

CONSTRUCTION PHASING & M.O.T	
	BARRICADE, TYPE 3
	CONCRETE SAFETY BARRIER - PORTABLE
	CONSTRUCTION SAFETY FENCE / LENGTH
	CONSTRUCTION SAFETY FENCE
	CONSTRUCTION WARNING SIGN LOCATION
	CONSTRUCTION WARNING SIGN
	CRASH CUSHION ARRAY
	DRUM - TRAFFIC CONTROL
	FLAGGER LOCATION
	PHASING TRAFFIC FLOW ARROW
	TEMPORARY CONSTRUCTION
	TEMPORARY PAVEMENT MARKING ARROW
	TRUCK WITH MOUNTED ATTENUATOR
	WORK AREA - ACTIVE PHASE
	WORK AREA - PREVIOUS PHASE

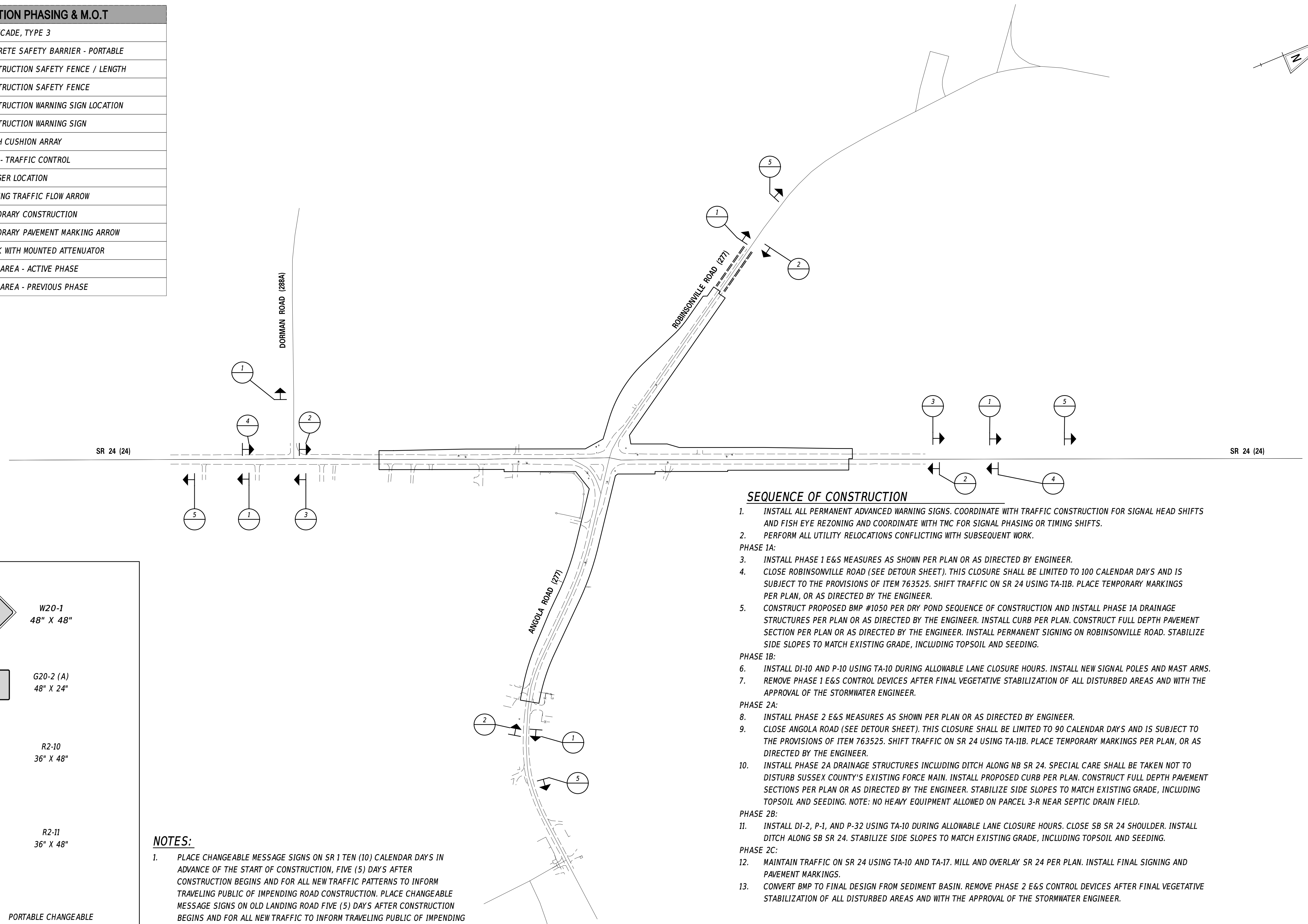
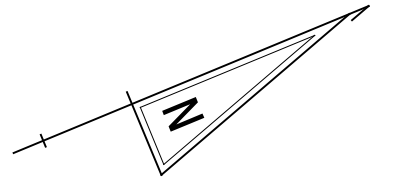

**SEQUENCE OF CONSTRUCTION**

- INSTALL ALL PERMANENT ADVANCED WARNING SIGNS. COORDINATE WITH TRAFFIC CONSTRUCTION FOR SIGNAL HEAD SHIFTS AND FISH EYE REZONING AND COORDINATE WITH TMC FOR SIGNAL PHASING OR TIMING SHIFTS.
  - PERFORM ALL UTILITY RELOCATIONS CONFLICTING WITH SUBSEQUENT WORK.
- PHASE 1A:
- INSTALL PHASE 1 E&S MEASURES AS SHOWN PER PLAN OR AS DIRECTED BY ENGINEER.
  - CLOSE ROBINSONVILLE ROAD (SEE DETOUR SHEET). THIS CLOSURE SHALL BE LIMITED TO 100 CALENDAR DAYS AND IS SUBJECT TO THE PROVISIONS OF ITEM 763525. SHIFT TRAFFIC ON SR 24 USING TA-11B. PLACE TEMPORARY MARKINGS PER PLAN, OR AS DIRECTED BY THE ENGINEER.
  - CONSTRUCT PROPOSED BMP #1050 PER DRY POND SEQUENCE OF CONSTRUCTION AND INSTALL PHASE 1A DRAINAGE STRUCTURES PER PLAN OR AS DIRECTED BY THE ENGINEER. INSTALL CURB PER PLAN. CONSTRUCT FULL DEPTH PAVEMENT SECTION PER PLAN OR AS DIRECTED BY THE ENGINEER. INSTALL PERMANENT SIGNING ON ROBINSONVILLE ROAD. STABILIZE SIDE SLOPES TO MATCH EXISTING GRADE, INCLUDING TOPSOIL AND SEEDING.
- PHASE 1B:
- INSTALL DI-10 AND P-10 USING TA-10 DURING ALLOWABLE LANE CLOSURE HOURS. INSTALL NEW SIGNAL POLES AND MAST ARMS.
  - REMOVE PHASE 1 E&S CONTROL DEVICES AFTER FINAL VEGETATIVE STABILIZATION OF ALL DISTURBED AREAS AND WITH THE APPROVAL OF THE STORMWATER ENGINEER.
- PHASE 2A:
- INSTALL PHASE 2 E&S MEASURES AS SHOWN PER PLAN OR AS DIRECTED BY ENGINEER.
  - CLOSE ANGOLA ROAD (SEE DETOUR SHEET). THIS CLOSURE SHALL BE LIMITED TO 90 CALENDAR DAYS AND IS SUBJECT TO THE PROVISIONS OF ITEM 763525. SHIFT TRAFFIC ON SR 24 USING TA-11B. PLACE TEMPORARY MARKINGS PER PLAN, OR AS DIRECTED BY THE ENGINEER.
  - INSTALL PHASE 2A DRAINAGE STRUCTURES INCLUDING DITCH ALONG NB SR 24. SPECIAL CARE SHALL BE TAKEN NOT TO DISTURB SUSSEX COUNTY'S EXISTING FORCE MAIN. INSTALL PROPOSED CURB PER PLAN. CONSTRUCT FULL DEPTH PAVEMENT SECTIONS PER PLAN OR AS DIRECTED BY THE ENGINEER. STABILIZE SIDE SLOPES TO MATCH EXISTING GRADE, INCLUDING TOPSOIL AND SEEDING. NOTE: NO HEAVY EQUIPMENT ALLOWED ON PARCEL 3-R NEAR SEPTIC DRAIN FIELD.
- PHASE 2B:
- INSTALL DI-2, P-1, AND P-32 USING TA-10 DURING ALLOWABLE LANE CLOSURE HOURS. CLOSE SB SR 24 SHOULDER. INSTALL DITCH ALONG SB SR 24. STABILIZE SIDE SLOPES TO MATCH EXISTING GRADE, INCLUDING TOPSOIL AND SEEDING.
- PHASE 2C:
- MAINTAIN TRAFFIC ON SR 24 USING TA-10 AND TA-17. MILL AND OVERLAY SR 24 PER PLAN. INSTALL FINAL SIGNING AND PAVEMENT MARKINGS.
  - CONVERT BMP TO FINAL DESIGN FROM SEDIMENT BASIN. REMOVE PHASE 2 E&S CONTROL DEVICES AFTER FINAL VEGETATIVE STABILIZATION OF ALL DISTURBED AREAS AND WITH THE APPROVAL OF THE STORMWATER ENGINEER.

**NOTES:**

- PLACE CHANGEABLE MESSAGE SIGNS ON SR 1 TEN (10) CALENDAR DAYS IN ADVANCE OF THE START OF CONSTRUCTION, FIVE (5) DAYS AFTER CONSTRUCTION BEGINS AND FOR ALL NEW TRAFFIC PATTERNS TO INFORM TRAVELING PUBLIC OF IMPENDING ROAD CONSTRUCTION. PLACE CHANGEABLE MESSAGE SIGNS ON OLD LANDING ROAD FIVE (5) DAYS AFTER CONSTRUCTION BEGINS AND FOR ALL NEW TRAFFIC TO INFORM TRAVELING PUBLIC OF IMPENDING ROAD CONSTRUCTION. PCMS SHALL BE APPROVED BY TRAFFIC SAFETY PRIOR TO USE.

1		W20-1 48" X 48"
2		G20-2 (A) 48" X 24"
3		R2-10 36" X 48"
4		R2-11 36" X 48"
5		PORTABLE CHANGEABLE MESSAGE SIGN

ADDENDA / REVISIONS

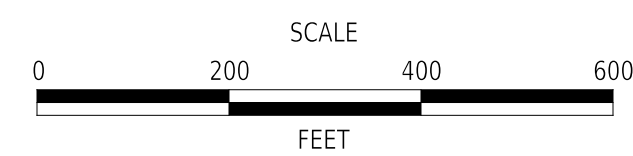

**HSIP SC, SR24 AT ANGOLA ROAD**

CONTRACT	BRIDGE NO.	N/A
T202400902	DESIGNED BY:	W. NAUMAN
COUNTY	CHECKED BY:	J. GAINES
SUSSEX		

**CONSTRUCTION PHASING,  
M.O.T., AND EROSION  
CONTROL PLAN**

SECTION
PD
SHEET NO.
35