

**SUCCESSSES IN 2022!**

# SUCCESSSES IN 2022: E-TICKETING



- Instituted a specification that all hot mix tickets must be provided electronically.
- Still working on implementing concrete tickets . New pilots in the works!

# SUCCESSSES IN 2022: E-TICKETING



12:50

CHRISTIANA MATERIALS

Transport History Ticket: # 73069

**In Transit** 04/29/2022 08:37 AM EDT

Ticket Audit Log Test Results Photos

Hide raw ticket data

Supplier	Christina Materials
Plant	CHRISTIANA MATERIALS
Customer Name	ADEL
Contract #	T201012001
Job	SR. 299
Job #	T201012001
Hauler	ADEL CONSTRUCTION
Truck	ADE252
Max GVW	N/A
Product	139B3
Product Description	CHR 139 19MM 76-22 AC 4.3
Product Code	401016 OR 401816
Load	2
Daily Total	43.65
Weighmaster	N/A
Gross	36.41

Mark delivered More actions

# SUCCESSSES IN 2022: E-TICKETING

## Ticket Packages



Ticket Package

e-Tickets

Summary Pay Items

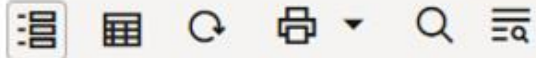

No. ▼		Mater... Type	Pay/S...	Type	Short Desc	Ticket Pay Item Name	Quantity
004		Hot Mix	Payment	Bid Pay Items	401500-01-0001	HOT MIX HOT LAID BIT...	258.54
003		Hot Mix	Payment	Non-bid Pay Items	000002-01-0001	Additional Landscape	22.16
002		Hot Mix	Payment	Bid Pay Items	202505-00-0001	Crack Gauges	11.06
001		Hot Mix	Source	Bid Pay Items	401500-01-0001	HOT MIX HOT LAID BIT...	18.63

Line Item Details

Attachments

Linked R [ ]

Material Type

Hot Mix

Pay or Source

Payment

Select Pay Item Type

Bid Pay Items

Non-bid Pay Items

Bid Pay Item

401500-01-0001

Non-Bid Pay Item

Quantity



# SUCCESSSES IN 2022: ROUTE 24



# SUCSESSES IN 2022: ROUTE 24

<b>SR 24</b>	<b>FUNCTIONAL CLASS: MAJOR COLLECTOR</b>	
	<b>TYPE OF CONSTRUCTION: SAFETY</b>	
	<b>A.A.D.T. CURRENT: 17799</b>	<b>YEAR: 2011</b>
	<b>A.A.D.T. PROJECTED: 24000</b>	<b>YEAR: 2041</b>

<b>S.R. 24 (ANGOLA)</b>	<b>FUNCTIONAL CLASS: MAJOR COLLECTOR</b>	
	<b>TYPE OF CONSTRUCTION: INTERSECTION IMPROVEMENT</b>	
	<b>A.A.D.T. CURRENT: 19868</b>	<b>YEAR: 2017</b>
	<b>A.A.D.T. PROJECTED: 24000</b>	<b>YEAR: 2041</b>

<b>FUNCTIONAL CLASS: MAJOR COLLECTOR</b>	
<b>TYPE OF CONSTRUCTION: SAFETY/OPERATIONAL</b>	
<b>A.A.D.T. CURRENT: 19285</b>	<b>YEAR: 2015</b>
<b>A.A.D.T. PROJECTED: 28500</b>	<b>YEAR: 2040</b>

<b>JOHN J. WILLIAMS HWY (SR 24)</b>	
<b>FUNCTIONAL CLASS: MAJOR COLLECTOR</b>	
<b>TYPE OF CONSTRUCTION: SAFETY/OPERATIONAL</b>	
<b>A.A.D.T. CURRENT: 19590</b>	<b>YEAR: 2016</b>
<b>A.A.D.T. PROJECTED: 33300</b>	<b>YEAR: 2040</b>
<b>PLANTATION/WARRINGTON RD</b>	
<b>FUNCTIONAL CLASS: MAJOR COLLECTOR</b>	
<b>TYPE OF CONSTRUCTION: SAFETY/OPERATIONAL</b>	
<b>A.A.D.T. CURRENT: 11028</b>	<b>YEAR: 2016</b>
<b>A.A.D.T. PROJECTED: -</b>	<b>YEAR: 2040</b>



# SR 24 Area Projects and Impacts - October 2020

ID#	Project	Estimated Construction Start	Estimated Construction Completion
1	SR 24, <b>Mulberry Knoll to SR 1</b> (T200411209)	Ongoing	2022
2	SR 24, <b>Love Creek to Mulberry Knoll</b>	Summer 2021	Spring 2022
3	HSIP SR 24 at <b>Camp Arrow Head Road Intersection</b> Improvements (T201200902)	Spring 2021	Spring 2022
	HSIP SR 24 at <b>Robinsonville Rd/Angola Rd Intersection</b> Improvements (T201200902)		
4	HSIP SR 24 at <b>SR 5 / SR 23 Intersection</b> Improvements (T201200903)	Spring 2021	Fall 2022
5	HSIP SR 24 at <b>Bay Farm Road Intersection</b> Improvements (T200711201)	Spring 2021	2023
	HSIP SR 24 at <b>Mount Joy Road Intersection</b> Improvements (T200711201)		
6A	<b>Plantation Road</b> Improvements, Robinsonville Road to US 9 (Phase 1) (T201111201)	Winter 2021-2022	2023
6B	<b>Plantation Road</b> Improvements, SR 24 to Robinsonville Road (Phase 2) (T201111201)	TBD	TBD
7	BR 3-708P on Old SR 24 over Love Creek	Summer 2018	Spring 2019
8	Mt. Joy Road - Pavement & Rehabilitation, Sussex IV, 2017 (T201706304)	Summer 2018	Summer 2019
9	SR 1 Forgotten Mile - Pavement & Rehabilitation, Sussex I, 2017 (T201706301)	Fall 2018	Spring 2019
10	SR 30 (Gravel Hill Rd) - Pavement & Rehabilitation, 2018 (T201606301)	Summer 2019	Fall 2019
11	Robinsonville Road - Force Main, Kendale Road to Plantation Road	Spring 2019	
12	Cedar Grove Road	Spring 2019	
13	Beaver Dam Road Patching	2019	
14	SR 24 @ SR 30 Patching	2019	
15	Cool Spring Road at Forest Road Realignment	Spring 2019	
16	SR 24 Rail Crossing Replacements in Millsboro (516301Y & 516302F) (T201500514)	October 2020	October 2020
17	US 113 @ SR 24 Wawa Construction	Fall 2019	Spring 2020
18	BR 3-150 N&S on SR 1 over Lewes-Rehoboth Canal (T201407602)	Winter 2019-2020	Spring 2020
19	Burtons Pond Dam Improvements (T201807302)	2022	2023
20	North Millsboro Bypass, US 113 to SR 24 (T201912701)	Fall 2023	Fall 2026
21	BR 3-507 on US 113 over Iron Branch (T201307301)	October 2019	December 2019

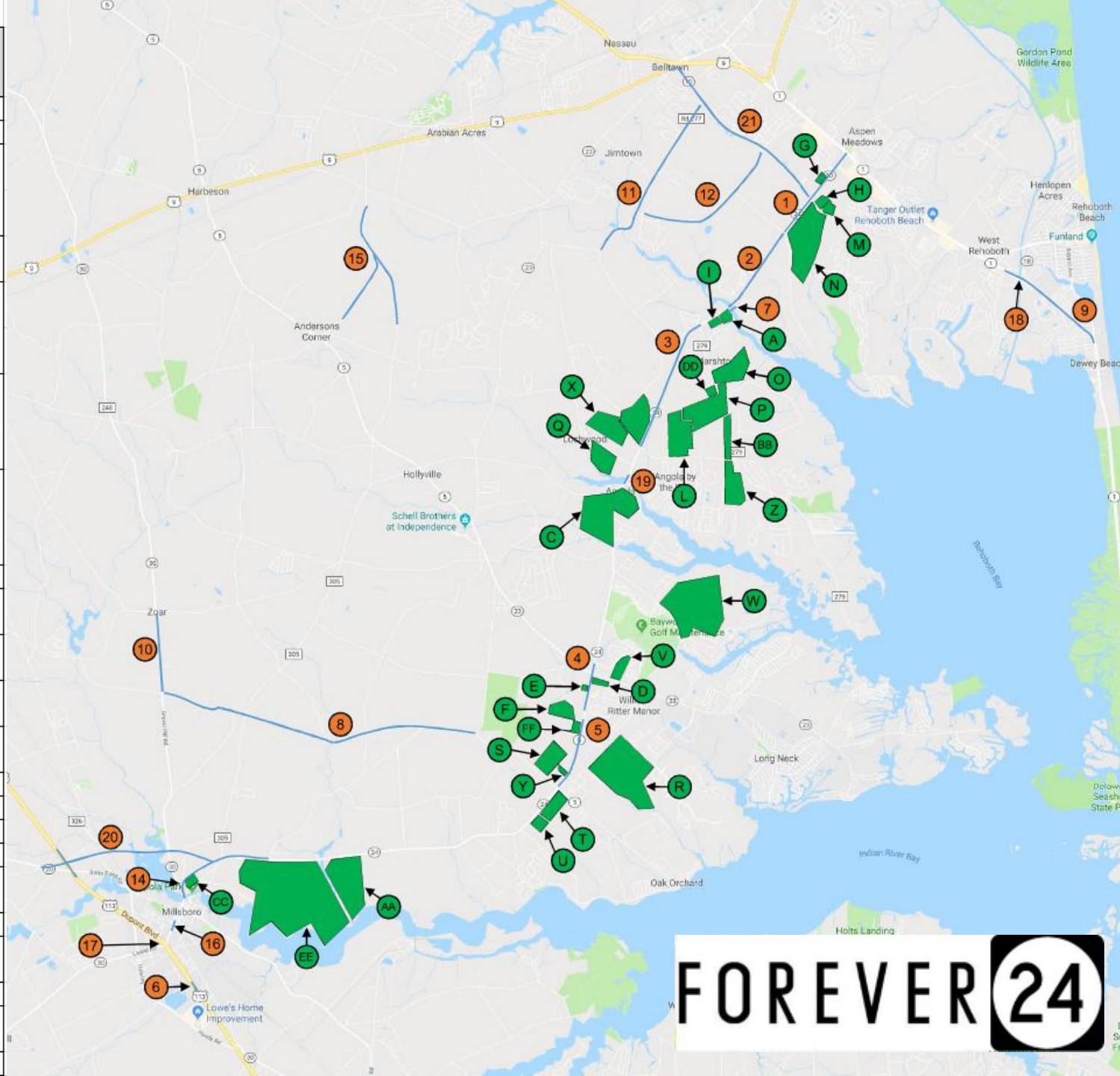



# SUCCESSSES IN 2022: ROUTE 24



Ver-Mac JamLogic 3.114.4 <https://svr1jamlogic.com/>

File Edit View Tools Options Windows ?

Folders: 0-SWZ - DE - SR 24 SWZ (2021) RS (5/41)  
JSON (2/20)

Type	Status	Name	Value	Voltage	Image	Road	R
		PVMS 01 SB US 113 (S of SR 18/404) MB0009	ROADWORK ON SR 24 TO SR 24	12.62 V		US-113	
		PVMS 02 SB US 113 (N of Houston St-Millsboro) mb1860	ROADWORK ON SR 24 TO SR 24	12.74 V		US-113	
		PVMS 03 NB US 113 (N of 1st St-Millsboro) MB1700	ROADWORK ON SR 24 TO SR 24	12.66 V		US-113	
		PVMS 04 NB US 113 (S of SR 26) MB 1453	ROADWORK ON SR 24 TO SR 24	12.82 V		US-113	
		PVMS 05 SB SR 24 (W of Herbert Ln) MB1246	LONGNECK 6 MILES 12 MIN	12.62 V		SR 24	
		PVMS 06 SB Mt Joy Rd (N of Cordrey Rd) MB 1580	LONGNECK VIA SR 24E	12.84 V		Mount Joy Rd	
		PVMS 07 NB Oak Orchard Rd (N of Driftwood Blvd) MB2540	LONGNECK VIA SR 24E	12.68 V		Oak Orchard Rd	
		PVMS 08 SB SR 5 (N of Hollymount Rd) MB0209	ROADWORK ON SR 24	12.66 V		SR-5	
		PVMS 09 NB Long Neck Rd (N of Julius Ln) 1.0 Mile Off SR 24	ROADWORK ON SR 24	12.57 V		Long Neck Rd	
		PVMS 10 EB SR 24 (W of Dorman Rd) MB0218	SR 24 ROADWORK NEXT 4	12.74 V		SR-24	
		PVMS 11 WB SR 24 (E of Mariners Way) MB 1454	SR24 ROADWORK NEXT 4	12.84 V		SR-24	
		PVMS 12 WB SR 24 (@ Fire Station 3) MB1900	SR24	12.66 V		SR 24	

Task List

Map: Center on select, Cluster, GoogleMap

Properties: <no name>

English (United States) 0-SWZ - DE - SR 24 SWZ (2021) RS 10:41 PM (-04:00)



- Smart work zone implemented.
- Stand along contract integrating each project.
- Real-time traveler information.



# SUCCESSSES OF 2022: I-95 VIADUCT





# SUCCESSSES OF 2022: I-95 VIADUCT

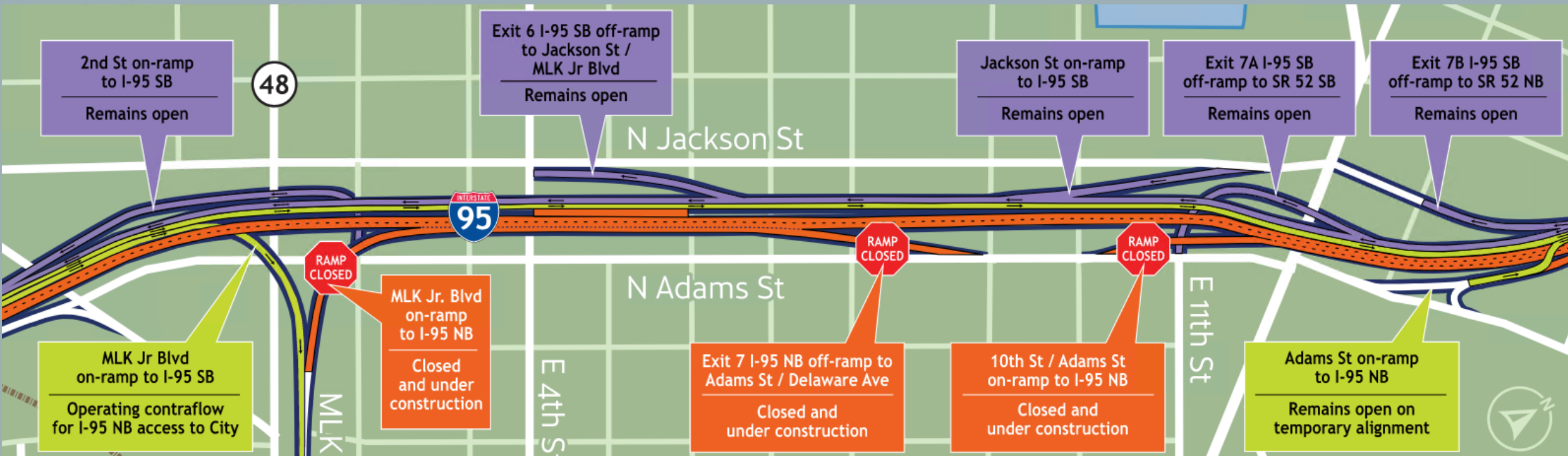

## Phase I

- Shift NB I-95 to SB I-95 in a contraflow pattern to reconstruct all of NB I-95 and rehab all bridges.
- The traffic shift will take 2 weeks to implement.

# SUCCESSSES OF 2022: I-95 VIADUCT

January 2021  
Su Mo Tu We Th Fr Sa  
1 2  
3 4 5 6 7 8 9  
10 11 12 13 14 15 16  
17 18 19 20 21 22 23  
24 25 26 27 28 29 30  
31

March 2021  
Su Mo Tu We Th Fr Sa  
1 2 3 4 5 6  
7 8 9 10 11 12 13  
14 15 16 17 18 19 20  
21 22 23 24 25 26 27  
28 29 30 31

## FEBRUARY 2021

Sunday	Monday	Tuesday	Wednesday	Thursday	Friday	Saturday
	1	2	3	4	5	6
7	8	9	10	11	12	13
14	15	16	17	18	19	20
21	22	23	24	25	26	27
28	March 1. First day of work!					

# SUCCESSSES OF 2022: I-95 VIADUCT



## Phase 2

- Shift NB I-95 and SB I-95 to the NB I-95 side in a contraflow pattern to reconstruct all of SB I-95 and rehab all bridges.
- The traffic shift will take approximately 2 weeks to implement.



# SUCSESSES OF 2022: I-95 VIADUCT

## December 2021

Sunday	Monday	Tuesday	Wednesday	Thursday	Friday	Saturday
			1	2	3	4
5	6	7	8	9	10	11
12	13	14	15	16	17	18
19	20	21	22	23	24	25
26	27	28	29	30	31	