

| TEMPORARY PAVEMENT MARKINGS LEGEND | | |
|------------------------------------|--|----------|
| SYMBOL | ITEM | QUANTITY |
| (A) | 4" SOLID WHITE TEMPORARY MARKING, PAINT (ITEM 817003) | 2,023 LF |
| (B) | 4" SOLID DOUBLE YELLOW (4"-6"-4") TEMPORARY MARKING, PAINT (ITEM 817003) | 1,678 LF |
| (C) | 4" WHITE AUXILIARY LANE (3' STRIPE, 9' GAP) TEMPORARY MARKING, PAINT (ITEM 817003) | 60 LF |
| (D) | TEMPORARY PAVEMENT SYMBOL, PAINT (ITEM 817004) | 42 SF |

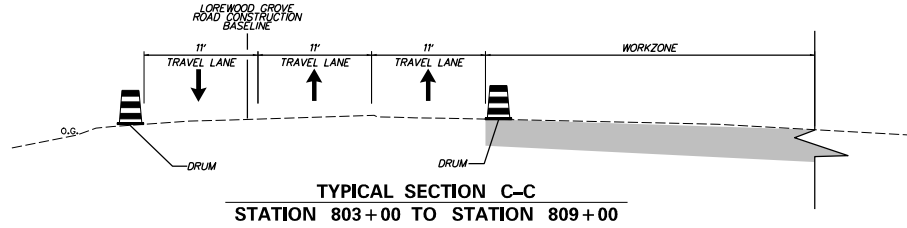

PARCEL 12-035.00-001
PARKWAY GRAVEL, INC.
INSTR NO. 20010123 0004754

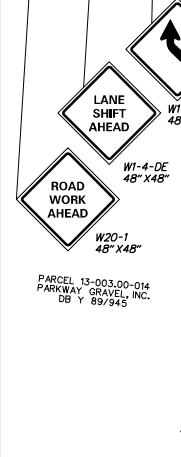
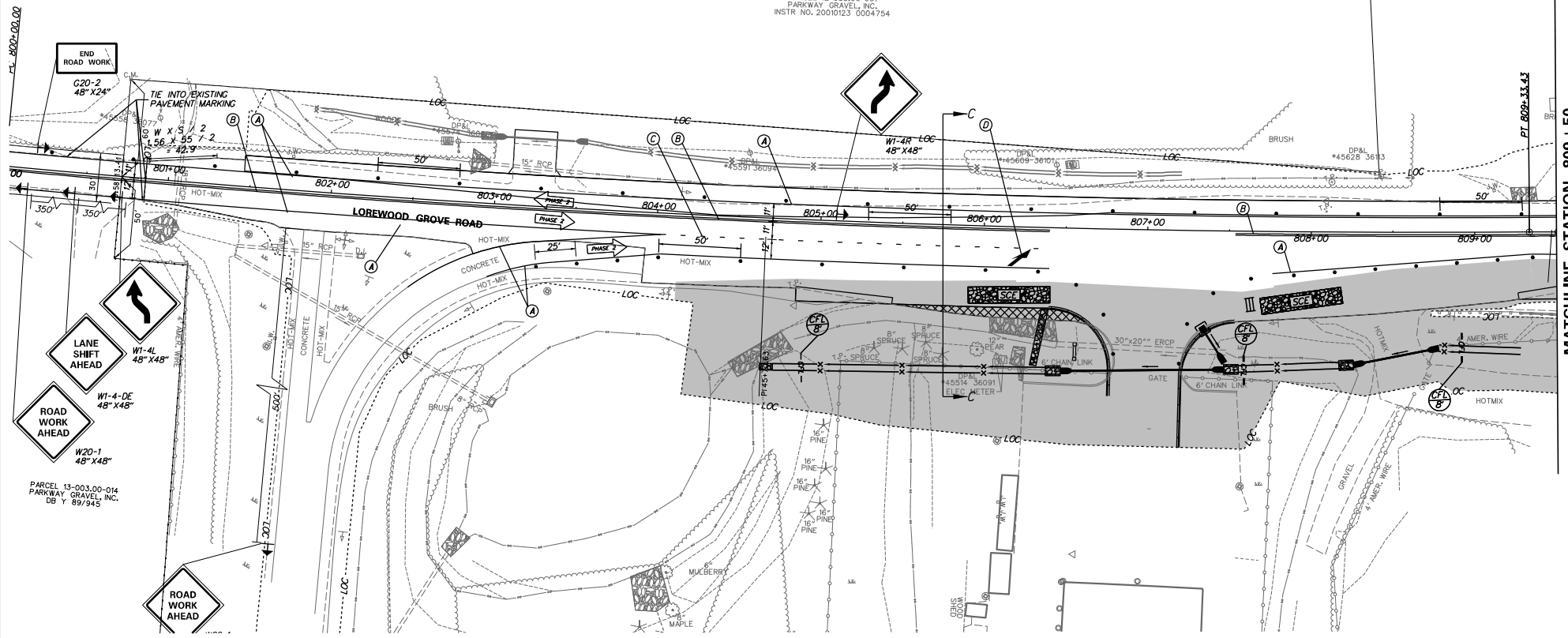

PLOTTED BY: BDOUGHERTY DATE: 4/18/2017
 FILE LOCATION: Q:\INR\120995_02\157_GEOORGES_MAINTENANCE_CADD\ROADWAY_CS_PHASE_FINAL.DWG [SHEET: 0901]

DELAWARE
DEPARTMENT OF TRANSPORTATION

ADDENDUMS / REVISIONS

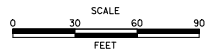

ST. GEORGES
MAINTENANCE YARD
ENTRANCE IMPROVEMENTS

| | | |
|------------|--------------|-----|
| CONTRACT | BRIDGE NO. | N/A |
| T201780102 | DESIGNED BY: | ABF |
| COUNTY | CHECKED BY: | WJD |
| NEW CASTLE | | |

CONSTRUCTION PHASING, M.O.T.
AND EROSION CONTROL PLAN

| | |
|-------------|----|
| SHEET NO. | 19 |
| TOTAL SHTS. | 40 |

MATCHLINE STATION 809 + 50