

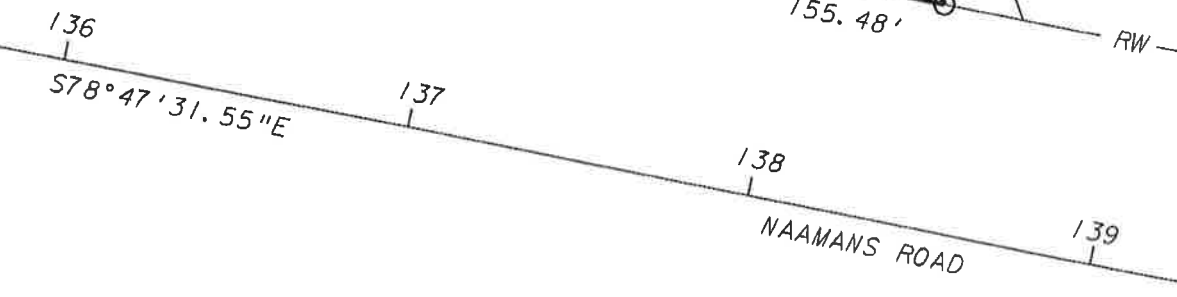

LANDS N/F OF
PIERCE FAMILY, INC.

LANDS N/F OF
MABEL B. PIERCE

AREA = 0.7469 +/- AC.



JACK FRIEDMAN and DIANA FRIEDMAN, H/W LANDS ACQUIRED FROM		
NEW CASTLE COUNTY	BRANDYWINE HUNDRED	06-23.00-111 TAX ASSMT. PAR. NO.
79-102-10 CONTRACT NO.	NAAMANS ROAD - SECTION 4B PROJECT TITLE	
417-L CONTRACT PARCEL NO.	2536-076 DEED RECORD	DEED DATE
SCALE: 1 INCH = 50 FEET / FULL SIZE DWG. IS 17" x 22" FOR 8 1/2" COPIES; SCALE X 2		NOTED AREA OF
REVISIONS:		



STATE OF DELAWARE
DEPARTMENT OF TRANSPORTATION

OFFICE OF PRECONSTRUCTION

P.O. BOX 778
DOVER, DELAWARE 19903

REAL ESTATE SECTION



DRAWN BY J. FIORI

DATE NOV. 19, 1998

PLOT DWG. NO.

NC

579