

CIRCULAR CURVE ①

Element: Circular	STATION	NORTHING	EASTING
PC(11002)	200+84.74	246021.9942	724239.3915
PI(11005)	205+02.85	245984.8337	723822.9406
CC(11004)		246853.6897	724165.1781
PT(11006)	208+60.00	246296.0222	723543.7024
Radius:	835.00		
Delta:	53°11'47.65" Right		
Degree of Curvature:	6°51'42.37"		
Length:	775.26		
Tangent:	418.11		
Chord:	747.71		
Middle Ordinate:	88.37		
External:	98.83		
Tangent Direction:	S 84°54'03.30" W		
Radial Direction:	N 5°05'56.70" W		
Chord Direction:	N 68°30'02.88" W		
Radial Direction:	N 48°05'50.94" E		
Tangent Direction:	N 41°54'09.06" W		

CIRCULAR CURVE ②

Element: Circular	STATION	NORTHING	EASTING
PC(11007)	210+76.78	246457.3674	723398.9228
PI(11008)	211+96.65	246546.5873	723318.8632
CC(11009)		245696.0010	722550.4411
PT(11010)	213+15.65	246617.2027	723221.9972
Radius:	1140.00		
Delta:	12°00'19.55" Left		
Degree of Curvature:	5°01'33.40"		
Length:	238.87		
Tangent:	119.87		
Chord:	238.43		
Middle Ordinate:	6.25		
External:	6.29		
Tangent Direction:	N 41°54'09.06" W		
Radial Direction:	N 48°05'50.94" E		
Chord Direction:	N 47°54'18.77" W		
Radial Direction:	N 36°05'31.39" E		
Tangent Direction:	N 53°54'28.61" W		

CIRCULAR CURVE ③

Element: Circular	STATION	NORTHING	EASTING
PC(11013)	218+03.47	246904.5709	722827.8021
PI(11015)	219+50.43	246991.1437	722709.0466
CC(11014)		247296.4856	723113.5080
PT(11016)	220+88.86	247129.0724	722658.3181
Radius:	485.00		
Delta:	33°42'54.17" Right		
Degree of Curvature:	11°48'48.83"		
Length:	285.39		
Tangent:	146.96		
Chord:	281.29		
Middle Ordinate:	20.84		
External:	21.78		
Tangent Direction:	N 53°54'28.59" W		
Radial Direction:	N 36°05'31.41" E		
Chord Direction:	N 37°03'01.53" W		
Radial Direction:	N 69°48'25.57" E		
Tangent Direction:	N 20°11'34.43" W		

CIRCULAR CURVE ④

Element: Circular	STATION	NORTHING	EASTING
PC(11017)	222+54.86	247284.8690	722601.0181
PI(11019)	223+07.74	247334.5003	722582.7643
CC(11018)		247117.4558	722145.8282
PT(11020)	223+60.21	247379.0318	722554.2434
Radius:	485.00		
Delta:	12°26'43.01" Left		
Degree of Curvature:	11°48'48.83"		
Length:	105.35		
Tangent:	52.88		
Chord:	105.14		
Middle Ordinate:	2.86		
External:	2.87		
Tangent Direction:	N 20°11'34.43" W		
Radial Direction:	N 69°48'25.57" E		
Chord Direction:	N 26°24'56.02" W		
Radial Direction:	N 57°21'42.56" E		
Tangent Direction:	N 32°38'17.44" W		

DISCLAIMER:
 THIS EXAMPLE PLAN SET IS INTENDED TO BE A GUIDELINE FOR PREPARING A SET OF PLANS AND BASIC GUIDANCE FOR THE GENERAL APPEARANCE OF A SET OF PLANS. IT IS NOT INTENDED TO BE A SET OF CADD STANDARDS OR TO PROVIDE DESIGN GUIDANCE. PLEASE REFER TO THE DESIGN RESOURCE CENTER (DRC) FOR THE LATEST CADD UPDATES AND VARIOUS OTHER DOCUMENTS FOR DESIGN GUIDANCE.

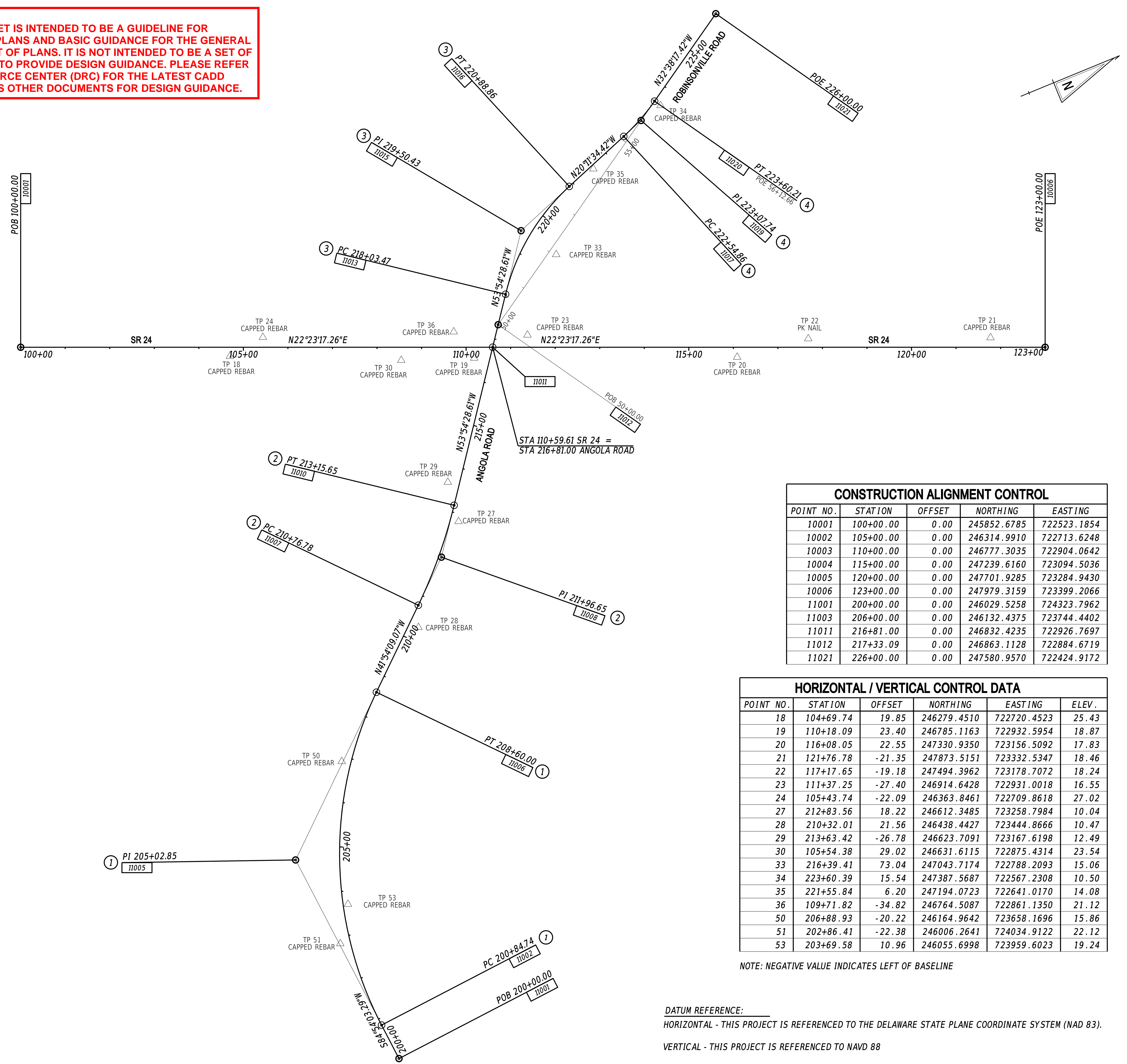

CONSTRUCTION ALIGNMENT CONTROL

POINT NO.	STATION	OFFSET	NORTHING	EASTING
10001	100+00.00	0.00	245852.6785	722523.1854
10002	105+00.00	0.00	246314.9910	722713.6248
10003	110+00.00	0.00	246777.3035	722904.0642
10004	115+00.00	0.00	247239.6160	723094.5036
10005	120+00.00	0.00	247701.9285	723284.9430
10006	123+00.00	0.00	247979.3159	723399.2066
11001	200+00.00	0.00	246029.5258	724323.7962
11003	206+00.00	0.00	246132.4375	723744.4402
11011	216+81.00	0.00	246832.4235	722926.7697
11012	217+33.09	0.00	246863.1128	722884.6719
11021	226+00.00	0.00	247580.9570	722424.9172

HORIZONTAL / VERTICAL CONTROL DATA

POINT NO.	STATION	OFFSET	NORTHING	EASTING	ELEV.
18	104+69.74	19.85	246279.4510	722720.4523	25.43
19	110+18.09	23.40	246785.1163	722932.5954	18.87
20	116+08.05	22.55	247330.9350	723156.5092	17.83
21	121+76.78	-21.35	247873.5151	723332.5347	18.46
22	117+17.65	-19.18	247494.3962	723178.7072	18.24
23	111+37.25	-27.40	246914.6428	722931.0018	16.55
24	105+43.74	-22.09	246363.8461	722709.8618	27.02
27	212+83.56	18.22	246612.3485	723258.7984	10.04
28	210+32.01	21.56	246438.4427	723444.8666	10.47
29	213+63.42	-26.78	246623.7091	723167.6198	12.49
30	105+54.38	29.02	246631.6115	722875.4314	23.54
33	216+39.41	73.04	247043.7174	722788.2093	15.06
34	223+60.39	15.54	247387.5687	722567.2308	10.50
35	221+55.84	6.20	247194.0723	722641.0170	14.08
36	109+71.82	-34.82	246764.5087	722861.1350	21.12
50	206+88.93	-20.22	246164.9642	723658.1696	15.86
51	202+86.41	-22.38	246006.2641	724034.9122	22.12
53	203+69.58	10.96	246055.6998	723959.6023	19.24

NOTE: NEGATIVE VALUE INDICATES LEFT OF BASELINE

DATUM REFERENCE:
 HORIZONTAL - THIS PROJECT IS REFERENCED TO THE DELAWARE STATE PLANE COORDINATE SYSTEM (NAD 83).
 VERTICAL - THIS PROJECT IS REFERENCED TO NAVD 88

ADDENDA / REVISIONS

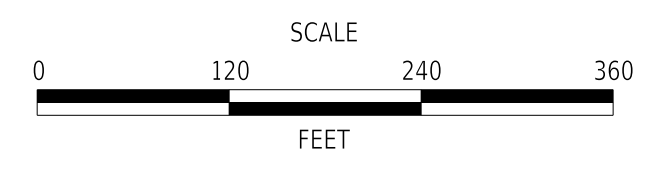

HSIP SC, SR24 AT CAMP ARROW HEAD ROAD AND SR24 AT ANGOLA ROAD

CONTRACT	T201200902	BRIDGE NO.	N/A
COUNTY	SUSSEX	DESIGNED BY:	W. NAUMAN
		CHECKED BY:	C. ESHAM

HORIZONTAL AND VERTICAL CONTROL

SECTION	PD
SHEET NO.	12

31-MAR-2020 07:57 \\DOT\F08\Cadd\Active_Designs\SUSSEX\024\road\T201200902\PLANS\ONLY\HV_ANG.dgn