

**GUARDRAIL SECTION**  
(RURAL SHOULDER APPLICATION)

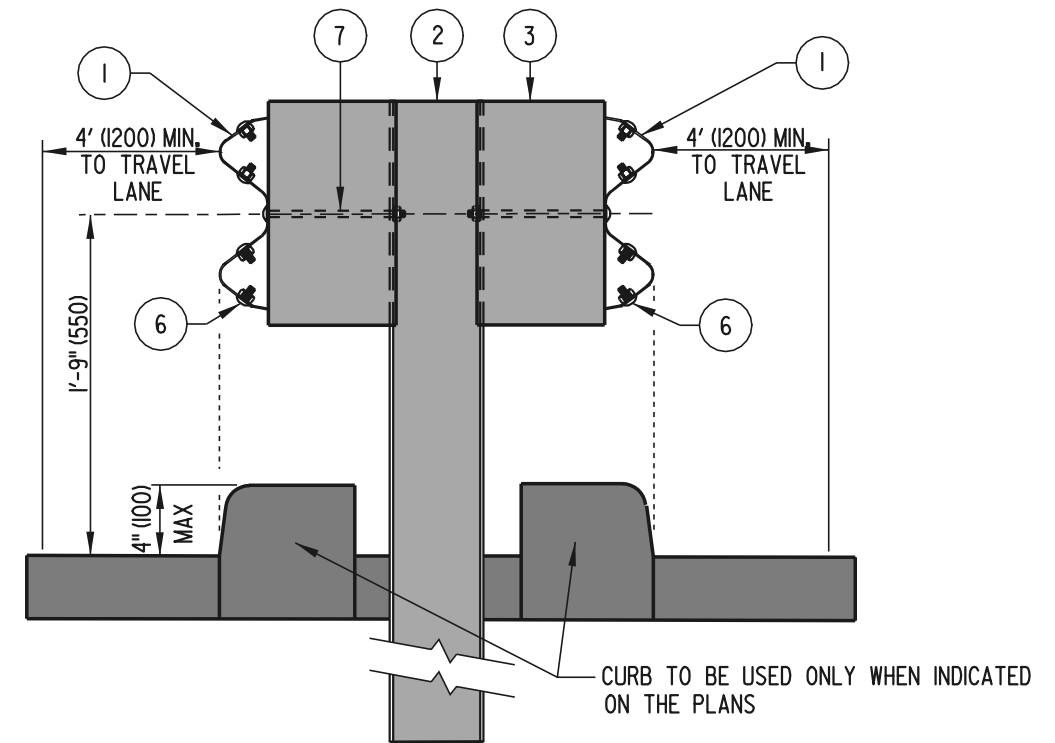

**GUARDRAIL SECTION**  
(MEDIAN APPLICATION)

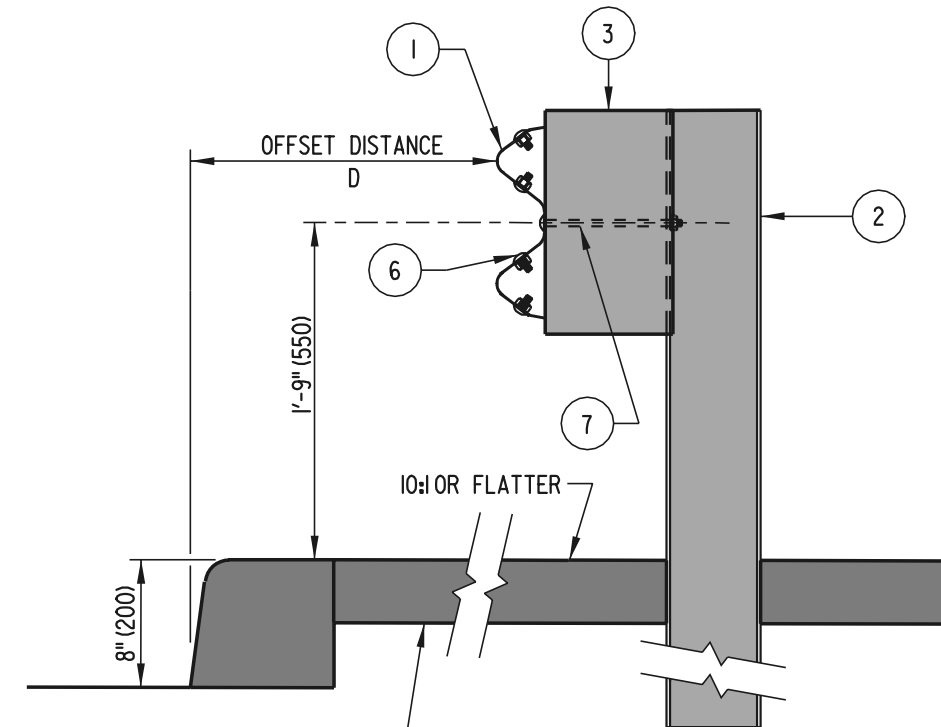

**GUARDRAIL SECTION**  
(URBAN SHOULDER APPLICATION)

DESIGN SPEED	D
< 50 MPH (80 km/h)	6' (1800)
≥ 50 MPH (80 km/h)	10' (3000)

TYPE	POST SPACING	CLEAR AREA BEHIND POST(*)
1	6' 3" (1905)	4' (1200)
2	3' 1½" (952.5)	2' (600)



DELAWARE  
DEPARTMENT OF TRANSPORTATION

GUARDRAIL APPLICATIONS

STANDARD NO. B-1 (2001)

SHT. 3 OF 3

APPROVED *Ryan M. Harshbarger* 6/18/01  
CHIEF ENGINEER DATE  
 RECOMMENDED *Michael R. [Signature]* 6/18/01  
DESIGN ENGINEER DATE