

**TYPE A**

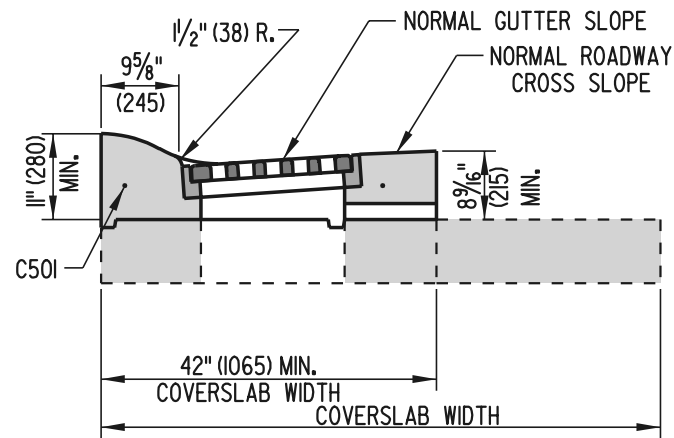

**TYPE D**

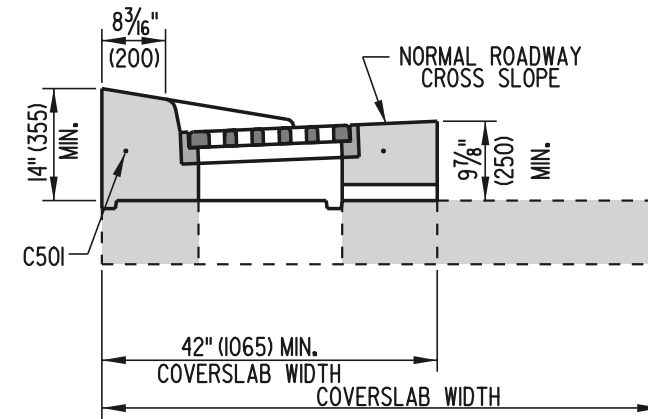

**TYPE E**

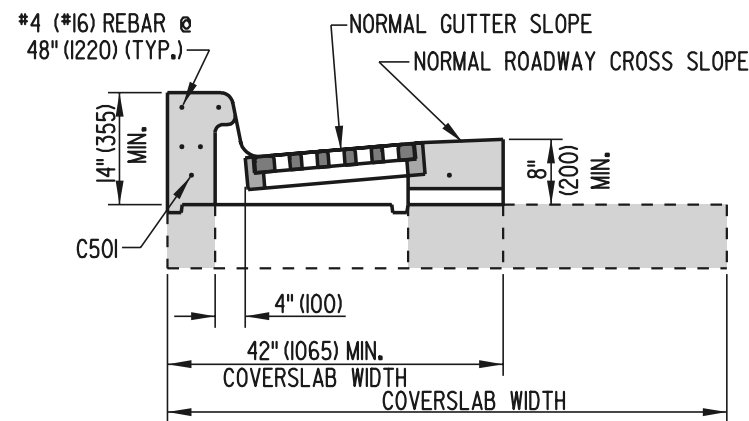

**TYPE B**

INLET TOP UNIT APPLICATIONS	
TOP UNIT	CURB
TYPE A	USE IN DRAINAGE SWALE
TYPE B	INTEGRAL PCC CURB & GUTTER, TYPE 1 & 3, PCC CURB TYPE 1
TYPE C	INTEGRAL PCC CURB & GUTTER, TYPE 4, PCC CURB TYPE 3
TYPE D	INTEGRAL PCC CURB & GUTTER, TYPE 2
TYPE E	PCC CURB TYPE 2

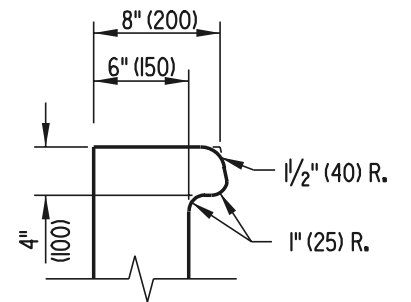

**CURB OPENING DETAIL**

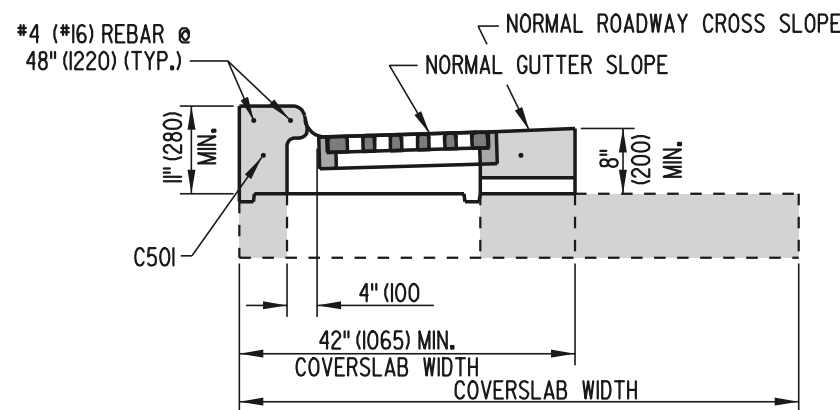

**TYPE C**

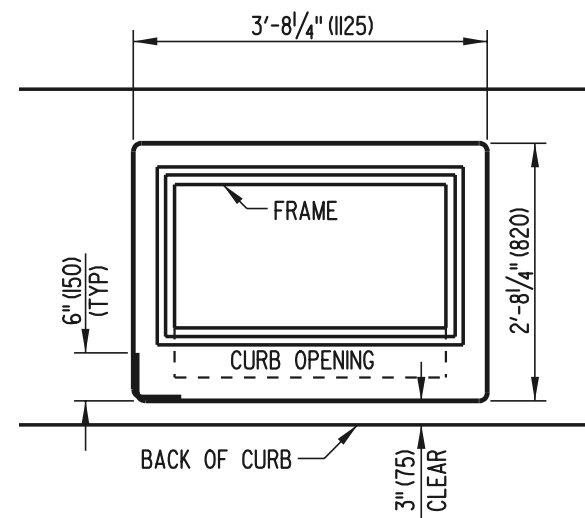

**C501 BENDING DIAGRAM**

C501 IS NOT REQUIRED TO BE ONE CONTINUOUS BAR. IF MORE THAN ONE BAR IS USED, THERE MUST BE A 12" (300) OVERLAP BETWEEN BARS.

**DRAINAGE INLET TOP UNITS**

NOTE: TOP UNIT IS TO BE CAST IN PLACE TO GRADE AS SPECIFIED ON PLAN SHEETS OR AS DIRECTED BY ENGINEER.

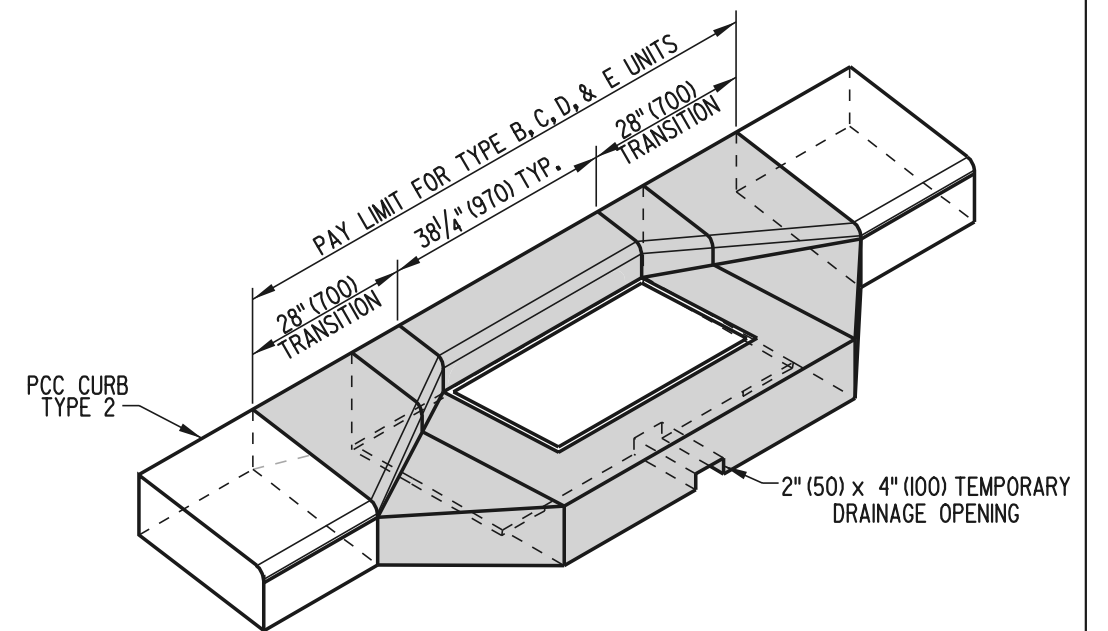

**ISOMETRIC VIEW**

TYPE E UNIT SHOWN



**DELAWARE**  
**DEPARTMENT OF TRANSPORTATION**

**DRAINAGE INLET DETAILS**

STANDARD NO. **D-5 (2001)** SHT. **3** OF **7**

APPROVED *Ryan M. Harshbarger* 6/18/01  
CHIEF ENGINEER DATE

RECOMMENDED *Mehal Alghob* 6/18/01  
DESIGN ENGINEER DATE