

**PLAN**

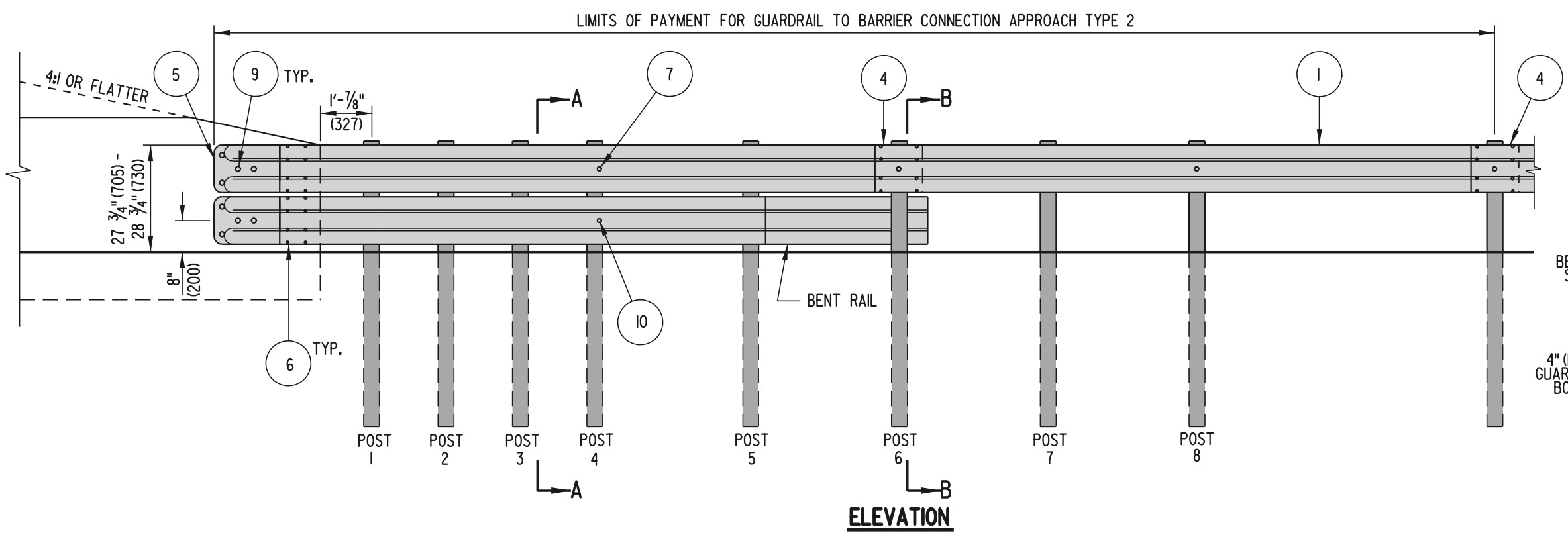

**ELEVATION**

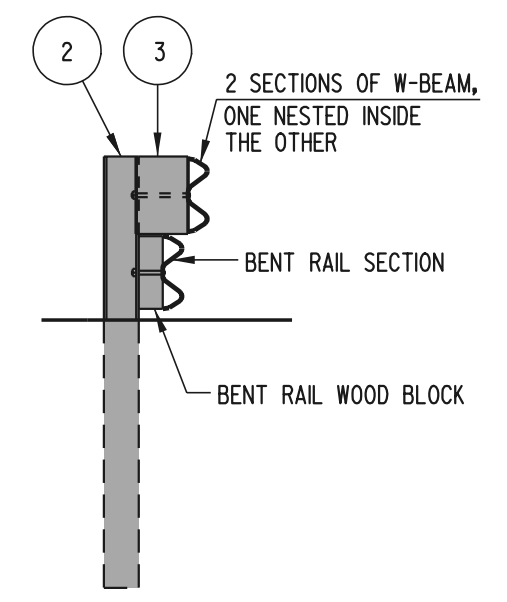

**SECTION A-A**

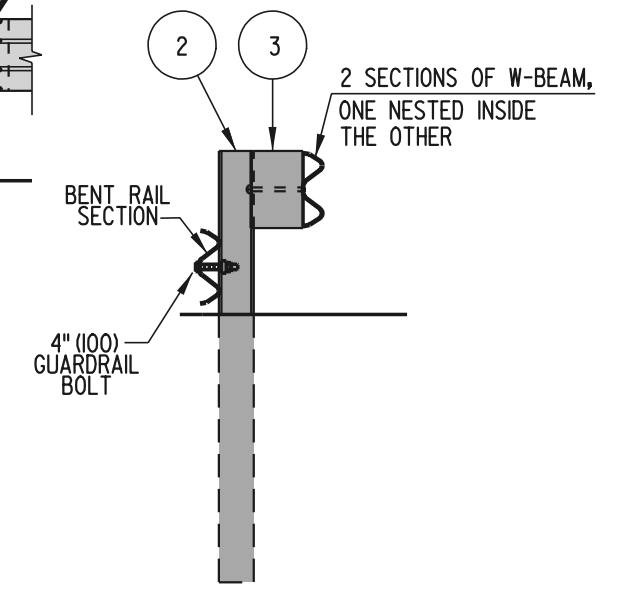

**SECTION B-B**

- NOTES :**
- 1). CURB SHALL NOT BE USED AT THE FACE OF RAIL WITHIN THE LIMITS OF THIS INSTALLATION.
  - 2). POSTS 1, 2, 3, 4, AND 6 REQUIRE AN ADDITIONAL HOLE TO ATTACH WOOD BLOCKS AND/OR BENT RAIL.
  - 3). DO NOT ATTACH RAILS TO POSTS 1, 2, 3, 5, OR 7.
  - 4). CURB SHALL NOT BE USED AT THE FACE OF RAIL WITHIN THE LIMITS OF THIS INSTALLATION.
  - 5). ALL HOLES SHALL BE DRILLED PRIOR TO GALVANIZING.
  - 6). BENT RAIL MAY BE SHOP BENT TO FACILITATE INSTALLATION OR MAY BE FIELD BENT USING HEAT.
  - 7). APPROVED CONCRETE INSERTS MAY BE USED IN NEW CONSTRUCTION TO ATTACH TERMINAL CONNECTORS TO PARAPET.
  - 8). PLACE REFLECTORIZED WASHER EVERY FIFTH POST.
  - 9). WHEN PLACED OVER CURB (MIN 8" (200) HIGH), BOTTOM RAIL CAN BE ELIMINATED.

 <b>DELAWARE</b> <b>DEPARTMENT OF TRANSPORTATION</b>	<b>GUARDRAIL TO BARRIER CONNECTION, APPROACH TYPE 2</b>		<b>APPROVED</b> <i>Caution Wicks</i> <b>9/6/02</b> <small>CHIEF ENGINEER DATE</small>
	<b>STANDARD NO. B-8 (2002)</b>	<b>SHT. 1 OF 2</b>	<b>RECOMMENDED</b> <i>Therese Delph</i> <b>8/19/02</b> <small>DESIGN ENGINEER DATE</small>