

SCALE : N.T.S.

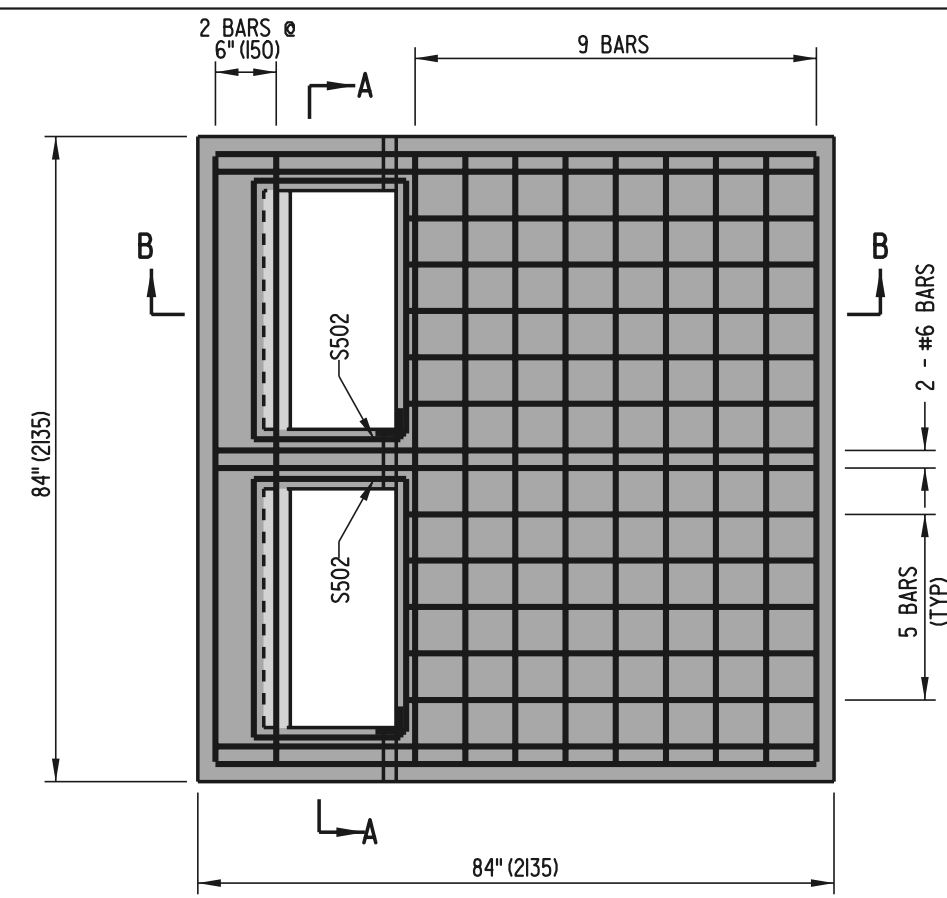

72" (1830) x 72" (1830) INLET

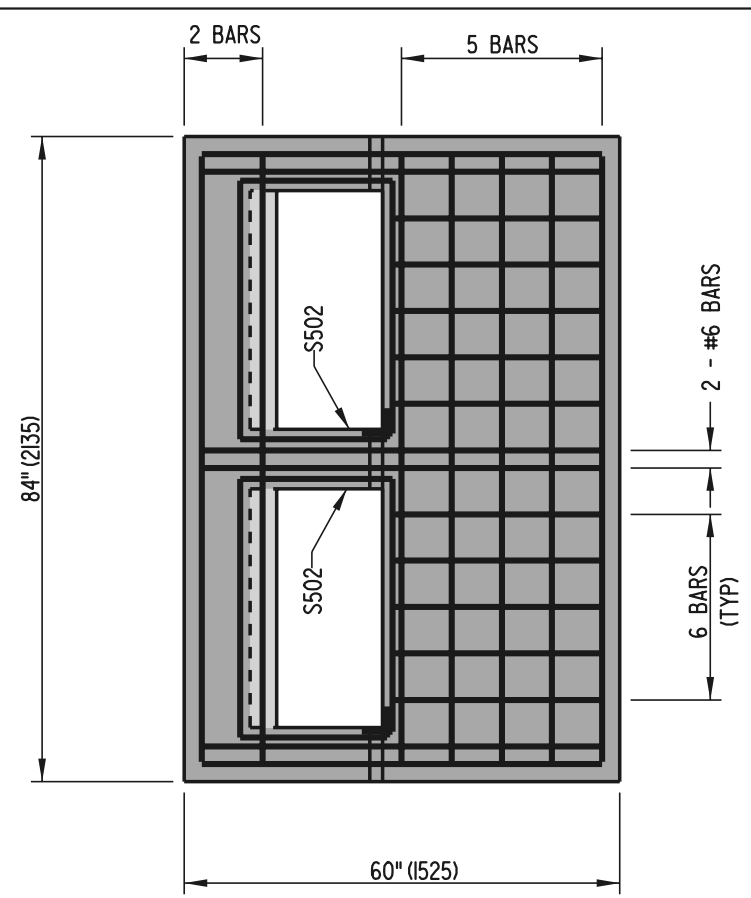

72" (1830) x 48" (1220) INLET

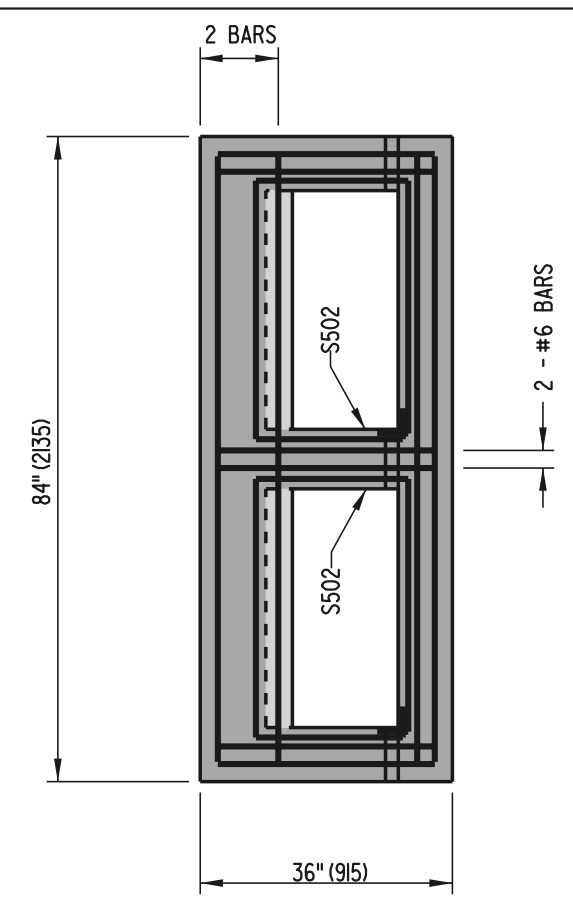

72" (1830) x 24" (610) INLET

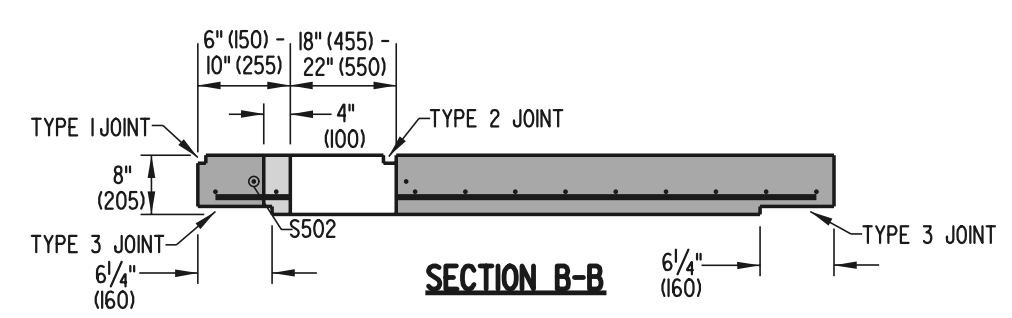

SECTION B-B

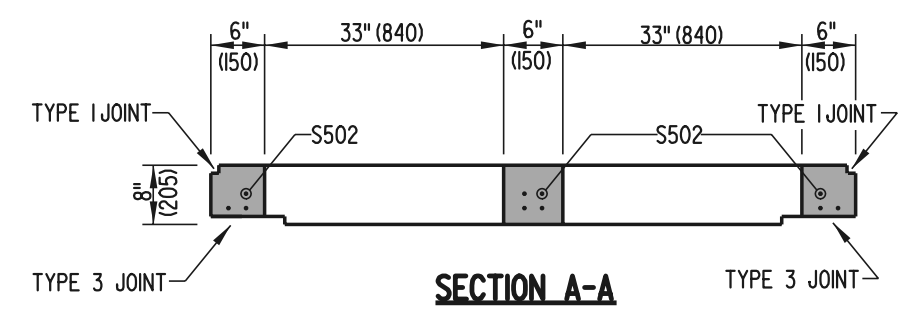

SECTION A-A

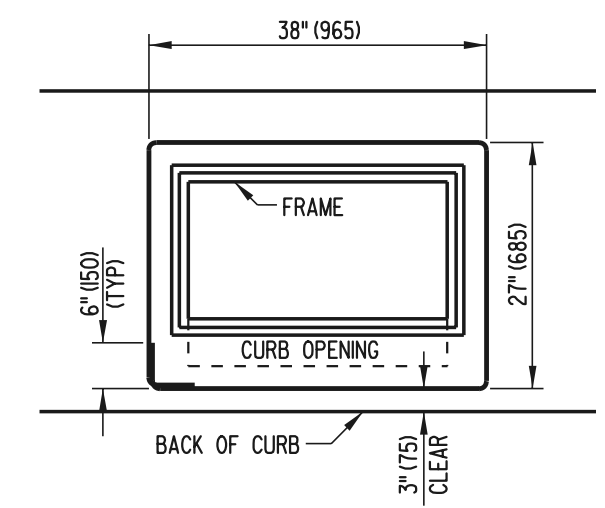

S502 BENDING DIAGRAM

S502 IS NOT REQUIRED TO BE ONE CONTINUOUS BAR. IF MORE THAN ONE BAR IS USED, THERE MUST BE A 12" (300) OVERLAP BETWEEN BARS.

- NOTE :**
1. 4" (100) THROAT IS FOR TYPES B AND C TOP UNITS ONLY.
 2. RELOCATE ENCROACHING REINFORCING BARS WHEN USING TYPES B & C TOP UNITS.
 3. COVER SLABS ARE TO BE PRE-CAST AND MUST BE SIZED TO FIT INLET BOX DIMENSIONS.
 4. ALL BARS ARE TO BE #5 (#16) SPACED @ 6" (150) ± UNLESS NOTED OTHERWISE.
 5. MINIMUM BAR COVER = 1/2" (38).



**DELAWARE
DEPARTMENT OF TRANSPORTATION**

DOUBLE INLET COVER SLAB DETAILS

STANDARD NO. **D-5 (2002)** SHT. **5** OF **8**

APPROVED *Carsten Wicks* 9/6/02
CHIEF ENGINEER DATE
 RECOMMENDED *Thurston Phelps* 8/19/02
DESIGN ENGINEER DATE