

TYPICAL SECTION (BASES 5 AND 6)

POLE BASE DATA CHART				
POLE BASE TYPE *	DIAMETER	DEPTH *	#4 (#13) HORIZONTAL REINFORCING BARS	#8 (#25) VERTICAL REINFORCING BARS
1	36" (915)	7' (2150)	5	8
2	36" (915)	10' (3050)	6	8
2A	48" (1220)	8' (2450)	5	8
2B	60" (1525)	7' (2150)	5	8
3	48" (1220)	10' (3050)	6	8
3A	60" (1525)	9' (2750)	6	8
3B	72" (1830)	7' (2150)	5	8
4	24" (610)	2'-4" (725)	NONE	NONE
5	36" (915)	4' (1225)	NONE	NONE
6	24" (610)	6' (1850)	4	8
7	48" (1220)	13'-4" (4000)	7	8

* - ADDITIONAL DEPTH FOR POLE BASE EXTENSION, IF REQUIRED, TO BE DETERMINED BY TRAFFIC ENGINEERING AND MANAGEMENT (TEAM) FIELD REPRESENTATIVE.

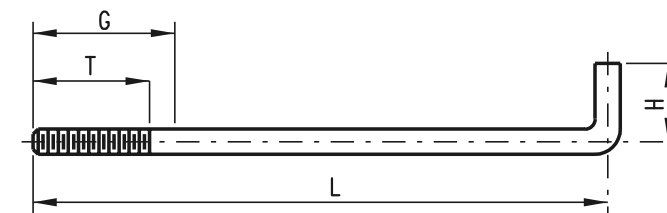

G = GALVANIZED PORTION
 T = THREAD LENGTH
 L = LENGTH OF ROD
 H = HEIGHT OF ROD

NOMINAL BOLT SIZE	L	H	T	G
1" (25) X 40" (1025)	36" (925)	4" (100)	6" (150)	8" (200)
1 1/4" (32) X 48" (1225)	42" (1075)	6" (150)	8" (200)	10" (250)
1 1/2" (38) X 60" (1525)	54" (1375)	6" (150)	10" (250)	12" (305)
1 3/4" (45) X 90" (2285)	84" (2135)	6" (150)	10" (250)	20" (500)
2" (51) X 90" (2285)	82" (2085)	8" (200)	8" (200)	18" (455)

ANCHOR BOLT DATA CHART AND DETAILS

NOTE: ANCHOR BOLTS FOR POLE BASE TYPE 7 SHALL CONFORM TO THE CCTV POLE MANUFACTURER'S SPECIFICATIONS.

PLAN SYMBOL



DELAWARE
 DEPARTMENT OF TRANSPORTATION

POLE BASES		APPROVED	DATE
STANDARD NO. T-5 (2002)	SHT. 3 OF 3	<i>Caution Wicks</i> CHIEF ENGINEER	9/6/02
		RECOMMENDED <i>Theresa Delgado</i> DESIGN ENGINEER	9/19/02