

**TYPE A**

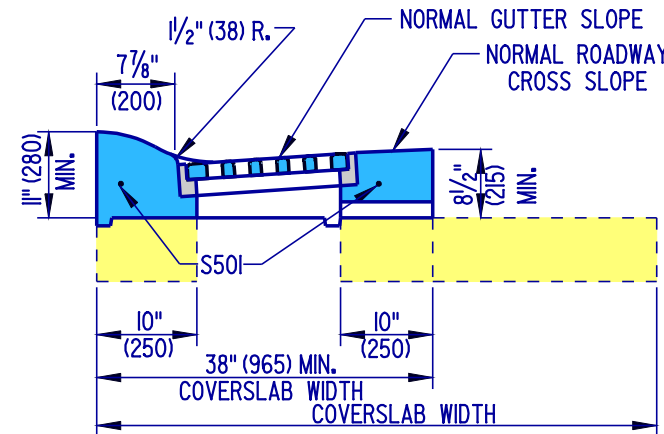

**TYPE D**

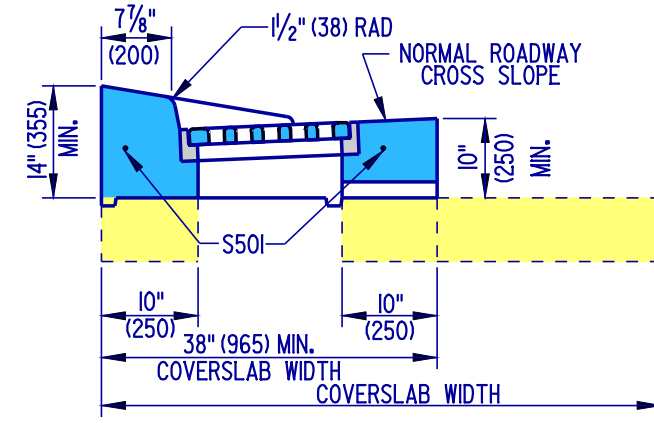

**TYPE E**

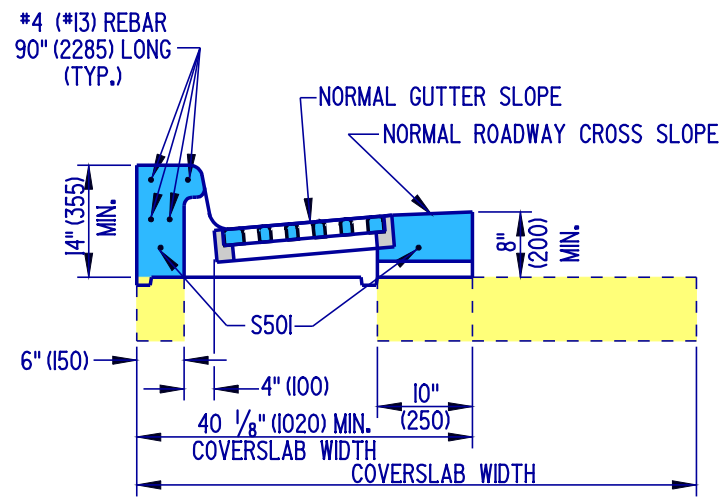

**TYPE B**

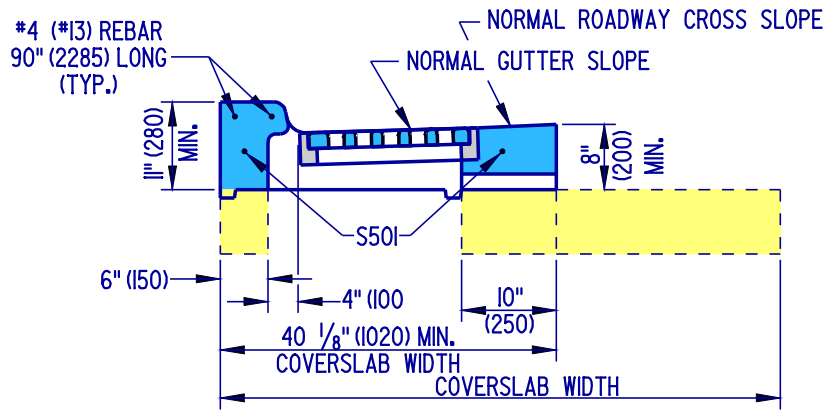

**TYPE C**

INLET TOP UNIT APPLICATIONS	
TOP UNIT	CURB
TYPE A	USE IN DRAINAGE SWALE
TYPE B	INTEGRAL PCC CURB & GUTTER, TYPE 1 & 3, PCC CURB TYPE 1
TYPE C	INTEGRAL PCC CURB & GUTTER, TYPE 4, PCC CURB TYPE 3
TYPE D	INTEGRAL PCC CURB & GUTTER, TYPE 2
TYPE E	PCC CURB TYPE 2

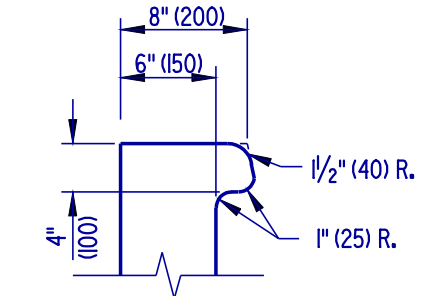

**CURB OPENING DETAIL**

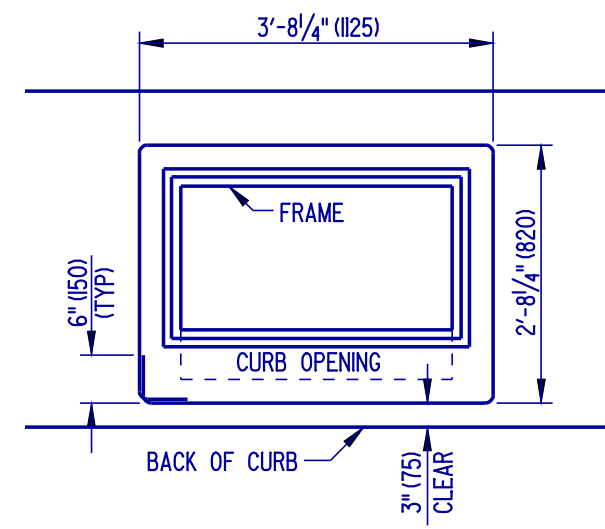

**S501 BENDING DIAGRAM**

S501 IS NOT REQUIRED TO BE ONE CONTINUOUS BAR. IF MORE THAN ONE BAR IS USED, THERE MUST BE A 12" (300) OVERLAP BETWEEN BARS.

**DRAINAGE INLET TOP UNITS**

NOTE: TOP UNIT IS TO BE CAST-IN-PLACE TO GRADE AS SPECIFIED ON PLAN SHEETS OR AS DIRECTED BY ENGINEER.

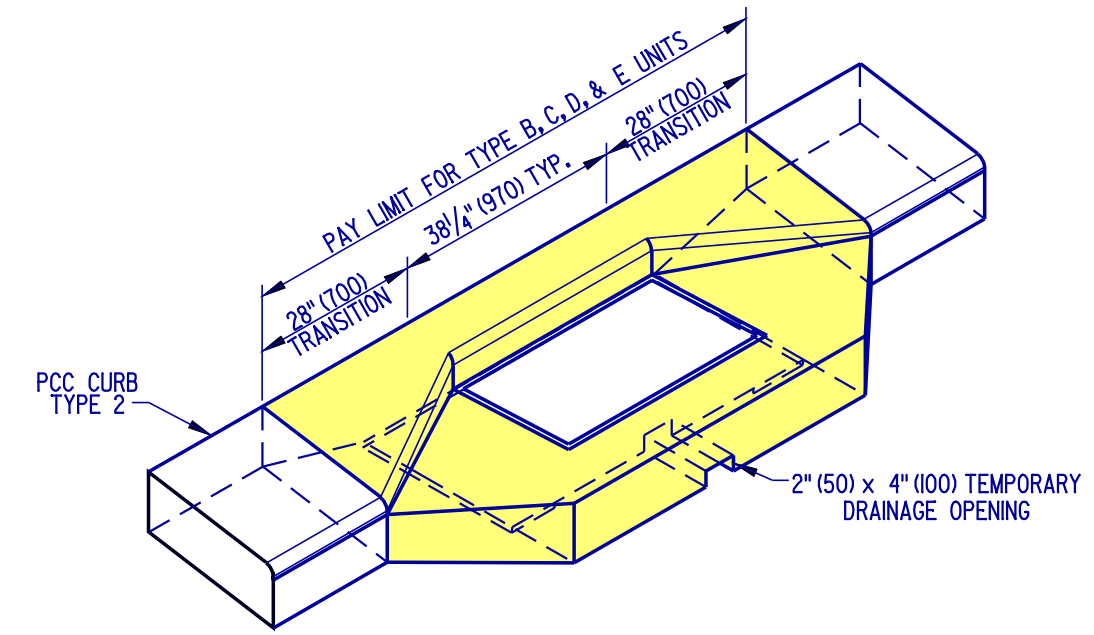

**ISOMETRIC VIEW**

TYPE E UNIT SHOWN



**DELAWARE DEPARTMENT OF TRANSPORTATION**

**DRAINAGE INLET DETAILS**  
 STANDARD NO. **D-5 (2004)** SHT. **3** OF **8**

APPROVED *Carolann Wicks* 1/10/05  
 CHIEF ENGINEER DATE  
 RECOMMENDED *Dennis M. O'Flaherty* 1/13/05  
 DESIGN ENGINEER DATE