

**TYPE A**

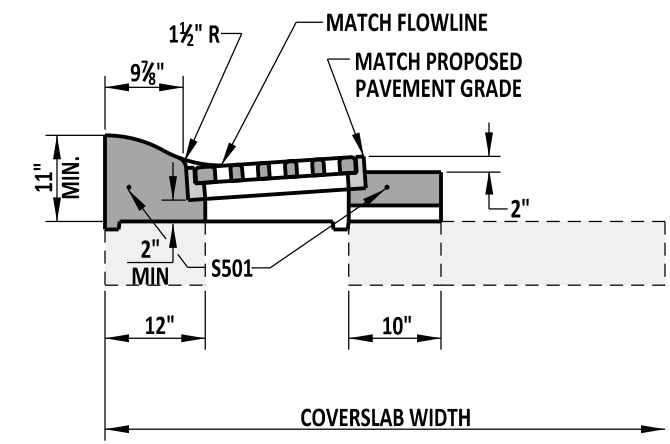

**TYPE D**

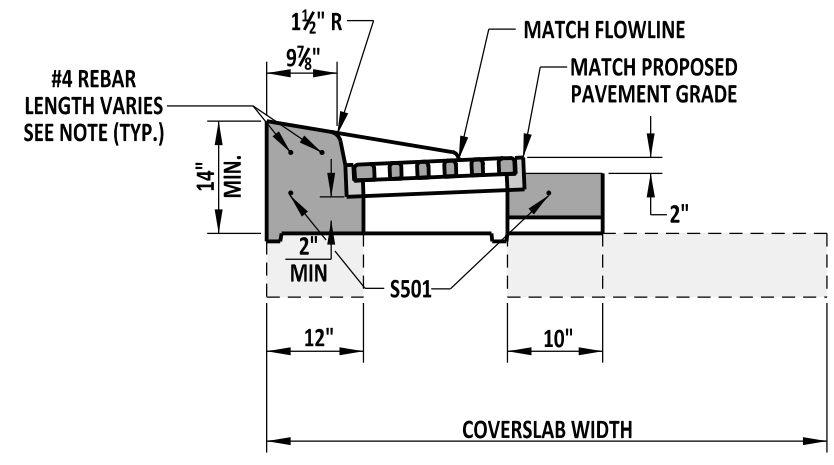

**TYPE E**

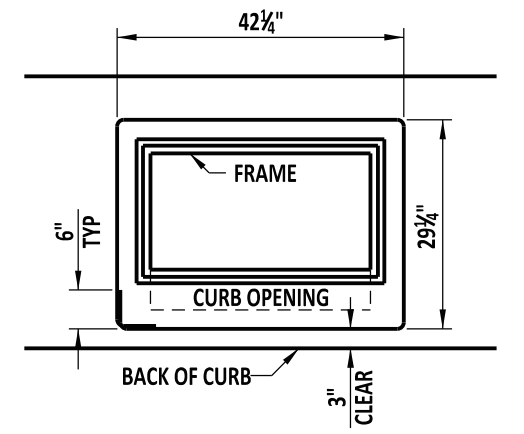

**S501 BENDING DIAGRAM**

S501 IS NOT REQUIRED TO BE ONE CONTINUOUS BAR. IF MORE THAN ONE BAR IS USED, THERE MUST BE A 12" OVERLAP BETWEEN BARS.

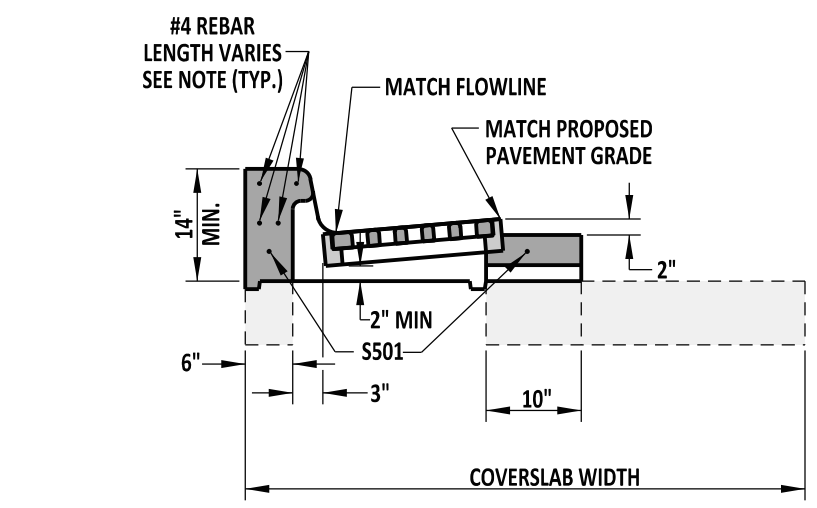

**TYPE B**

SEE CURB OPENING DETAIL ON THIS SHEET

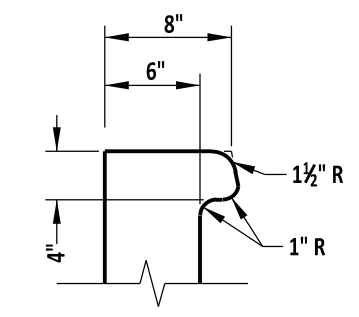

**CURB OPENING DETAIL**

INLET TOP UNIT APPLICATIONS	
TOP UNIT	CURB
TYPE A	USE IN DRAINAGE SWALE
TYPE B	INTEGRAL P.C.C. CURB & GUTTER, TYPE 1-8 & 3-8, PCC CURB TYPE 1-8
TYPE C	INTEGRAL P.C.C. CURB & GUTTER, TYPES 1-6, 3-6, 1-4, 3-4, 1-2 AND 3-2 AND PCC CURB TYPE 1-6, 1-4, AND 1-2.
TYPE D	INTEGRAL PCC CURB & GUTTER, TYPE 2
TYPE E	PCC CURB TYPE 2

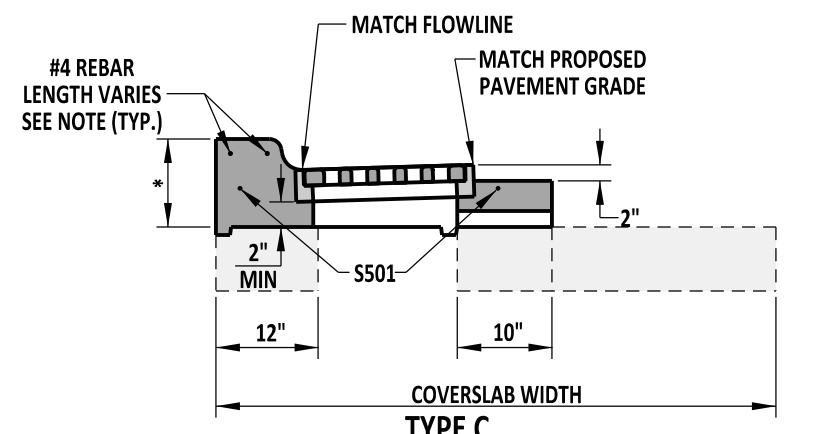

**TYPE C**

\* - THIS DIMENSION VARIES BASED ON THE HEIGHT OF THE CURB AND GUTTER OR CURB USED:  
 - INTEGRAL P.C.C. CURB AND GUTTER, TYPES 1-6 AND 3-6 & CURB, TYPE 1-6 - 12" MIN.  
 - INTEGRAL P.C.C. CURB AND GUTTER, TYPES 1-4 AND 3-4 & CURB, TYPE 1-4 - 10" MIN.  
 - INTEGRAL P.C.C. CURB AND GUTTER, TYPES 1-2 AND 3-2 & CURB, TYPE 1-2 - 8" MIN.

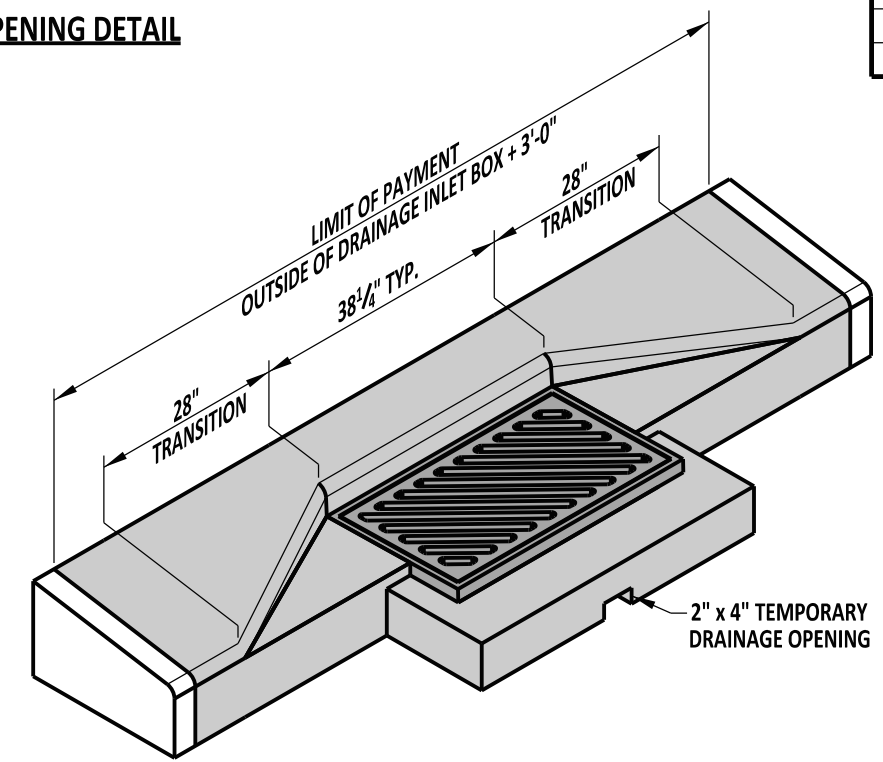

**ISOMETRIC VIEW**  
TYPE E UNIT SHOWN

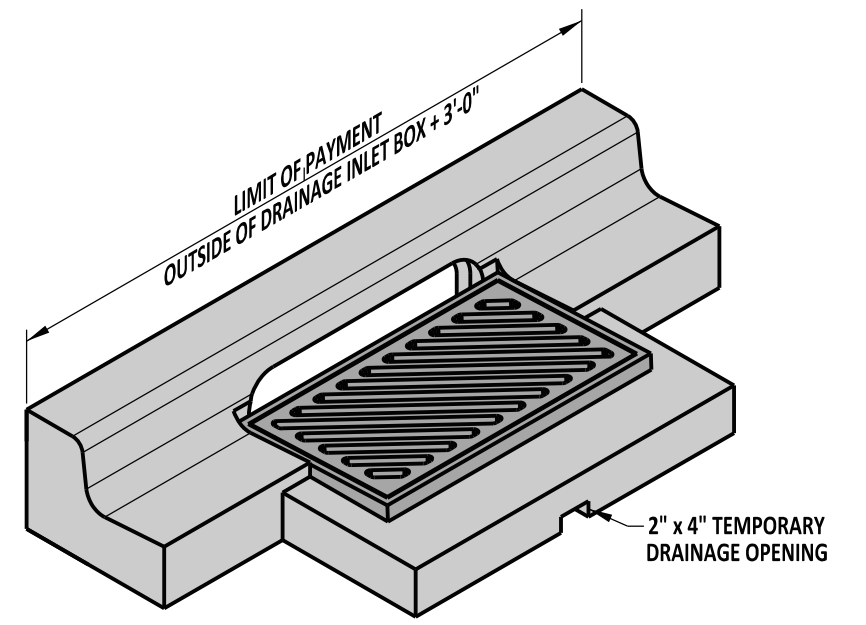

**ISOMETRIC VIEW**  
TYPE B TOP UNIT SHOWN WITH INTEGRAL CURB & GUTTER TYPE 3

NOTE: LENGTH OF #4 REBAR SHALL BE THE OUTSIDE OF THE DRAINAGE INLET BOX PLUS 2'-9".

<p><b>DELAWARE</b> DEPARTMENT OF TRANSPORTATION</p>	<b>DRAINAGE INLET TOP UNITS</b>				<b>APPROVED</b>	SIGNATURE ON FILE <small>CHIEF ENGINEER</small>	01/07/2013 <small>DATE</small>
	STANDARD NO.	D-5 (2012)	SHT.	3 OF 9	<b>RECOMMENDED</b>	SIGNATURE ON FILE <small>DESIGN ENGINEER</small>	12/20/2012 <small>DATE</small>