

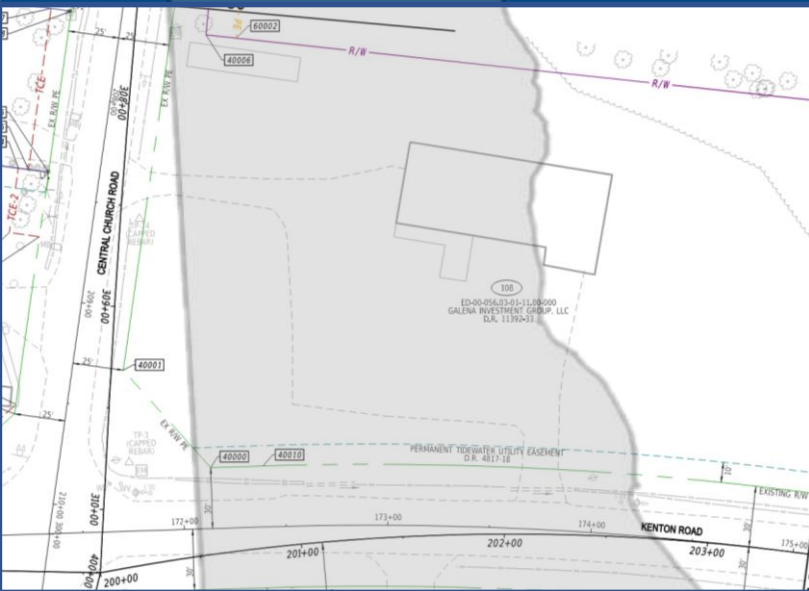

RIGHT-OF-WAY ENGINEERING MANUAL

2023 EDITION



ASSESSMENT NUMBER		OWNERSHIP OF RECORD						TYPE OF ACQUISITION	TITLE SOURCE	PARCEL AREA (ACRES)	PAGE NUMBER
ED-00-056.03-01-11.00-000		(108) GALENA INVESTMENT GROUP, LLC						R/W	D.R. 11392-33	C - 6.19	9
PT. NO.	ALIGN. NO.	STATION	OFFSET*	NORTH	EAST	BEARING	DISTANCE	CHORD BEARING	CHORD LENGTH	ARC LENGTH	RADIUS**
40000	P_BL_N_Kenton	200+60.70	-42.44	434256.3149	605500.3843	S 76°58'24.36" W	64.386				
40001	P_BL_N_Kenton	200+27.35	-96.17	434193.5858	605485.8715	S 27°03'13.55" W	509.010				
40002	P_BL_N_Kenton	201+33.65	-647.63	433934.7852	604979.1228	S 56°17'39.37" E	10.068				
40003	P_BL_N_Kenton	201+39.92	-646.77	433943.1606	604973.5360	N 27°03'13.55" E	125.865				
40004	P_BL_N_Kenton	201+23.18	-523.57	434000.4071	605085.6285			N 28°34'20.41" E	275.345	275.378	-5195.000
40006	P_BL_N_Kenton	200+81.57	-254.05	434132.0959	605327.4406	S 61°04'39.37" E	399.379				
40007	P_BL_N_Kenton	204+13.22	-225.49	434481.6625	605134.2912	N 28°55'20.63" E	195.930				
40008	P_BL_N_Kenton	204+25.37	-30.00	434576.4191	605305.7840			N 59°06'56.01" W	349.004	349.693	-1607.022
40010	P_BL_N_Kenton	200+85.40	-40.15	434276.5025	605484.9306	N 53°06'24.82" W	25.742				
40000	P_BL_N_Kenton	200+60.70	-42.44	434256.3149	605500.3843						

FIGURE 1082 AREA = 86868.898 SQ. FT. (1.99 ACRES).
REMAINING AREA = 182680.382 SQ. FT. (4.19 ACRES)
CUMULATIVE REMAINING AREA = 182680.382 SQ.FT (4.19 ACRES)
DEED RECORD OF ACQUISITION:
REMARKS: 3802.89 SF TIDEWATER UTILITY EASEMENT PER D.R. 4817-18; 31 PARKING SPACES IMPACTED