

**APPENDIX A**  
**CULTURAL RESOURCE SURVEY FORMS**

CULTURAL RESOURCE SURVEY  
LOCUS IDENTIFICATION FORM

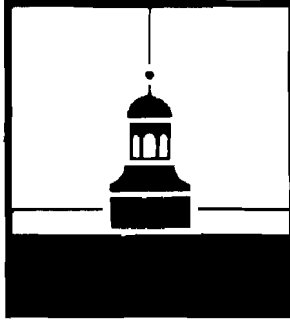

FORM CRS-3

FOR OFFICE USE ONLY

DELAWARE BUREAU OF  
ARCHAEOLOGY AND HISTORIC  
PRESERVATION  
HALL OF RECORDS  
DOVER, DELAWARE 19901  
(302) 678-5314

CRS # N-11711  
Quad Newark East  
SPO map # 08-09-33  
Hundred White Clay Cr.  
DOCUMENT 20-06/78/047

1. NAME OF LOCUS: Jonathan Davis Farmstead (AGCX)
2. STREET LOCATION: DE Route 7, south of Faith City Medical Center
3. OWNER'S NAME: Thomas Clough TEL. # \_\_\_\_\_  
ADDRESS: \_\_\_\_\_
4. TYPE OF LOCUS: a) structure \_\_\_\_\_ b) district \_\_\_\_\_ c) archaeological site \_\_\_\_\_  
d) other agricultural complex
5. SURROUNDINGS OF LOCUS: (check more than one if necessary)  
a) fallow field X b) cultivated field \_\_\_\_\_ c) woodland \_\_\_\_\_  
d) scattered buildings X e) densely built up \_\_\_\_\_ f) other \_\_\_\_\_
6. THREATS TO LOCUS: (check more than one if necessary)  
a) none known \_\_\_\_\_ b) zoning \_\_\_\_\_ c) roads \_\_\_\_\_ d) developers \_\_\_\_\_  
e) deterioration X f) other \_\_\_\_\_
7. REPRESENTATION ON OTHER SURVEYS:  
TITLE: \_\_\_\_\_ # \_\_\_\_\_  
TITLE: \_\_\_\_\_ # \_\_\_\_\_  
TITLE: \_\_\_\_\_ # \_\_\_\_\_
8. YOUR NAME: M.H. Bowers TEL. # 201/678-1960  
YOUR ADDRESS: 100 Halsted Street, East Orange, New Jersey  
ORGANIZATION (if any) Louis Berger & Associates, Inc. DATE: Jan. 1987

USE BLACK INK ONLY

## 8. SKETCH MAP

Please indicate position of locus in relation to geographical landmarks such as streams and roads.

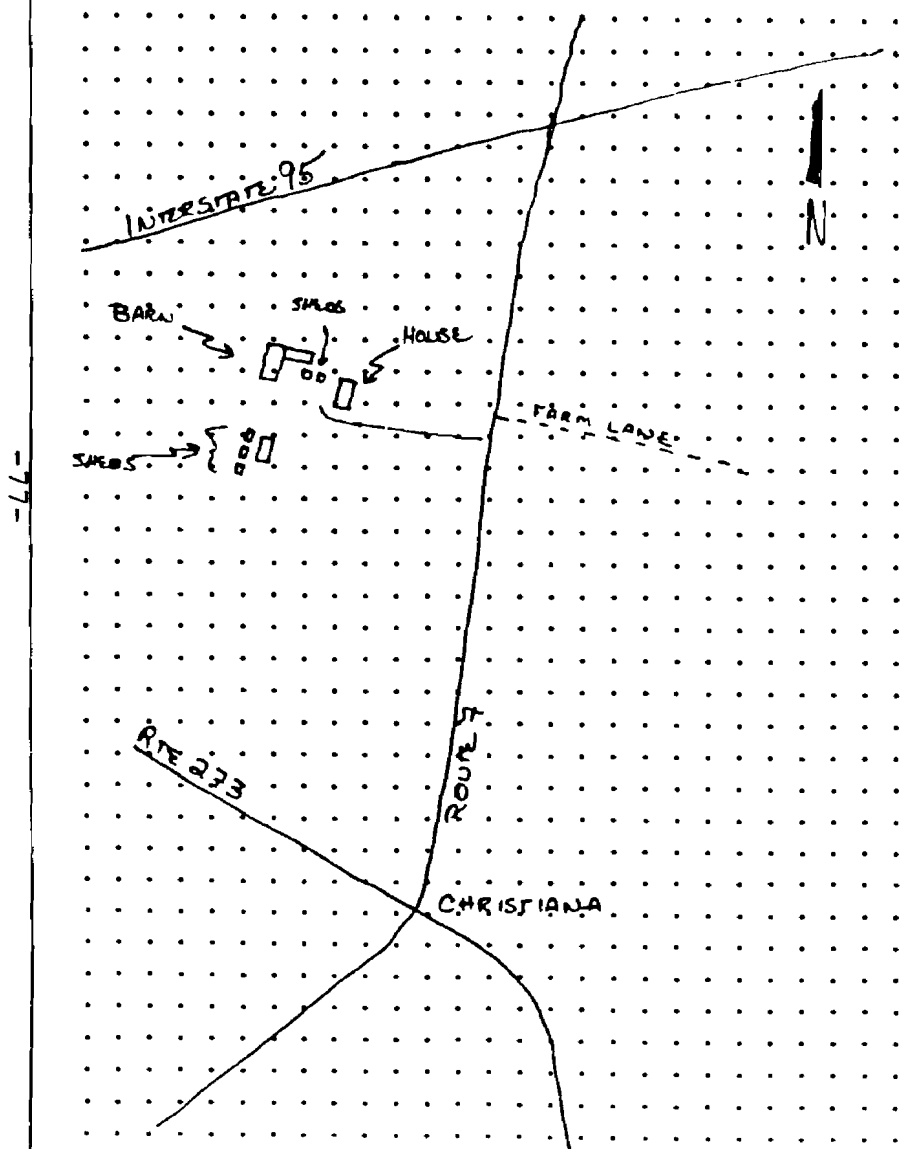

INDICATE NORTH ON SKETCH

USE BLACK INK ONLY

## 9. COMMENTS:

Consider the following:

- relationship to setting
- associated traditions or stories
- noteworthy features
- comparison with others in area

This former farmstead includes a dwelling, barn with attached machine shed, and several small sheds, most of which (including the barn) are in ruinous condition. The frame house is of the I-type, three bays wide with a centered gabled wall dormer--a treatment common to other dwellings of its kind and age in this area of Delaware. Based on historic maps of the area, construction of the house and barn is attributed to Jonathan Davis, who is shown as owner of the farm on Hopkins (1881) and Baist (1893)

## 10. Comprehensive Planning:

- Time Period(s) 1880-1940
- Cultural Concept Architecture and Building

## 11. Evaluation:

- Settlement & Development
- Cultural Historic & Ethnic Issues
- Built Environment
- Material Culture
- e. not eligible

Survey: Name/Title \_\_\_\_\_

Date \_\_\_\_\_

BAHP: Name/Title \_\_\_\_\_

Date \_\_\_\_\_

CULTURAL RESOURCE SURVEY  
STRUCTURAL DATA FORM

DELAWARE BUREAU OF  
ARCHAEOLOGY AND HISTORIC  
PRESERVATION  
HALL OF RECORDS  
DOVER, DELAWARE 19901  
(302) 678-5314

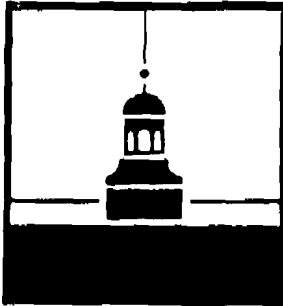

Form CRS-1  
FOR OFFICE USE ONLY

CRS # N-11711  
Quad Newark East  
SPO map # 08-09-33  
Hundred White Clay Cr.  
DOCUMENT 20-06/78/08/14

1. ADDRESS OF STRUCTURE : Del. Route 7, south of I-95 and Faith City Medical Cen.

2. DESCRIBE THE STRUCTURE AS COMPLETELY AS POSSIBLE:

a) Overall shape

stories 2

bays 3

wings full-width kitchen & porch additions  
( front and rear)

b) Structural system wood frame

c) Foundation

materials fieldstone; concrete block  
basement

d) Exterior walls

materials wood and vinyl clapboarding  
color(s) brown(wood) and white (vinyl)

e) Roof

shape; materials side gable; composition shingle

cornice box; front and rear fascia have flat applied trim in vine motif

dormers wall dormer w/triangular gable centered at front

chimney location(s) south gable end, exterior, concrete block

f) Windows

spacing symmetrical

type 6/6 double hung sash

trim flat with applied half-round molding

shutters none (removed)

g) Door obscured within enclosed porch at front

spacing

type

trim

h) Porches

location(s) full length across front, fully enclosed

materials wood members w/vinyl siding

supports

trim none

i) Interior details (if accessible)

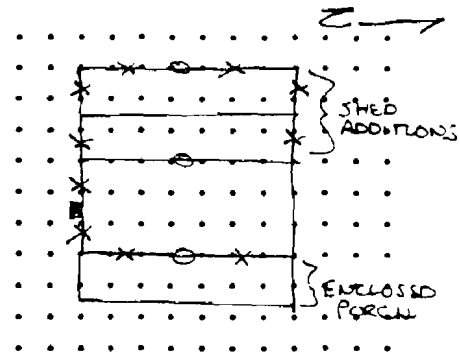

SKETCH PLAN

USE BLACK INK ONLY

3. CONDITION: good \_\_\_\_\_ deteriorated XX

remarks: barn has collapsed, most other outbuildings in ruinous condition

4. INTEGRITY: a) original site xx b) moved \_\_\_\_\_

c) if moved, when and from where \_\_\_\_\_

d) list major alterations and dates (if known) shed-roofed fully-  
enclosed porch and kitchen additions across front and rear; vinyl  
siding applied

5. DATE OF INITIAL CONSTRUCTION: c. 1875-80

6. ARCHITECT/BUILDER: \_\_\_\_\_

7. RELATED OUTBUILDINGS:

a) barn XX b) carriage house \_\_\_\_\_ c) garage \_\_\_\_\_ d) privy XX

e) shed xxx f) greenhouse \_\_\_\_\_ g) shop \_\_\_\_\_ h) gardens \_\_\_\_\_

i) icehouse \_\_\_\_\_ j) springhouse \_\_\_\_\_ k) other \_\_\_\_\_

describe: collapsed two-level "English" type barn with large machine shed  
at right angles to east

8. BRIEFLY DISCUSS THE ORIGINAL AND SUBSEQUENT USES OF THE STRUCTURE. NOTE ANY ASSOCIATIONS WITH HISTORIC EVENTS OR PERSONS:

Historic maps show this property owned by Jonathan Davis in 1881 (Hopkins) and 1893 (Baist). House appears to have been built ca. 1875-80.

9. Primary References: (include location of reference).

Hopkins, G.M. and Co., Map of New Castle County, Delaware, Philadelphia 1881.  
Baist, G. William, Atlas of the State of Delaware. Philadelphia, 1893.

10. Surveyor: M.H. Bowers Date of Form: April 1987

USE BLACK INK ONLY

For Photographs of the Davis  
Farmstead, See Plates 2 and 3.