



ALTERNATIVES / IMPACTS / WORKING GROUP RECOMMENDATIONS

113

US 113 North / South Study

May / June 2005

Milford Area - Preliminary On-Alignment Alternatives

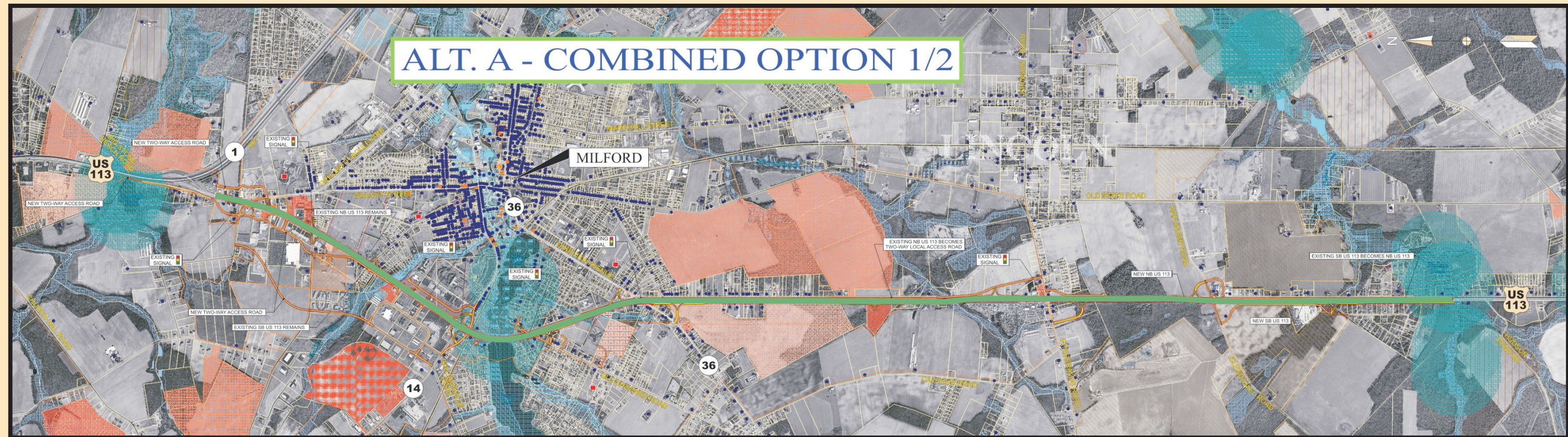



ALTERNATIVES / IMPACTS / WORKING GROUP RECOMMENDATIONS

113

US 113 North / South Study

May / June 2005

Milford Area - Preliminary On-Alignment Alternatives

OPTION 3

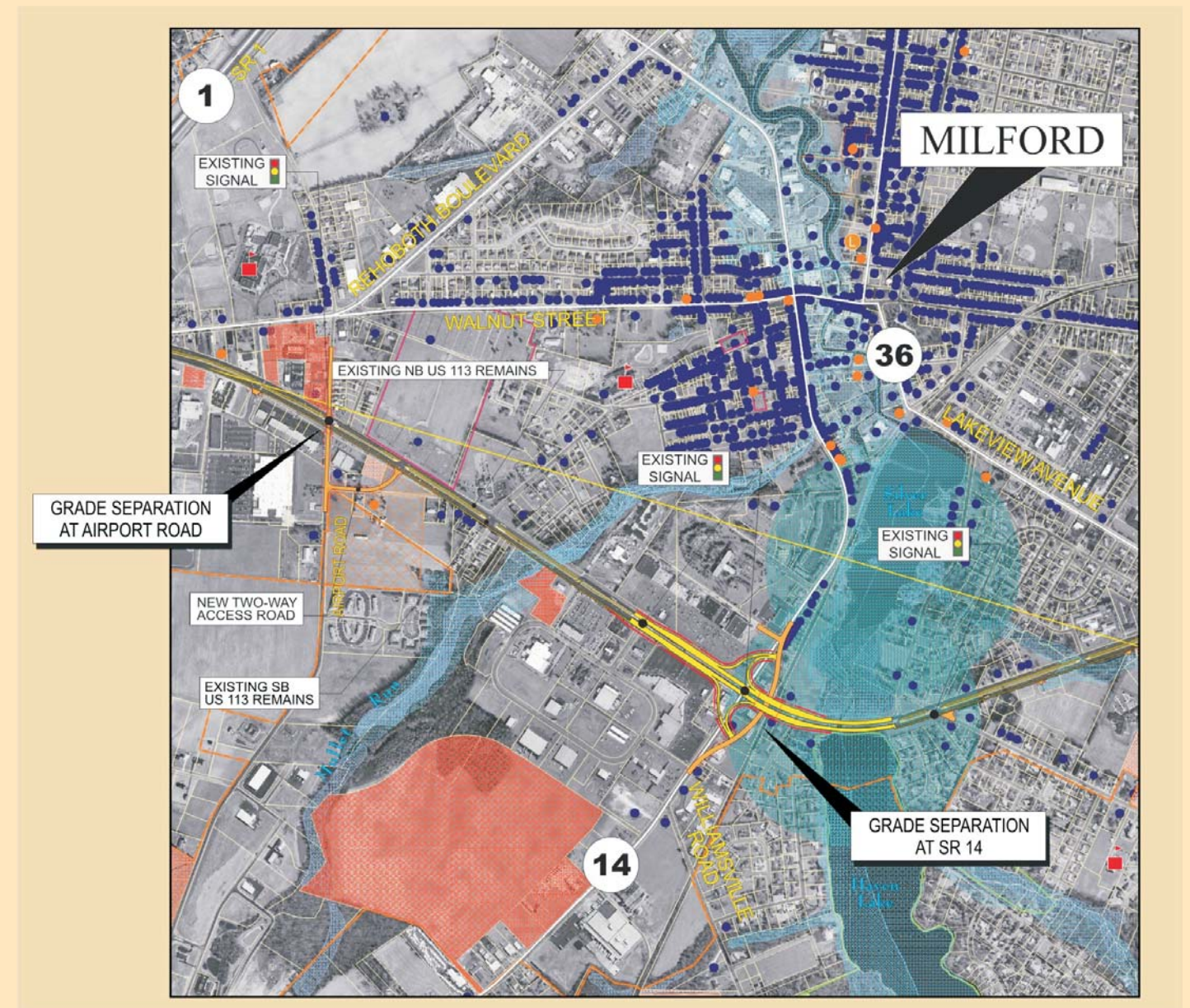
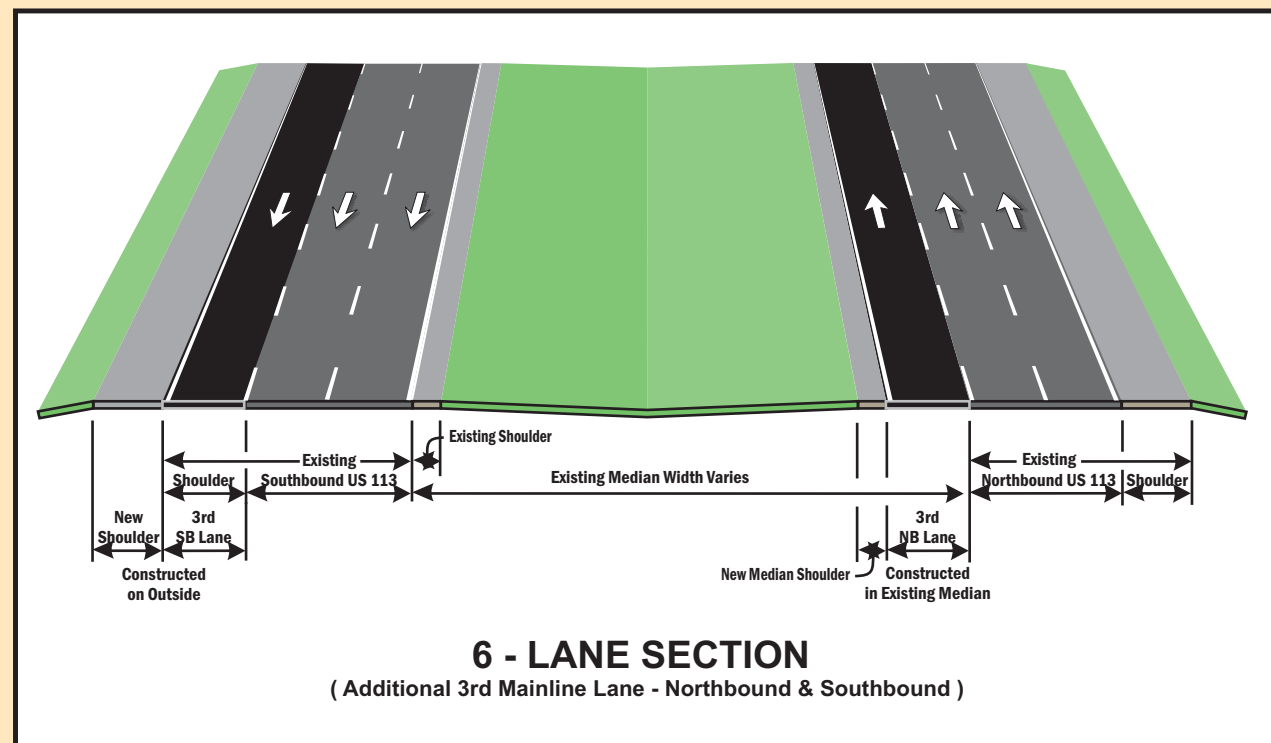

Grade Separations at Airport Road and SR 14



Milford Area - Preliminary On-Alignment Alternatives

Description of Alternatives

- **Options 1 and 2 have been combined based on public input.**
 - Full control of access along existing US 113
 - Grade separations and frontage roads used for access
- **Option 3 adds one lane in each direction at grade.**
 - Grade separations at Airport Road and SR 14
 - All other existing signals will remain
 - This option is being evaluated to determine whether it addresses purpose and need
- **Public opinions:**
 - There is little support for an on-alignment alternative, at least north of Johnson Road / Fitzgerald Road.
 - An on-alignment alternative is perceived to have negative community and economic impacts to the City of Milford.

Working Group Recommendations

ON-ALIGNMENT ALTERNATIVES

- There was consensus among the Working Group members that they do NOT support the on-alignment alternatives. However, the members recognized that the environmental resource and regulatory agencies will insist that at least one on-alignment alternative be retained for detailed study. Thus, the members stated that IF an on-alignment alternative is retained for detailed study, the alternative should be the combination of Alternatives A1 and A2 presented by the Project Team.
- There was consensus among the Working Group members to recommend to DeIDOT that Alternative A3 (the third lane option) NOT be retained for detailed study.

On-Alignment Conclusions

- Option 1/2 will be retained for further study.
- Preliminary review indicates that on-alignment option 3 does not meet long-term traffic and safety needs in the corridor.



ALTERNATIVES / IMPACTS / WORKING GROUP RECOMMENDATIONS



US 113 North / South Study

May / June 2005

Milford Area - Impact Comparison of Preliminary On-Alignment Alternatives

Engineering

Considerations	No-Build	On-Alignment Alternatives	
		A, opt. 1/2	A, opt. 3
Existing SR 1 length (miles)	4.0	4.0	4.0
Existing US 113 length (miles)	7.2	7.2	7.2
Proposed US 113 off-alignment length (miles)	0.0	0.0	0.0
Total length of alternative (miles)	11.2	11.2	11.2
Existing US 113 converted to service roads (miles)	0.0	3.3	3.3
Property Impacts			
<i>Properties affected (numbers of)</i>	0	218	135
<i>Properties affected (total acres)</i>	0	97	30
Access Rights			
<i>Denial of Access (numbers of affected properties)</i>	0	35	7
Residential		23	3
Agricultural		3	0
Commercial		9	4
Industrial		0	0
<i>Modified Access (numbers of affected properties)</i>	0	331	30
Residential		231	6
Agricultural		13	0
Commercial		72	10
Industrial		15	14

Environmental

Considerations	No-Build	On-Alignment Alternatives	
		A, opt. 1/2	A, opt. 3
Wetlands and Waters of the US			
Wetlands (acres)	0	2	0
Waters of the US (linear feet) ¹	0	1,800	400
Historic and Archeological Resources			
Number of Known Historic Buildings, Structures, Objects, and Districts	0	2	1
Number of Known Archeological Sites	0	0	0
Number of Potentially Historic Buildings, Structures, Objects, and Districts - currently being evaluated	0	17	12
Number of Potentially Significant Archeological Sites - currently being evaluated	0	2	2
Number of Cemeteries	0	3	3
Section 4(f) Properties			
Number of Publicly-Owned Parks and Recreation Areas	0	0	0
Number of Publicly-Owned Wildlife and Waterfowl Refuges	0	0	0
Number of Historic Properties - same as number of Known Historic Buildings, Structures, Objects and Districts (above)	0	2	1
Section 6(f) Properties			
Properties purchased by Land & Water Conservation Fund (LWCF) (number)	0	0	0
Area (acres)	0	0	0
Rare, Threatened and Endangered Species			
Potential Rare, Threatened and Endangered Species Areas (acres)	0	TBD	TBD
Other Considerations			
Agricultural Districts (Ten-Year) (number of properties)	0	0	0
(acres within properties)	0	0	0
Agricultural Preservation Easements (Permanent) (number of properties)	0	1	1
(acres within properties)	0	17	1
Forestland: 2002 Land Use (acres)	0	14	1
State Forest Lands	0	0	0

Note 1: Waters of the US are calculated only for the Sussex County portions of all alternatives.