

DRAFT

**BEGIN
CONTRACT T200911302
STATION 848+00**

Type of Curve = Symmetric Parabola
 Direction = Sag
 Length = 950.00'
 L1 = 475.00'
 L2 = 475.00'
 G1 = 0.44%
 G2 = 2.80%
 SSD = 2174.72'
 K = 403.10

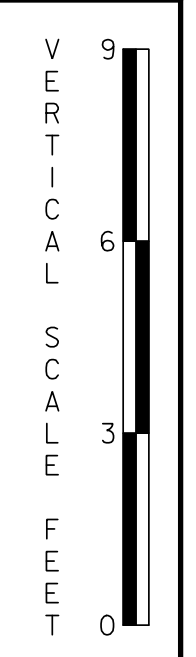
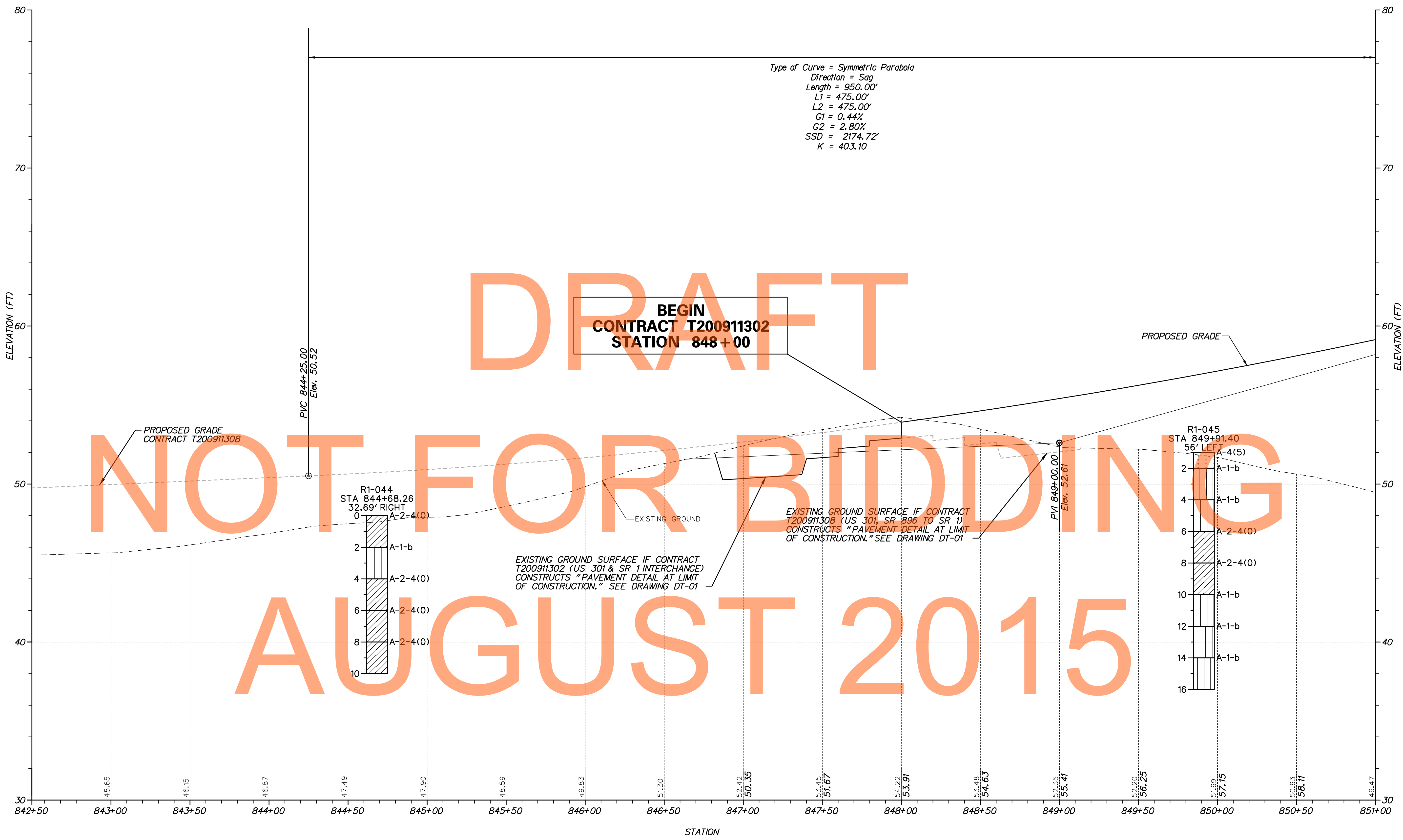

NOTE:
BORINGS ARE PROVIDED FOR INFORMATIONAL PURPOSES ONLY.
MATERIALS ENCOUNTERED MAY NOT CORRESPOND TO BORING DATA PROVIDED HEREIN.

P:\2009\11302\11302.dwg
 2/27/2013 3:56:09 PM



| ADDENDUMS / REVISIONS | |
|-----------------------|--|
| | |
| | |
| | |

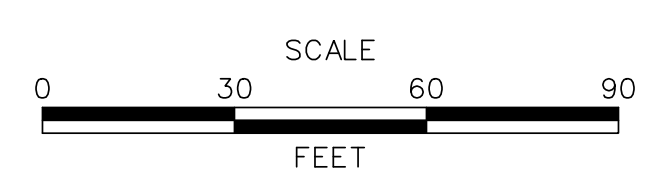

**US 301 &
SR 1 INTERCHANGE**

| | |
|------------------------|---------------------|
| CONTRACT T200911302 | BRIDGE NO. |
| COUNTY NEW CASTLE | DESIGNED BY: S.E.S. |
| | CHECKED BY: B.R.T. |

| | |
|-----------------|--------------------|
| PROFILES | SHEET NO. 49 |
| | TOTAL SHTS. 491 |

PF-01

Direction = Sag
 Length = 950.00'
 L1 = 475.00'
 L2 = 475.00'
 G1 = 0.44%
 G2 = 2.80%
 SSD = 2174.72'
 K = 403.10

BRIDGE 1-433

Type of Curve = Symmetric Parabola
 Direction = Crest
 Length = 1010.00'
 L1 = 505.00'
 L2 = 505.00'
 G1 = 2.80%
 G2 = -3.53%
 SSD = 587.12'
 K = 159.71

DRAFT
 NOT FOR BIDDING
 AUGUST 2015

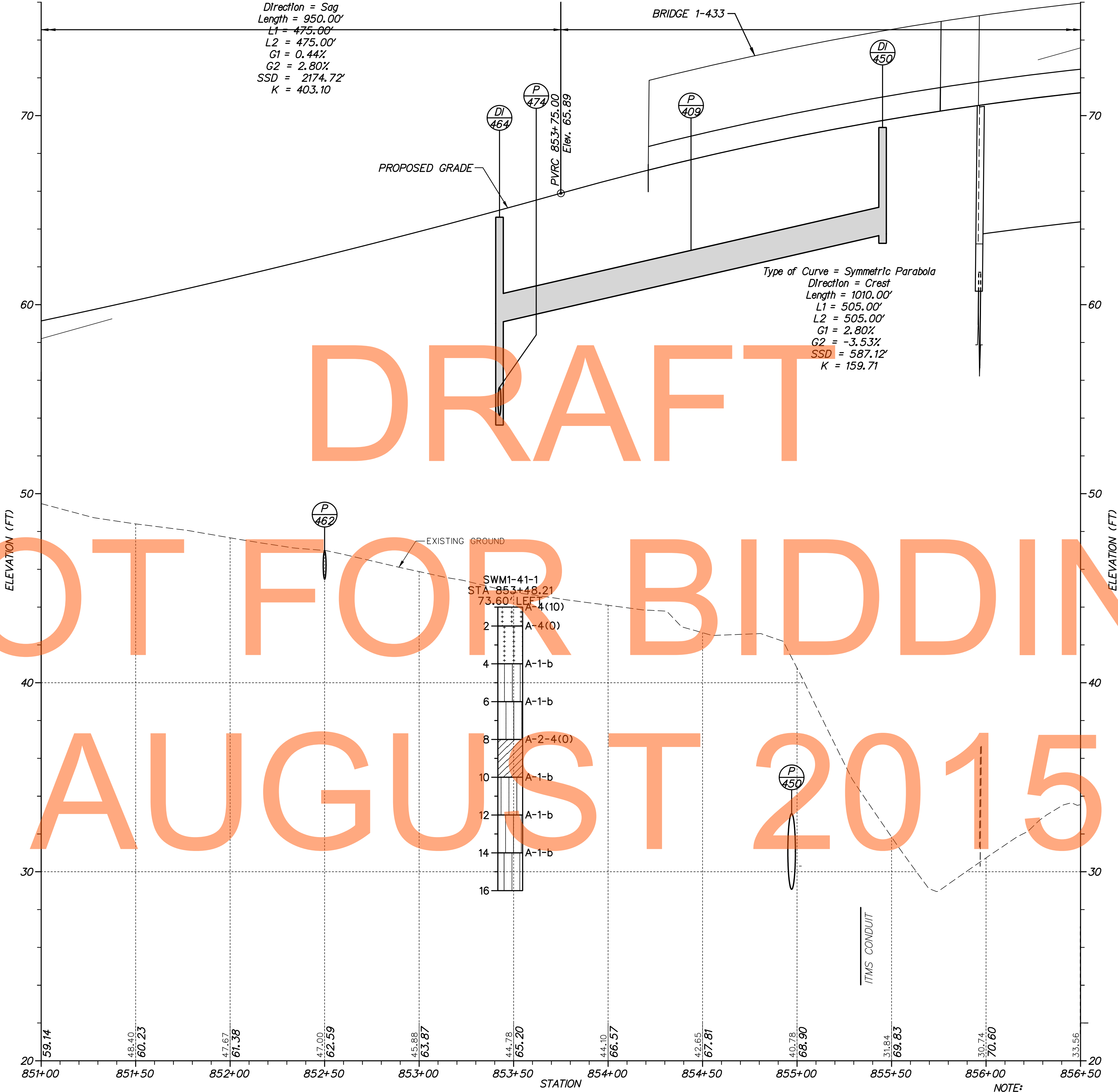

US 301 - NORTHBOUND

NOTE:
 BORINGS ARE PROVIDED FOR INFORMATIONAL PURPOSES ONLY.
 MATERIALS ENCOUNTERED MAY NOT CORRESPOND TO BORING DATA PROVIDED HEREIN.



ADDENDUMS / REVISIONS

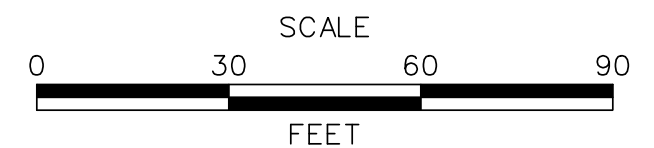

**US 301 &
SR 1 INTERCHANGE**

| | |
|------------|---------------------|
| CONTRACT | BRIDGE NO. |
| T200911302 | DESIGNED BY: S.E.S. |
| COUNTY | CHECKED BY: B.R.T. |
| NEW CASTLE | |

PROFILES

VERTICAL SCALE FEET

| | |
|-------|-------------|
| PF-02 | SHEET NO. |
| | 50 |
| | TOTAL SHTS. |
| | 491 |

P:\2009\11302\11302\11302.dwg
 2/27/2015 3:57:07 PM

DRAFT
NOT FOR BIDDING
AUGUST 2015

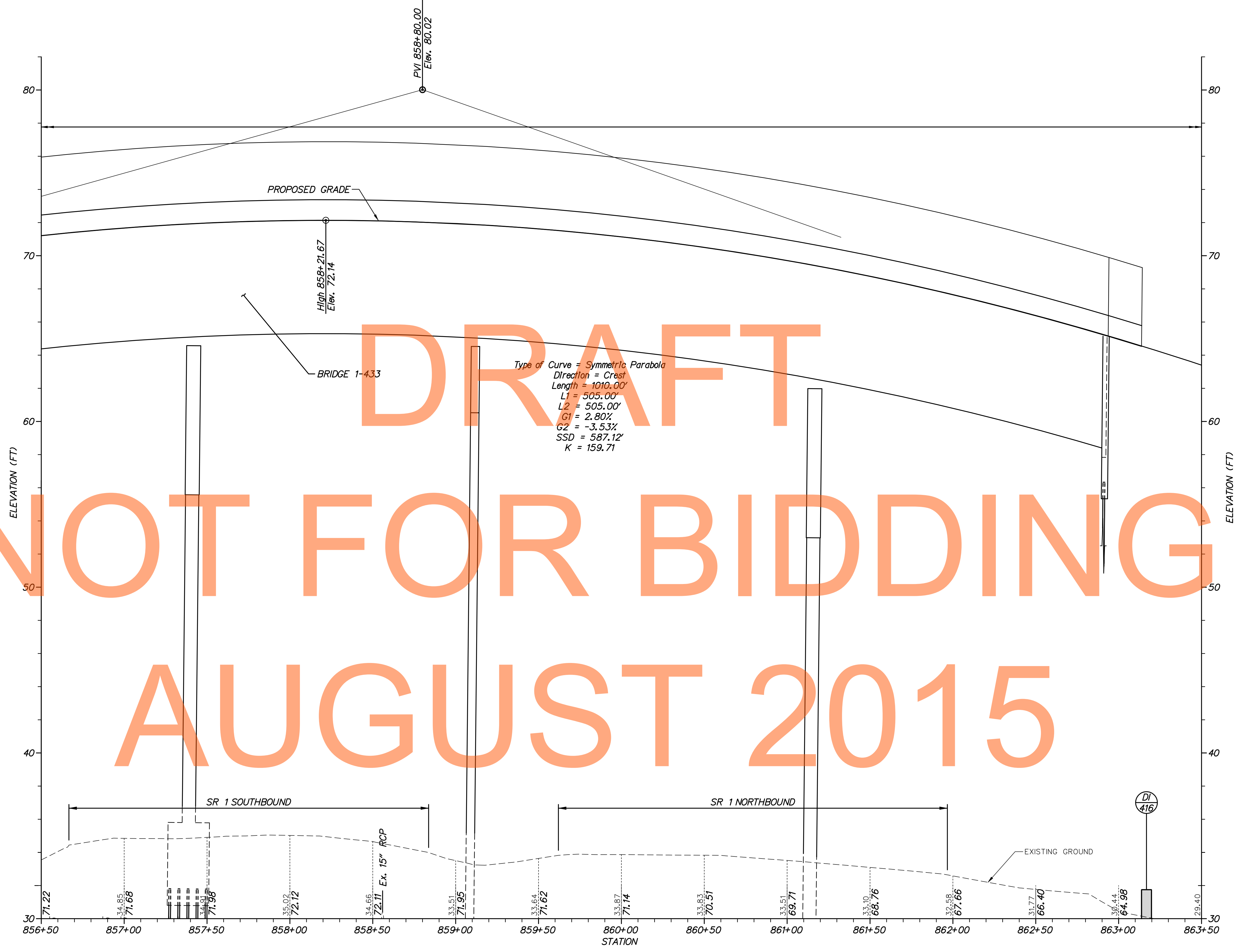

US 301 - NORTHBOUND

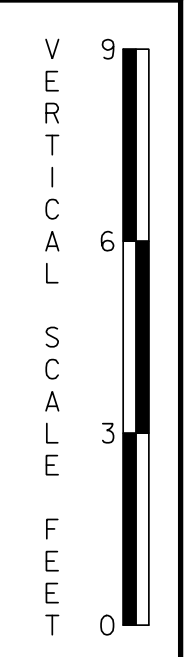

PF-03

| | |
|-------------|-----|
| SHEET NO. | 51 |
| TOTAL SHTS. | 491 |



| ADDENDUMS / REVISIONS | |
|-----------------------|--|
| | |
| | |
| | |

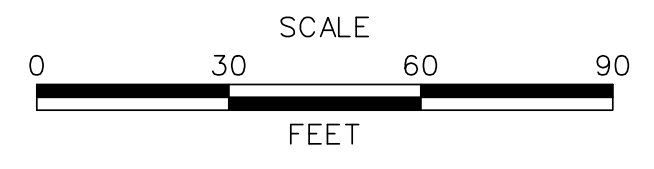

**US 301 &
SR 1 INTERCHANGE**

| | | | |
|----------|------------|--------------|--------|
| CONTRACT | T200911302 | BRIDGE NO. | |
| COUNTY | NEW CASTLE | DESIGNED BY: | S.E.S. |
| | | CHECKED BY: | B.R.T. |

PROFILES

P:\2009\11302\11302.dwg
 2/2/2015 3:57:15 PM

DRAFT

NOT FOR BIDDING

AUGUST 2015

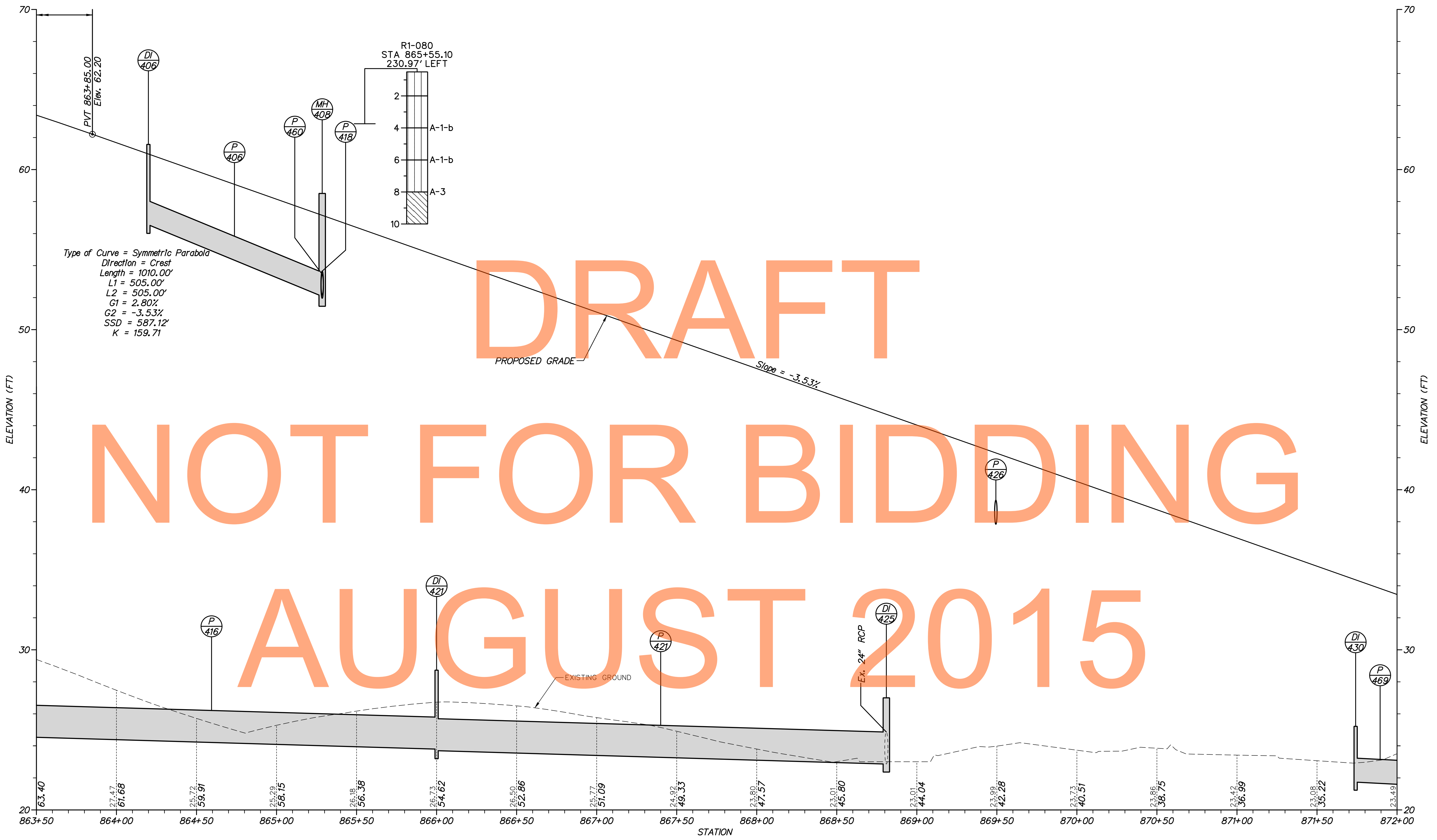

US 301 - NORTHBOUND

NOTE:
BORINGS ARE PROVIDED FOR INFORMATIONAL PURPOSES ONLY.
MATERIALS ENCOUNTERED MAY NOT CORRESPOND TO BORING DATA PROVIDED HEREIN.

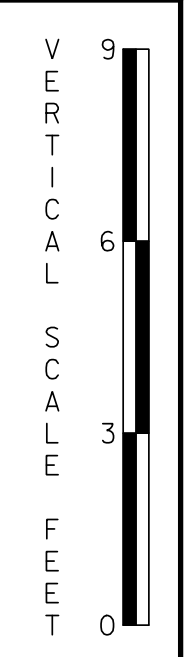

P:\2009\11302\SR1\Drawings\Profile\PF04\US301_NORTHBOUND.dwg
 2/27/2015 3:57:28 PM



| ADDENDUMS / REVISIONS | |
|-----------------------|--|
| | |
| | |
| | |

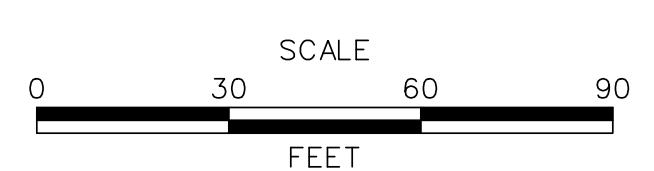

**US 301 &
SR 1 INTERCHANGE**

| | |
|------------------------|---------------------|
| CONTRACT T200911302 | BRIDGE NO. |
| COUNTY NEW CASTLE | DESIGNED BY: S.E.S. |
| | CHECKED BY: B.R.T. |

| | |
|-----------------|--------------------|
| PROFILES | SHEET NO. 52 |
| | TOTAL SHTS. 491 |

PF-04

Type of Curve = Symmetric Parabola
 Direction = Sag
 Length = 530.00'
 L1 = 265.00'
 L2 = 265.00'
 G1 = -3.53%
 G2 = 0.35%
 SSD = 576.81'
 K = 136.64

Type of Curve = Symmetric Parabola
 Direction = Crest
 Length = 500.00'
 L1 = 250.00'
 L2 = 250.00'
 G1 = 0.35%
 G2 = -1.78%
 SSD = 756.67'
 K = 234.76

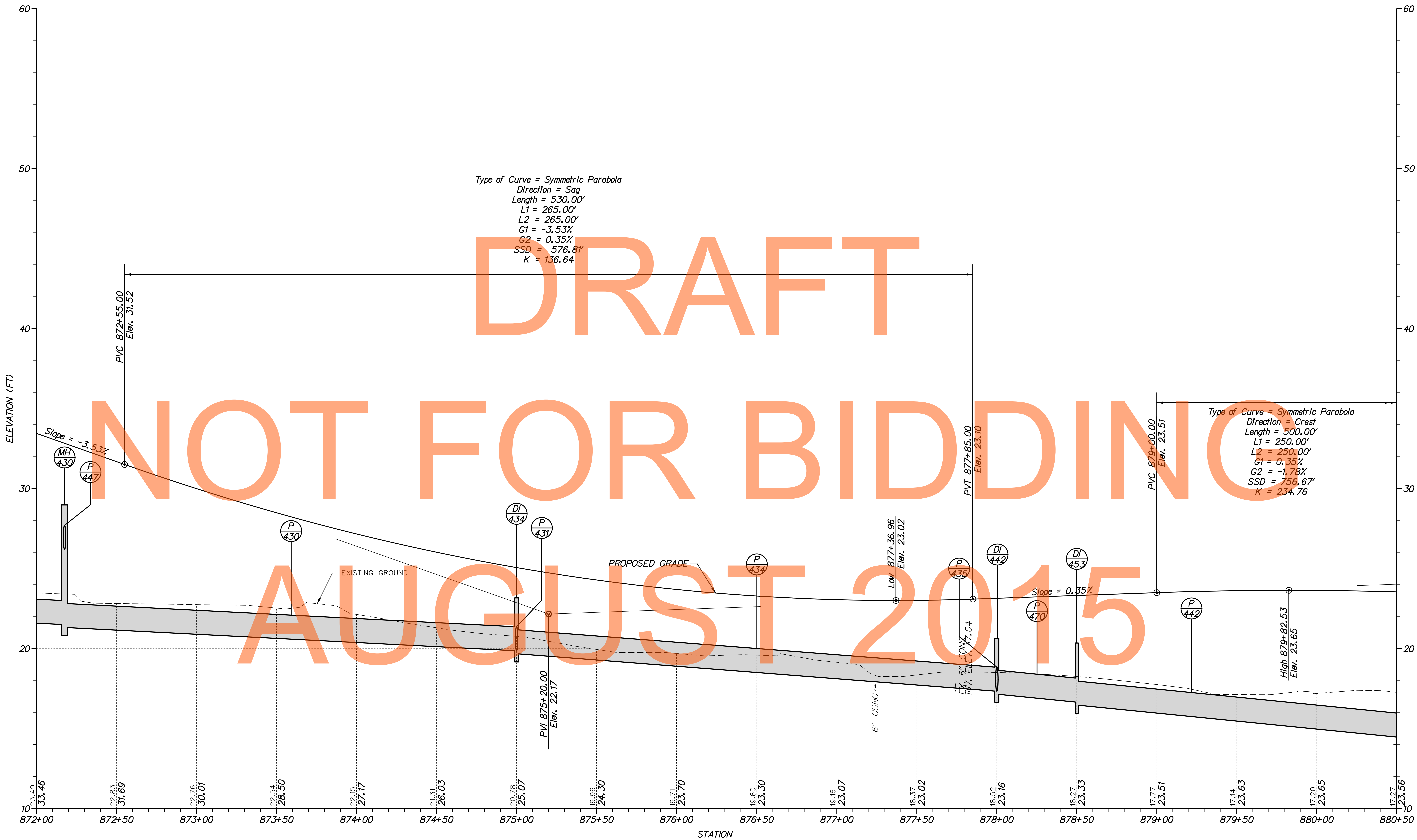

DRAFT

NOT FOR BIDDING

AUGUST 2015

US 301 - NORTHBOUND

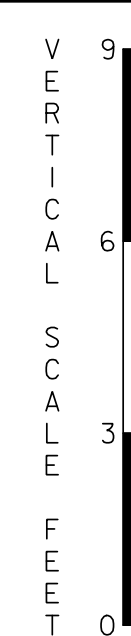

PF-05



ADDENDUMS / REVISIONS

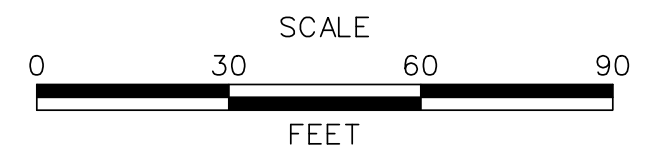

US 301 & SR 1 INTERCHANGE

| | |
|------------------------|---------------------|
| CONTRACT T200911302 | BRIDGE NO. |
| COUNTY NEW CASTLE | DESIGNED BY: S.E.S. |
| | CHECKED BY: B.R.T. |

PROFILES

| | |
|-------------|-----|
| SHEET NO. | 53 |
| TOTAL SHTS. | 491 |

P:\31653-000\31653.dwg
 2/27/2015 3:57:44 PM

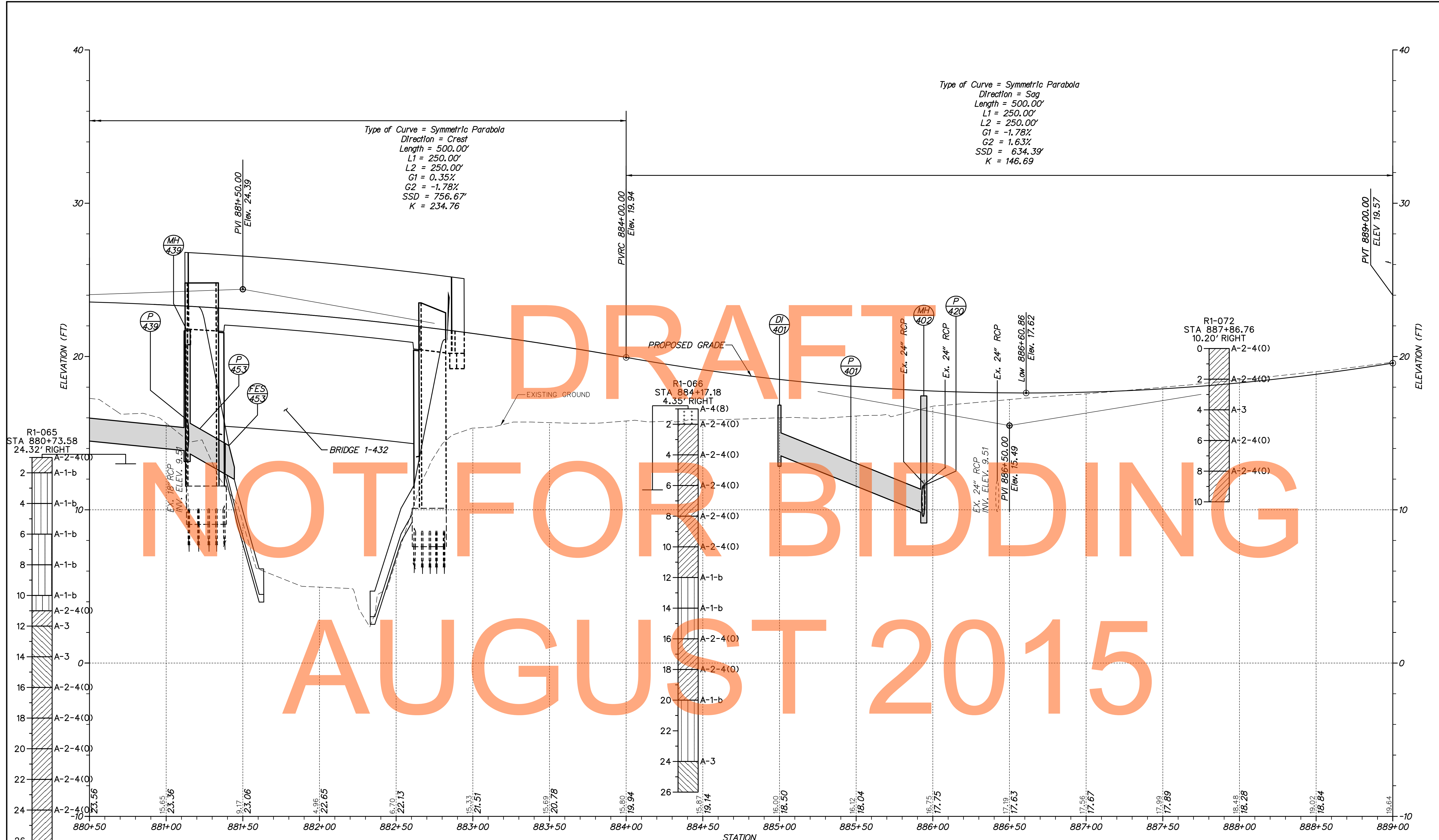

DRAFT
NOT FOR BIDDING
AUGUST 2015

US 301 - NORTHBOUND

NOTE:
ROADWAY BORINGS ARE FOR INFORMATIONAL PURPOSES ONLY

NOTE:
BORINGS ARE PROVIDED FOR INFORMATIONAL PURPOSES ONLY.
MATERIALS ENCOUNTERED MAY NOT CORRESPOND TO BORING DATA PROVIDED HEREIN.

P:\31653-000\31653.dwg 2/27/2015 3:57:42 PM



| ADDENDUMS / REVISIONS |
|-----------------------|
| |
| |
| |

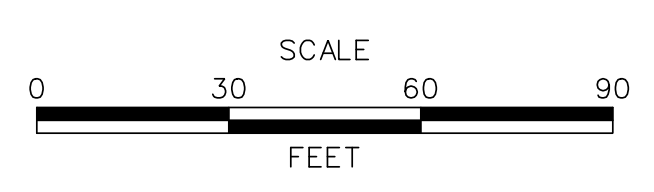

**US 301 &
SR 1 INTERCHANGE**

| | |
|------------------------|---------------------|
| CONTRACT T200911302 | BRIDGE NO. |
| COUNTY NEW CASTLE | DESIGNED BY: S.E.S. |
| | CHECKED BY: B.R.T. |

PROFILES

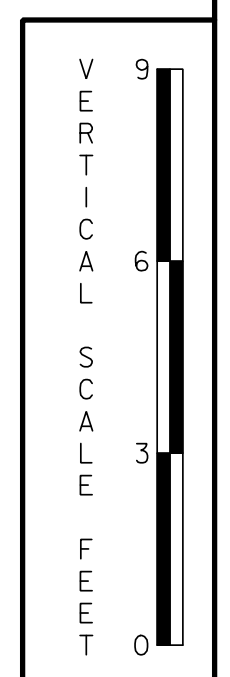

| |
|--------------------|
| PF-06 |
| SHEET NO. 54 |
| TOTAL SHTS. 491 |

DRAFT
NOT FOR BIDDING
AUGUST 2015



US 301 - NORTHBOUND

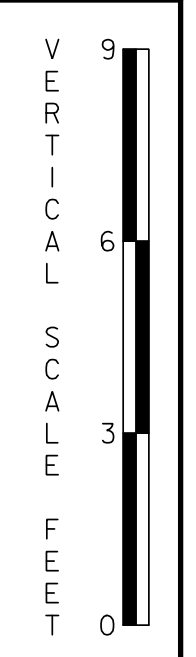

pf:\653-000\cadd\p071301_1B.dgn 2/27/2015 3:57:06 PM



| ADDENDUMS / REVISIONS | |
|-----------------------|--|
| | |
| | |
| | |
| | |

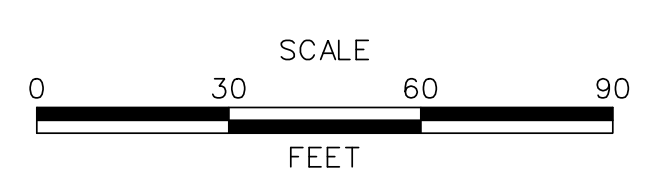

**US 301 &
SR 1 INTERCHANGE**

| | |
|------------------------|---------------------|
| CONTRACT T200911302 | BRIDGE NO. |
| COUNTY NEW CASTLE | DESIGNED BY: S.E.S. |
| | CHECKED BY: B.R.T. |

| |
|-----------------|
| PROFILES |
|-----------------|

| |
|--------------------|
| PF-07 |
| SHEET NO. 55 |
| TOTAL SHTS. 491 |

DRAFT

NOT FOR BIDDING

AUGUST 2015

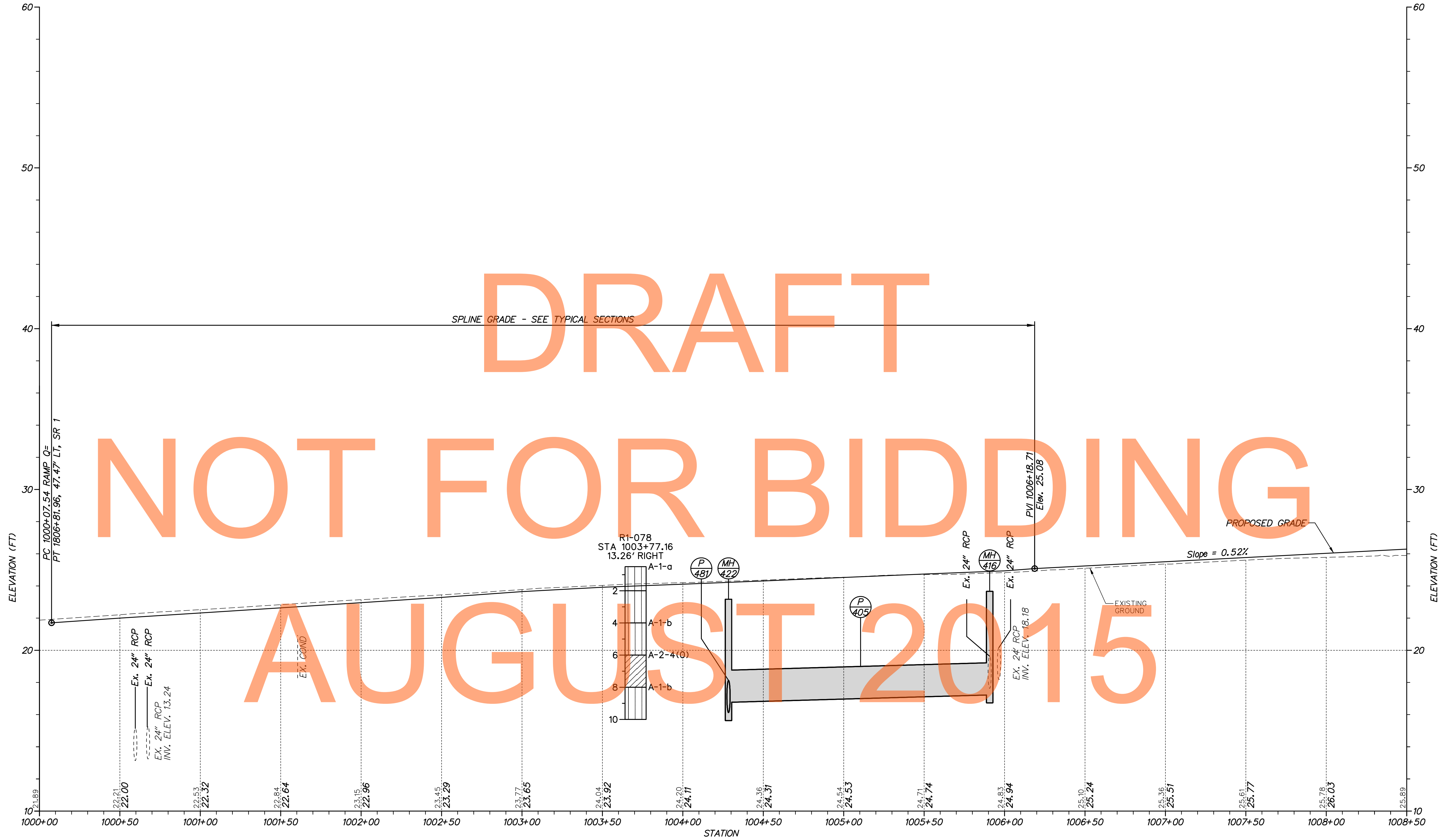

RAMP Q

NOTE:
BORINGS ARE PROVIDED FOR INFORMATIONAL PURPOSES ONLY.
MATERIALS ENCOUNTERED MAY NOT CORRESPOND TO BORING DATA PROVIDED HEREIN.

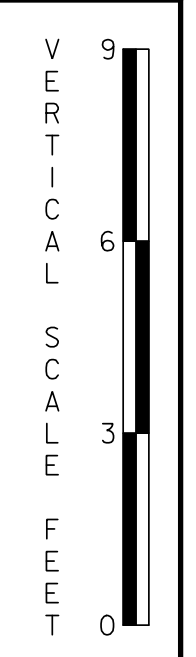

P:\1653-000\centric\1b\cadd\PF008U301_TB.dgn
 2/27/2015 3:58:06 PM



| ADDENDUMS / REVISIONS | |
|-----------------------|--|
| | |
| | |
| | |

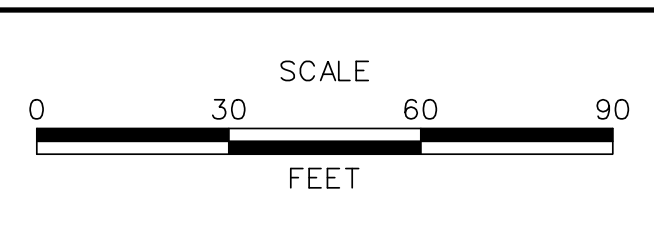

**US 301 &
SR 1 INTERCHANGE**

| | |
|------------------------|---------------------|
| CONTRACT T200911302 | BRIDGE NO. |
| COUNTY NEW CASTLE | DESIGNED BY: J.A.D. |
| | CHECKED BY: B.R.T. |

| | |
|-----------------|--------------------|
| PROFILES | SHEET NO. 56 |
| | TOTAL SHTS. 491 |

PF-08

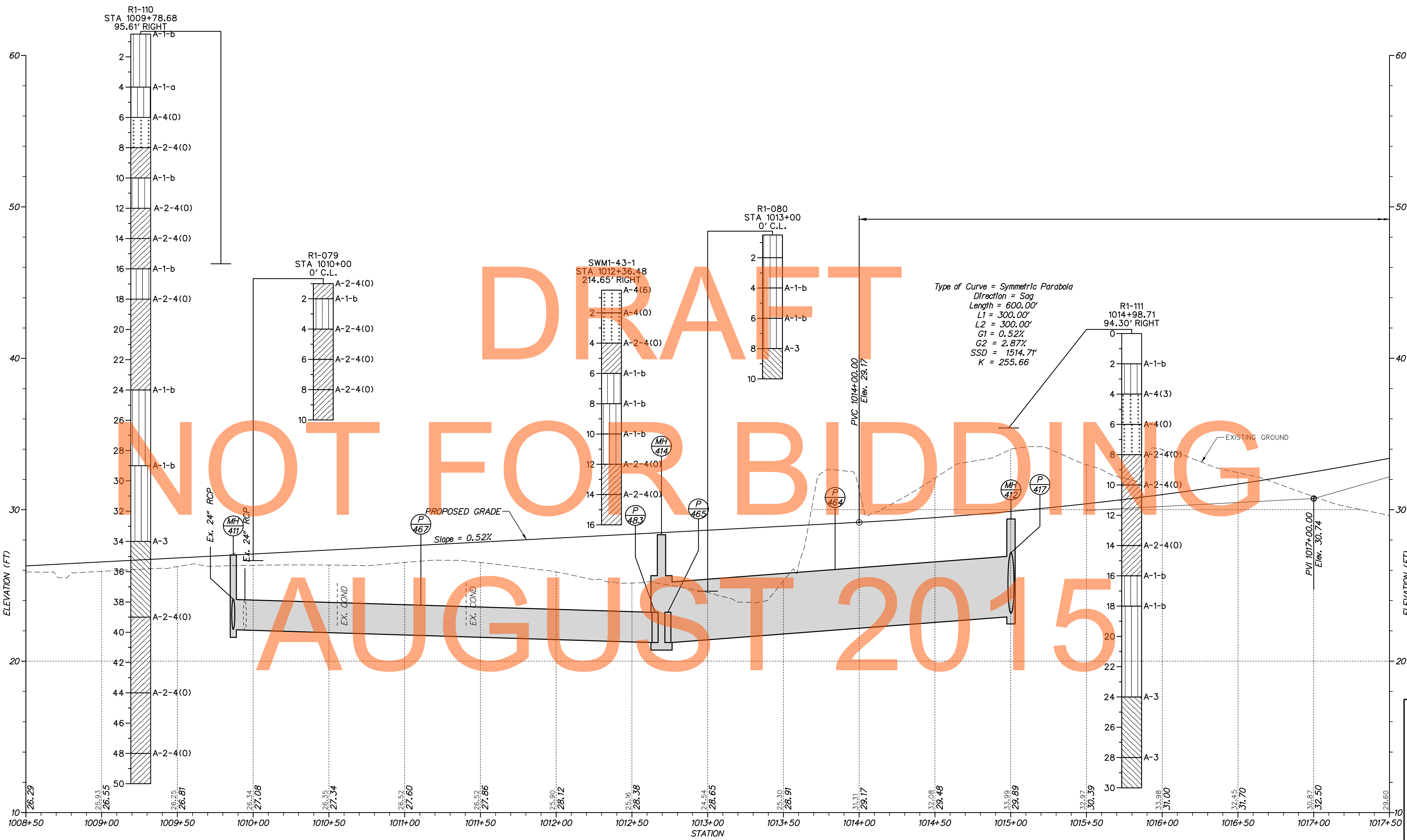

R1-110
STA 1009+78.68
95.61' RIGHT

R1-079
STA 1010+00
0' C.L.

SWM1-43-1
STA 1012+36.48
214.65' RIGHT

R1-080
STA 1013+00
0' C.L.

R1-111
1014+98.71
94.30' RIGHT

Type of Curve = Symmetric Parabola
Direction = Sag
Length = 600.00'
L1 = 300.00'
L2 = 300.00'
G1 = 0.52%
G2 = 2.87%
SSD = 1514.71'
K = 255.66

PROPOSED GRADE
Slope = 0.52%

PVC 1014+00.00
Elev. 29.17

PVI 1017+00.00
Elev. 30.74

RAMP Q

NOTE:
BORINGS ARE PROVIDED FOR INFORMATIONAL PURPOSES ONLY.
MATERIALS ENCOUNTERED MAY NOT CORRESPOND TO BORING DATA PROVIDED HEREIN.

P:\2009\000\centric\01\1b\cead\PF090301_1b.dgn
 2/27/2015 3:58:12 PM



| ADDENDUMS / REVISIONS | |
|-----------------------|--|
| | |
| | |
| | |

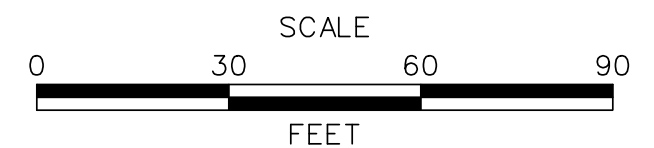

US 301 &
SR 1 INTERCHANGE

| | |
|------------------------|---------------------|
| CONTRACT T200911302 | BRIDGE NO. |
| COUNTY NEW CASTLE | DESIGNED BY: J.A.D. |
| | CHECKED BY: B.R.T. |

| | |
|-----------------|--------------------|
| PROFILES | SHEET NO. 57 |
| | TOTAL SHTS. 491 |
| | |

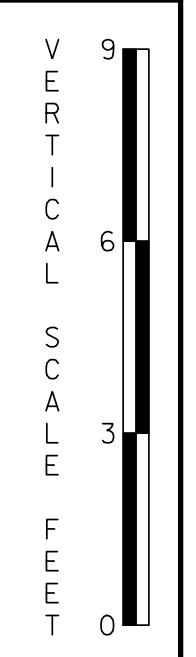

PF-09

DRAFT
NOT FOR BIDDING
AUGUST 2015

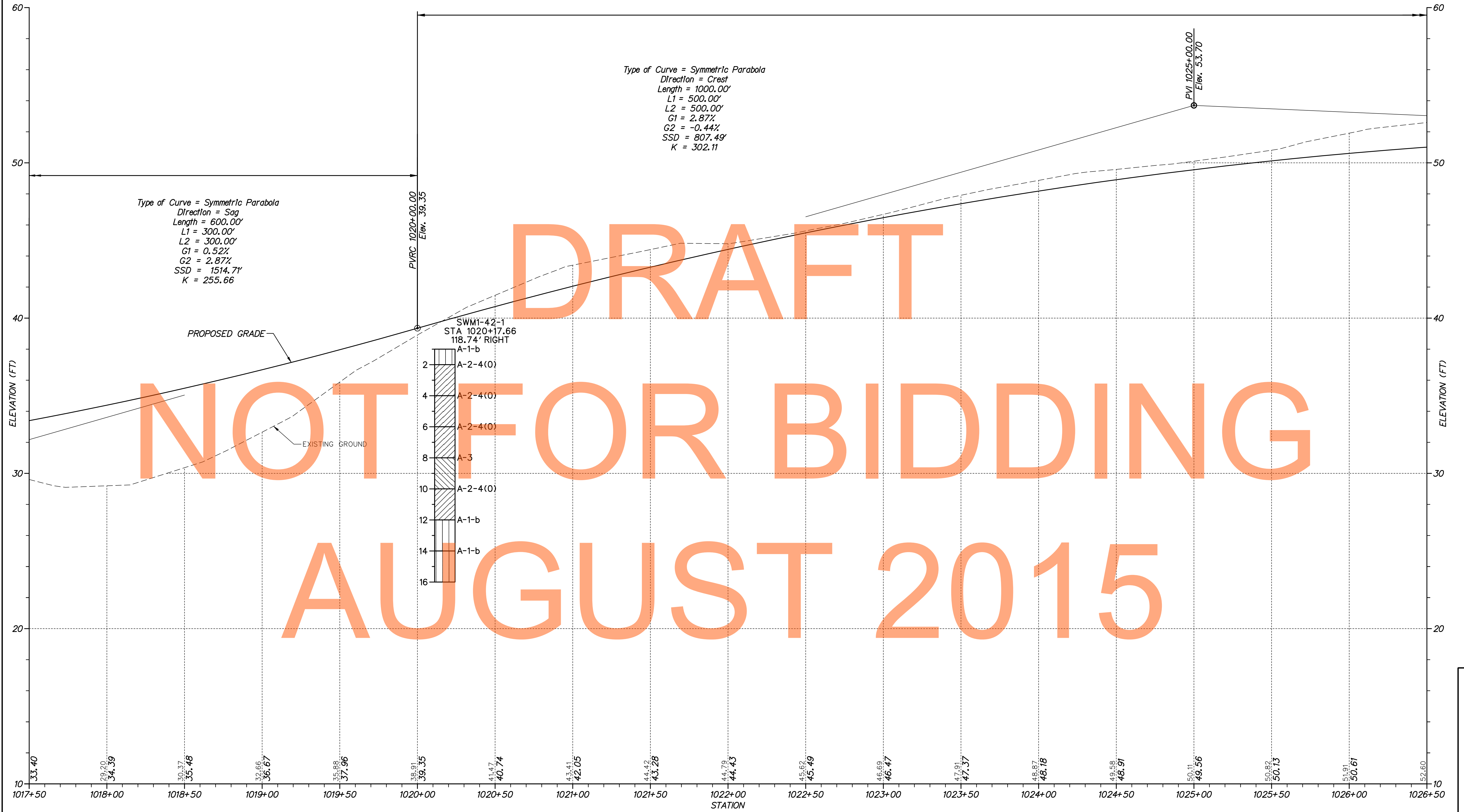

Type of Curve = Symmetric Parabola
 Direction = Sag
 Length = 600.00'
 L1 = 300.00'
 L2 = 300.00'
 G1 = 0.52%
 G2 = 2.87%
 SSD = 1514.71'
 K = 255.66

Type of Curve = Symmetric Parabola
 Direction = Crest
 Length = 1000.00'
 L1 = 500.00'
 L2 = 500.00'
 G1 = 2.87%
 G2 = -0.44%
 SSD = 807.49'
 K = 302.11

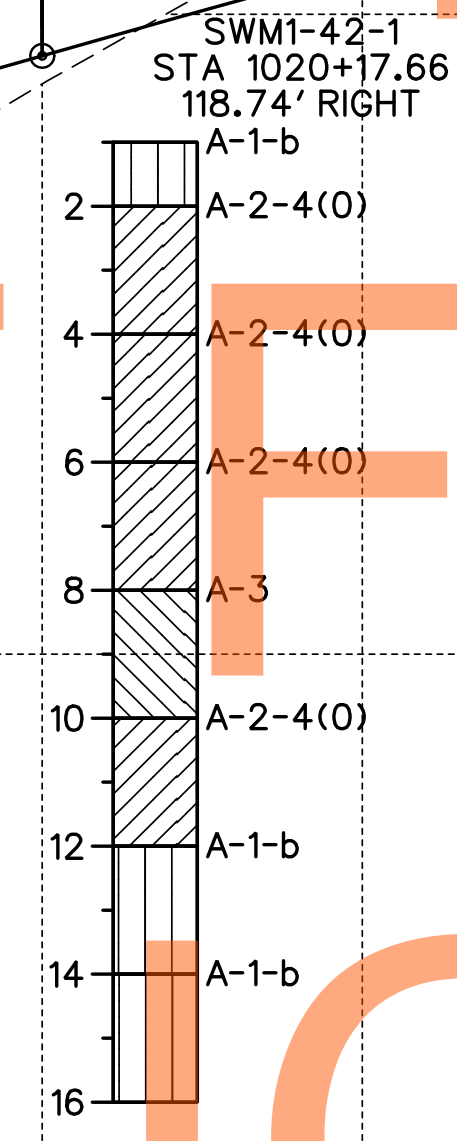

RAMP Q

NOTE:
 BORINGS ARE PROVIDED FOR INFORMATIONAL PURPOSES ONLY.
 MATERIALS ENCOUNTERED MAY NOT CORRESPOND TO BORING DATA PROVIDED HEREIN.

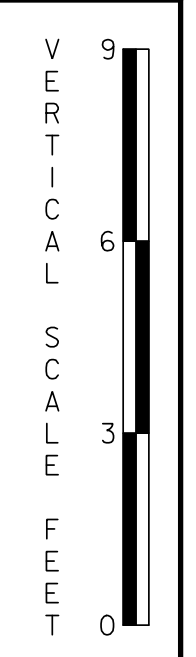

| ADDENDUMS / REVISIONS | |
|-----------------------|--|
| | |
| | |
| | |

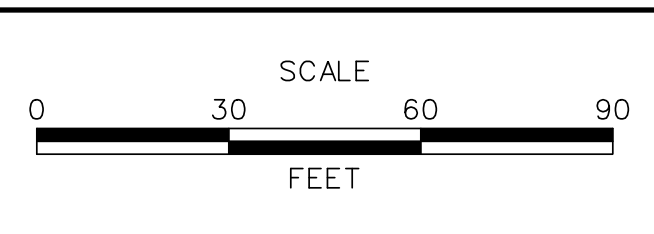

**US 301 &
SR 1 INTERCHANGE**

| | |
|------------------------|---|
| CONTRACT T200911302 | BRIDGE NO. |
| COUNTY NEW CASTLE | DESIGNED BY: J.A.D. CHECKED BY: B.R.T. |

| | |
|-----------------|--------------------|
| PROFILES | SHEET NO. 58 |
| | TOTAL SHTS. 491 |
| | |

P:\2009\11302\11302.dwg
 2/27/2015 3:58:18 PM

DRAFT

NOT FOR BIDDING

AUGUST 2015

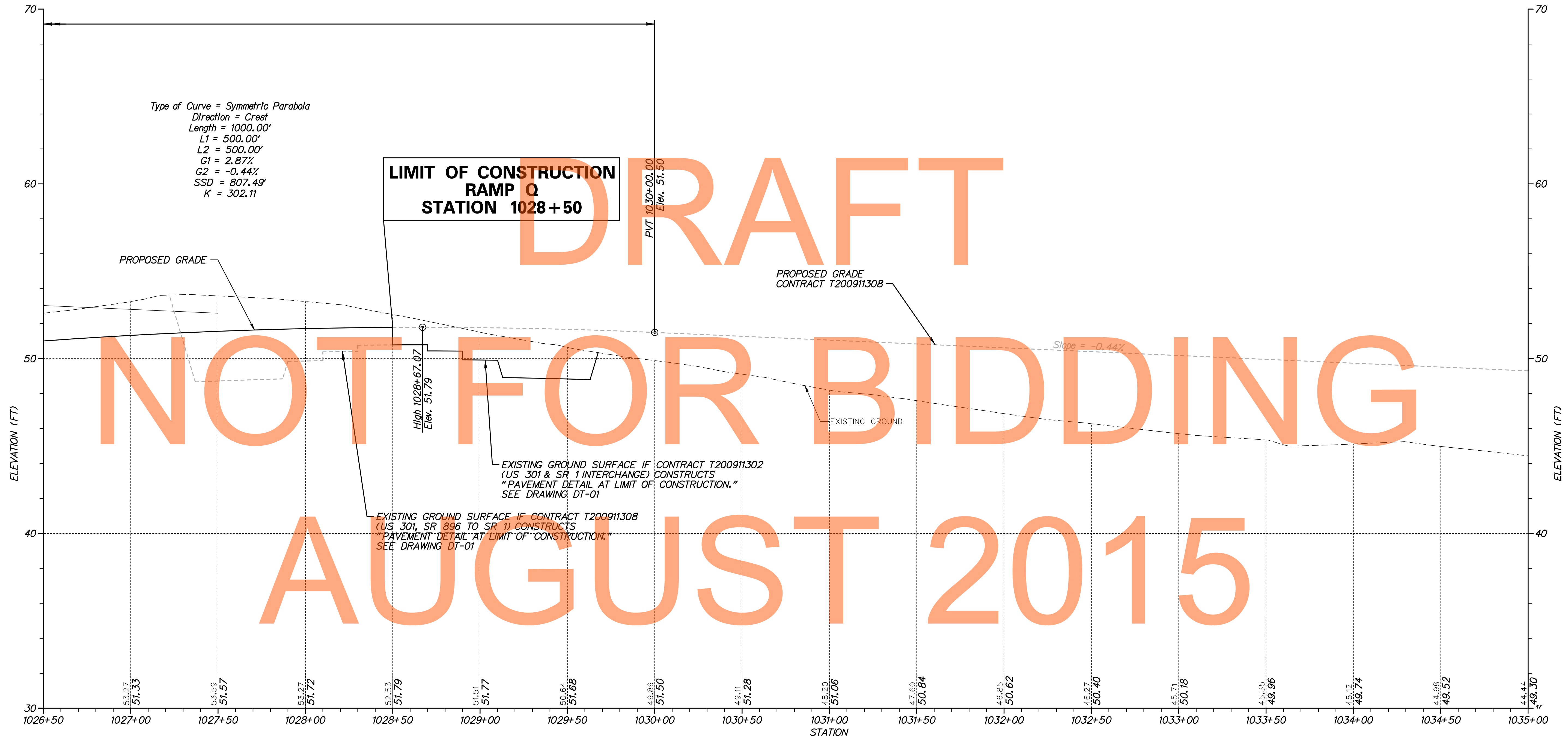

RAMP Q

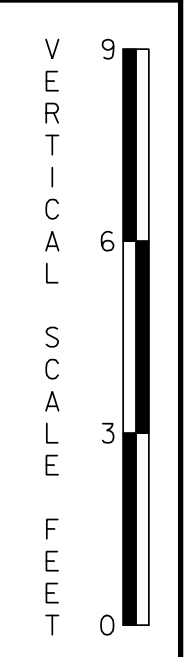

PF:\053-000\centric\1b\cadd\PF0110301_1B.dgn 2/27/2015 3:58:23 PM



| ADDENDUMS / REVISIONS | |
|-----------------------|--|
| | |
| | |
| | |

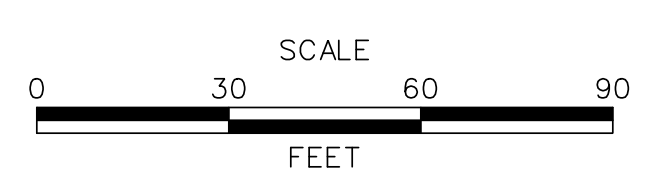

US 301 & SR 1 INTERCHANGE

| | |
|------------|---------------------|
| CONTRACT | BRIDGE NO. |
| T200911302 | |
| COUNTY | DESIGNED BY: J.A.D. |
| NEW CASTLE | CHECKED BY: B.R.T. |

| | |
|----------|-------------|
| PROFILES | SHEET NO. |
| | 59 |
| | TOTAL SHTS. |
| | 491 |

Type of Curve = Symmetric Parabola
 Direction = Sag
 Length = 580.00'
 L1 = 290.00'
 L2 = 290.00'
 G1 = -0.95%
 G2 = 5.00%
 SSD = 431.39'
 K = 97.44

Type of Curve = Symmetric Parabola
 Direction = Crest
 Length = 720.00'
 L1 = 360.00'
 L2 = 360.00'
 G1 = 5.00%
 G2 = -3.51%
 SSD = 427.25'
 K = 84.58

EXISTING GROUND SURFACE IF CONTRACT T200911302 (US 301 & SR 1 INTERCHANGE) CONSTRUCTS "PAVEMENT DETAIL AT LIMIT OF CONSTRUCTION." SEE DRAWING DT-01

FINISHED GROUND SURFACE IF CONTRACT T201011302 (US 13 & PORT PENN RD INTERSECTION) CONSTRUCTS "PAVEMENT DETAIL AT LIMIT OF CONSTRUCTION." SEE DRAWING DT-01

**LIMIT OF CONSTRUCTION
 RAMP R
 STATION 316+00**

PROPOSED GRADE
 CONTRACT T201011302

PROPOSED GRADE

Slope = 5.00%

P
 459

EXISTING GROUND

EXISTING GROUND SURFACE IF CONTRACT T200911302 (US 301 & SR 1 INTERCHANGE) CONSTRUCTS "PAVEMENT DETAIL AT LIMIT OF CONSTRUCTION." SEE DRAWING DT-01

DRAFT
NOT FOR BIDDING
AUGUST 2015

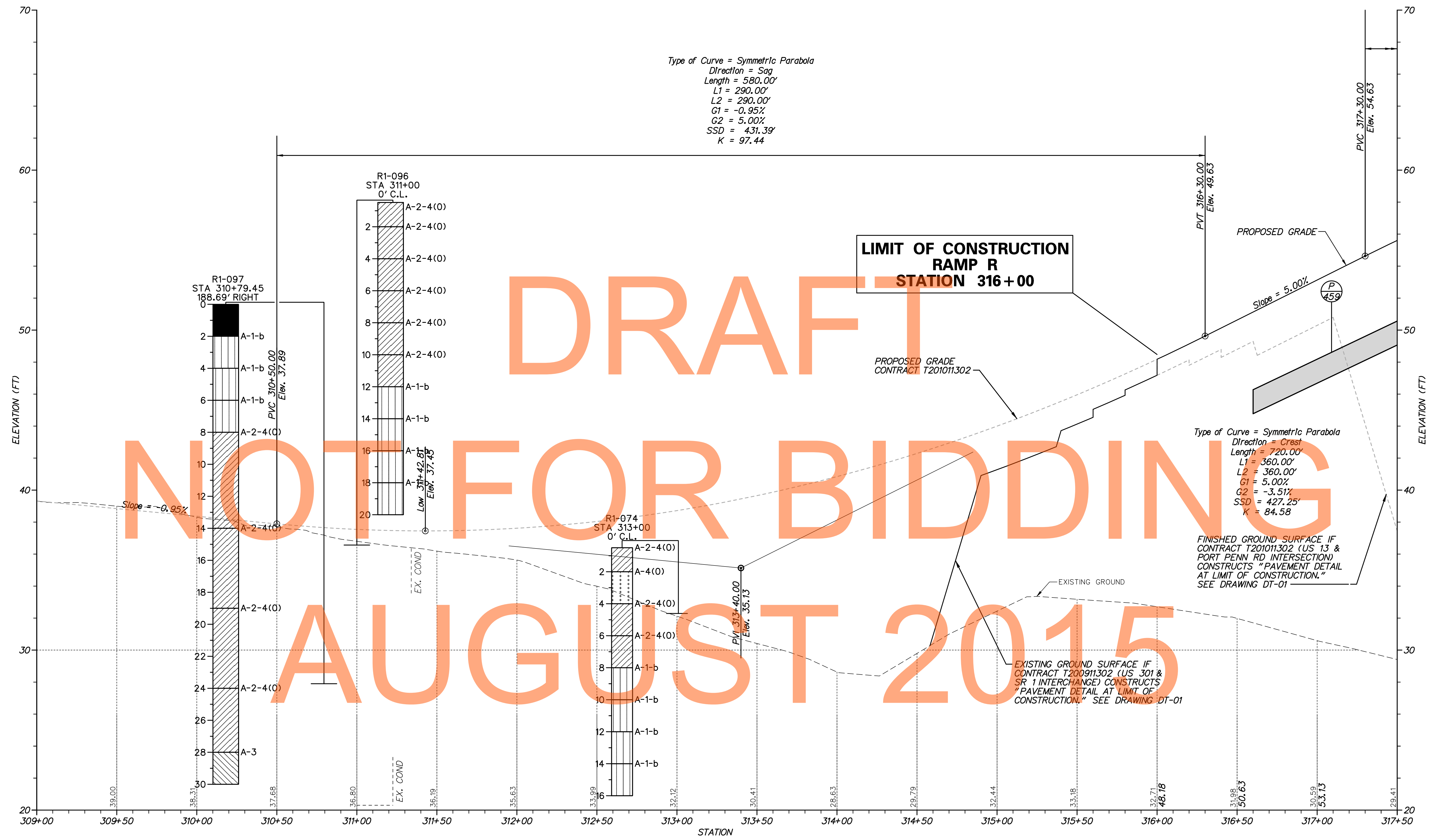

RAMP R

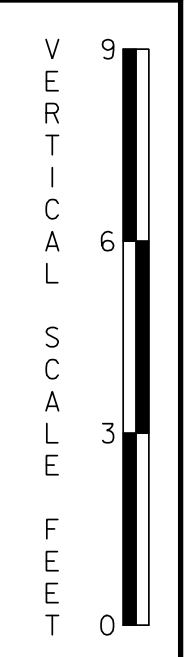

NOTE:
 BORINGS ARE PROVIDED FOR INFORMATIONAL PURPOSES ONLY.
 MATERIALS ENCOUNTERED MAY NOT CORRESPOND TO BORING DATA PROVIDED HEREIN.

PF120911302.dwg 2/27/2015 3:58:05 PM



| ADDENDUMS / REVISIONS | |
|-----------------------|--|
| | |
| | |
| | |

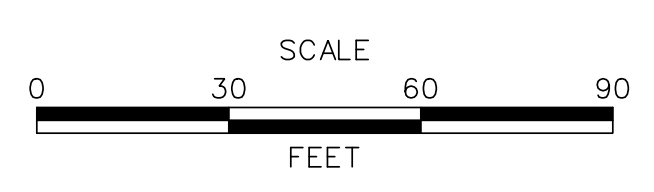

**US 301 &
 SR 1 INTERCHANGE**

| | |
|------------------------|---------------------|
| CONTRACT T200911302 | BRIDGE NO. |
| COUNTY NEW CASTLE | DESIGNED BY: S.E.S. |
| | CHECKED BY: B.R.T. |

| | |
|-----------------|--------------------|
| PROFILES | SHEET NO. 60 |
| | TOTAL SHTS. 491 |

DRAFT

NOT FOR BIDDING

AUGUST 2015

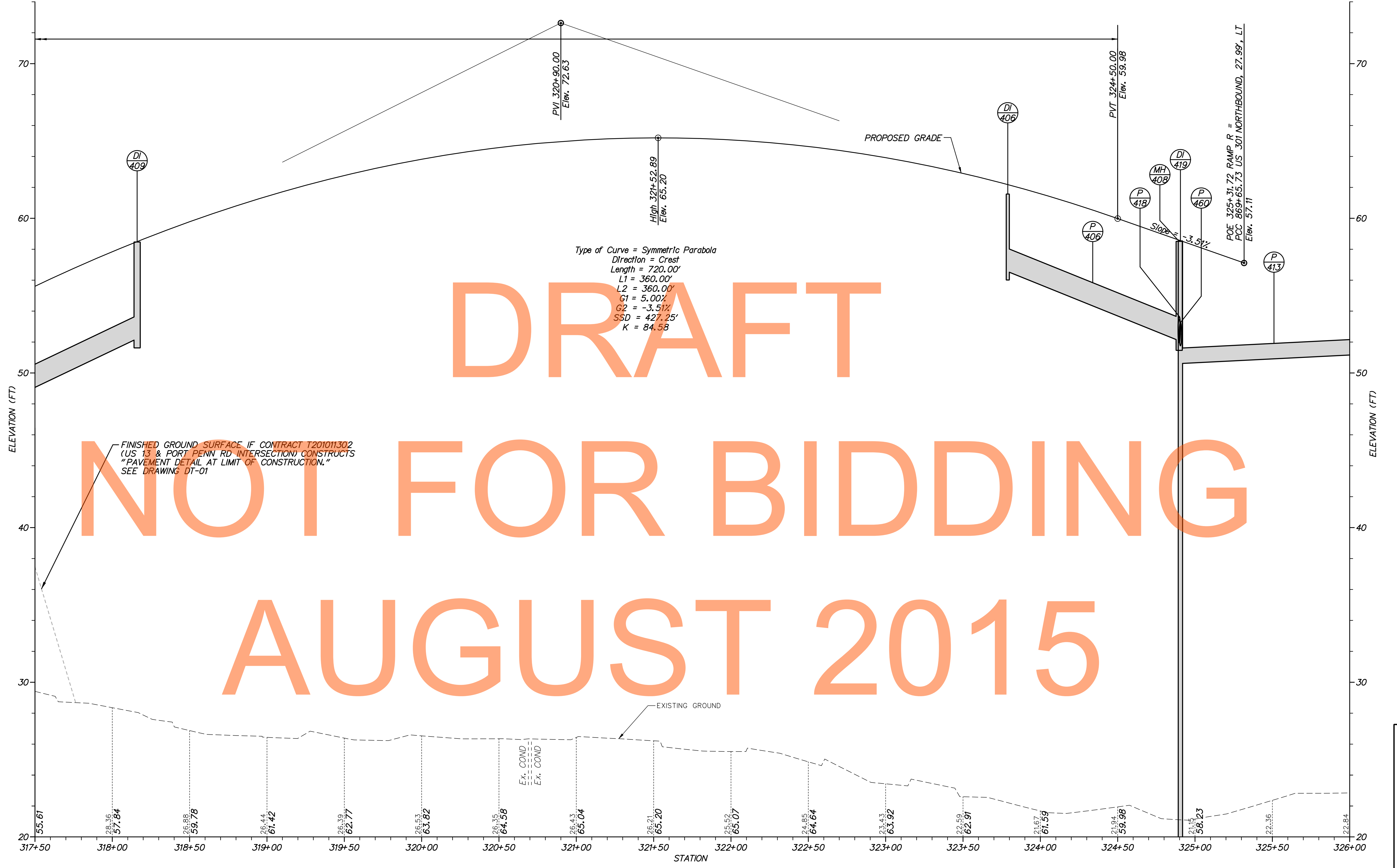

FINISHED GROUND SURFACE IF CONTRACT T201011302 (US 13 & PORT PENN RD INTERSECTION) CONSTRUCTS "PAVEMENT DETAIL AT LIMIT OF CONSTRUCTION." SEE DRAWING DT-01

RAMP R

PF13653-000.dgn
2/2/2015 3:58:45 PM



| ADDENDUMS / REVISIONS |
|-----------------------|
| |
| |
| |
| |

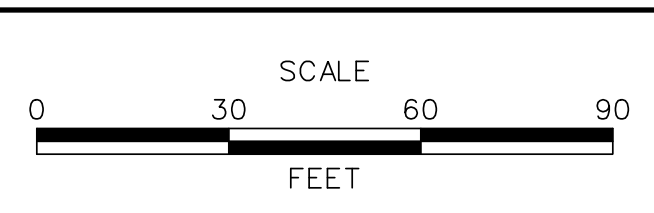

US 301 &
SR 1 INTERCHANGE

| | |
|------------------------|---|
| CONTRACT T200911302 | BRIDGE NO. |
| COUNTY NEW CASTLE | DESIGNED BY: S.E.S. CHECKED BY: B.R.T. |

| |
|--------------------|
| PROFILES |
| SHEET NO. 61 |
| TOTAL SHTS. 491 |

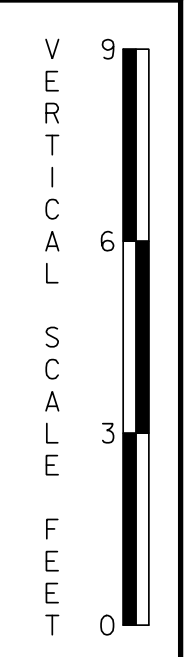

PF-13