

FILES \$DATES

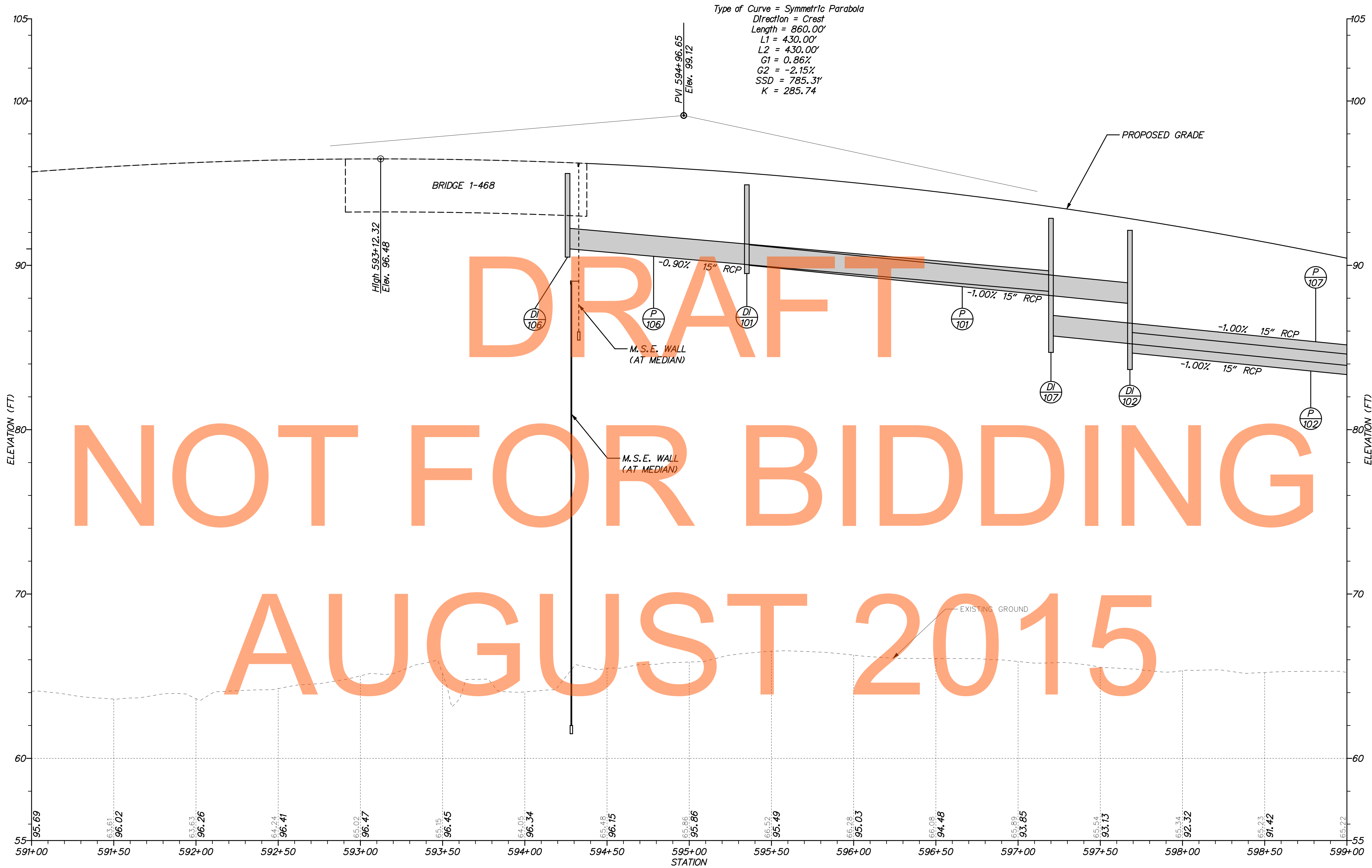

DRAFT

NOT FOR BIDDING

AUGUST 2015

NOTE: BORINGS ARE FOR INFORMATIONAL PURPOSES ONLY
 ADDITIONAL STRUCTURE BORING INFORMATION CAN BE
 FOUND ON THE BRIDGE PLANS

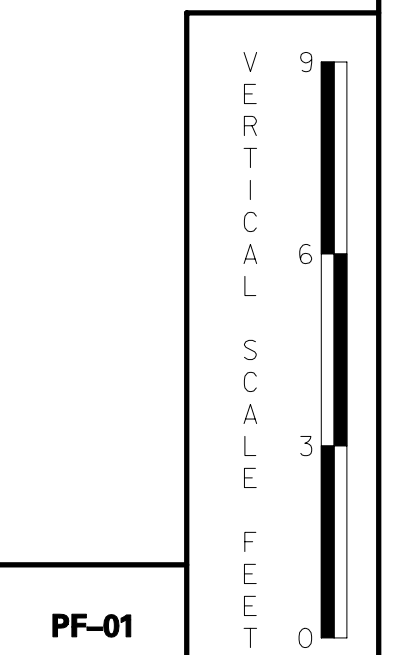

ADDENDUMS / REVISIONS	

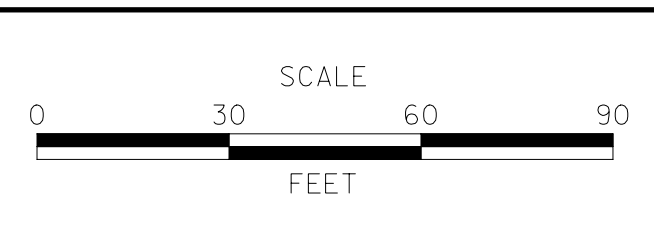

US 301, NORFOLK SOUTHERN RR TO SR 896

CONTRACT T200911301	BRIDGE NO.
COUNTY NEW CASTLE	DESIGNED BY: WJD
	CHECKED BY: MAA

PROFILES	SHEET NO. 34
	TOTAL SHTS. 240

PF-01

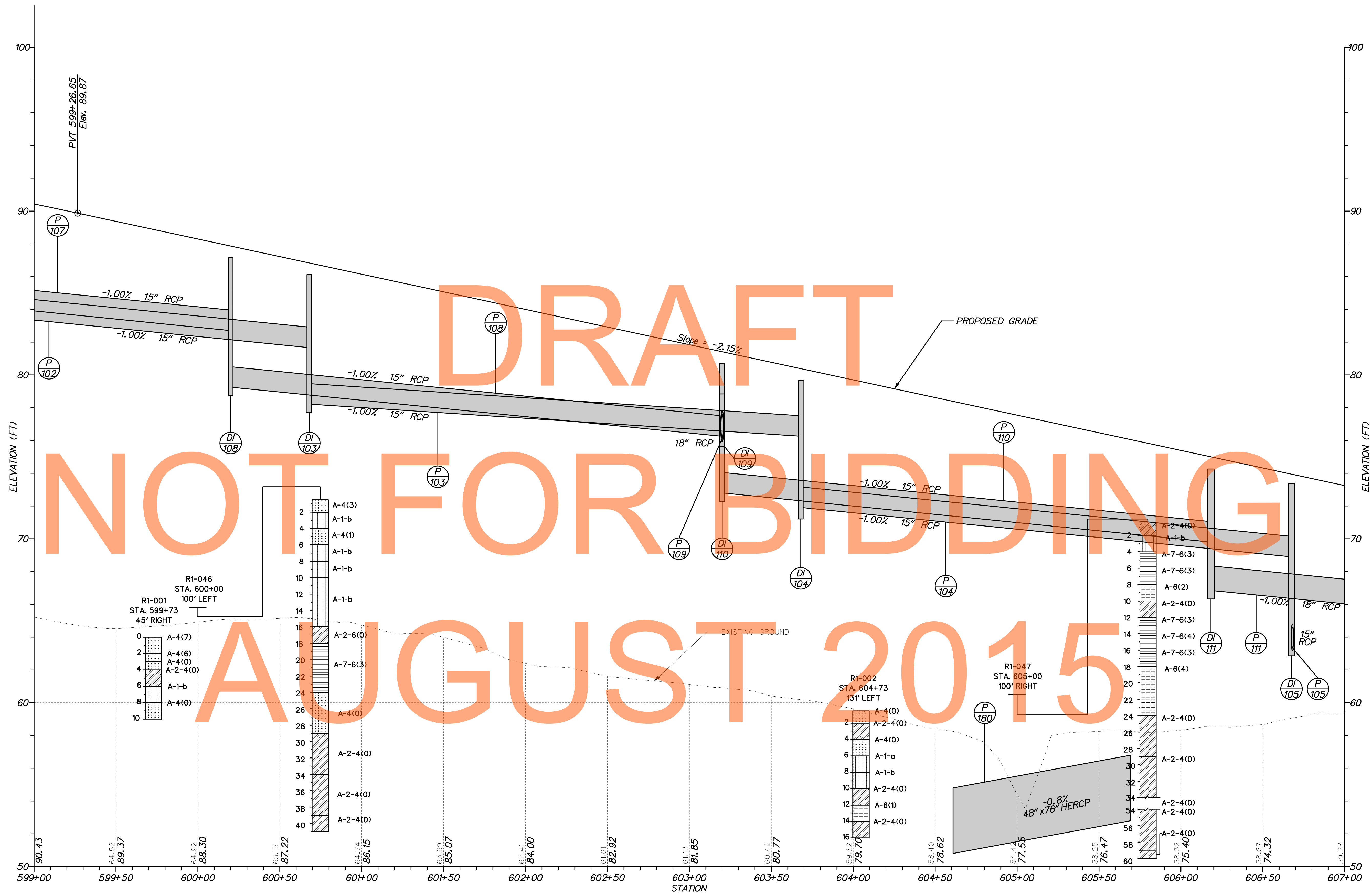

DRAFT
NOT FOR BIDDING
AUGUST 2015

US 301 - MAINLINE

NOTE: BORINGS ARE FOR INFORMATIONAL PURPOSES ONLY

PF-02



ADDENDUMS / REVISIONS

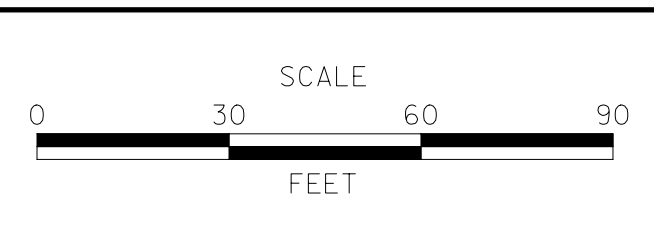

**US 301,
NORFOLK SOUTHERN RR TO SR 896**

CONTRACT T200911301	BRIDGE NO.
COUNTY NEW CASTLE	DESIGNED BY: WJD
	CHECKED BY: MAA

PROFILES
SHEET NO. 35
TOTAL SHTS. 240

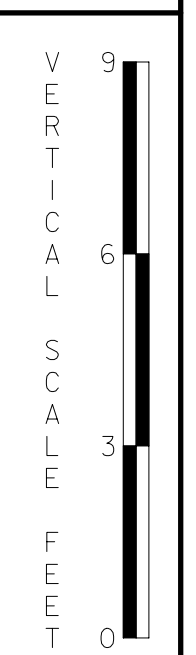

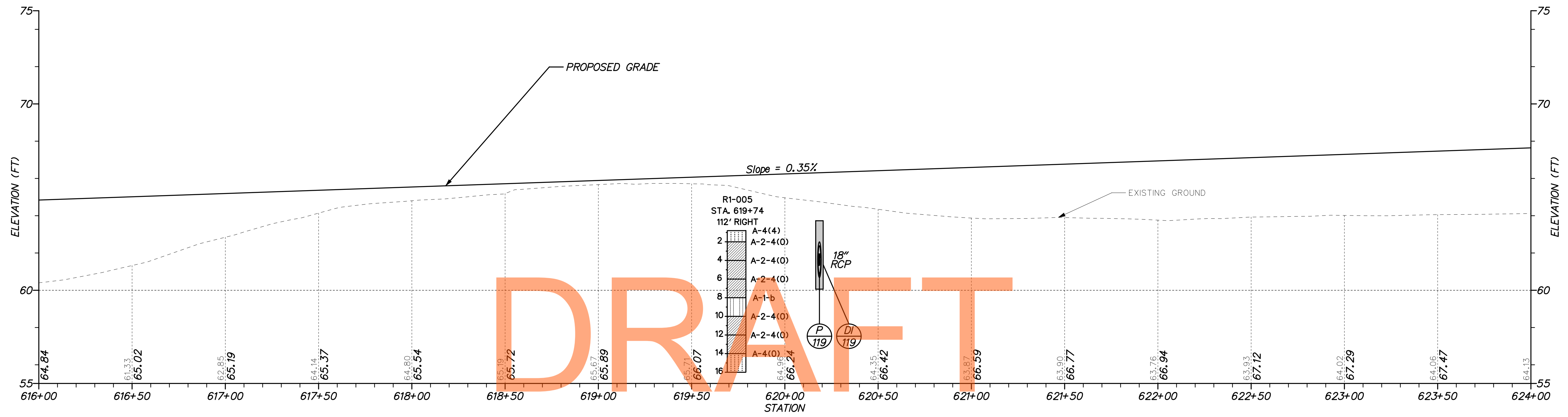

US 301 - MAINLINE

NOT FOR BIDDING

AUGUST 2015

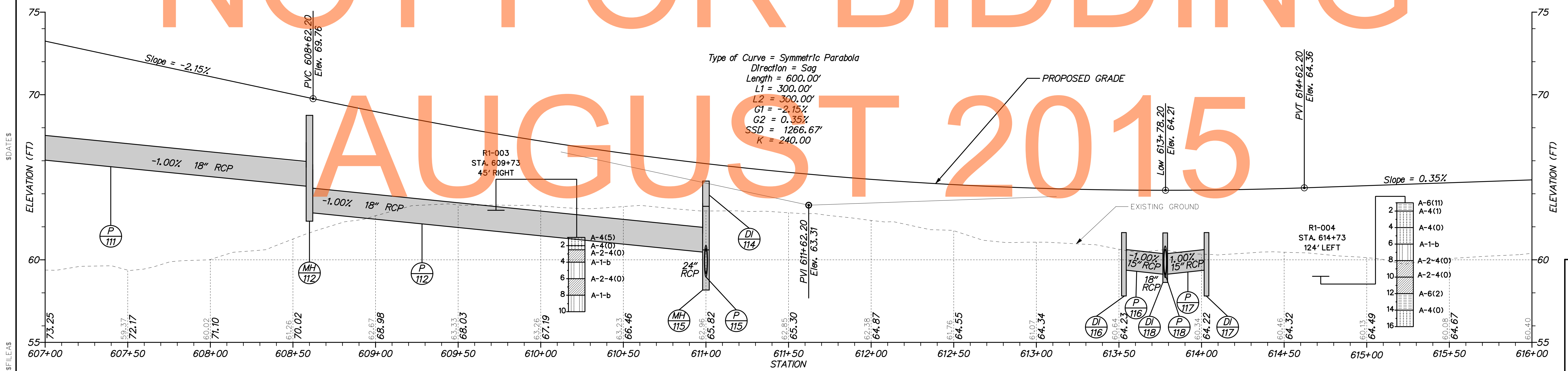

US 301 - MAINLINE

Type of Curve = Symmetric Parabola
 Direction = Sag
 Length = 600.00'
 L1 = 300.00'
 L2 = 300.00'
 G1 = -2.15%
 G2 = 0.35%
 SSD = 1266.67'
 K = 240.00

NOTE: BORINGS ARE FOR INFORMATIONAL PURPOSES ONLY

PF-03



ADDENDUMS / REVISIONS	

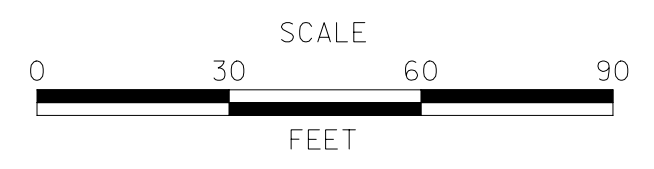

US 301,
 NORFOLK SOUTHERN RR TO SR 896

CONTRACT T200911301	BRIDGE NO.
COUNTY NEW CASTLE	DESIGNED BY: WJD
	CHECKED BY: MAA

PROFILES	SHEET NO. 36
	TOTAL SHTS. 240

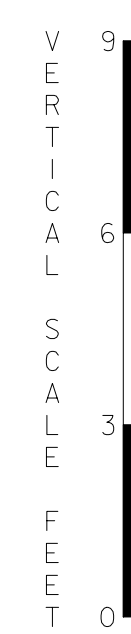

DRAFT

NOT FOR BIDDING

AUGUST 2015

Type of Curve = Symmetric Parabola
 Direction = Crest
 Length = 500.00'
 L1 = 250.00'
 L2 = 250.00'
 G1 = 0.35%
 G2 = -0.58%
 SSD = 1409.93'
 K = 537.43



US 301 - MAINLINE

\$FILES \$DATES

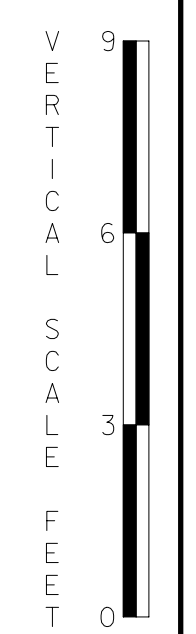

NOTE: BORINGS ARE FOR INFORMATIONAL PURPOSES ONLY

PF-04



ADDENDUMS / REVISIONS	

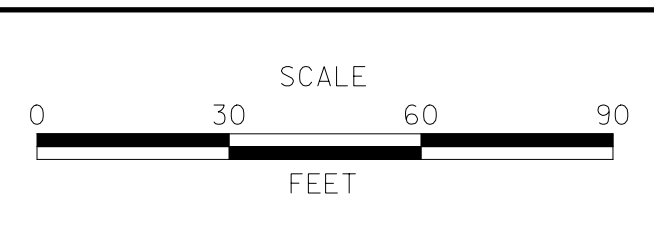

US 301,
NORFOLK SOUTHERN RR TO SR 896

CONTRACT T200911301	BRIDGE NO.
COUNTY NEW CASTLE	DESIGNED BY: WJD
	CHECKED BY: MAA

PROFILES	SHEET NO. 37
	TOTAL SHTS. 240

DRAFT

NOT FOR BIDDING

AUGUST 2015

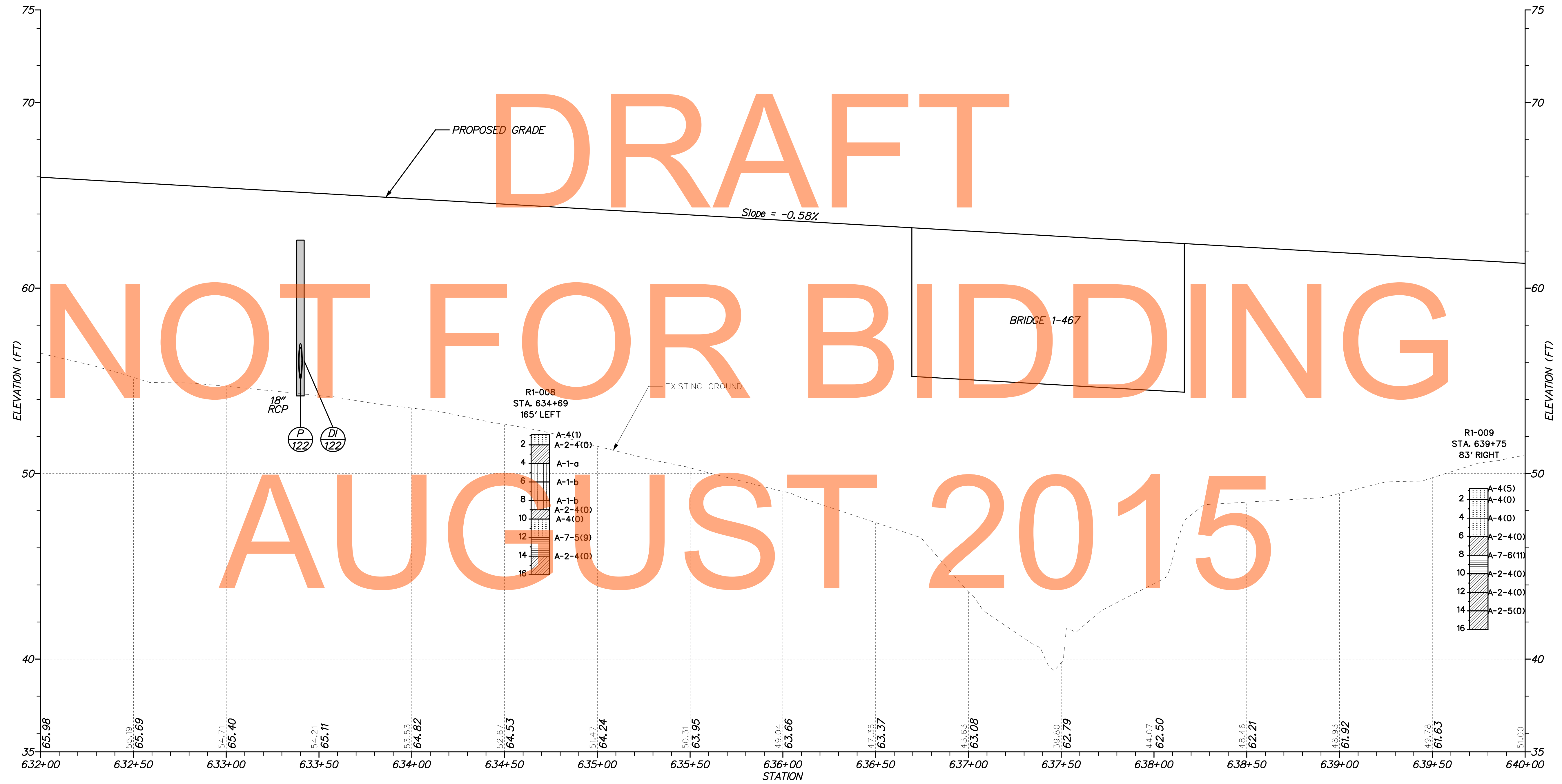

US 301 - MAINLINE

NOTE: BORINGS ARE FOR INFORMATIONAL PURPOSES ONLY
ADDITIONAL STRUCTURE BORING INFORMATION CAN BE FOUND ON THE BRIDGE PLANS

PF-05

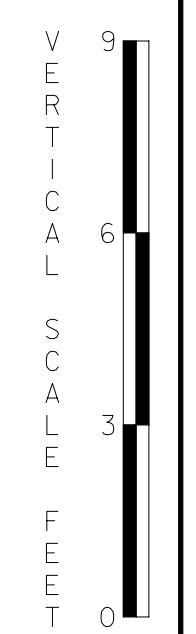

\$FILES \$DATES



ADDENDUMS / REVISIONS	

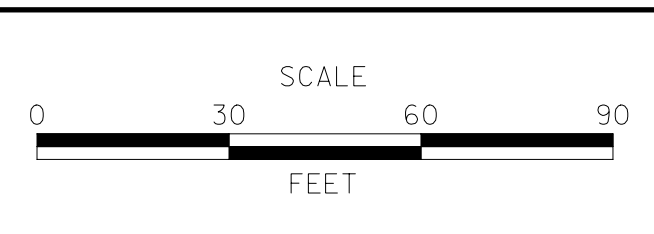

US 301,
NORFOLK SOUTHERN RR TO SR 896

CONTRACT	BRIDGE NO.	1-10
T200911301	DESIGNED BY:	WJD
COUNTY	CHECKED BY:	MAA
NEW CASTLE		

PROFILES	SHEET NO.	38
	TOTAL SHTS.	240

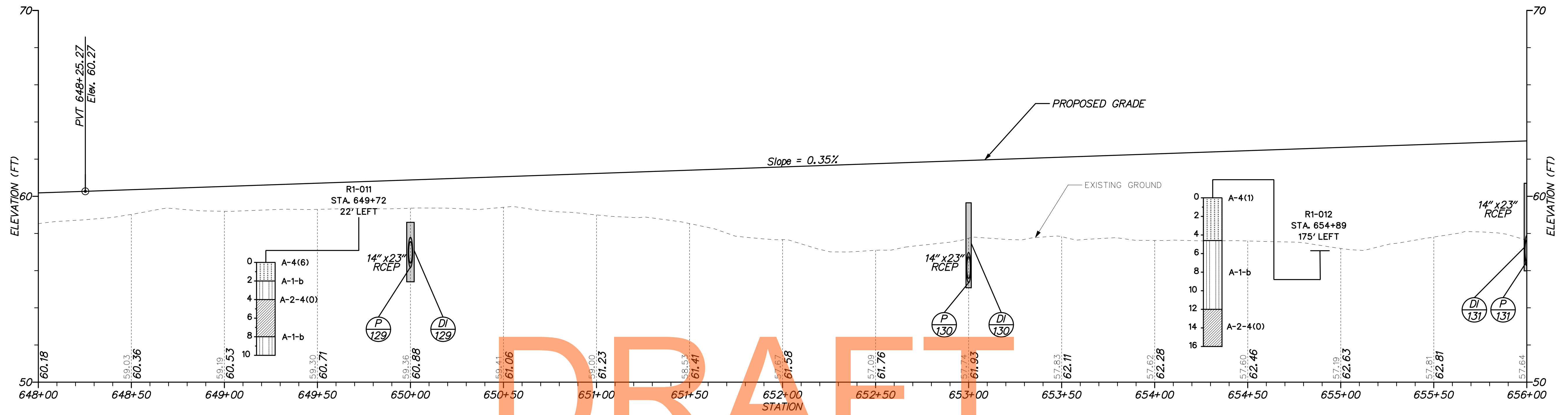

US 301 - MAINLINE

DRAFT

NOT FOR BIDDING

AUGUST 2015

Type of Curve = Symmetric Parabola
 Direction = Sag
 Length = 800.00'
 L1 = 400.00'
 L2 = 400.00'
 G1 = -0.58%
 G2 = 0.35%
 K = 859.88

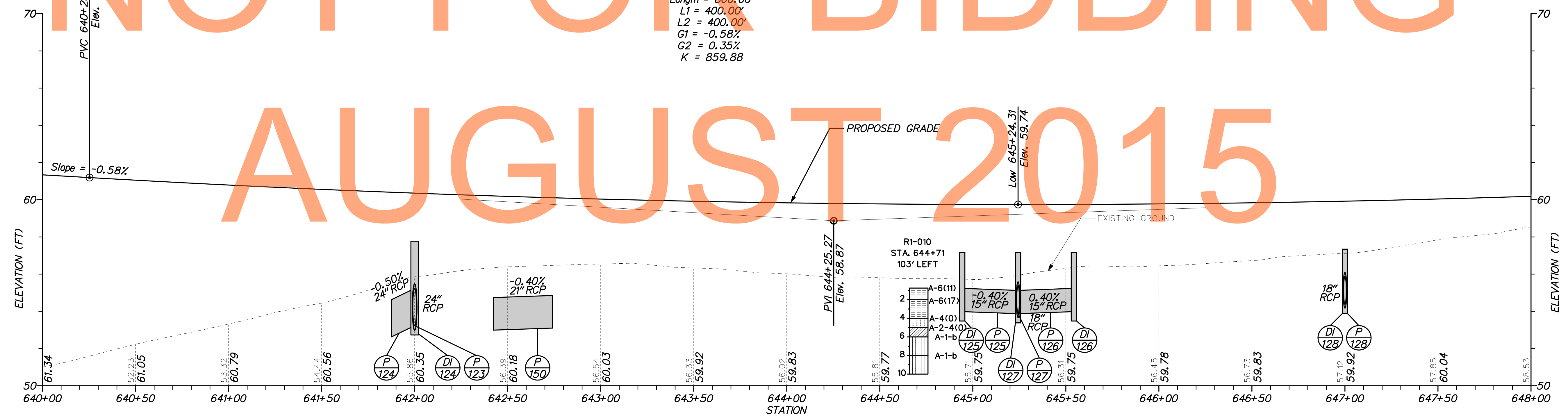

US 301 - MAINLINE

\$FILES \$DATES

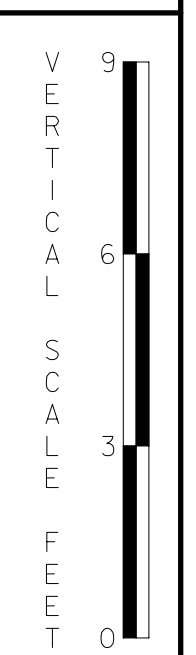

NOTE: BORINGS ARE FOR INFORMATIONAL PURPOSES ONLY

PF-06



ADDENDUMS / REVISIONS	

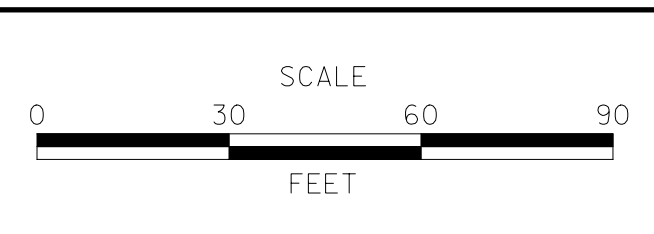

US 301,
 NORFOLK SOUTHERN RR TO SR 896

CONTRACT T200911301	BRIDGE NO.
COUNTY NEW CASTLE	DESIGNED BY: WJD
	CHECKED BY: MAA

PROFILES	SHEET NO. 39
	TOTAL SHTS. 240

Type of Curve = Symmetric Parabola
 Direction = Sag
 Length = 600.00'
 L1 = 300.00'
 L2 = 300.00'
 G1 = 0.35%
 G2 = 3.00%
 SSD = 1105.56'
 K = 226.42

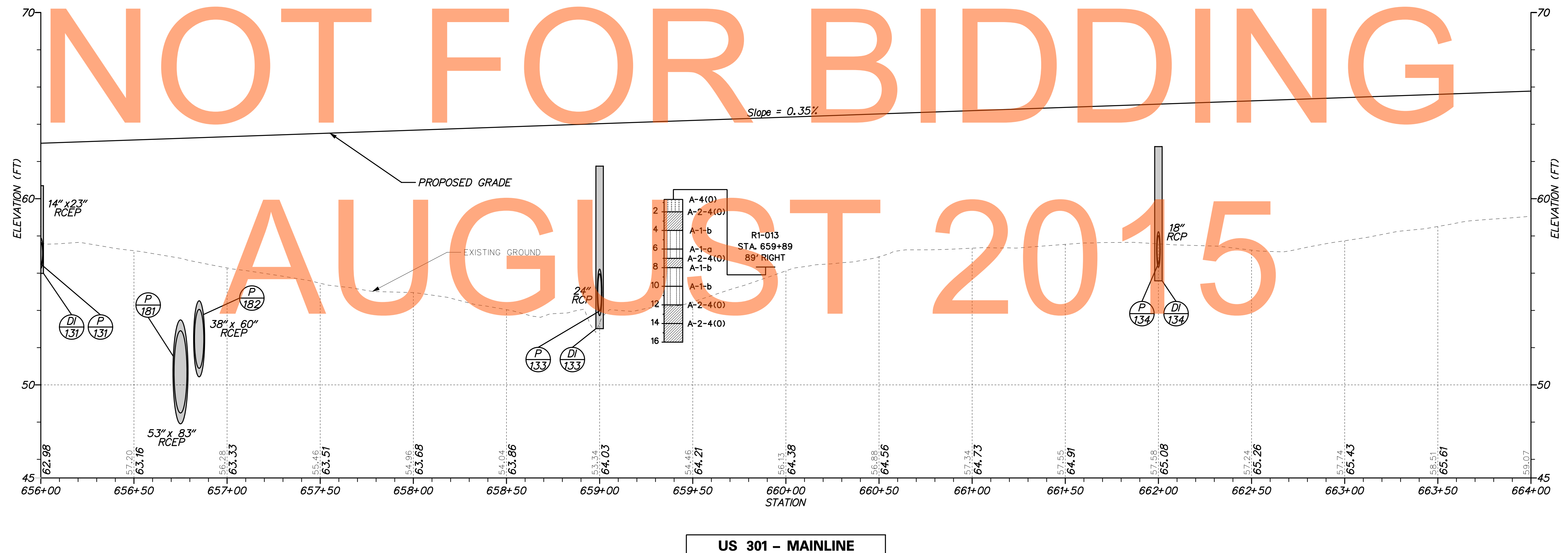
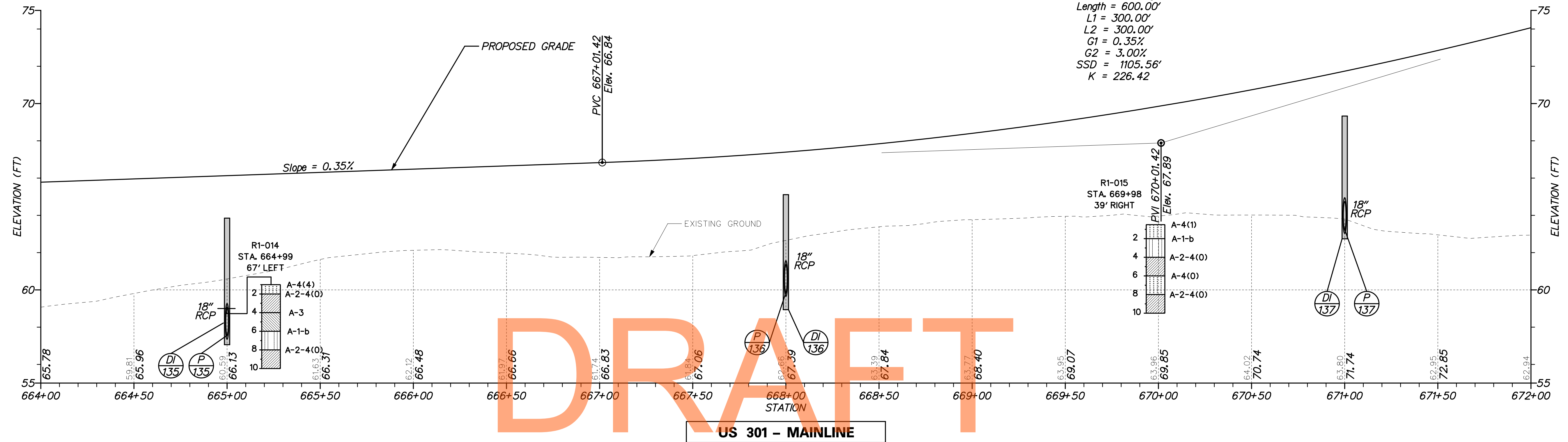

DRAFT

NOT FOR BIDDING

AUGUST 2015

\$FILES \$DATES

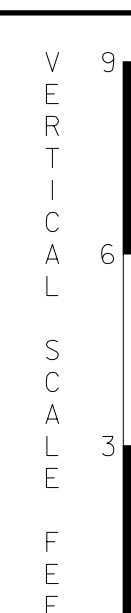

NOTE: BORINGS ARE FOR INFORMATIONAL PURPOSES ONLY

PF-07

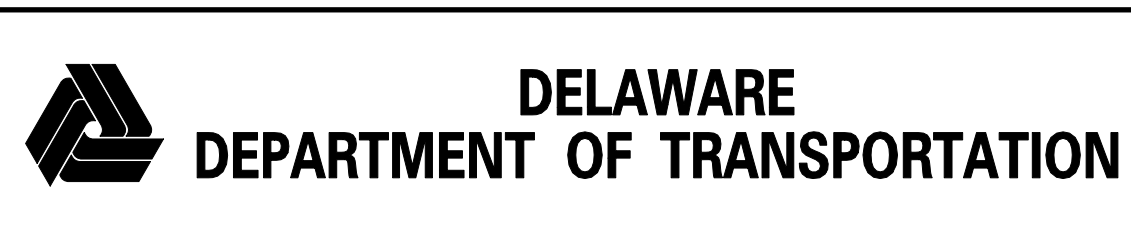

ADDENDUMS / REVISIONS	

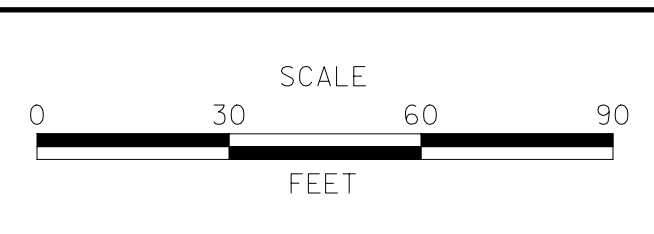

**US 301,
NORFOLK SOUTHERN RR TO SR 896**

CONTRACT T200911301	BRIDGE NO.
COUNTY NEW CASTLE	DESIGNED BY: WJD
	CHECKED BY: MAA

PROFILES	SHEET NO. 40
	TOTAL SHTS. 240

DRAFT
NOT FOR BIDDING
AUGUST 2015

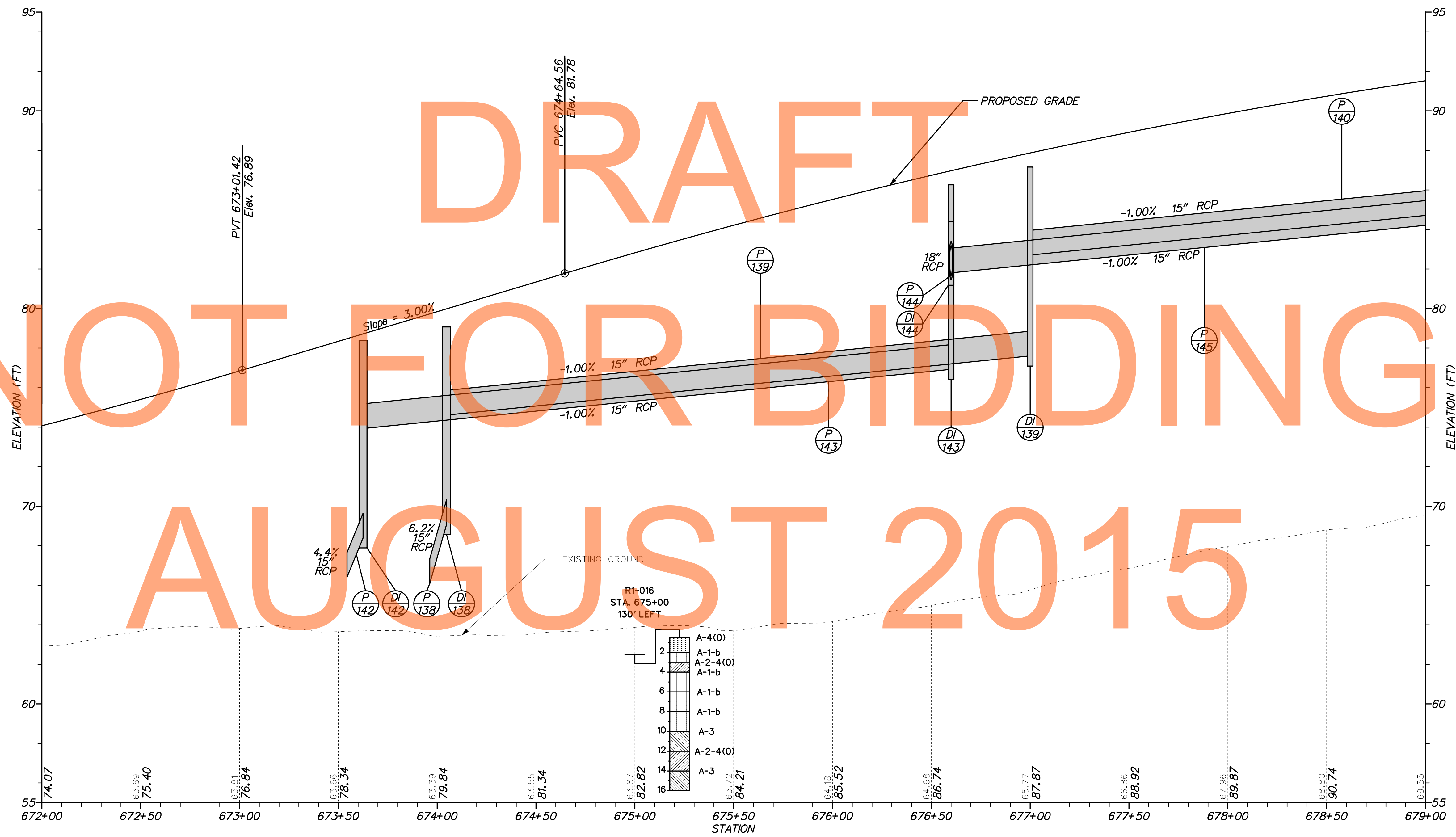

US 301 - MAINLINE

NOTE: BORINGS ARE FOR INFORMATIONAL PURPOSES ONLY

PF-08



ADDENDUMS / REVISIONS	



**US 301,
NORFOLK SOUTHERN RR TO SR 896**

CONTRACT T200911301	BRIDGE NO.
COUNTY NEW CASTLE	DESIGNED BY: WJD
	CHECKED BY: MAA

PROFILES	SHEET NO. 41
	TOTAL SHTS. 240

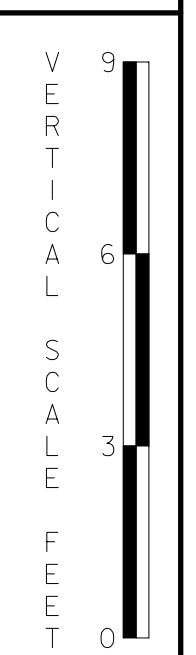

Type of Curve = Symmetric Parabola
 Direction = Crest
 Length = 1000.00'
 L1 = 500.00'
 L2 = 500.00'
 G1 = 3.00%
 G2 = -0.50%
 SSD = 785.28'
 K = 285.71

Type of Curve = Symmetric Parabola
 Direction = Crest
 Length = 30.00'
 L1 = 15.00'
 L2 = 15.00'
 G1 = 10.00%
 G2 = 0.34%
 SSD = 126.72'
 K = 3.11

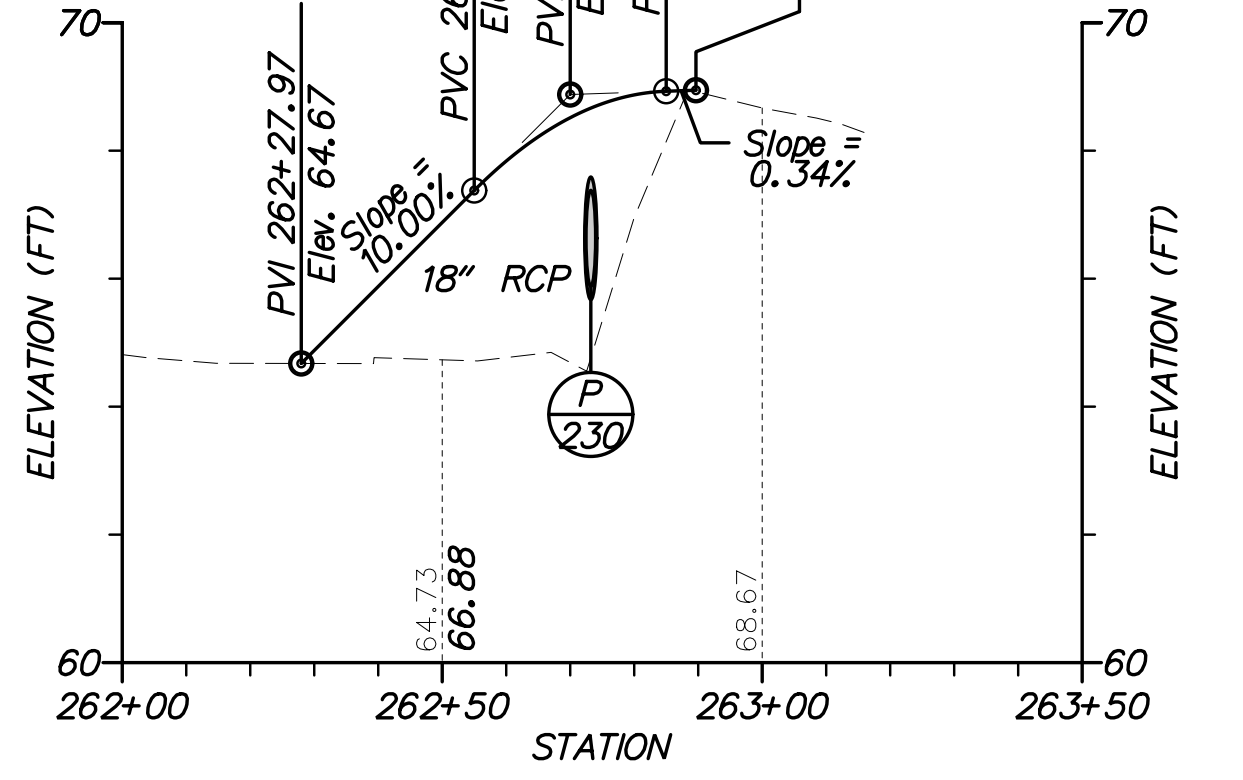
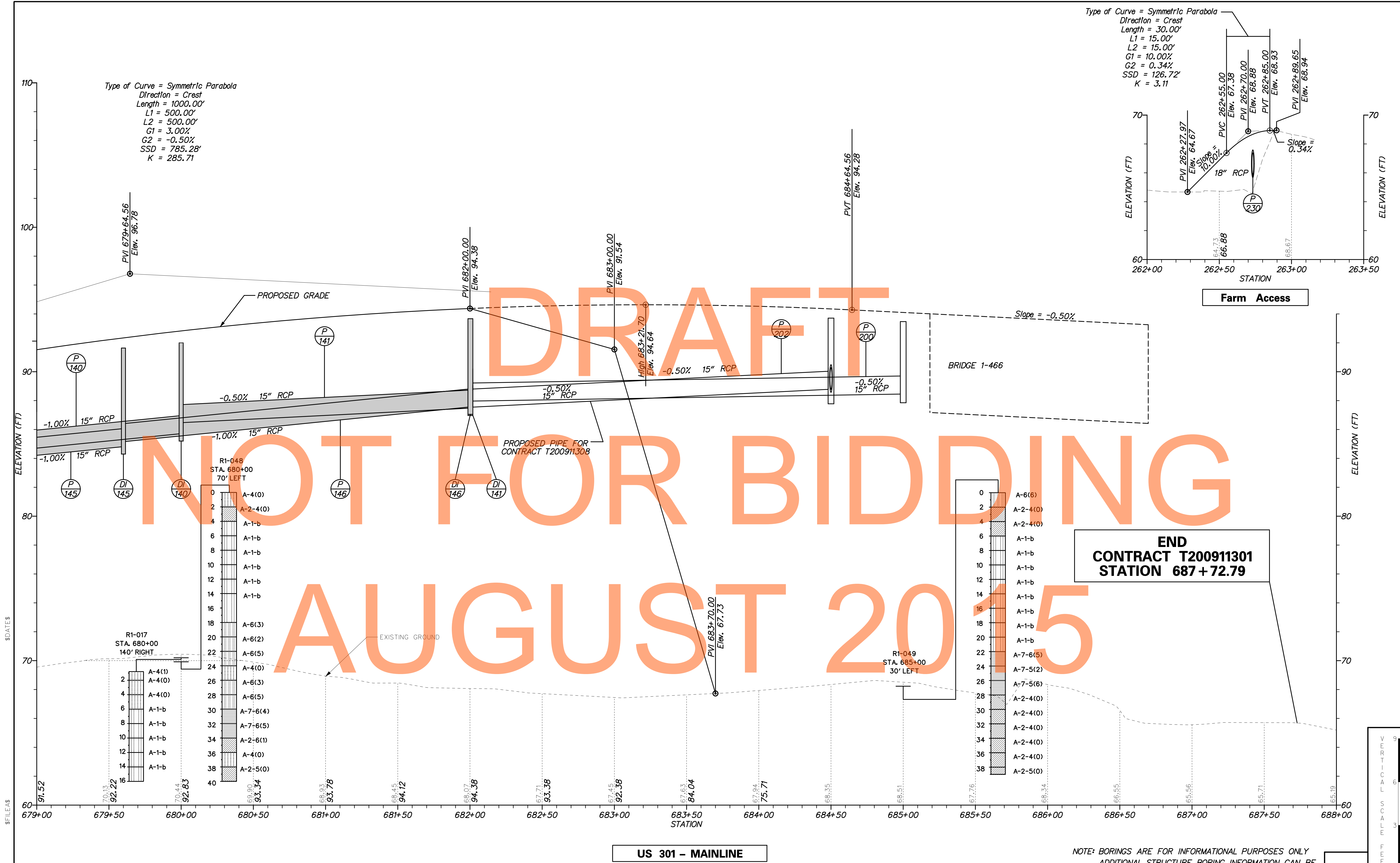

DRAFT

NOT FOR BIDDING

AUGUST 2015

**END
 CONTRACT T200911301
 STATION 687 + 72.79**

R1-048
 STA. 680+00
 70' LEFT

0	A-4(0)
2	A-2-4(0)
4	A-1-b
6	A-1-b
8	A-1-b
10	A-1-b
12	A-1-b
14	A-1-b
16	A-1-b
18	A-6(3)
20	A-6(2)
22	A-6(5)
24	A-4(0)
26	A-6(3)
28	A-6(5)
30	A-7-6(4)
32	A-7-6(5)
34	A-2-6(1)
36	A-4(0)
38	A-2-5(0)
40	

R1-049
 STA. 685+00
 30' LEFT

0	A-6(6)
2	A-2-4(0)
4	A-2-4(0)
6	A-1-b
8	A-1-b
10	A-1-b
12	A-1-b
14	A-1-b
16	A-1-b
18	A-1-b
20	A-1-b
22	A-7-6(5)
24	A-7-5(2)
26	A-7-5(6)
28	A-2-4(0)
30	A-2-4(0)
32	A-2-4(0)
34	A-2-4(0)
36	A-2-4(0)
38	A-2-5(0)

\$DATES

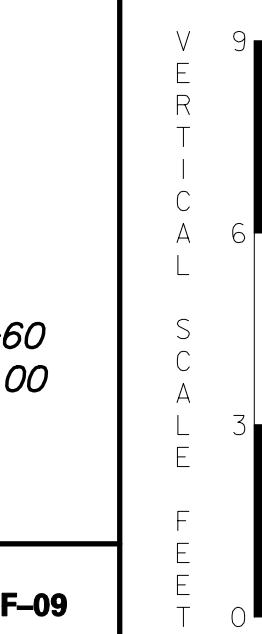

ADDENDUMS / REVISIONS	

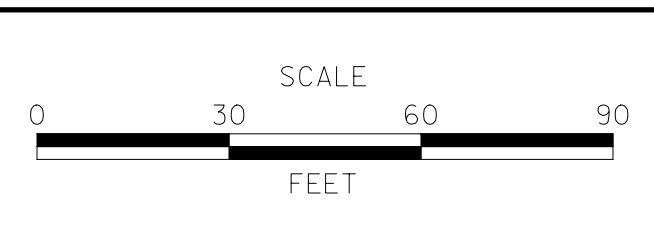

**US 301,
 NORFOLK SOUTHERN RR TO SR 896**

CONTRACT T200911301	BRIDGE NO.
COUNTY NEW CASTLE	DESIGNED BY: WJD
	CHECKED BY: MAA

PROFILES

SHEET NO. 42
TOTAL SHTS. 240

NOTE: BORINGS ARE FOR INFORMATIONAL PURPOSES ONLY
 ADDITIONAL STRUCTURE BORING INFORMATION CAN BE
 FOUND ON THE BRIDGE PLANS

PF-09