

DRAFT  
NOT FOR BIDDING  
AUGUST 2015

**RAMP R**

NOTE: BORINGS ARE PROVIDED FOR INFORMATIONAL PURPOSES ONLY.  
MATERIALS ENCOUNTERED MAY NOT CORRESPOND TO BORING  
DATA PROVIDED HEREIN.

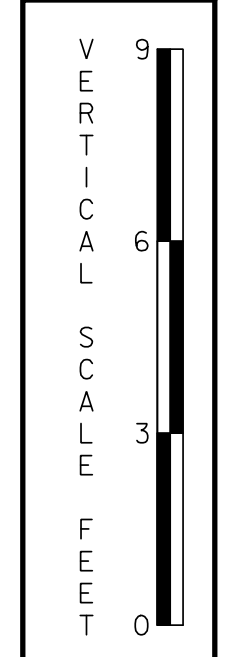

P:\17653-000\contract\1d\cead\PF0010301.dwg 9/17/2015 9:41 AM



ADDENDUMS / REVISIONS	

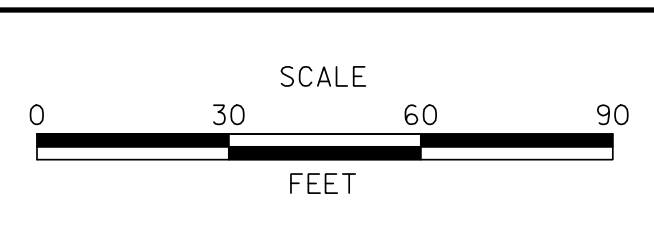

**US 13 & PORT PENN RD INTERSECTION**

CONTRACT T201011302	BRIDGE NO.
COUNTY NEW CASTLE	DESIGNED BY: SES
	CHECKED BY: BRT

**PROFILES**

PF-01	SHEET NO. 37
	TOTAL SHTS. 179

NOTE: BORINGS ARE PROVIDED FOR INFORMATIONAL PURPOSES ONLY. MATERIALS ENCOUNTERED MAY NOT CORRESPOND TO BORING DATA PROVIDED HEREIN.

Type of Curve = Symmetric Parabola  
 Direction = Sag  
 Length = 580.00'  
 L1 = 290.00'  
 L2 = 290.00'  
 G1 = -0.95%  
 G2 = 5.00%  
 SSD = 431.39'  
 K = 97.44

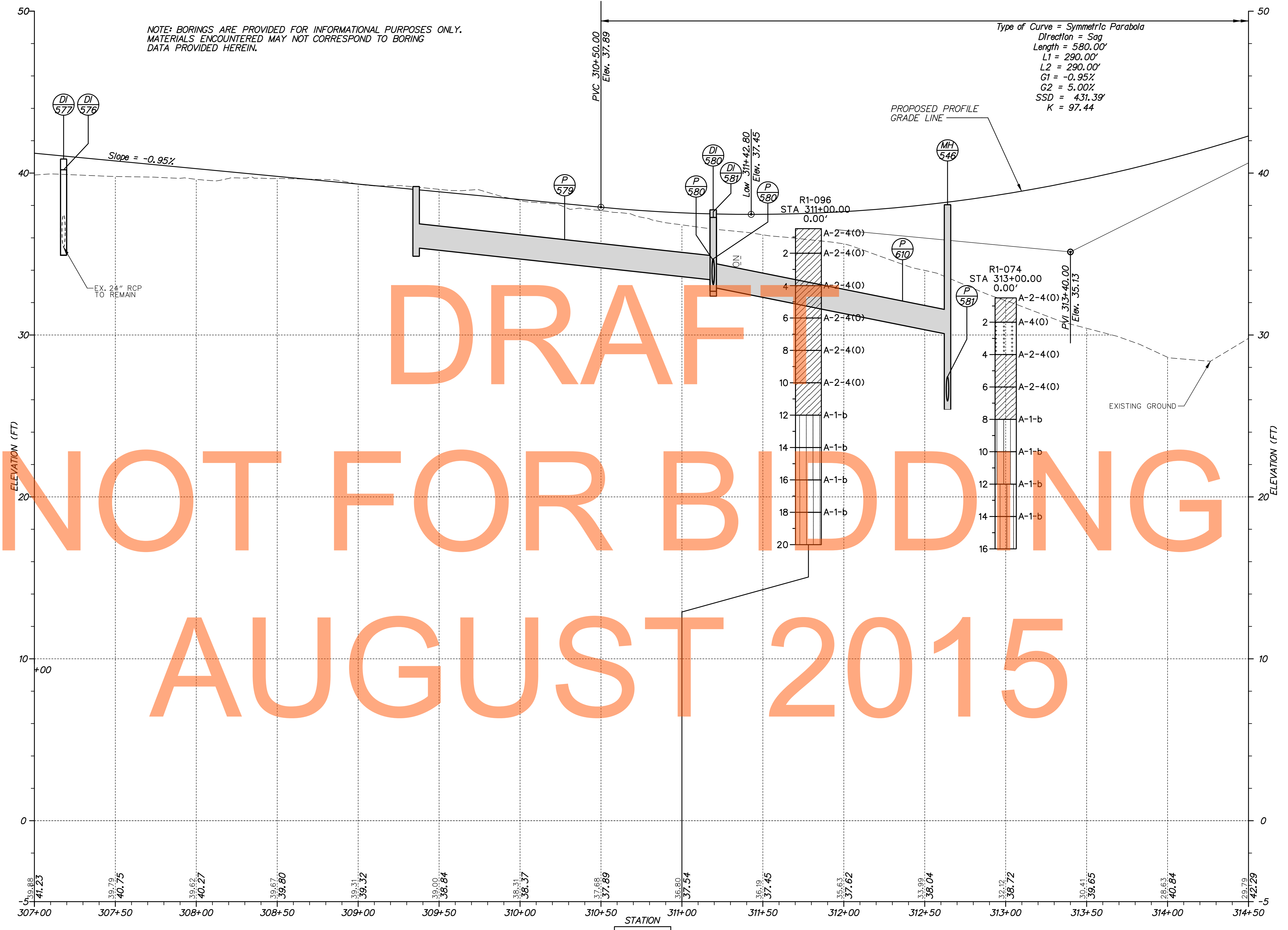

DRAFT  
NOT FOR BIDDING  
AUGUST 2015

p:\17653-000\centric\1d\cead\PF002U301\_ID.dgn 9/17/2015 9:41:24 AM



ADDENDUMS / REVISIONS	

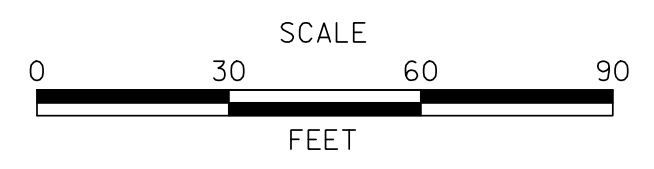

**US 13 & PORT PENN RD INTERSECTION**

CONTRACT T201011302	BRIDGE NO.
COUNTY NEW CASTLE	DESIGNED BY: SES
	CHECKED BY: BRT

**PROFILES**

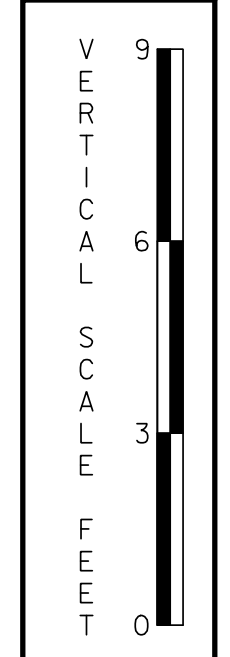

PF-02
SHEET NO. 38
TOTAL SHTS. 179





NOTE: BORINGS ARE PROVIDED FOR INFORMATIONAL PURPOSES ONLY.  
MATERIALS ENCOUNTERED MAY NOT CORRESPOND TO BORING  
DATA PROVIDED HEREIN.

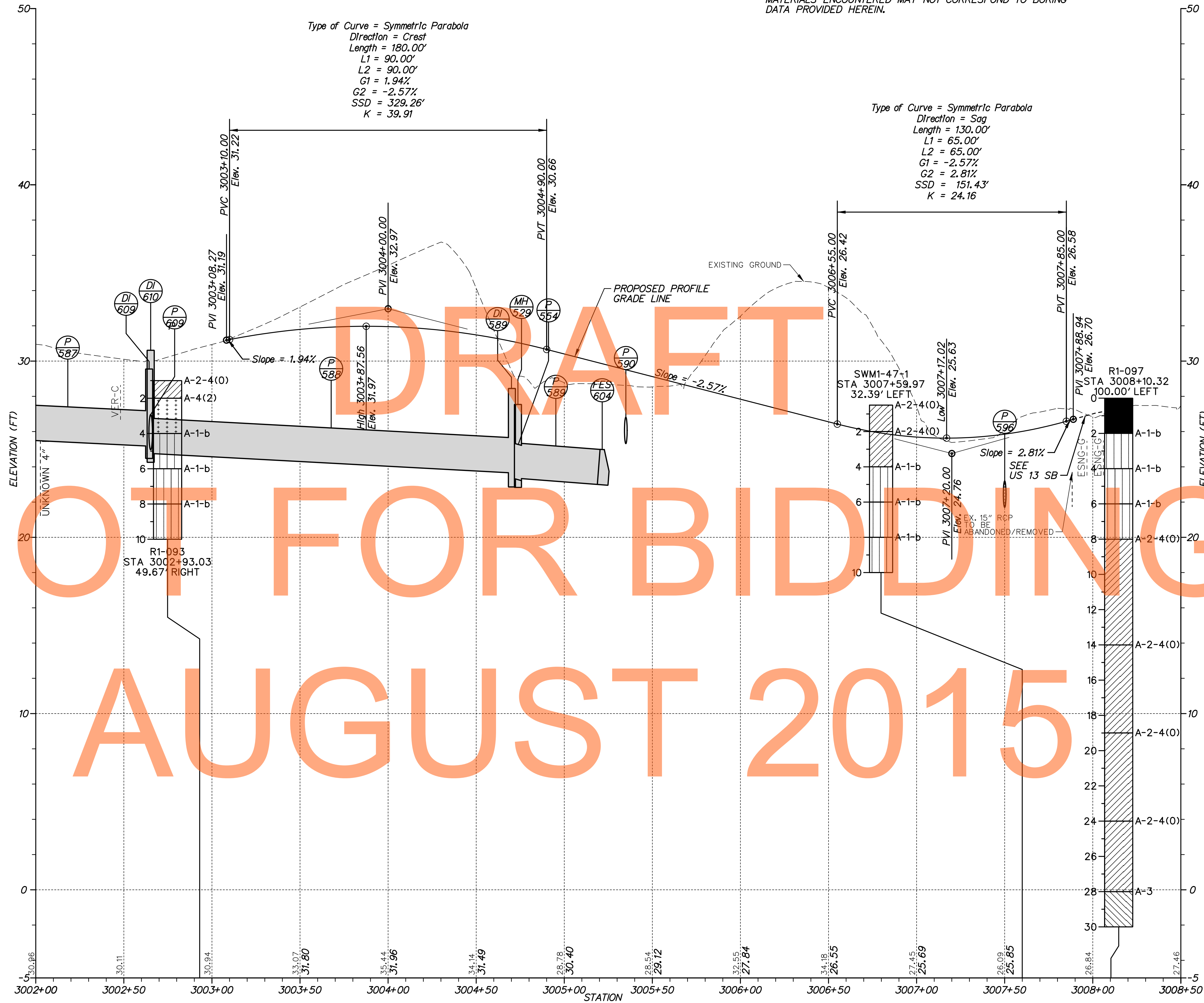

DRAFT

NOT FOR BIDDING

AUGUST 2015

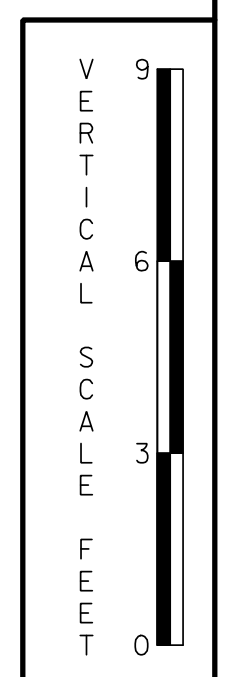

TOLL PLAZA ROAD



US 13 & PORT PENN RD INTERSECTION

CONTRACT	BRIDGE NO.
T201011302	
COUNTY	DESIGNED BY: SES
NEW CASTLE	CHECKED BY: BRT

PROFILES

SHEET NO.	40
TOTAL SHTS.	179

P:\17653-000\contract\1d\cadd\PF004U301\_ID.dgn  
 9/17/2015 9:54:14 AM



ADDENDUMS / REVISIONS



NOTE: BORINGS ARE PROVIDED FOR INFORMATIONAL PURPOSES ONLY. MATERIALS ENCOUNTERED MAY NOT CORRESPOND TO BORING DATA PROVIDED HEREIN.

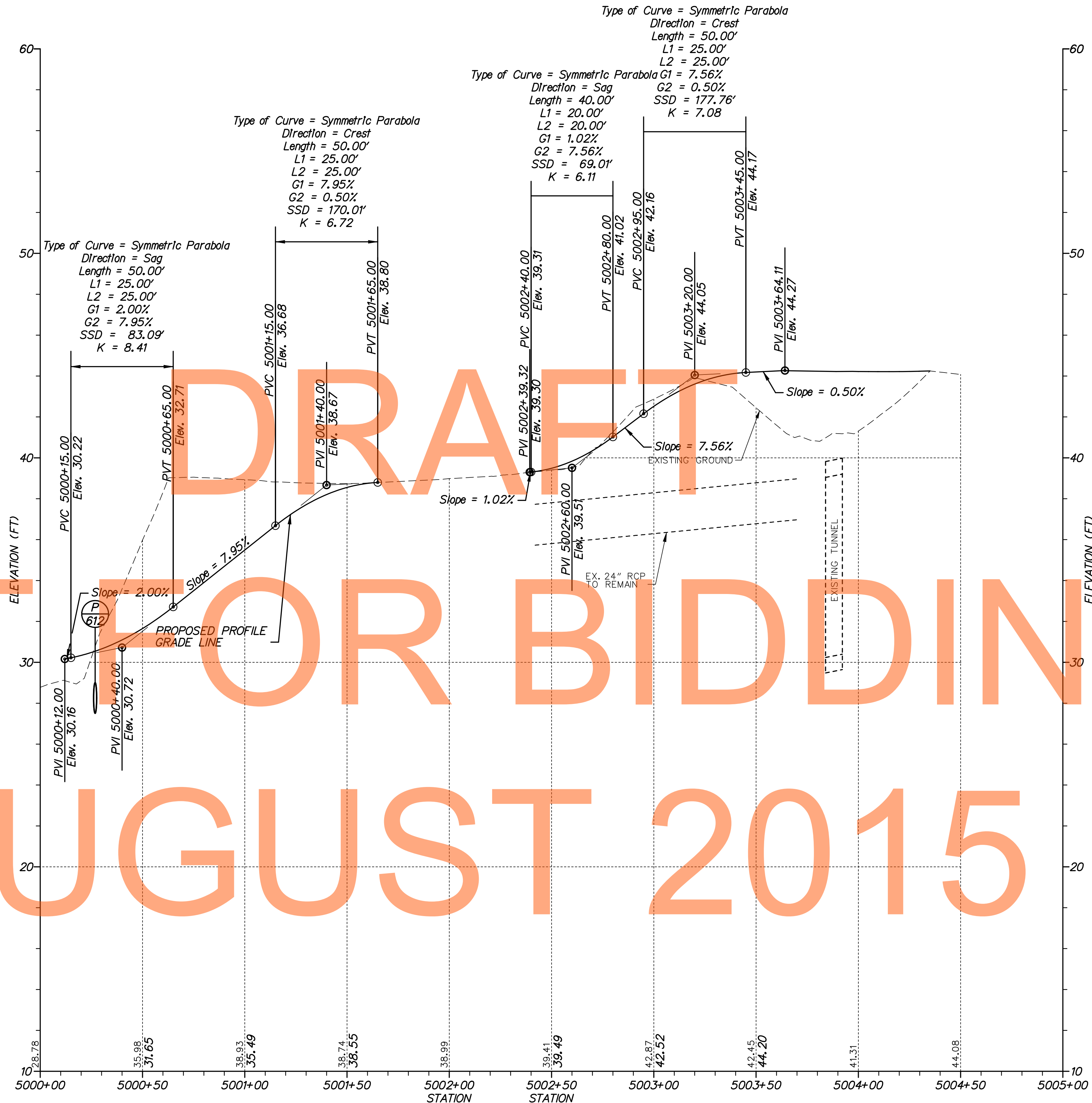

DRAFT  
NOT FOR BIDDING  
AUGUST 2015

FRONT PARKING LOT ACCESS ROAD

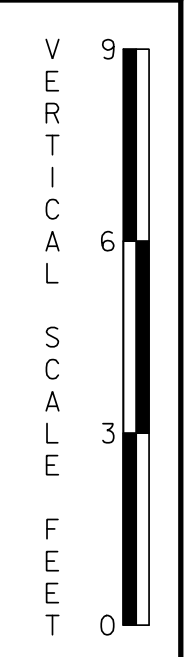

p:\17653-000\contract\1d\cead\PF005U301\_1D.dgn 8/17/2015 9:41:24 AM



ADDENDUMS / REVISIONS	



US 13 & PORT PENN RD INTERSECTION

CONTRACT	BRIDGE NO.	PROFILES
T201011302	DESIGNED BY: SES	
COUNTY	CHECKED BY: BRT	
NEW CASTLE		

PF-05
SHEET NO.
41
TOTAL SHTS.
179

Type of Curve = Symmetric Parabola  
 Direction = Sag  
 Length = 135.00'  
 L1 = 67.50'  
 L2 = 67.50'  
 G1 = -0.50%  
 G2 = 1.32%  
 SSD = 4332.12'  
 K = 73.99

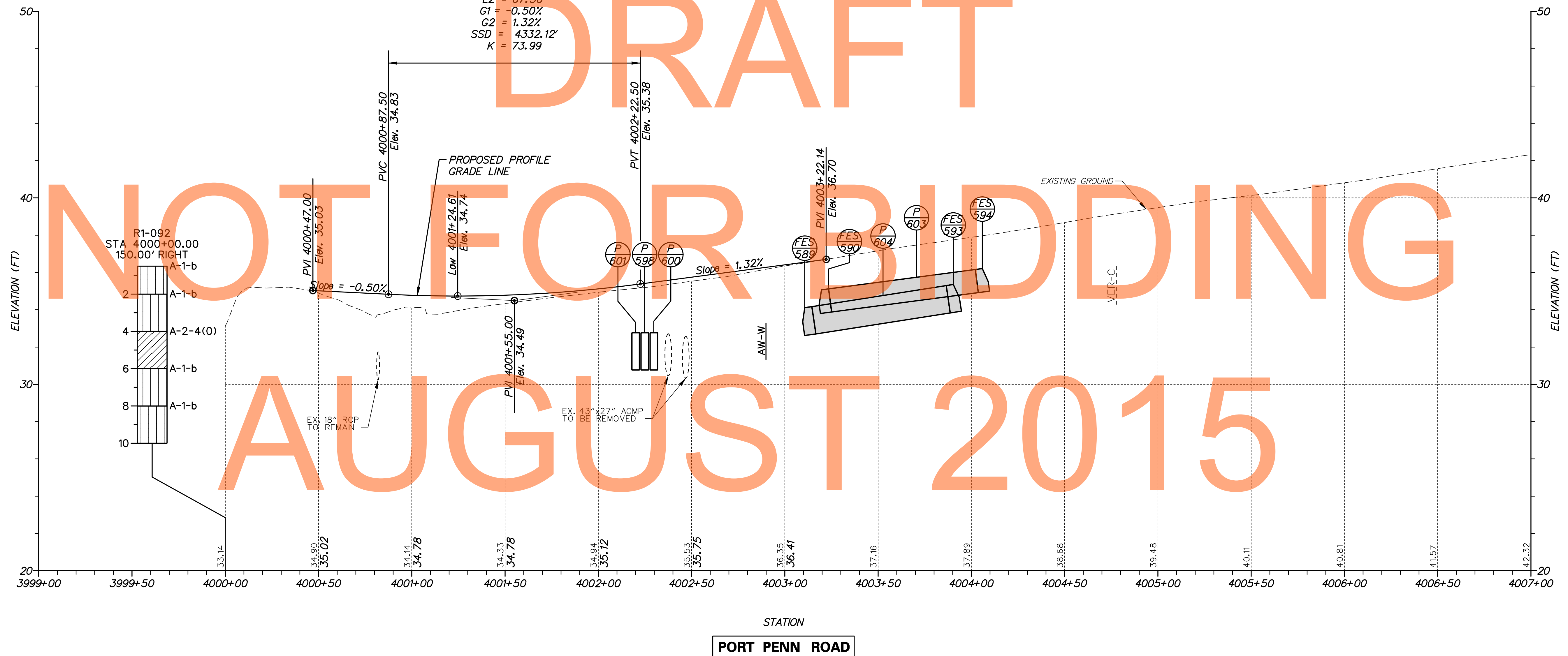

DRAFT  
NOT FOR BIDDING  
AUGUST 2015

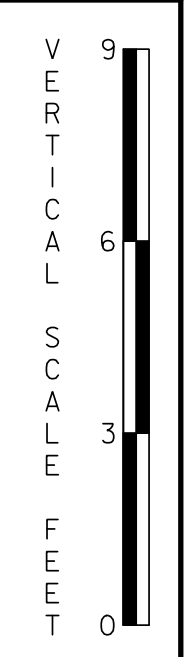

NOTE: BORINGS ARE PROVIDED FOR INFORMATIONAL PURPOSES ONLY. MATERIALS ENCOUNTERED MAY NOT CORRESPOND TO BORING DATA PROVIDED HEREIN.

P:\17172015\17172015\contract\1d\cead\PF006U301\_10.dgn 9/17/2015 9:54:18 AM



ADDENDUMS / REVISIONS	

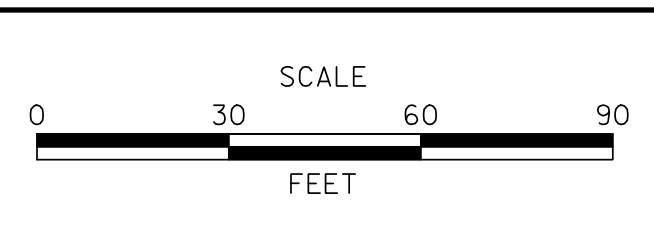

**US 13 & PORT PENN RD INTERSECTION**

CONTRACT	BRIDGE NO.
T201011302	
COUNTY	DESIGNED BY: SES
NEW CASTLE	CHECKED BY: BRT

<b>PROFILES</b>	SHEET NO.
	42
	TOTAL SHTS.
	179

PF-06

DRAFT  
NOT FOR BIDDING  
AUGUST 2015

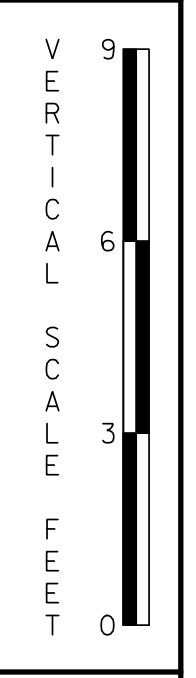

NOTE: BORINGS ARE PROVIDED FOR INFORMATIONAL PURPOSES ONLY. MATERIALS ENCOUNTERED MAY NOT CORRESPOND TO BORING DATA PROVIDED HEREIN.

P:\171653-000\centric\proj\1d\ceadh\PF007U301\_1D.dgn 9/17/2015 9:41:24 AM



ADDENDUMS / REVISIONS	

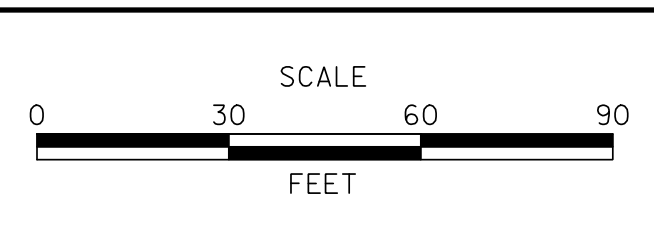

**US 13 & PORT PENN RD  
INTERSECTION**

CONTRACT	BRIDGE NO.
T201011302	
COUNTY	DESIGNED BY: SES
NEW CASTLE	CHECKED BY: BRT

<b>PROFILES</b>	SHEET NO.
	43
	TOTAL SHTS.
	179

**PF-07**



NOTE: BORINGS ARE PROVIDED FOR INFORMATIONAL PURPOSES ONLY.  
MATERIALS ENCOUNTERED MAY NOT CORRESPOND TO BORING  
DATA PROVIDED HEREIN.

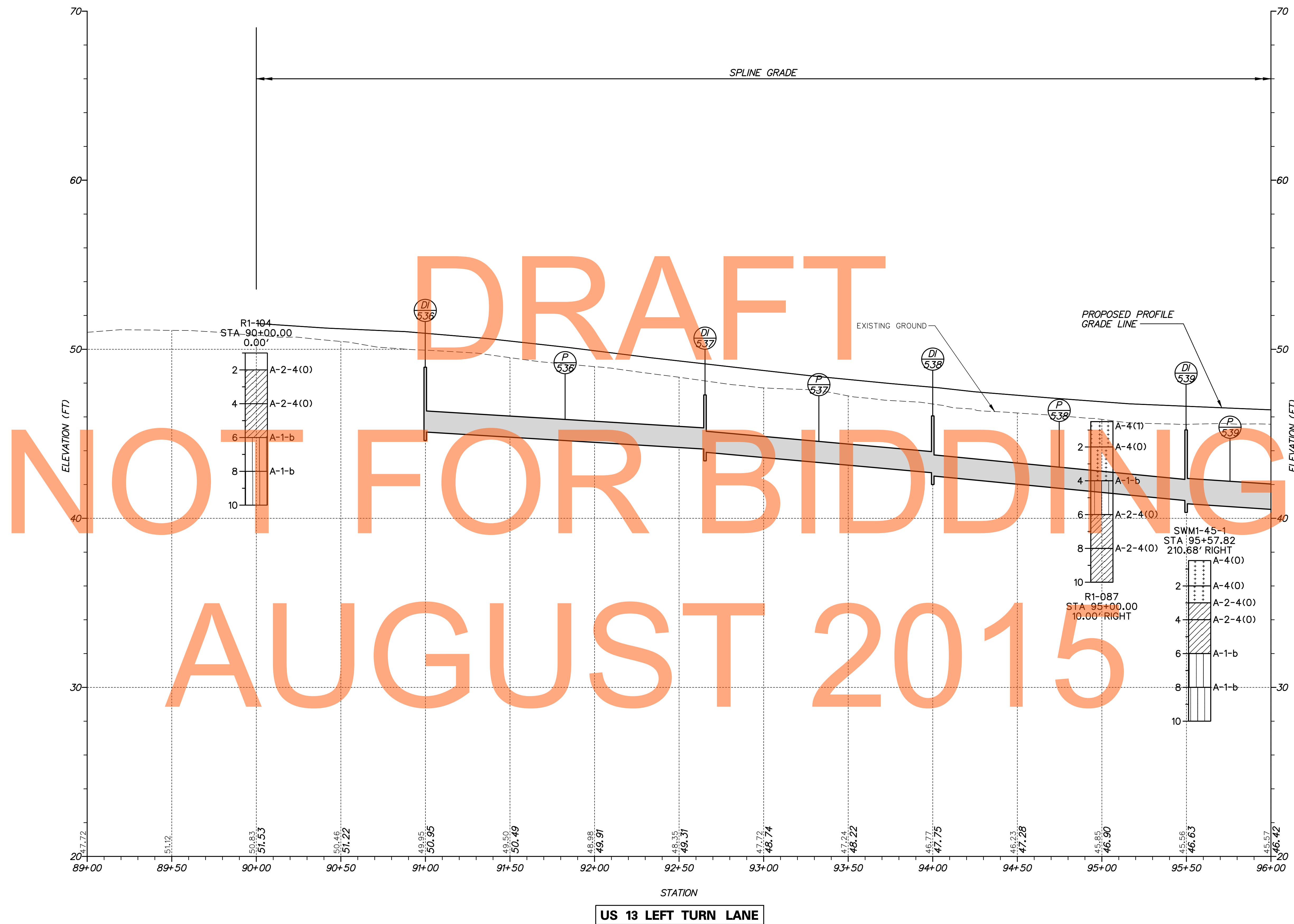

DRAFT  
NOT FOR BIDDING  
AUGUST 2015

US 13 LEFT TURN LANE

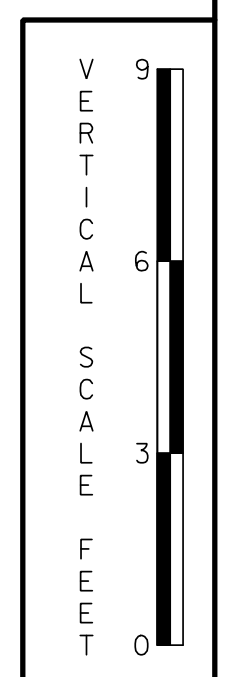

PF-08

p:\17172015\000\centr\ref\1d\cead\PF0808U301\_10.dgn



ADDENDUMS / REVISIONS	



US 13 & PORT PENN RD  
INTERSECTION

CONTRACT T201011302	BRIDGE NO.
COUNTY NEW CASTLE	DESIGNED BY: JAD
	CHECKED BY: BRT

PROFILES

SHEET NO.	44
TOTAL SHTS.	179



NOTE: BORINGS ARE PROVIDED FOR INFORMATIONAL PURPOSES ONLY.  
MATERIALS ENCOUNTERED MAY NOT CORRESPOND TO BORING  
DATA PROVIDED HEREIN.

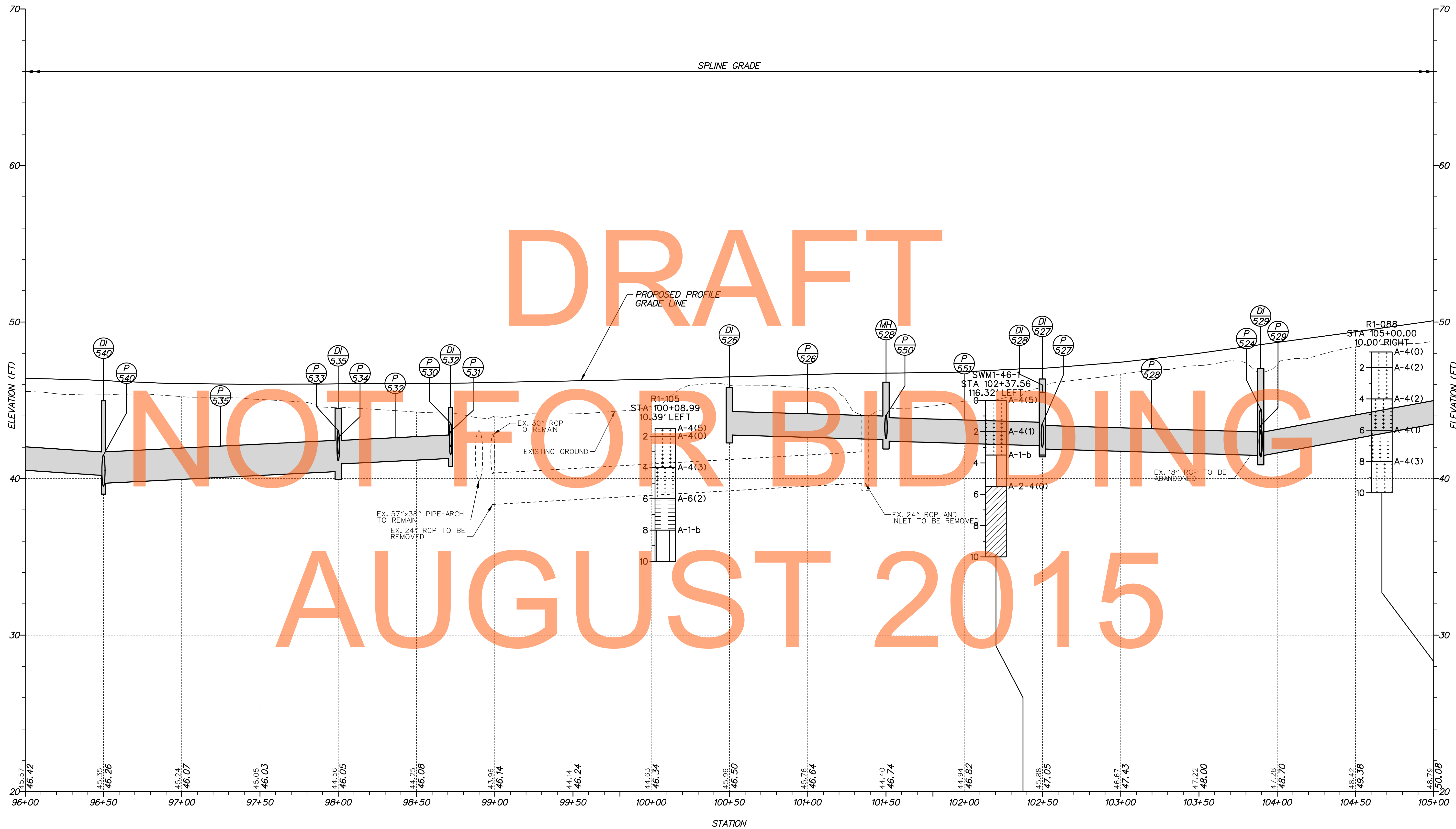

DRAFT  
NOT FOR BIDDING  
AUGUST 2015

US 13 LEFT TURN LANE

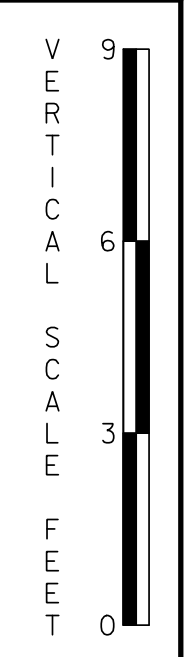

ADDENDUMS / REVISIONS	

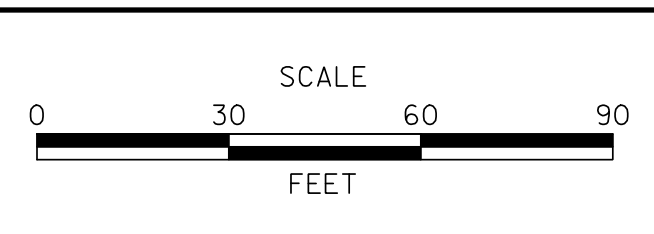

**US 13 & PORT PENN RD  
INTERSECTION**

CONTRACT T201011302	BRIDGE NO. 
COUNTY NEW CASTLE	DESIGNED BY: JAD CHECKED BY: BRT

**PROFILES**

SHEET NO. 45
TOTAL SHTS. 179

P:\17172015\17172015\contract\1d\cead\PF09090301\_1b.dgn  
 8/17/2015 9:41:18 AM

NOTE: BORINGS ARE PROVIDED FOR INFORMATIONAL PURPOSES ONLY. MATERIALS ENCOUNTERED MAY NOT CORRESPOND TO BORING DATA PROVIDED HEREIN.

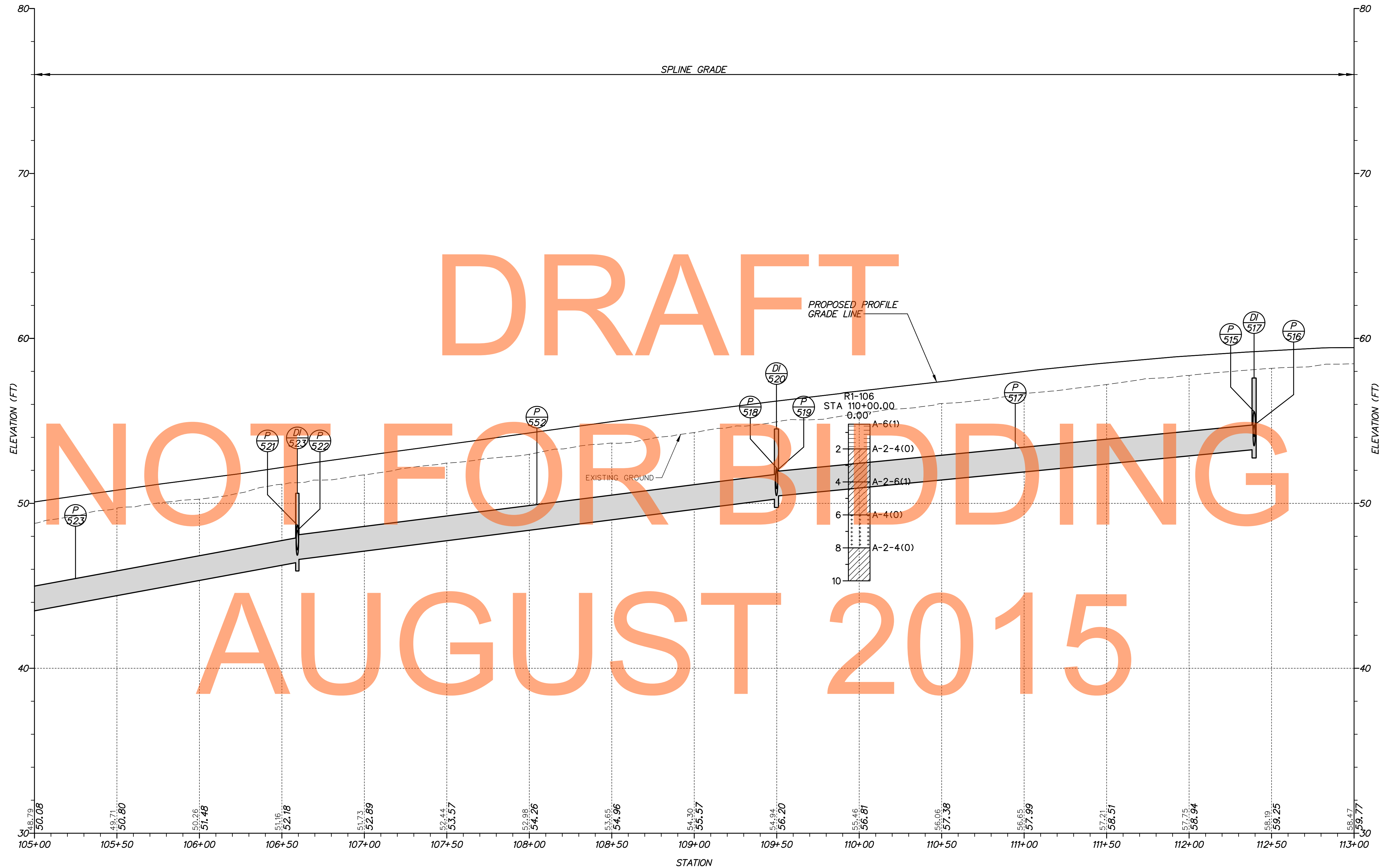

DRAFT  
NOT FOR BIDDING  
AUGUST 2015

US 13 LEFT TURN LANE

P:\17172015\17172015\17172015.dwg



ADDENDUMS / REVISIONS



US 13 & PORT PENN RD INTERSECTION

CONTRACT T201011302	BRIDGE NO.
COUNTY NEW CASTLE	DESIGNED BY: JAD
	CHECKED BY: BRT

PROFILES

VERTICAL SCALE FEET	9
	6
	3
	0
PF-10	
SHEET NO.	46
TOTAL SHTS.	179

NOTE: BORINGS ARE PROVIDED FOR INFORMATIONAL PURPOSES ONLY.  
MATERIALS ENCOUNTERED MAY NOT CORRESPOND TO BORING  
DATA PROVIDED HEREIN.

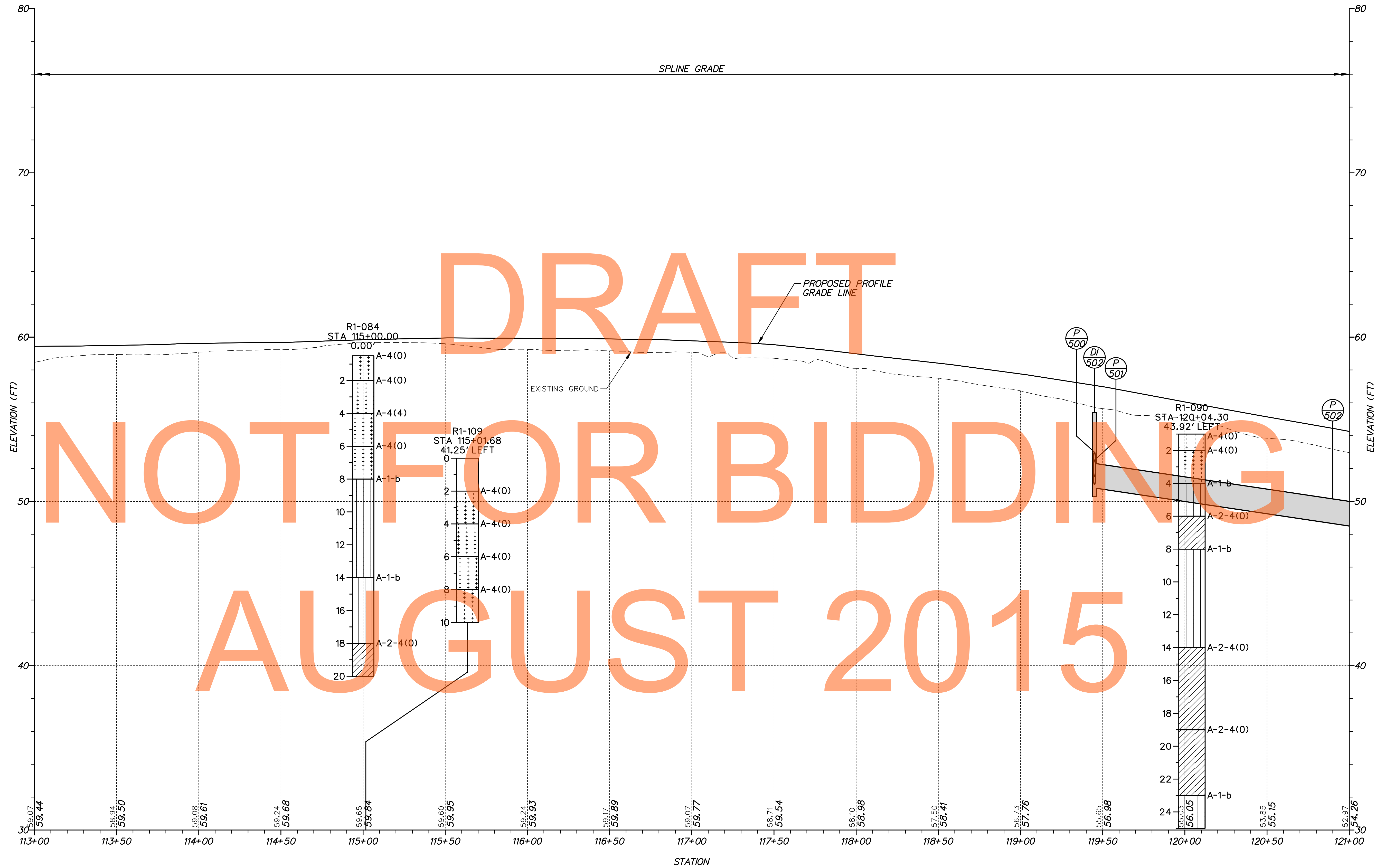

DRAFT  
NOT FOR BIDDING  
AUGUST 2015

US 13 LEFT TURN LANE

p:\1653-000\contract\1d\cead\PF0110301\_1.dgn 9/17/2015 9:44:20 AM



ADDENDUMS / REVISIONS



US 13 & PORT PENN RD INTERSECTION

CONTRACT	BRIDGE NO.
T201011302	DESIGNED BY: JAD
COUNTY	CHECKED BY: BRT
NEW CASTLE	

PROFILES

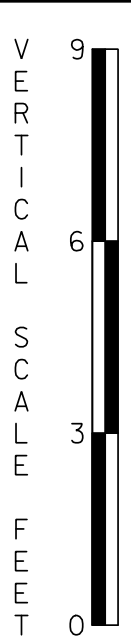

PF-11

SHEET NO.
47
TOTAL SHTS.
179



NOTE: BORINGS ARE PROVIDED FOR INFORMATIONAL PURPOSES ONLY.  
MATERIALS ENCOUNTERED MAY NOT CORRESPOND TO BORING  
DATA PROVIDED HEREIN.

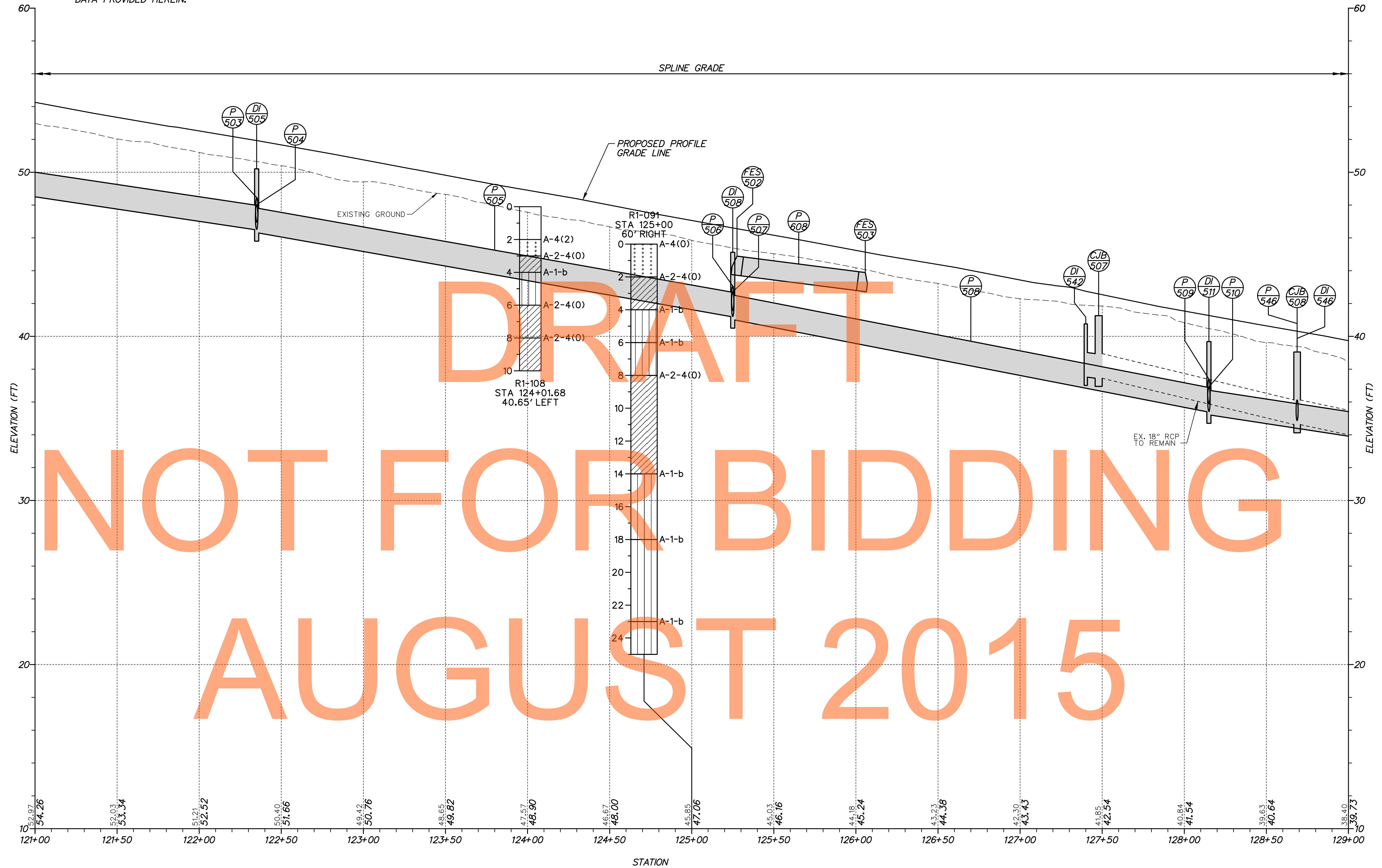

DRAFT  
NOT FOR BIDDING  
AUGUST 2015

US 13 LEFT TURN LANE

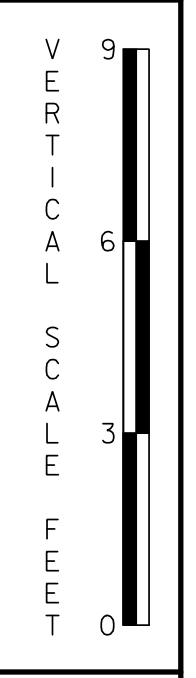

ADDENDUMS / REVISIONS	

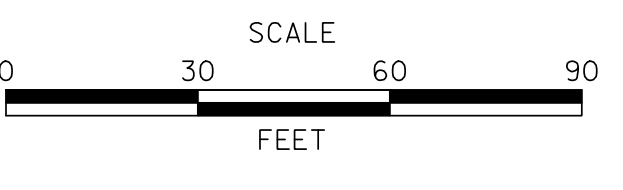

US 13 & PORT PENN RD  
INTERSECTION

CONTRACT T201011302	BRIDGE NO.
COUNTY NEW CASTLE	DESIGNED BY: JAD
	CHECKED BY: BRT

PROFILES

PF-12
SHEET NO. 48
TOTAL SHTS. 179

P:\17\1653-000\contract\1d\cead\PF012030\_1.D.dgn 8/17/2015 9:42 AM

NOTE: BORINGS ARE PROVIDED FOR INFORMATIONAL PURPOSES ONLY. MATERIALS ENCOUNTERED MAY NOT CORRESPOND TO BORING DATA PROVIDED HEREIN.

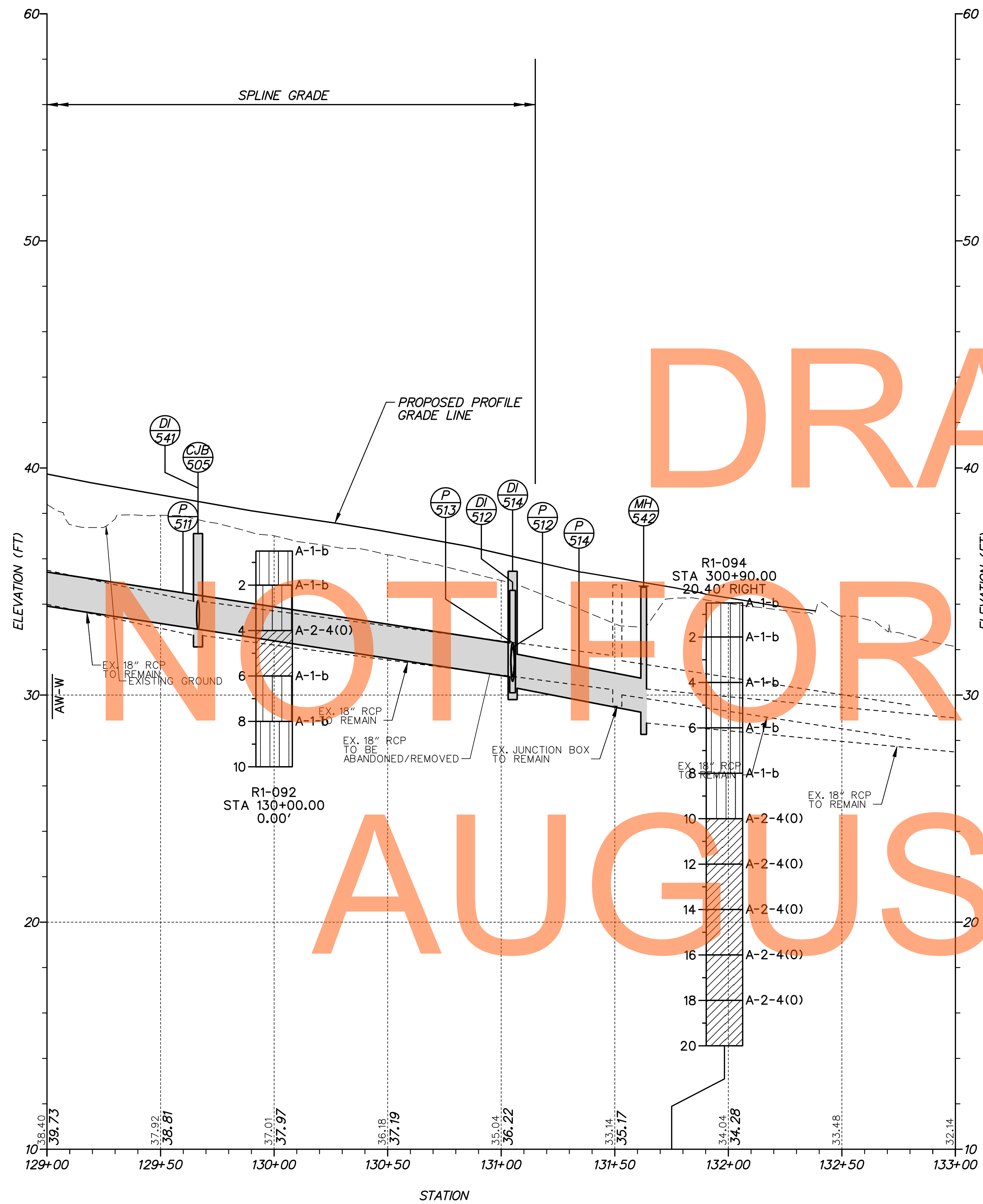

US 13 LEFT TURN LANE

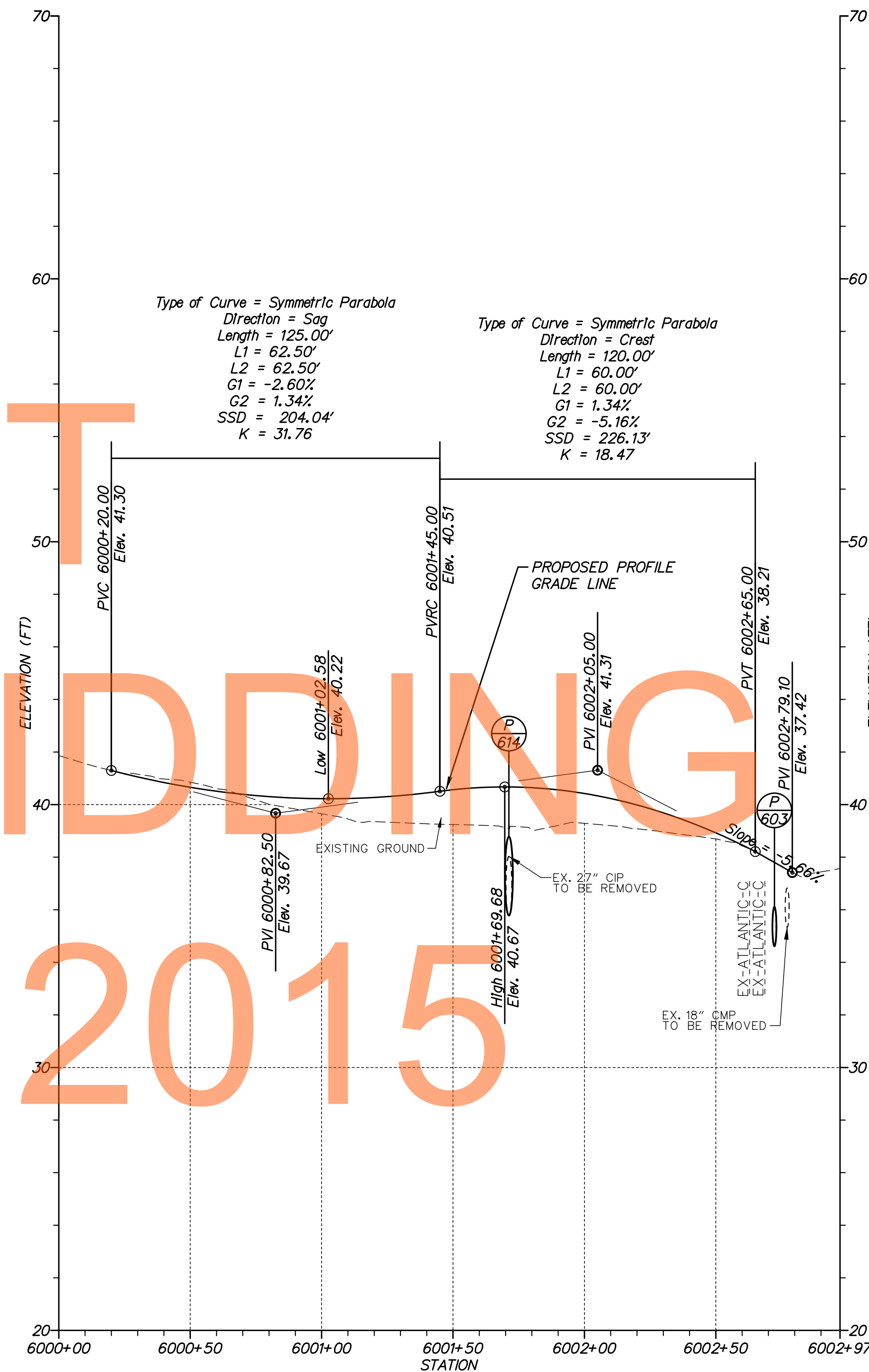

CHES-DEL DRIVEWAY

DRAFT  
NOT FOR BIDDING  
AUGUST 2015

p:\1653-000\contract\1653\cadd\PF0130301\_1D.dgn 9/17/2015 9:42 AM



ADDENDUMS / REVISIONS	



**US 13 & PORT PENN RD INTERSECTION**

CONTRACT	BRIDGE NO.
T201011302	
COUNTY	DESIGNED BY: JAD
NEW CASTLE	CHECKED BY: BRT

**PROFILES**

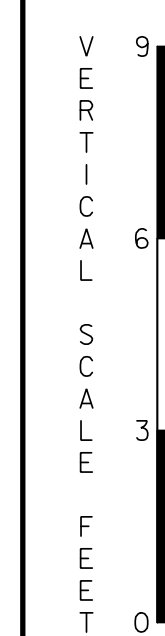

PF-13
SHEET NO.
49
TOTAL SHTS.
179