

COORDINATE LIST				
POINT NO.	STATION	OFFSET	NORTHING	EASTING
60000	89+99.86	19.00	551279.6225	590601.9701
60001	89+99.86	23.00	551279.5697	590605.9674
60002	93+46.36	23.00	551626.0399	590610.5430
60003	94+72.97	0.60	551752.9358	590589.8169
60004	94+72.97	2.60	551752.9094	590591.8179
60224	91+84.79	-3.40	551464.8332	590582.0118
60225	91+84.79	0.60	551464.7804	590586.0114
60226	95+30.63	-3.40	551810.6412	590586.5786

- NOTES:
1. OFFSETS SHOWN IN THE GEOMETRY TABLES WITH A MINUS SIGN ARE TO THE LEFT OF THE CONSTRUCTION BASELINE.
  2. UNLESS OTHERWISE NOTED, POINT GEOMETRY ADJACENT TO CURB AND GUTTER IS GIVEN TO THE EDGE OF PAVEMENT.
  3. RADIARE GIVEN TO THE EDGE OF PAVEMENT.
  4. UNLESS OTHERWISE NOTED, EDGE OF PAVEMENT ELEVATIONS AT CURB RETURNS ARE GIVEN AT 10 FOOT INTERVALS
  5. PROPOSED CURB OR PAVEMENT THAT TIES INTO EXISTING PAVEMENT OR EXISTING CURBS SHALL MATCH THE EXISTING PAVEMENT OR CURB ELEVATIONS AND CROSS SLOPES.

**BEGIN  
CONTRACT T201011302  
STATION 80+50**



DRAFT  
NOT FOR BIDDING  
AUGUST 2015

p:\17172015\contract\1d\ceadh\G6000U301.dgn 9/17/2015 10:25:16 AM



ADDENDUMS / REVISIONS	

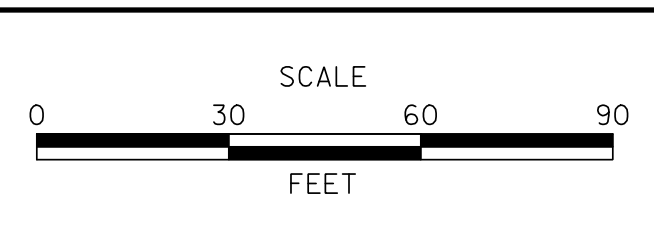

**US 13 & PORT PENN RD  
INTERSECTION**

CONTRACT T201011302	BRIDGE NO.
COUNTY NEW CASTLE	DESIGNED BY: N.S.P.
	CHECKED BY: B.R.T.

**GRADES & GEOMETRICS**

<b>GG-01</b>
SHEET NO. 50
TOTAL SHTS. 179

COORDINATE LIST				
POINT NO.	STATION	OFFSET	NORTHING	EASTING
60005	96+34.55	-3.00	551914.5424	590588.3508
60190	96+34.41	-7.00	551914.4566	590584.3518
60006	97+50.00	-3.00	552029.9862	590589.8754
60007	97+50.00	14.00	552029.7617	590606.8740
60008	97+50.00	18.00	552029.7089	590610.8736
60010	100+43.52	-19.00	552323.6958	590577.7529
60151	104+90.14	-19.00	552770.2719	590583.6506

**NOTES:**

- OFFSETS SHOWN IN THE GEOMETRY TABLES WITH A MINUS SIGN ARE TO THE LEFT OF THE CONSTRUCTION BASELINE.
- UNLESS OTHERWISE NOTED, POINT GEOMETRY ADJACENT TO CURB AND GUTTER IS GIVEN TO THE EDGE OF PAVEMENT.
- RADI ARE GIVEN TO THE EDGE OF PAVEMENT.
- UNLESS OTHERWISE NOTED, EDGE OF PAVEMENT ELEVATIONS AT CURB RETURNS ARE GIVEN AT 10 FOOT INTERVALS.
- PROPOSED CURB OR PAVEMENT THAT TIES INTO EXISTING PAVEMENT OR EXISTING CURBS SHALL MATCH THE EXISTING PAVEMENT OR CURB ELEVATIONS AND CROSS SLOPES.

MATCH LINE STA. 96+00

MATCH LINE STA. 105+00

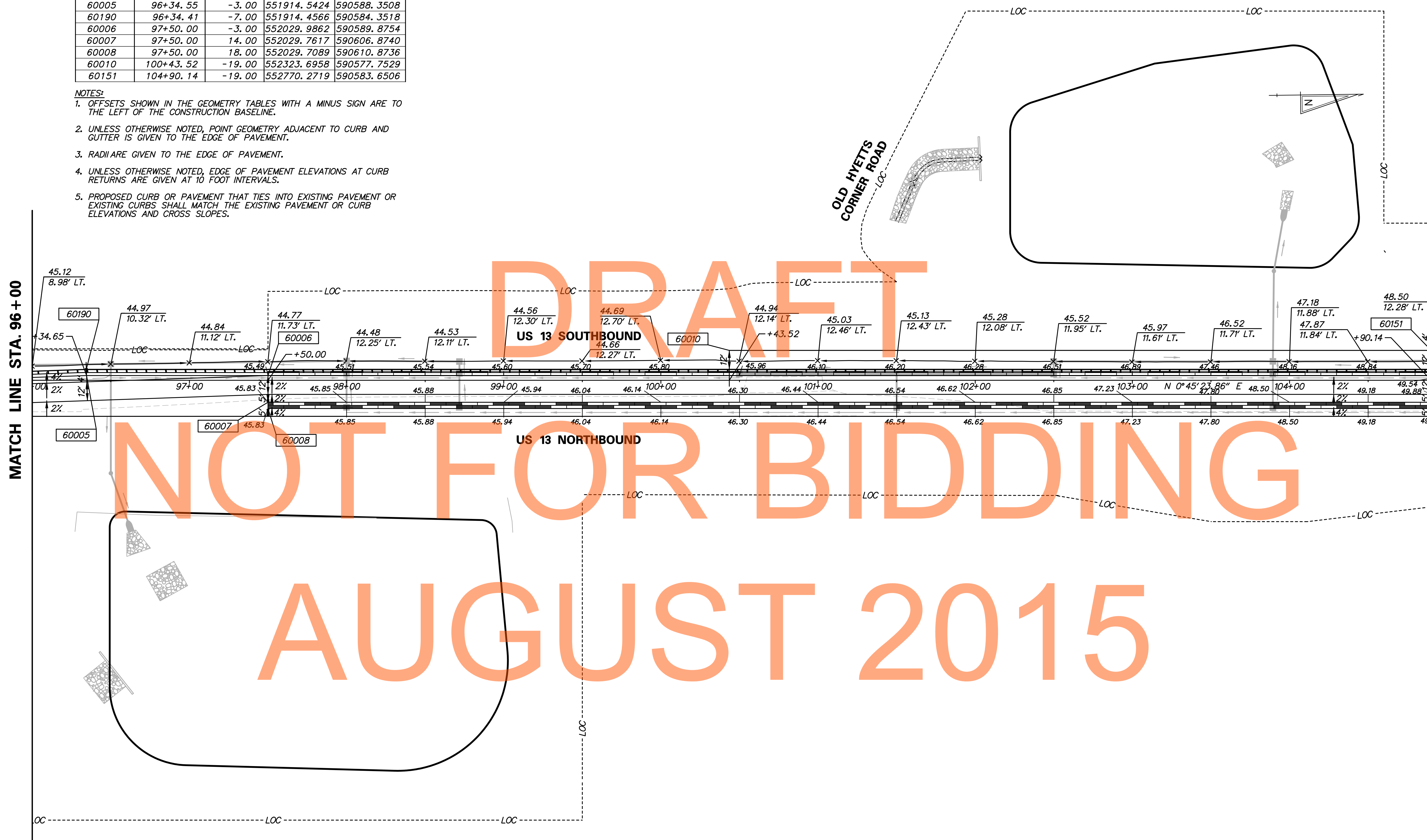

DRAFT

NOT FOR BIDDING

AUGUST 2015

p:\17055-000\contract\14\ceadh\G6002\1301\_1D.dgn 9/17/2015 10:52:17 AM



ADDENDUMS / REVISIONS	

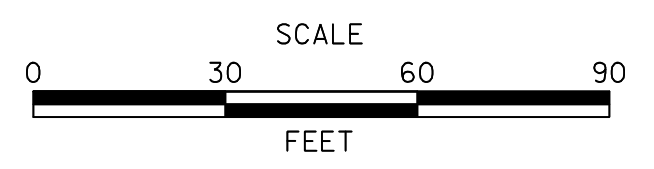

**US 13 & PORT PENN RD INTERSECTION**

CONTRACT T201011302	BRIDGE NO.
COUNTY NEW CASTLE	DESIGNED BY: N.S.P.
	CHECKED BY: B.R.T.

**GRADES & GEOMETRICS**

GG-02
SHEET NO. 51
TOTAL SHTS. 179



COORDINATE LIST				
POINT NO.	STATION	OFFSET	NORTHING	EASTING
60012	110+34.84	-57.00	553315.4252	590552.8481
60013	110+35.00	-47.00	553315.4552	590562.8480

- NOTES:
- OFFSETS SHOWN IN THE GEOMETRY TABLES WITH A MINUS SIGN ARE TO THE LEFT OF THE CONSTRUCTION BASELINE.
  - UNLESS OTHERWISE NOTED, POINT GEOMETRY ADJACENT TO CURB AND GUTTER IS GIVEN TO THE EDGE OF PAVEMENT.
  - RADIARE GIVEN TO THE EDGE OF PAVEMENT.
  - UNLESS OTHERWISE NOTED, EDGE OF PAVEMENT ELEVATIONS AT CURB RETURNS ARE GIVEN AT 10 FOOT INTERVALS.
  - PROPOSED CURB OR PAVEMENT THAT TIES INTO EXISTING PAVEMENT OR EXISTING CURBS SHALL MATCH THE EXISTING PAVEMENT OR CURB ELEVATIONS AND CROSS SLOPES.

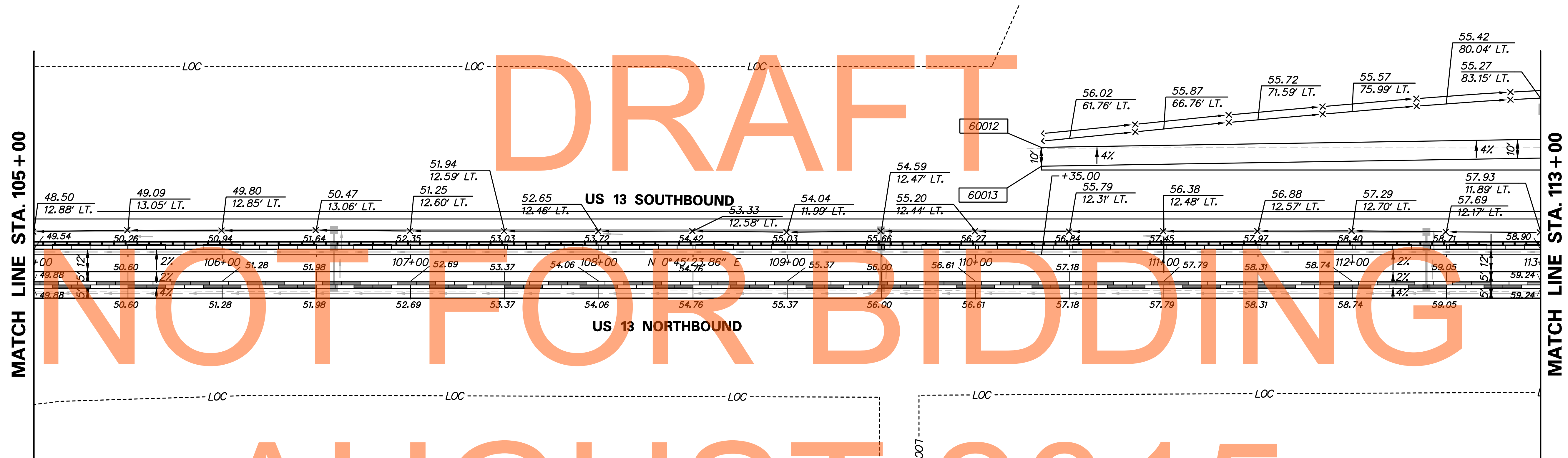
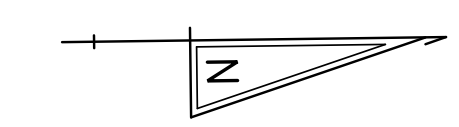

DRAFT  
NOT FOR BIDDING  
AUGUST 2015

p:\17172015\000\contract\1d\ceadh\G6003\1301\_ID.dgn 8/17/2015 10:05:18 AM



ADDENDUMS / REVISIONS	

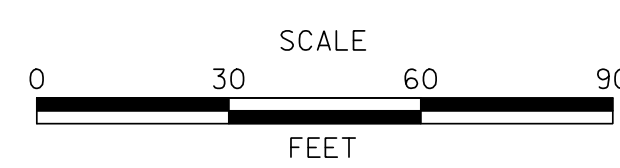

**US 13 & PORT PENN RD INTERSECTION**

CONTRACT T201011302	BRIDGE NO.
COUNTY NEW CASTLE	DESIGNED BY: N.S.P.
	CHECKED BY: B.R.T.

**GRADES & GEOMETRICS**

GG-03
SHEET NO. 52
TOTAL SHTS. 179





COORDINATE LIST				
POINT NO.	STATION	OFFSET	NORTHING	EASTING
60021	121+35.58	-19.00	554415.4747	590602.7385
60022	124+45.00	55.00	554724.3751	590678.8891
60023	124+45.00	59.00	554724.3473	590682.8890
60024	125+08.19	59.00	554787.5360	590683.3285
60025	125+08.19	109.00	554787.1885	590733.3273
60026	125+39.13	69.73	554818.4044	590694.2692
60027	126+02.47	85.06	554881.6346	590710.0397
60028	126+37.50	133.98	554916.3185	590759.2070
60029	126+14.46	96.99	554893.5437	590722.0562
60030	126+08.12	79.39	554887.3169	590704.4083
60031	126+04.32	72.34	554883.5747	590697.3375
60032	126+35.86	64.00	554915.1691	590689.2165
60232	123+15.00	-69.00	554595.2408	590553.9878
60233	123+40.00	-94.00	554620.4141	590529.1623

- NOTES:
1. OFFSETS SHOWN IN THE GEOMETRY TABLES WITH A MINUS SIGN ARE TO THE LEFT OF THE CONSTRUCTION BASELINE.
  2. UNLESS OTHERWISE NOTED, POINT GEOMETRY ADJACENT TO CURB AND GUTTER IS GIVEN TO THE EDGE OF PAVEMENT.
  3. RADII ARE GIVEN TO THE EDGE OF PAVEMENT.
  4. UNLESS OTHERWISE NOTED, EDGE OF PAVEMENT ELEVATIONS AT CURB RETURNS ARE GIVEN AT 10 FOOT INTERVALS.
  5. PROPOSED CURB OR PAVEMENT THAT TIES INTO EXISTING PAVEMENT OR EXISTING CURBS SHALL MATCH THE EXISTING PAVEMENT OR CURB ELEVATIONS AND CROSS SLOPES.

COORDINATE LIST				
POINT NO.	STATION	OFFSET	NORTHING	EASTING
60234	123+15.00	-94.00	554595.4147	590528.9884
60235	123+40.00	-102.98	554620.4766	590520.1794
60236	123+60.00	-102.98	554640.4761	590520.3185
60237	123+60.00	-94.00	554640.4136	590529.3014
60238	123+85.00	-94.00	554665.4130	590529.4753
60239	123+85.00	-69.00	554665.2391	590554.4747
60256	125+68.00	67.01	554847.2913	590691.7558
60257	125+69.73	64.00	554849.0376	590688.7565
60258	125+84.38	64.00	554863.6911	590688.8584
60259	125+85.23	65.52	554864.5320	590690.3885
60260	125+81.22	83.06	554860.3999	590707.8939
60261	125+75.04	84.15	554854.2056	590708.9468
60262	126+00.29	88.55	554879.4300	590713.5143
60263	126+11.67	99.82	554890.7296	590724.8656
60264	125+47.74	88.53	554826.8841	590713.1332
60265	125+11.06	100.39	554790.1220	590724.7356
60266	126+09.08	80.20	554888.2732	590705.2329
60267	125+69.73	66.00	554849.0237	590690.7564
60268	125+78.37	84.94	554857.5304	590709.7597
60269	125+84.38	65.00	554863.6841	590689.8584

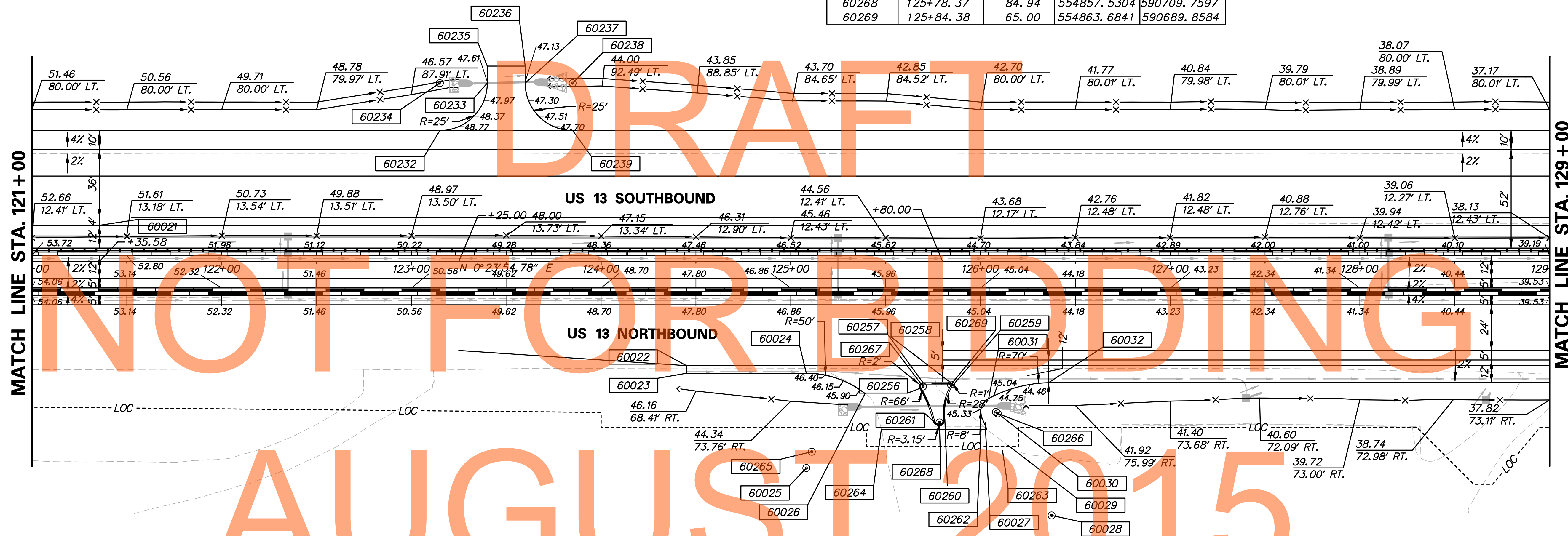
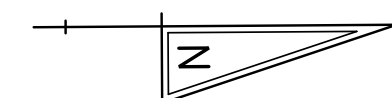

P:\17172015\17172015.ctb\17172015.dwg  
 8/17/2015 10:52:52 AM



ADDENDUMS / REVISIONS	



**US 13 & PORT PENN RD INTERSECTION**

CONTRACT	BRIDGE NO.
T201011302	
COUNTY	DESIGNED BY: N.S.P.
NEW CASTLE	CHECKED BY: B.R.T.

**GRADES & GEOMETRICS**

GG-05
SHEET NO.
54
TOTAL SHTS.
179



COORDINATE LIST				
POINT NO.	STATION	OFFSET	NORTHING	EASTING
60039	129+78.37	64.00	555257.6677	590691.5989
60040	129+93.32	77.79	555272.5227	590705.4943
60041	129+78.37	79.00	555257.5634	590706.5986
60043	130+19.00	64.00	555298.2940	590691.8815
60044	130+19.00	79.00	555298.1896	590706.8812
60045	130+04.04	77.79	555283.2471	590705.5689
60050	133+00.00	47.00	555579.4101	590676.8366
60052	133+00.00	57.00	555579.3405	590686.8364
60053	133+00.00	61.08	555579.3122	590690.9164
60057	131+15.00	14.00	555394.6441	590642.5506
60058	131+15.00	18.00	555394.6163	590646.5505
60072	132+38.45	-76.00	555518.7149	590553.4114
60074	133+82.50	-76.00	555662.7600	590554.4134
60076	3000+35.00	-75.05	555542.1442	590421.4855
60077	3000+35.00	-30.00	555535.8122	590466.0884
60078	3000+17.00	-30.00	555517.9909	590463.5585
60080	3000+17.00	15.00	555511.6659	590508.1117
60081	3000+88.43	33.00	555579.8598	590535.9733
60082	132+38.45	-80.00	555518.7427	590549.4115
60083	3000+56.86	15.00	555551.1322	590513.7145
60084	3000+75.10	33.00	555566.6570	590534.0990
60085	133+82.50	-80.00	555662.7878	590550.4135
60086	3001+78.17	33.57	555668.6272	590549.1548
60087	3001+56.82	12.50	555650.4512	590525.2892
60088	3001+80.23	36.34	555670.2794	590552.1795
60089	3000+64.00	-10.98	555561.8547	590488.9960
60090	3000+59.00	-15.98	555557.6034	590483.3423
60091	3000+64.00	-15.98	555562.5537	590484.0451
60092	3000+64.00	-25.20	555563.8499	590474.9146
60093	3000+59.00	-25.20	555558.8996	590474.2118
60094	3000+63.99	-30.20	555564.5418	590469.9627
60095	3001+75.24	-11.12	555672.0067	590504.4954
60096	3001+22.58	-81.81	555629.8095	590427.1039
60097	3001+23.14	-114.50	555634.9586	590394.8193
60098	5004+44.41	4.80	555600.8114	590366.9656
60099	5004+41.74	7.00	555602.5787	590363.9865
60100	304+26.24	24.00	555659.7239	590336.4376
60101	5003+64.10	-19.20	555680.1722	590378.6616
60102	303+33.84	52.92	555591.6320	590382.4393
60103	5003+48.57	-7.00	555695.7590	590367.9330
60104	301+64.25	-6.00	555446.7035	590449.5646
60105	301+64.25	-4.00	555448.5212	590450.3989
60106	305+13.66	-10.60	555746.9128	590309.7929
60107	3001+17.15	-114.60	555629.0335	590393.8743
60108	304+19.53	-19.56	555650.3515	590293.3850
60109	305+03.28	26.00	555731.6144	590344.6251
60110	304+84.50	-10.51	555718.0132	590305.8859
60111	304+84.50	-8.50	555717.7377	590307.8777
60152	304+70.95	68.03	555693.8374	590381.8280
60153	305+00.67	190.00	555706.5598	590506.7211
60195	302+42.54	-193.49	555355.0241	590254.6461
60196	302+70.69	-121.58	555438.1734	590274.9336
60197	303+26.11	-58.78	555536.0143	590285.2699
60198	304+19.86	-21.97	555650.5239	590290.9561
60199	304+14.29	-10.00	555645.6488	590303.3956
60200	302+63.15	-18.58	555498.1403	590359.2180
60201	304+77.98	29.16	555706.1187	590344.2938
60202	304+26.24	22.00	555659.6262	590334.4400
60222	3002+25.12	-52.25	555727.1712	590470.7815
60223	3001+99.21	-52.25	555701.5211	590467.1401

- NOTES:
- OFFSETS SHOWN IN THE GEOMETRY TABLES WITH A MINUS SIGN ARE TO THE LEFT OF THE CONSTRUCTION BASELINE.
  - UNLESS OTHERWISE NOTED, POINT GEOMETRY ADJACENT TO CURB AND GUTTER IS GIVEN TO THE EDGE OF PAVEMENT.
  - RADIARE GIVEN TO THE EDGE OF PAVEMENT.
  - UNLESS OTHERWISE NOTED, EDGE OF PAVEMENT ELEVATIONS AT CURB RETURNS ARE GIVEN AT 10 FOOT INTERVALS.
  - PROPOSED CURB OR PAVEMENT THAT TIES INTO EXISTING PAVEMENT OR EXISTING CURBS SHALL MATCH THE EXISTING PAVEMENT OR CURB ELEVATIONS AND CROSS SLOPES.

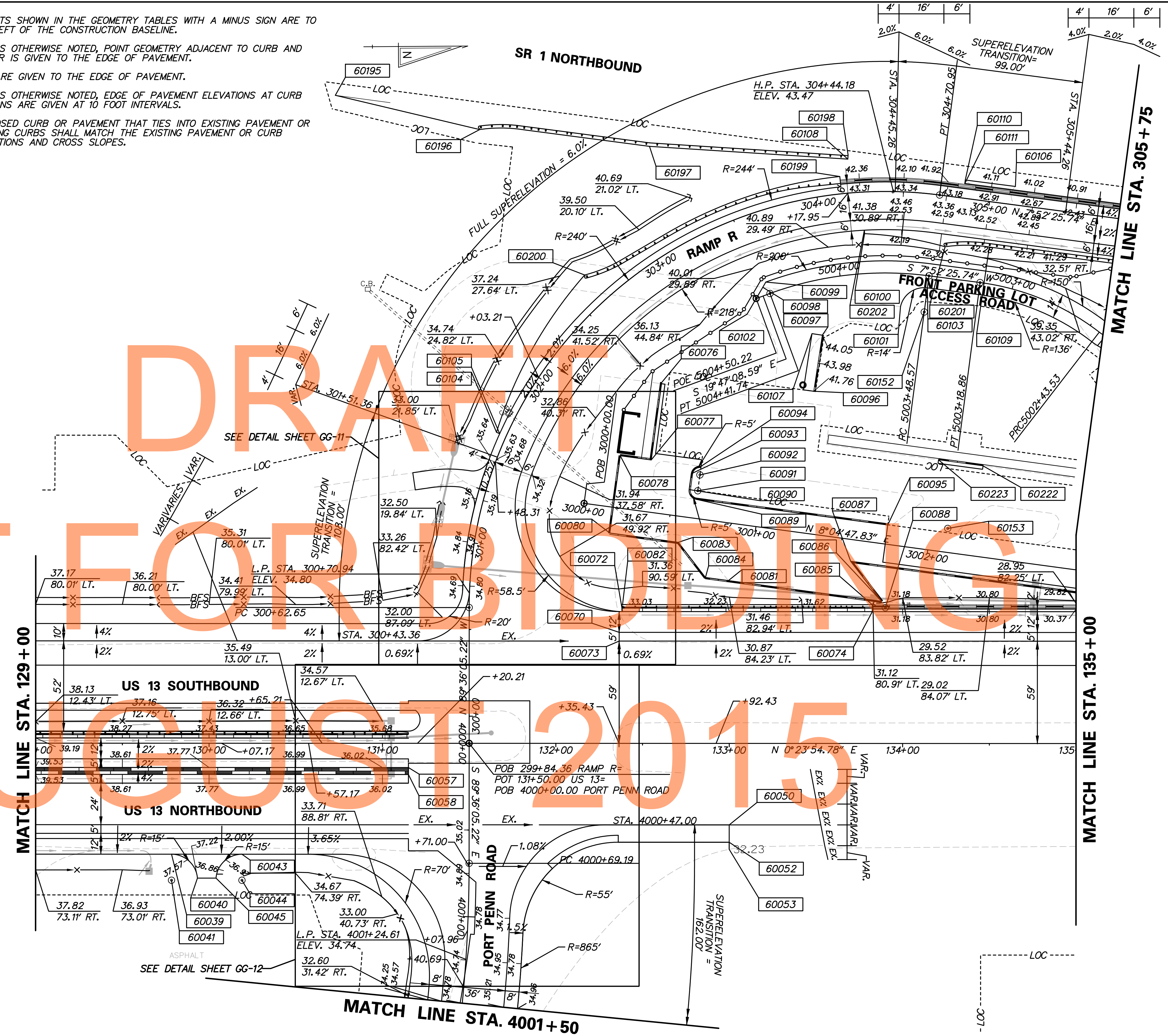

P:\1712015\1000\contract\1712015\1000\1301\_ID.dgn  
 1/17/2015 10:52:42 AM

ADDENDUMS / REVISIONS	

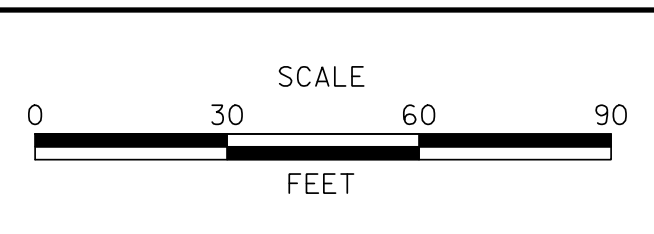

**US 13 & PORT PENN RD INTERSECTION**

CONTRACT	T201011302
COUNTY	NEW CASTLE
BRIDGE NO.	
DESIGNED BY:	N.S.P.
CHECKED BY:	B.R.T.

<b>GRADES &amp; GEOMETRICS</b>	
SHEET NO.	55
TOTAL SHTS.	179







COORDINATE LIST				
POINT NO.	STATION	OFFSET	NORTHING	EASTING
60126	142+85.29	-69.00	556565.4816	590567.6931
60127	316+00.00	-8.00	556822.6562	590461.1880
60128	316+00.00	-4.00	556822.1082	590465.1503
60129	316+00.00	26.00	556817.9985	590494.8674
60130	316+00.00	22.00	556818.5465	590490.9051
60131	144+66.60	-58.47	556746.7111	590579.4883
60170	144+66.60	-48.65	556746.6428	590589.3043

COORDINATE LIST				
POINT NO.	STATION	OFFSET	NORTHING	EASTING
60243	144+66.60	-23.00	556746.4644	590614.9531
60244	144+66.60	-19.00	556746.4366	590618.9530
60245	142+37.79	-19.00	556517.6386	590617.3615
60246	142+04.12	-16.00	556483.9472	590620.1272
60247	142+04.12	-23.00	556483.9959	590613.1273
60254	312+68.33	29.16	556489.0240	590452.5663
60255	312+93.63	26.00	556514.5198	590452.8976

**NOTES:**

1. OFFSETS SHOWN IN THE GEOMETRY TABLES WITH A MINUS SIGN ARE TO THE LEFT OF THE CONSTRUCTION BASELINE.
2. UNLESS OTHERWISE NOTED, POINT GEOMETRY ADJACENT TO CURB AND GUTTER IS GIVEN TO THE EDGE OF PAVEMENT.
3. RADII ARE GIVEN TO THE EDGE OF PAVEMENT.
4. UNLESS OTHERWISE NOTED, EDGE OF PAVEMENT ELEVATIONS AT CURB RETURNS ARE GIVEN AT 10 FOOT INTERVALS.
5. PROPOSED CURB OR PAVEMENT THAT TIES INTO EXISTING PAVEMENT OR EXISTING CURBS SHALL MATCH THE EXISTING PAVEMENT OR CURB ELEVATIONS AND CROSS SLOPES.

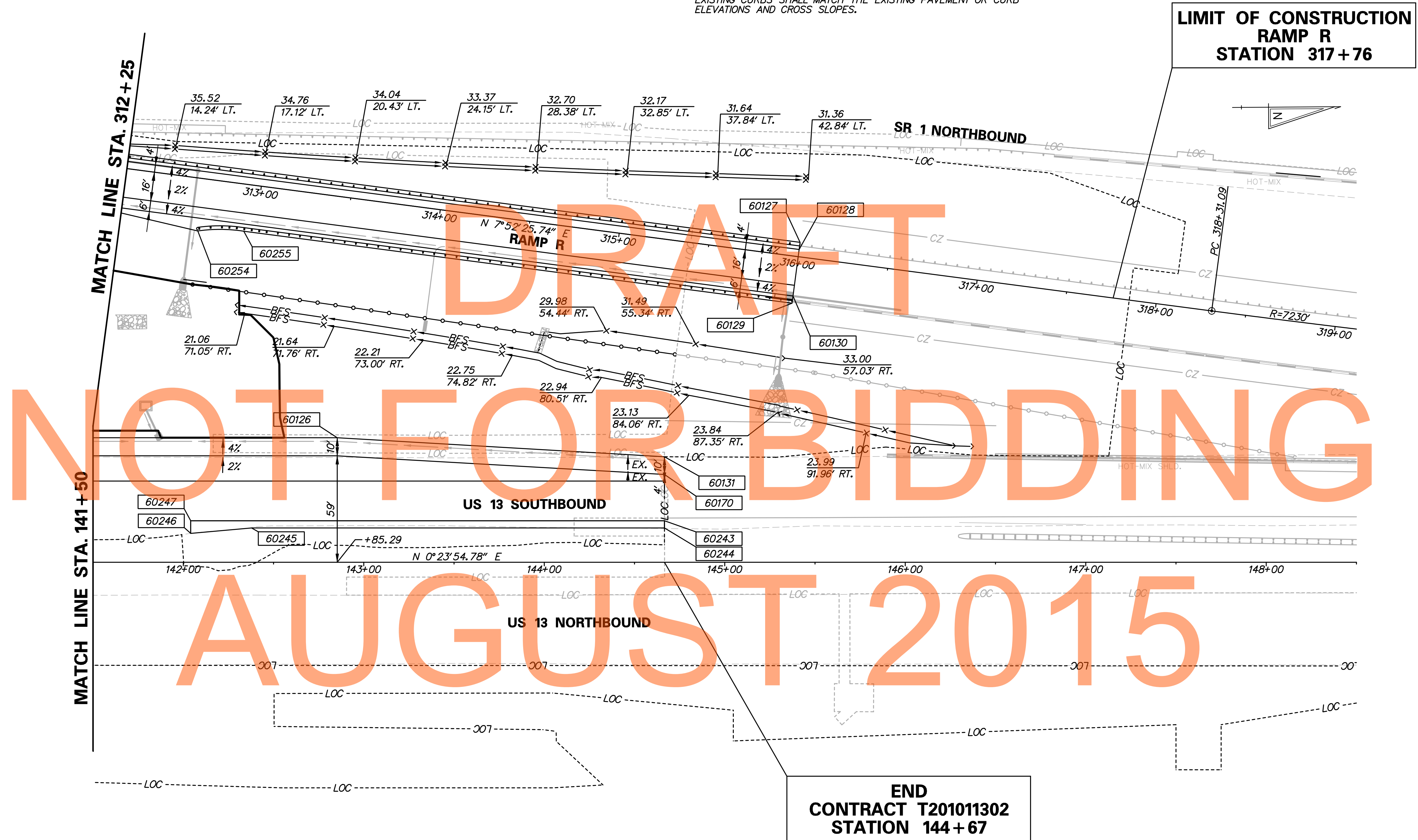

p:\17172015\1025252.dgn  
 8/17/2015 10:25:25 AM



ADDENDUMS / REVISIONS	

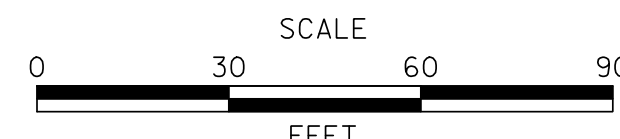

**US 13 & PORT PENN RD INTERSECTION**

CONTRACT T201011302	BRIDGE NO.
COUNTY NEW CASTLE	DESIGNED BY: N.S.P.
	CHECKED BY: B.R.T.

**GRADES & GEOMETRICS**

GG-08
SHEET NO. 57
TOTAL SHTS. 179











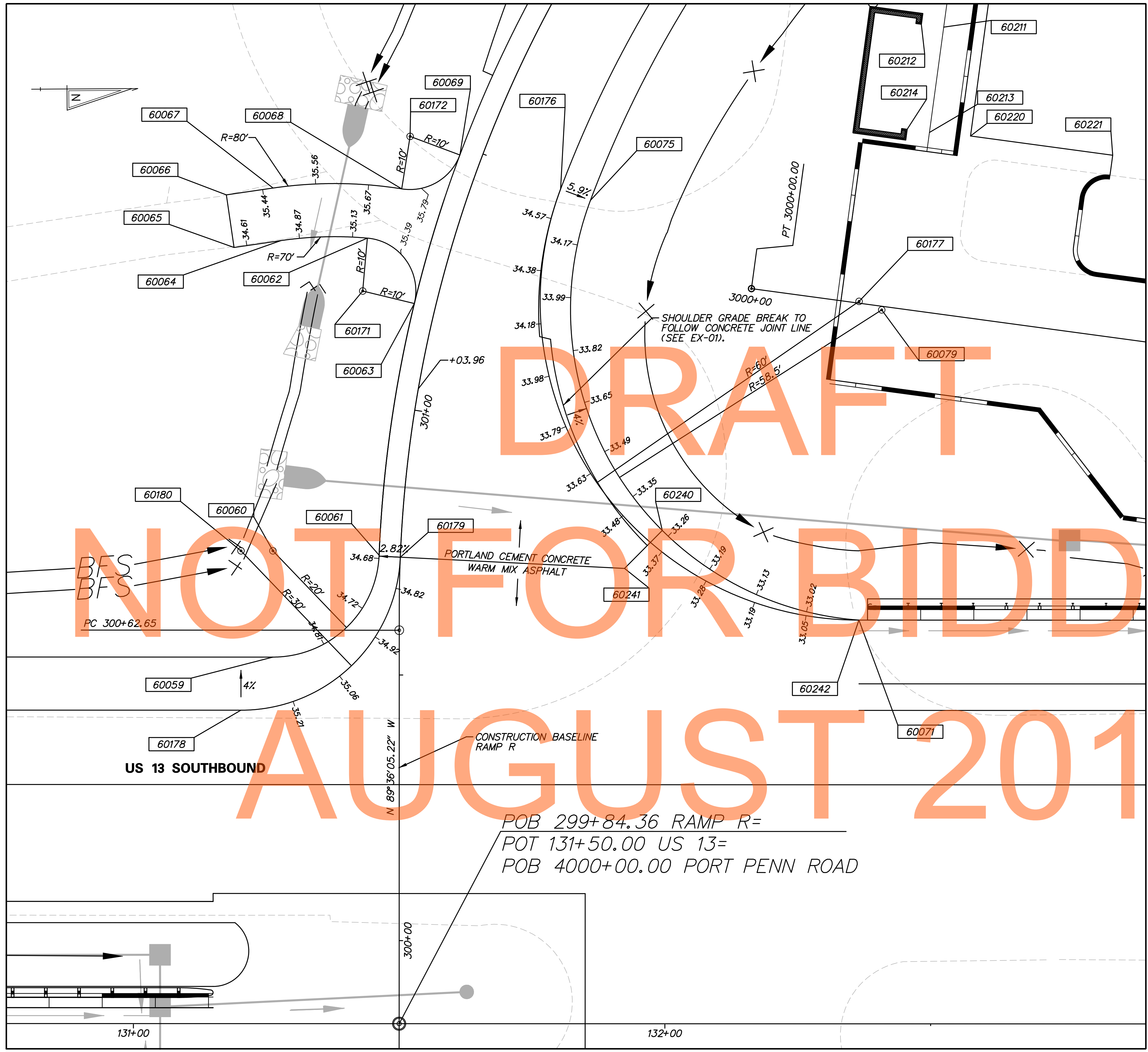

COORDINATE LIST				
POINT NO.	STATION	OFFSET	NORTHING	EASTING
60059	131+26.22	-69.00	555406.4387	590559.6306
60060	300+72.39	-24.00	555406.5778	590539.6311
60061	300+72.39	-4.00	555426.5552	590540.5817
60062	301+28.81	-15.68	555424.7399	590480.8787
60063	301+19.52	-4.00	555433.5026	590493.2494
60064	301+24.48	-31.27	555408.4520	590481.2431
60065	301+21.48	-39.46	555399.6516	590482.4744
60066	301+29.31	-43.42	555398.2660	590472.5708
60067	301+32.50	-35.35	555407.0664	590471.3396
60068	301+38.98	-12.21	555431.2687	590471.6506
60069	301+48.31	-4.00	555442.2537	590465.3448
60071	132+36.49	-76.00	555516.7579	590553.3978
60075	301+48.96	22.00	555466.7629	590474.0448
60079	300+24.82	00.68	555521.4258	590495.0312
60171	301+19.52	-14.00	555432.9084	590461.7860
60172	301+48.31	-14.00	555423.7987	590490.8343
60176	301+48.96	16.00	555461.1615	590471.8943
60177	301+48.96	76.00	555517.1753	590493.3993
60178	131+20.21	-59.00	555400.3644	590569.5886
60179	300+72.18	0.00	555430.5405	590540.9882
60180	300+72.18	-30.00	555400.5731	590539.5893
60211	302+23.80	64.25	555533.4406	590441.8848
60212	302+20.89	60.58	555529.2328	590441.2875
60213	301+98.97	73.59	555530.6295	590461.6863
60214	301+96.46	69.73	555526.4217	590461.0889
60220	302+04.38	80.43	555538.3545	590462.4093
60221	302+25.43	104.14	555565.0865	590466.2042
60240	300+71.67	48.92	555479.8670	590536.2783
60241	300+80.98	42.24	555472.7149	590543.3768
60242	132+36.49	-76.00	555516.7579	590553.3978

- NOTES:
1. OFFSETS SHOWN IN THE GEOMETRY TABLES WITH A MINUS SIGN ARE TO THE LEFT OF THE CONSTRUCTION BASELINE.
  2. UNLESS OTHERWISE NOTED, POINT GEOMETRY ADJACENT TO CURB AND GUTTER IS GIVEN TO THE EDGE OF PAVEMENT.
  3. RADII ARE GIVEN TO THE EDGE OF PAVEMENT.
  4. UNLESS OTHERWISE NOTED, EDGE OF PAVEMENT ELEVATIONS AT CURB RETURNS ARE GIVEN AT 10 FOOT INTERVALS.
  5. PROPOSED CURB OR PAVEMENT THAT TIES INTO EXISTING PAVEMENT OR EXISTING CURBS SHALL MATCH THE EXISTING PAVEMENT OR CURB ELEVATIONS AND CROSS SLOPES.

US 13 SOUTHBOUND

POB 299+84.36 RAMP R=  
 POT 131+50.00 US 13=  
 POB 4000+00.00 PORT PENN ROAD

p:\17205\100352.dwg  
 7/17/2015 10:05:52 AM  
 17205\100352.dwg



ADDENDUMS / REVISIONS	

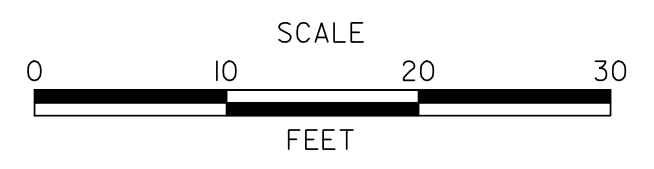

US 13 & PORT PENN RD INTERSECTION

CONTRACT	BRIDGE NO.
T201011302	
COUNTY	DESIGNED BY: N.S.P.
NEW CASTLE	CHECKED BY: B.R.T.

GRADES & GEOMETRICS

GG-11
SHEET NO.
60
TOTAL SHTS.
179



COORDINATE LIST				
POINT NO.	STATION	OFFSET	NORTHING	EASTING
60042	130+57.17	64.00	555336.4657	590692.1471
60046	4001+41.94	90.00	555335.9788	590762.1454
60047	4001+41.94	20.00	555405.6678	590768.7362
60048	4001+07.97	-32.00	555460.0416	590738.4485
60049	132+36.00	57.00	555515.3454	590686.3912
60051	4001+07.97	-87.00	555514.9629	590741.3899
60054	131+15.00	-13.70	555394.8368	590614.8489
60055	131+19.11	-19.00	555398.9791	590609.5799
60056	131+15.00	-7.00	555394.7902	590621.5511
60070	131+15.00	55.00	555394.3589	590683.5496
60073	131+15.00	59.00	555394.3102	590690.5494
60173	131+14.99	-24.50	555394.8997	590604.0514
60174	131+85.00	-24.50	555464.9102	590604.5384
60175	131+85.00	11.50	555464.6598	590640.5375
60181	130+76.02	64.00	555355.3209	590692.2782
60182	4001+29.24	12.00	555414.7162	590757.0144
60183	4001+29.24	72.00	555354.9035	590752.2768
60184	132+28.41	47.00	555507.8215	590676.3386
60185	4000+99.16	-24.00	555452.4896	590728.9763
60186	4000+99.16	-79.00	555507.4389	590731.3373
60215	4000+62.00	18.00	555411.3098	590690.6676
60216	4000+80.00	-4.00	555433.1132	590708.8714
60217	4001+10.00	-4.00	555431.9699	590738.9921
60218	4001+10.00	-1.86	555507.4389	590731.3373
60219	4000+72.05	-48.03	555477.2653	590701.3413

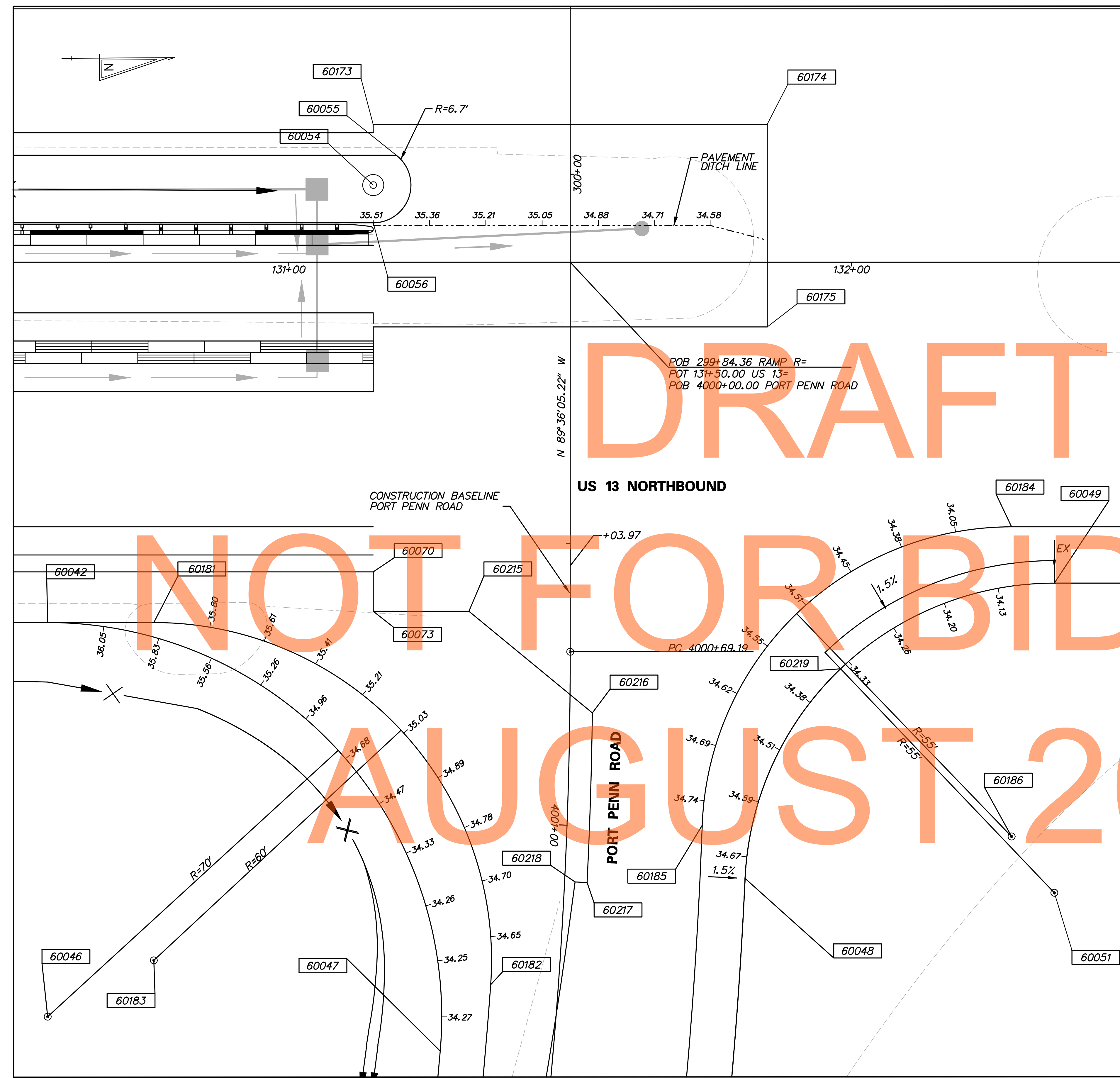

- NOTES:
1. OFFSETS SHOWN IN THE GEOMETRY TABLES WITH A MINUS SIGN ARE TO THE LEFT OF THE CONSTRUCTION BASELINE.
  2. UNLESS OTHERWISE NOTED, POINT GEOMETRY ADJACENT TO CURB AND GUTTER IS GIVEN TO THE EDGE OF PAVEMENT.
  3. RADI ARE GIVEN TO THE EDGE OF PAVEMENT.
  4. UNLESS OTHERWISE NOTED, EDGE OF PAVEMENT ELEVATIONS AT CURB RETURNS ARE GIVEN AT 10 FOOT INTERVALS.
  5. PROPOSED CURB OR PAVEMENT THAT TIES INTO EXISTING PAVEMENT OR EXISTING CURBS SHALL MATCH THE EXISTING PAVEMENT OR CURB ELEVATIONS AND CROSS SLOPES.

p:\17\653-000\cont\fract\_1d\ceadh\G012\301\_1b.dgn  
 8/17/2015 10:52:56 AM



ADDENDUMS / REVISIONS	

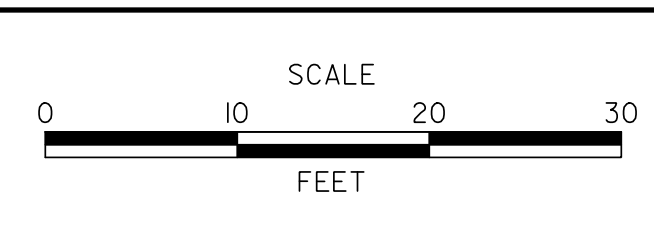

**US 13 & PORT PENN RD INTERSECTION**

CONTRACT	BRIDGE NO.
T201011302	
COUNTY	DESIGNED BY: N.S.P.
NEW CASTLE	CHECKED BY: B.R.T.

**GRADES & GEOMETRICS**

GG-12
SHEET NO.
61
TOTAL SHTS.
179