

AREA NOT SUBJECT TO IRI TESTING
PER ITEM 501506 - RIDE QUALITY OF
PORTLAND CEMENT CONCRETE PAVEMENT

NOTES:

1. JOINT LAYOUT AS SHOWN ON THE PLANS IS GRAPHICAL AND IT IS THE RESPONSIBILITY OF THE CONTRACTOR TO CONSTRUCT THE JOINTS ACCORDING TO THE STANDARD DETAILS AND THESE GENERAL NOTES.
2. TYPICAL TRANSVERSE JOINT SPACING IS 15'.
3. THE MAXIMUM SLAB WIDTH IS 14' UNLESS OTHERWISE NOTED ON THE PLANS OR APPROVED BY THE ENGINEER.
4. THE MINIMUM SLAB WIDTH IS 4'.
5. THE MINIMUM TRANSVERSE JOINT SPACING IS 12'. THE MAXIMUM TRANSVERSE SPACING IS 17'. MAXIMUM AND MINIMUM SPACING ON CURVES SHALL BE MEASURED ALONG THE LONGEST CHORD. THE MAXIMUM AND MINIMUM SPACING FOR CURVES ON THE US 301 MAINLINE SHOULD BE CALCULATED FOR FUTURE LANE EXPANSION INTO THE MEDIAN WHERE APPLICABLE.
6. PAVEMENT CROSS SLOPES AND TRANSITION LENGTHS SHALL BE ADJUSTED AS NEEDED PER LOCATION AND TO MEET DESIGN CRITERIA.
7. IN CURVED SECTIONS, SLAB DIMENSIONS ARE PROVIDED ALONG THE OUTER RADIUS OF THE THROUGH TRAVEL LANES.

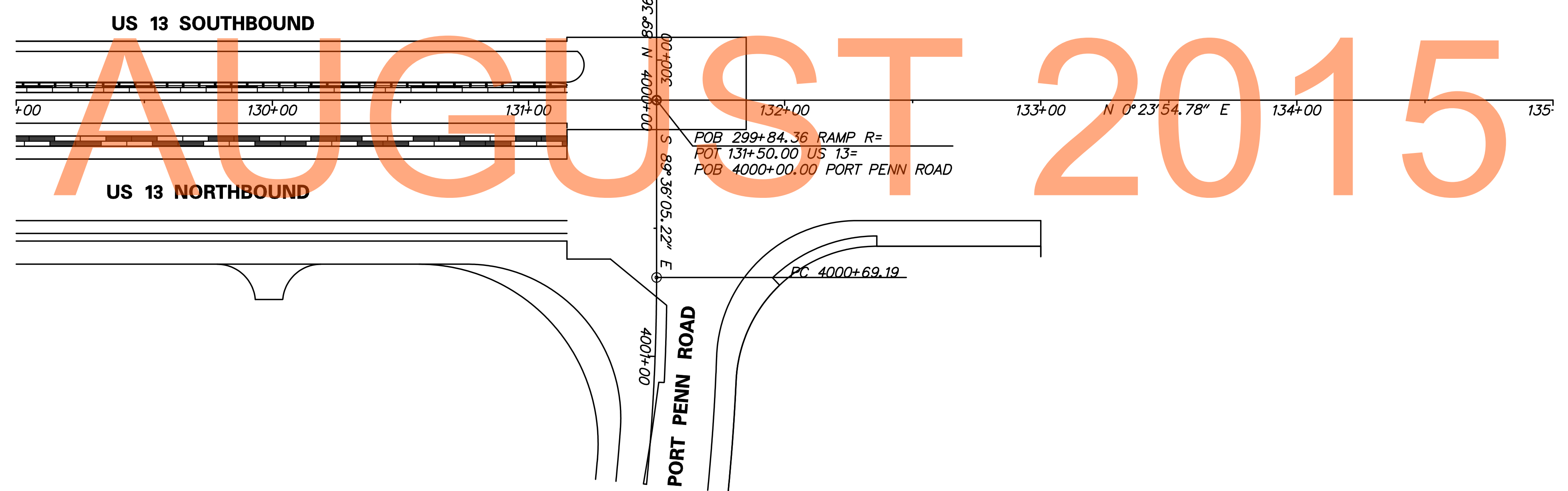
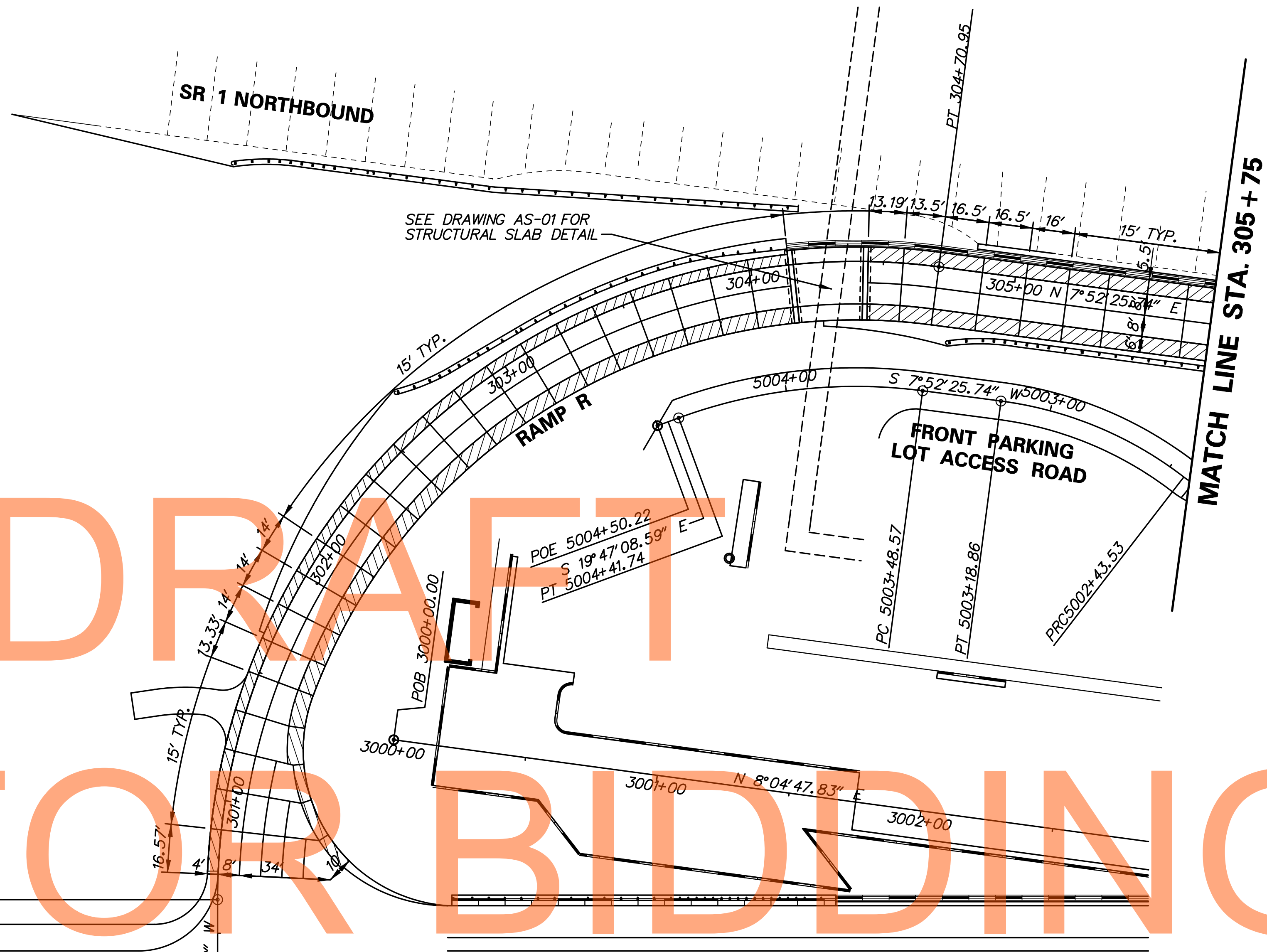

DRAFT
NOT FOR BIDDING
AUGUST 2015

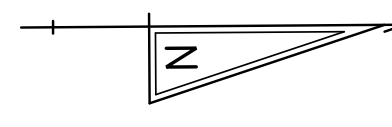

M:\716531-000\Contract\ID\CADD\EX0010301_ID.dgn
 9/17/2015 10:18:05 AM



ADDENDUMS / REVISIONS	

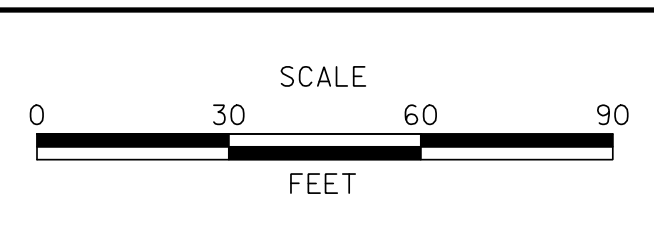

**US 13 & PORT PENN RD
INTERSECTION**

CONTRACT T201011302	BRIDGE NO.
COUNTY NEW CASTLE	DESIGNED BY: NSP
	CHECKED BY: BRT

PAVEMENT JOINT LAYOUT PLAN	SHEET NO. 62
	TOTAL SHTS. 179

EX-01

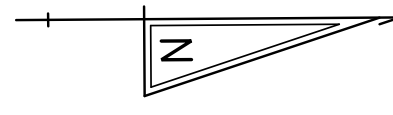

LIMIT OF CONSTRUCTION
CONTRACT T201011302
STATION 317 + 76

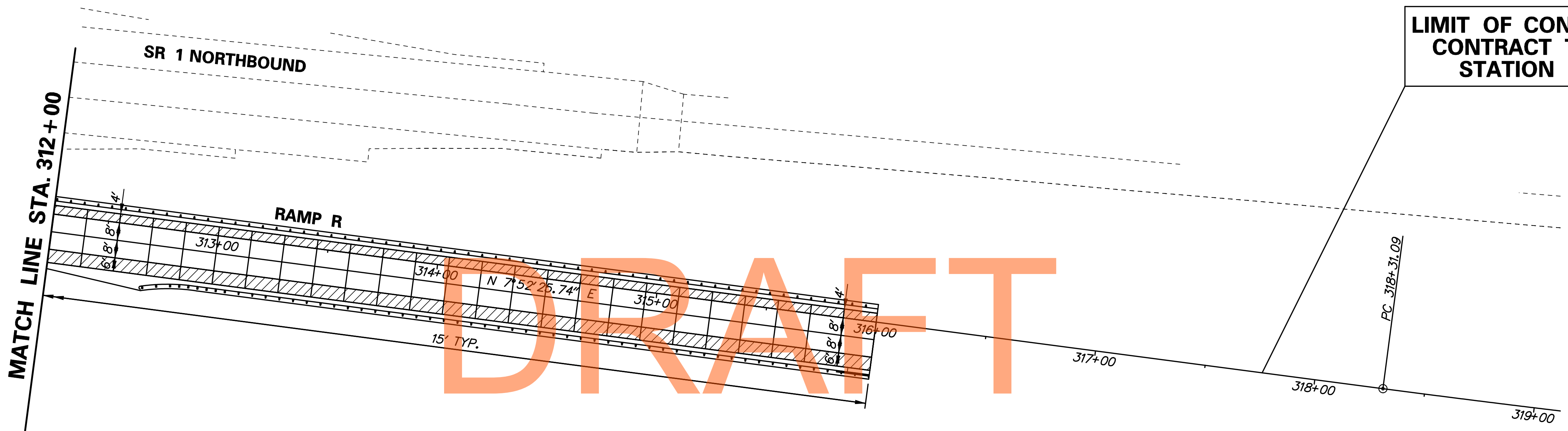

NOT FOR BIDDING

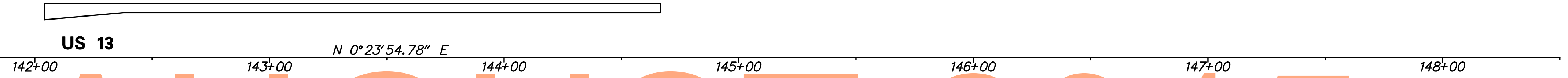

AUGUST 2015

AREA NOT SUBJECT TO IRI TESTING
PER ITEM 501506 - RIDE QUALITY OF
PORTLAND CEMENT CONCRETE PAVEMENT

NOTES:

1. JOINT LAYOUT AS SHOWN ON THE PLANS IS GRAPHICAL AND IT IS THE RESPONSIBILITY OF THE CONTRACTOR TO CONSTRUCT THE JOINTS ACCORDING TO THE STANDARD DETAILS AND THESE GENERAL NOTES.
2. TYPICAL TRANSVERSE JOINT SPACING IS 15'.
3. THE MAXIMUM SLAB WIDTH IS 14' UNLESS OTHERWISE NOTED ON THE PLANS OR APPROVED BY THE ENGINEER.
4. THE MINIMUM SLAB WIDTH IS 4'.
5. THE MINIMUM TRANSVERSE JOINT SPACING IS 12'. THE MAXIMUM TRANSVERSE SPACING IS 17'. MAXIMUM AND MINIMUM SPACING ON CURVES SHALL BE MEASURED ALONG THE LONGEST CHORD. THE MAXIMUM AND MINIMUM SPACING FOR CURVES ON THE US 301 MAINLINE SHOULD BE CALCULATED FOR FUTURE LANE EXPANSION INTO THE MEDIAN WHERE APPLICABLE.
6. PAVEMENT CROSS SLOPES AND TRANSITION LENGTHS SHALL BE ADJUSTED AS NEEDED PER LOCATION AND TO MEET DESIGN CRITERIA.
7. IN CURVED SECTIONS, SLAB DIMENSIONS ARE PROVIDED ALONG THE OUTER RADIUS OF THE THROUGH TRAVEL LANES.

file: \\653-000\csm\contract\14\cead\EX0030301_10.dgn
9/17/2015 10:18:14 AM



DELAWARE
DEPARTMENT OF TRANSPORTATION

ADDENDUMS / REVISIONS

NO.	DATE	DESCRIPTION

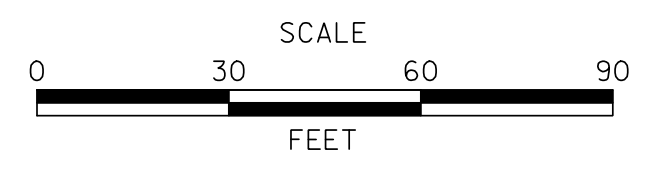

US 13 & PORT PENN RD
INTERSECTION

CONTRACT	BRIDGE NO.
T201011302	
COUNTY	DESIGNED BY: NSP
NEW CASTLE	CHECKED BY: BRT

PAVEMENT JOINT
LAYOUT PLAN

EX-03
SHEET NO.
64
TOTAL SHTS.
179