

ADDENDUMS / REVISIONS	

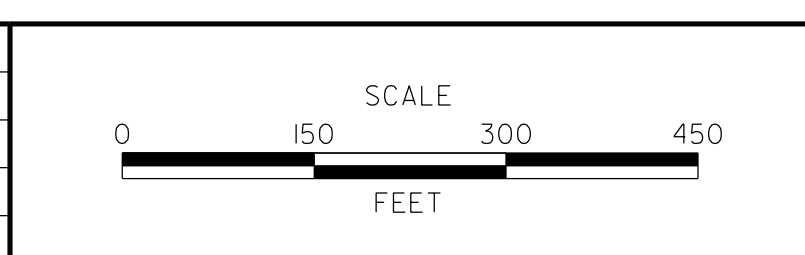

**US 301**  
**LEVELS ROAD**  
**TO SUMMIT BRIDGE ROAD**

CONTRACT	BRIDGE NO.
T200911303	
COUNTY	DESIGNED BY: WRC
NEW CASTLE	CHECKED BY: GTS

**SPUR ROAD STOCKPILE PLANS**  
**PLAN SHEET INDEX**

STKP-1
SHEET NO.
1242
TOTAL SHTS.
1256

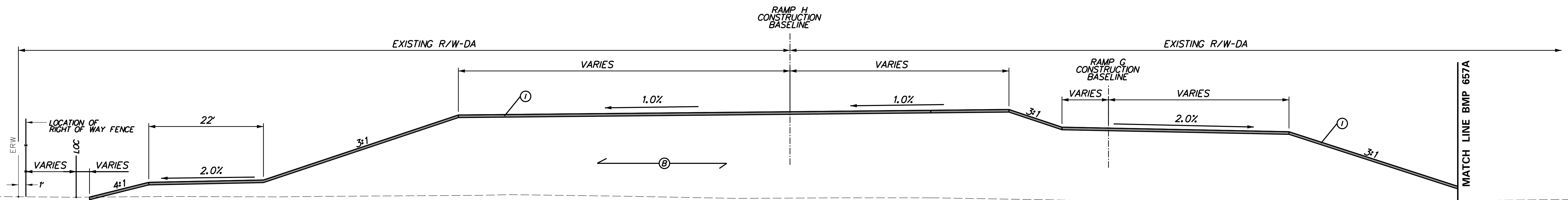

RAMP H  
STA. 52+50.00 TO STA. 56+50.00  
(NOTE- RAMP H SHOWN LOOKING BACK STATION)

RAMP G  
STA. 103+25± TO STA. 108+25±

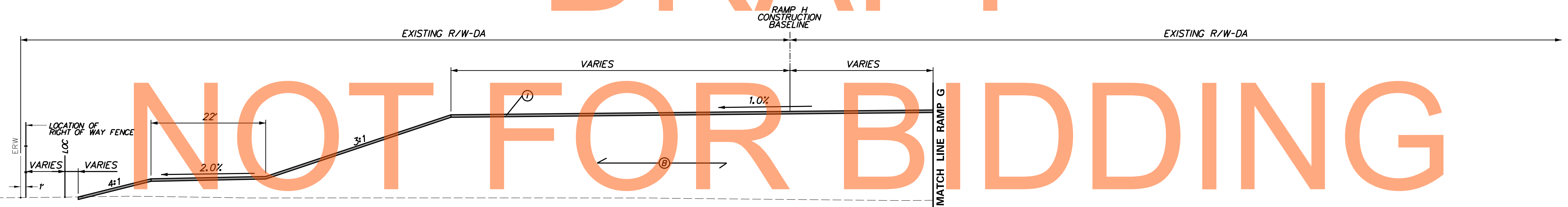

RAMP H  
STA. 56+50.00 TO STA. 61+00.00  
(NOTE- RAMP H SHOWN LOOKING BACK STATION)

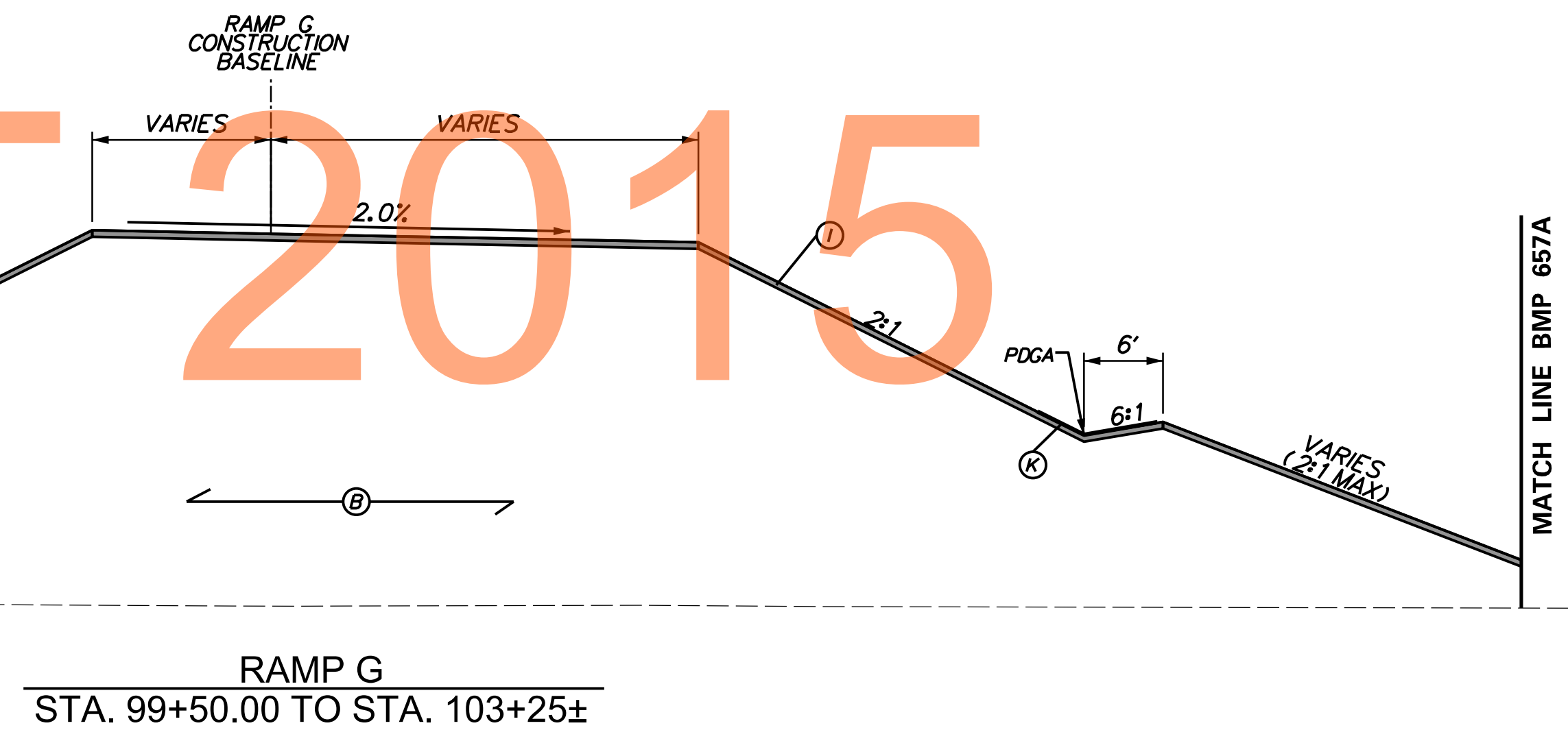

RAMP G  
STA. 99+50.00 TO STA. 103+25±

NOTE : RAMP H - FOR STA. 61+00.00 TO STA. 66+00.00 SEE TYPICAL SECTION SHEET NO. TS-23

NOTE : SEE GRADING PLANS FOR OFFSET AND ELEVATION INFORMATION

LEGEND

- ⓑ ITEM #209006, BORROW TYPE F
- Ⓚ ITEM #735535 SOIL RETENTION BLANKET MULCH, TYPE 5
- Ⓛ ITEM #733002, TOPSOILING, 6" DEPTH
- Ⓜ ITEM #734013, PERMANENT GRASS SEEDING, DRY GROUND



ADDENDUMS / REVISIONS	

US 301  
LEVELS ROAD  
TO SUMMIT BRIDGE ROAD

CONTRACT T200911303	BRIDGE NO.
COUNTY NEW CASTLE	DESIGNED BY: WRC
	CHECKED BY: GTS

SPUR ROAD STOCKPILE PLANS  
TYPICAL SECTIONS

STKP-2
SHEET NO. 1243
TOTAL SHTS. 1256



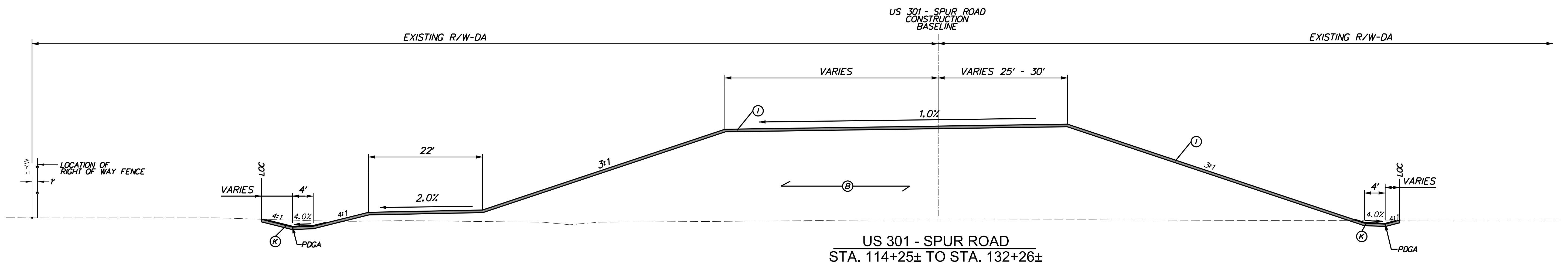

US 301 - SPUR ROAD  
STA. 114+25± TO STA. 132+26±

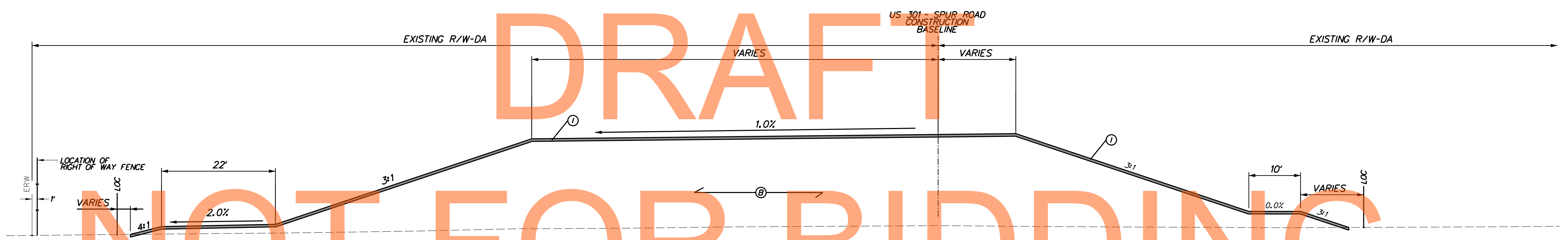

US 301 - SPUR ROAD  
STA. 110+00 TO STA. 112+20±

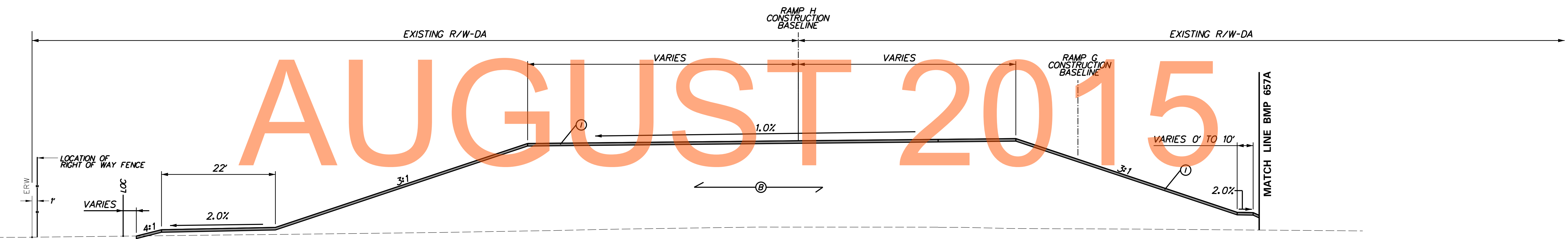

RAMP H  
STA. 50+10.00 TO STA. 52+50.00  
(NOTE- RAMP H SHOWN LOOKING BACK STATION)

RAMP G  
STA. 108+25± TO STA. 110+00.00

NOTE : SEE GRADING PLANS FOR OFFSET AND ELEVATION INFORMATION

LEGEND

- Ⓟ ITEM #209006, BORROW TYPE F
- Ⓚ ITEM #735535 SOIL RETENTION BLANKET MULCH, TYPE 5
- ① ITEM #733002, TOPSOILING, 6" DEPTH
- ② ITEM #734013, PERMANENT GRASS SEEDING, DRY GROUND



ADDENDUMS / REVISIONS

US 301  
LEVELS ROAD  
TO SUMMIT BRIDGE ROAD

CONTRACT T200911303	BRIDGE NO.
COUNTY NEW CASTLE	DESIGNED BY: WRC
	CHECKED BY: GTS

SPUR ROAD STOCKPILE PLANS  
TYPICAL SECTIONS

STKP-3
SHEET NO. 1244
TOTAL SHTS. 1256

CONSTRUCTION ALIGNMENT CONTROL				
POINT	STATION	OFFSET	NORTHING	EASTING
15300	1205+13.48	0.00	539076.4276	565998.1809
15307	1235+65.98	0.00	539428.4337	568986.9947
15308	1209+49.68	34.32	539009.3445	566434.1989
15309	1227+47.55	-25.05	539509.9244	568169.4377
15400	1300+11.31	0.00	540100.5648	566247.7741
15404	1319+93.50	0.00	540007.1979	568018.4611
15405	1322+33.50	0.00	539832.3229	568182.8349
15409	1326+49.79	0.00	539481.9512	568365.2255
15411	1315+19.88	-21.05	540396.5750	567735.1169
15412	1325+05.60	-15.25	539630.0273	568370.7100

HORIZONTAL / VERTICAL CONTROL DATA					
POINT	STATION	OFFSET	NORTHING	EASTING	ELEVATION
247	1205+73.44	238.10	538831.9768	566021.2282	71.28
249A	129+97.96	-858.73	540206.9106	566632.8752	70.05
250	133+89.70	207.92	540381.1117	567755.7580	71.08
251	1321+76.80	24.93	539856.5645	568125.8347	72.40
252	1231+21.46	3.77	539468.7672	568544.2888	71.91

CIRCULAR CURVE NO. ⑨			
Element: Circular	STATION	NORTHING	EASTING
PT ( 15304 )	1224+87.93	539437.0864	567916.9480
PI ( )	1227+50.72	539509.9244	568169.4377
CC ( 15305 )		538124.9355	568295.4759
PT ( 15306 )	1230+07.16	539483.8601	568430.9278
Radius:		1365.66	
Design Speed(mph):		55.00	
Superelevation:		-4.40%	
Delta:	21° 47' 02.1800" Right		
Degree of Curvature(Arc):	4° 11' 43.69"		
Length:	519.23		
Tangent:	262.79		
Chord:	516.10		
Middle Ordinate:	24.60		
External:	25.05		
Tangent Direction:	N 73° 54' 29.75" E		
Radial Direction:	S 16° 05' 30.25" E		
Chord Direction:	N 84° 48' 00.84" E		
Radial Direction:	S 5° 41' 31.93" W		
Tangent Direction:	S 84° 18' 28.07" E		

CIRCULAR CURVE NO. ⑩			
Element: Circular	STATION	NORTHING	EASTING
PT ( 15401 )	1314+55.86	540382.5291	567664.5410
PI ( )	1315+27.82	540396.5750	567735.1169
CC ( 15402 )		540272.2002	567686.4986
PT ( 15403 )	1315+83.90	540338.3898	567777.4575
Radius:		112.49	
Design Speed(mph):		55.00	
Superelevation:		0.00%	
Delta:	65° 12' 47.00" Right		
Degree of Curvature(Arc):	50° 55' 58.56"		
Length:	128.04		
Tangent:	71.96		
Chord:	121.24		
Middle Ordinate:	17.73		
External:	21.05		
Tangent Direction:	N 78° 44' 38.75" E		
Radial Direction:	S 11° 15' 21.25" E		
Chord Direction:	S 68° 38' 57.75" E		
Radial Direction:	S 53° 57' 25.75" W		
Tangent Direction:	S 36° 02' 34.25" E		

DATUM REFERENCE  
HORIZONTAL - THIS PROJECT IS REFERENCED TO THE DELAWARE STATE PLAN COORDINATE SYSTEM (NAD 83/91).

VERTICAL - THIS PROJECT IS REFERENCED TO NAVD 88

ADDENDUMS / REVISIONS



US 301  
LEVELS ROAD  
TO SUMMIT BRIDGE ROAD

CONTRACT  
T200911303  
COUNTY  
NEW CASTLE

BRIDGE NO.  
DESIGNED BY: WRC  
CHECKED BY: GTS

HORIZONTAL & VERTICAL  
CONTROL

STKP-4  
SHEET NO.  
1245  
TOTAL SHTS.  
1256

DRAFT  
NOT FOR BIDDING  
AUGUST 2015

LIMIT OF CONSTRUCTION  
CONTRACT T200911303  
STATION 132+81



COORDINATE LIST				
POINT NO.	STATION	OFFSET	NORTHING	EASTING
60803	60+78.85	27.95	537034.4470	566810.4450
60804	60+67.32	9.18	537041.1265	566831.4065

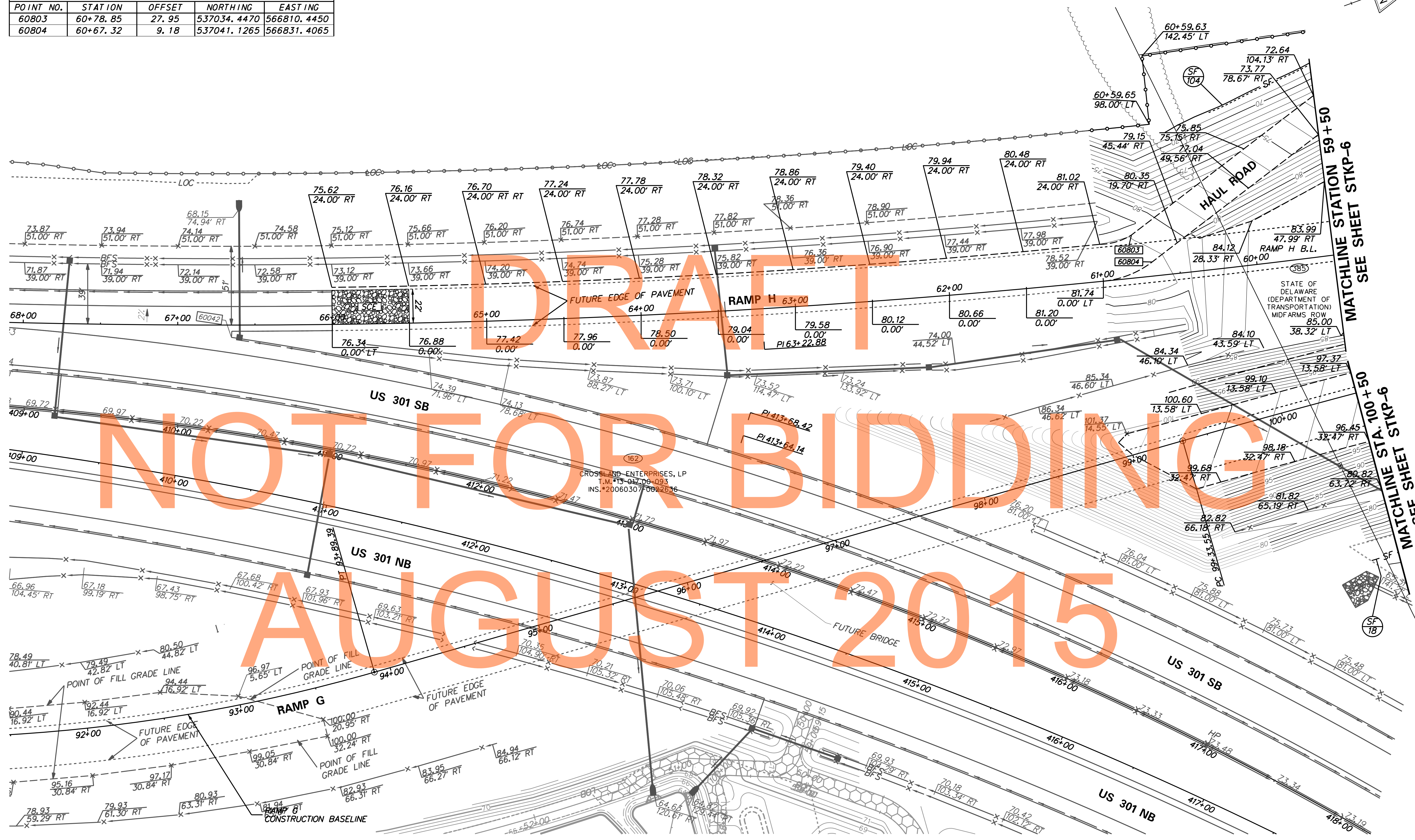
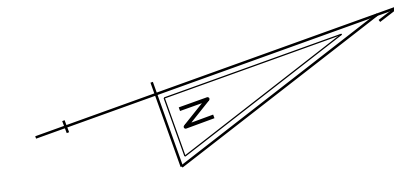

NOT FOR BIDDING

AUGUST 2015

MATCHLINE STATION 59+50  
SEE SHEET STKP-6

MATCHLINE STA. 100+50  
SEE SHEET STKP-6

CROSSLAND ENTERPRISES, LP  
T.M. #15-017-00-093  
INS. #200603070002656



ADDENDUMS / REVISIONS	

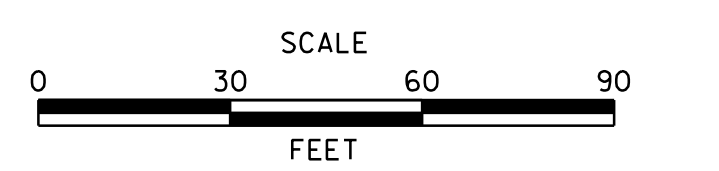

**US 301  
LEVELS ROAD  
TO SUMMIT BRIDGE ROAD**

CONTRACT T200911303	BRIDGE NO.
COUNTY NEW CASTLE	DESIGNED BY: WRC
	CHECKED BY: GTS

<b>SPUR ROAD STOCKPILE PLANS CONSTRUCTION, GRADING AND E&amp;S PLAN</b>	
---	--

<b>STKP-5</b>
SHEET NO. 1246
TOTAL SHTS. 1256



COORDINATE LIST				
POINT NO.	STATION	OFFSET	NORTHING	EASTING
60805	59+32.16	114.30	537195.1276	566759.2437
60806	59+20.95	95.25	537201.8071	566780.2053
60807	59+01.56	122.55	537226.1511	566757.5292
60808	59+01.28	100.55	537221.8222	566779.0991

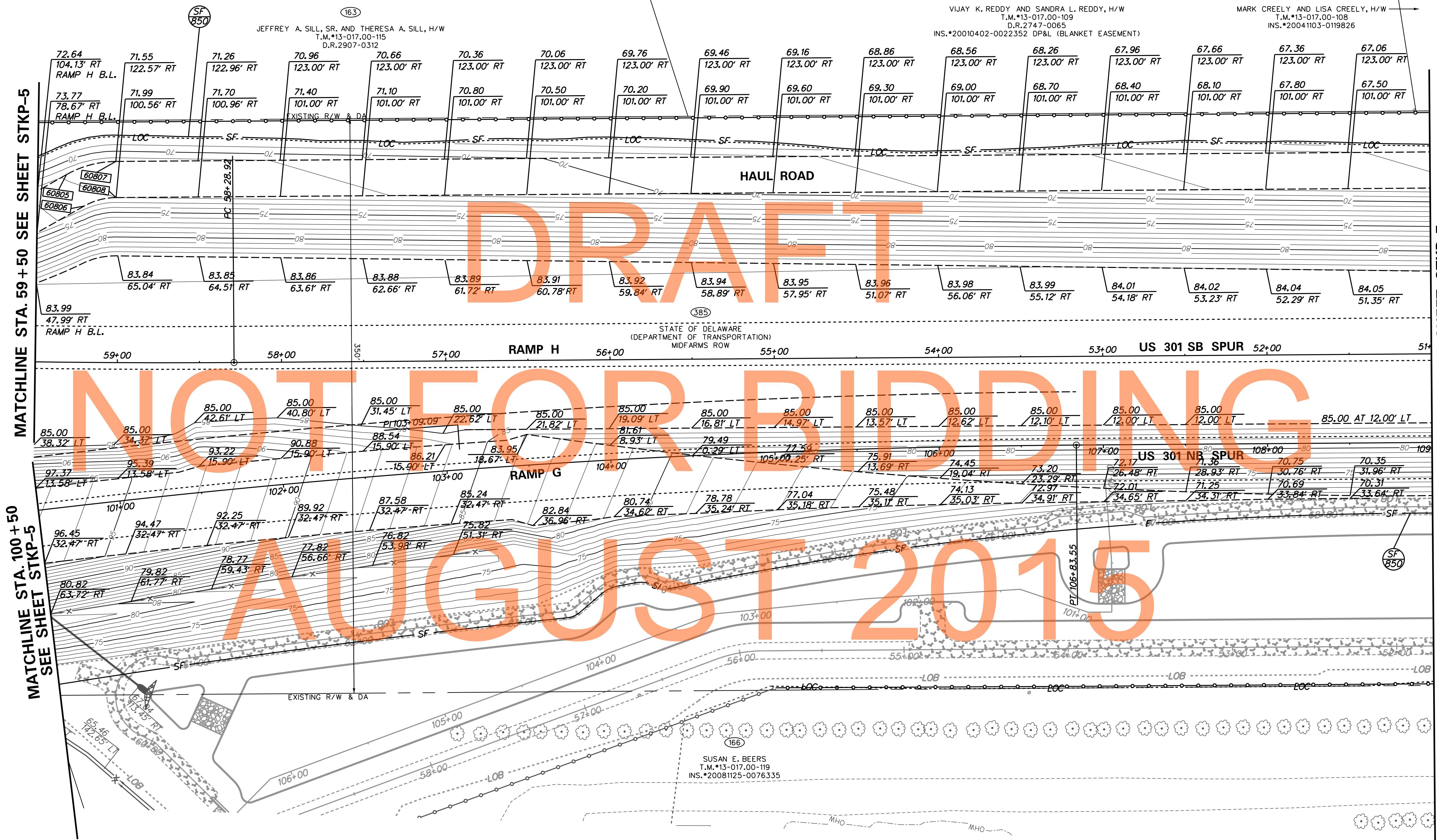
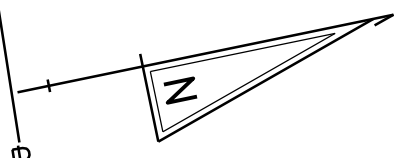

MATCHLINE STA. 59+50 SEE SHEET STKP-5

MATCHLINE STA. 100+50 SEE SHEET STKP-5

MATCHLINE STATION 109+00 SEE SHEET STKP-7



ADDENDUMS / REVISIONS

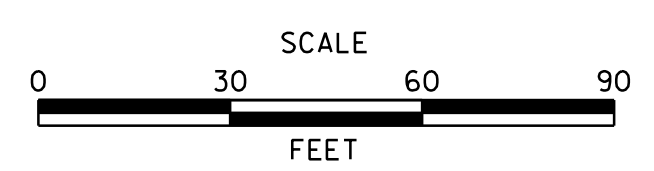

**US 301  
LEVELS ROAD  
TO SUMMIT BRIDGE ROAD**

CONTRACT	BRIDGE NO.
T200911303	
COUNTY	DESIGNED BY: WRC
NEW CASTLE	CHECKED BY: GTS

**SPUR ROAD STOCKPILE PLANS  
CONSTRUCTION, GRADING AND  
E&S PLAN**

<b>STKP-6</b>
SHEET NO.
1247
TOTAL SHTS.
1256



DRAINAGE PIPE SCHEDULE						
NO.	SIZE / TYPE	CLASS	LENGTH	SLOPE	INT. EL.	DIS. EL.
1	24" RCP	V	51'	0.003	64.98	64.83

RIP-RAP SCHEDULE					
NO.	TYPE	LENGTH	WIDTH	AREA	THICKNESS
1	R-4	8'	11.3'	7 SY	20"

FLARED END SECTION SCHEDULE			
NO.	SIZE / TYPE	SLOPE	SAFETY GRATE
1	24" RCP	0.003	NO
2	24" RCP	0.003	NO

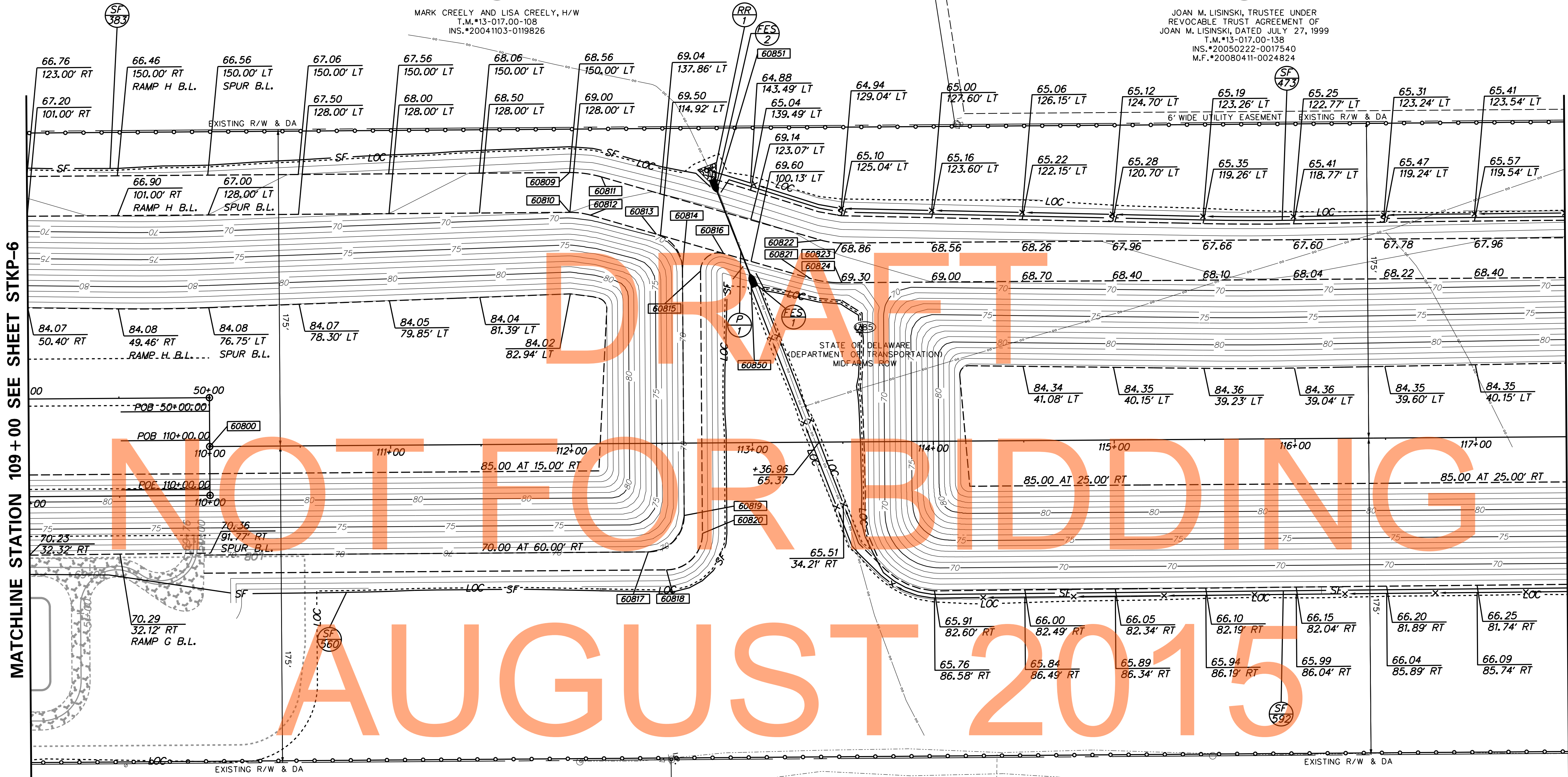
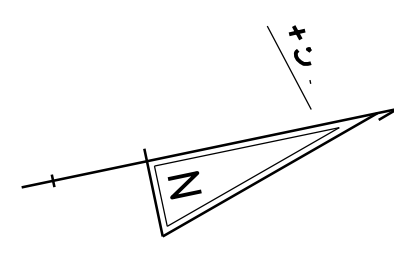

COORDINATE LIST				
POINT NO.	STATION	OFFSET	NORTHING	EASTING
60800	110+00.00	0.00	538079.0411	567081.6873
60809	112+00.00	-150.00	538304.6463	566973.9733
60810	112+00.00	-128.00	538300.3174	566995.5432
60811	112+17.56	-147.45	538321.3632	566979.9244
60812	112+11.32	-126.36	538311.0950	566999.3811
60813	112+47.67	-115.61	538344.6189	567017.0734
60814	112+62.00	-96.43	538354.8932	567038.6966
60815	112+72.00	-95.03	538364.4219	567042.0383
60816	112+84.84	-104.62	538378.8938	567035.1620

166  
SUSAN E. BEERS  
T.M.\*13-017.00-119  
INS.\*20081125-0076335

COORDINATE LIST				
POINT NO.	STATION	OFFSET	NORTHING	EASTING
60817	112+42.00	60.00	538304.5041	567188.1320
60818	112+52.00	70.00	538312.3409	567199.9042
60819	112+62.00	40.00	538328.0484	567172.4584
60820	112+72.00	50.00	538335.8852	567184.2305
60821	113+32.42	-90.55	538422.7759	567058.3208
60822	113+38.66	-111.64	538433.0442	567038.8641
60823	113+50.00	-110.00	538443.8431	567042.7064
60824	113+50.00	-88.00	538439.5142	567064.2763

301  
RICHARD F. MATONI  
T.M.\*13-017.00-121  
INS.\*20031113-0145141  
M.F.\*20050726-0073388  
D.R.20041110-012581 DP&L  
(BLANKET EASEMENT)

COORDINATE LIST				
POINT NO.	STATION	OFFSET	NORTHING	EASTING
60850	112+99.74	-91.99	538391.0242	567050.4786
60851	112+81.29	-139.53	538382.2825	567000.2334



ADDENDUMS / REVISIONS	

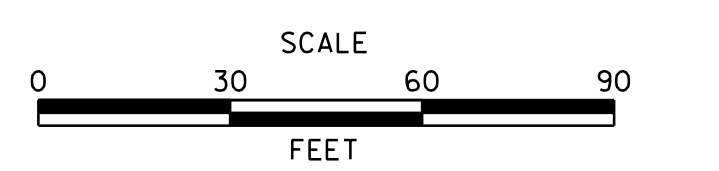

US 301  
LEVELS ROAD  
TO SUMMIT BRIDGE ROAD

CONTRACT T200911303	BRIDGE NO.
COUNTY NEW CASTLE	DESIGNED BY: WRC
	CHECKED BY: GTS

SPUR ROAD STOCKPILE PLANS	
CONSTRUCTION, GRADING AND E&S PLAN	

STKP-7
SHEET NO. 1248
TOTAL SHTS. 1256



COORDINATE LIST				
POINT NO.	STATION	OFFSET	NORTHING	EASTING
60829	120+08.52	-175.00	539102.2745	567108.5514
60830	122+28.51	-175.00	539317.9711	567151.8397
60831	121+90.24	175.00	539211.5825	567487.4674
60832	124+10.21	175.00	539427.2475	567530.7494

MATCHLINE SEE SHEET STKP-10

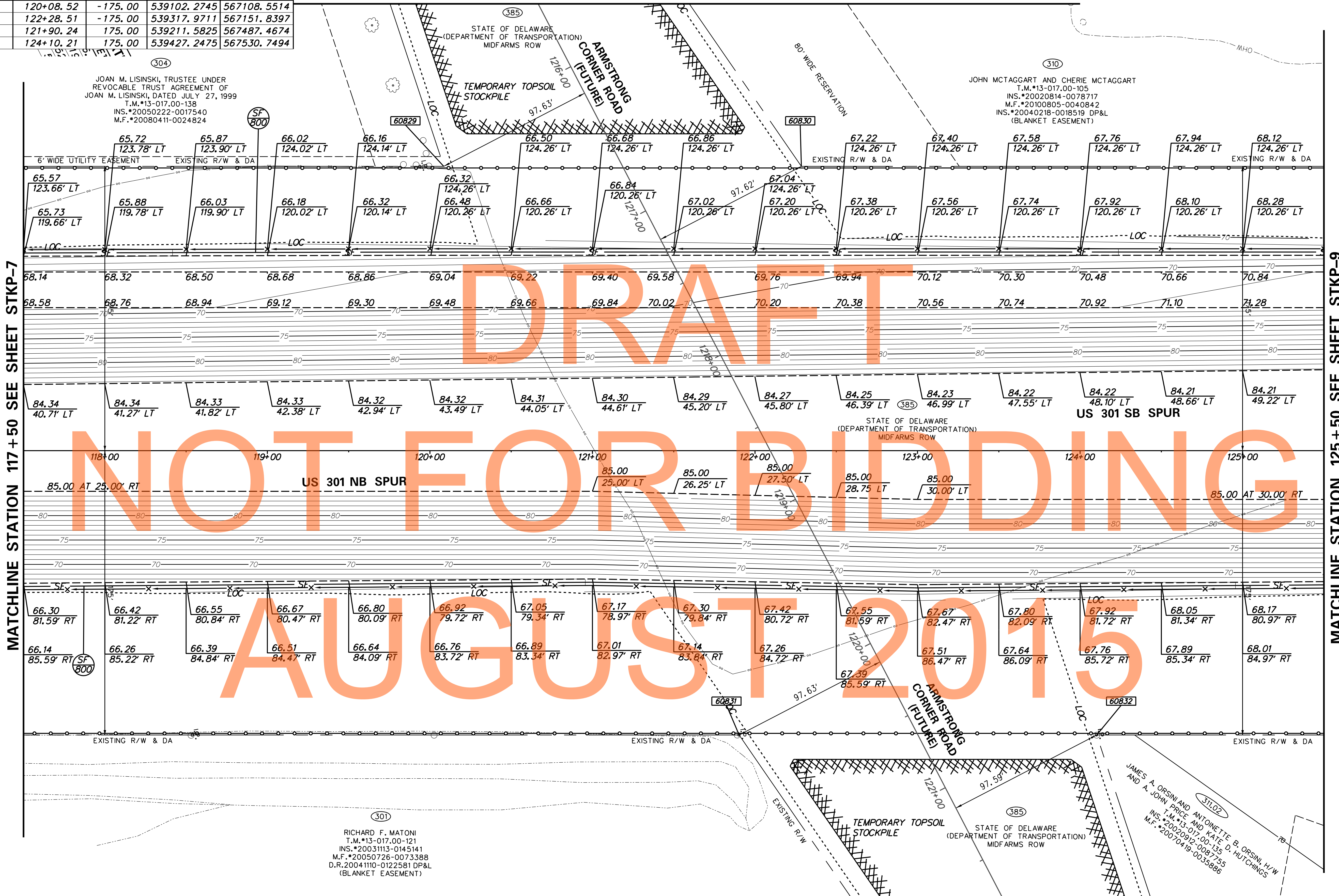
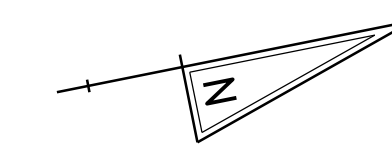

MATCHLINE STATION 117+50 SEE SHEET STKP-7

MATCHLINE STATION 125+50 SEE SHEET STKP-9

MATCHLINE SEE SHEET STKP-10



ADDENDUMS / REVISIONS	

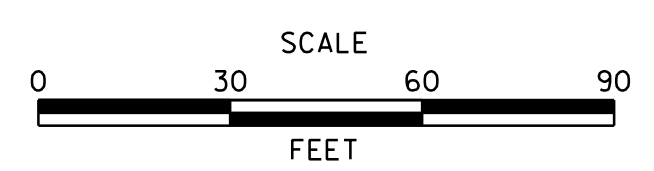

**US 301  
LEVELS ROAD  
TO SUMMIT BRIDGE ROAD**

CONTRACT T20091303	BRIDGE NO.
COUNTY NEW CASTLE	DESIGNED BY: WRC
	CHECKED BY: GTS

**SPUR ROAD STOCKPILE PLANS  
CONSTRUCTION, GRADING AND  
E&S PLAN**

STKP-8	
SHEET NO.	1249
TOTAL SHTS.	1256



MATCHLINE STATION 125+50 SEE SHEET STKP-8

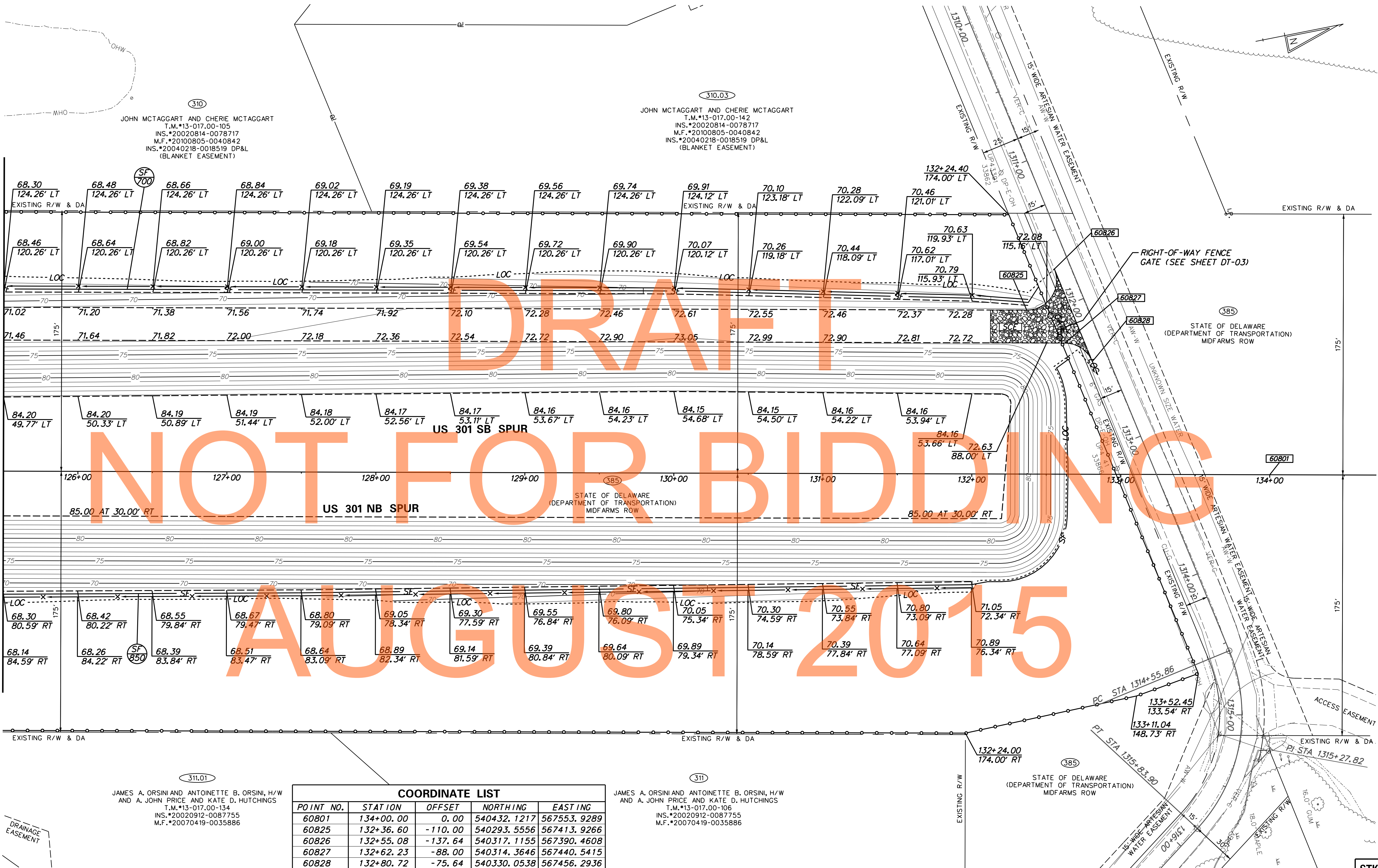

310.03  
 JOHN MCTAGGART AND CHERIE MCTAGGART  
 T.M.\*13-017.00-105  
 INS.\*20020814-0078717  
 M.F.\*20100805-0040842  
 INS.\*20040218-0018519 DP&L  
 (BLANKET EASEMENT)

310.03  
 JOHN MCTAGGART AND CHERIE MCTAGGART  
 T.M.\*13-017.00-142  
 INS.\*20020814-0078717  
 M.F.\*20100805-0040842  
 INS.\*20040218-0018519 DP&L  
 (BLANKET EASEMENT)

311.01  
 JAMES A. ORSINI AND ANTOINETTE B. ORSINI, H/W  
 AND A. JOHN PRICE AND KATE D. HUTCHINGS  
 T.M.\*13-017.00-134  
 INS.\*20020912-0087755  
 M.F.\*20070419-0035886

311  
 JAMES A. ORSINI AND ANTOINETTE B. ORSINI, H/W  
 AND A. JOHN PRICE AND KATE D. HUTCHINGS  
 T.M.\*13-017.00-106  
 INS.\*20020912-0087755  
 M.F.\*20070419-0035886

**COORDINATE LIST**

POINT NO.	STATION	OFFSET	NORTHING	EASTING
60801	134+00.00	0.00	540432.1217	567553.9289
60825	132+36.60	-110.00	540293.5556	567413.9266
60826	132+55.08	-137.64	540317.1155	567390.4608
60827	132+62.23	-88.00	540314.3646	567440.5415
60828	132+80.72	-75.64	540330.0538	567456.2936



ADDENDUMS / REVISIONS

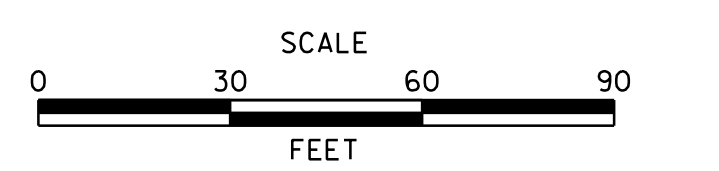

**US 301  
 LEVELS ROAD  
 TO SUMMIT BRIDGE ROAD**

CONTRACT	BRIDGE NO.
T200911303	
COUNTY	DESIGNED BY: WRC
NEW CASTLE	CHECKED BY: GTS

**SPUR ROAD STOCKPILE PLANS  
 CONSTRUCTION, GRADING AND  
 E&S PLAN**

<b>STKP-9</b>
SHEET NO.
1250
TOTAL SHTS.
1256



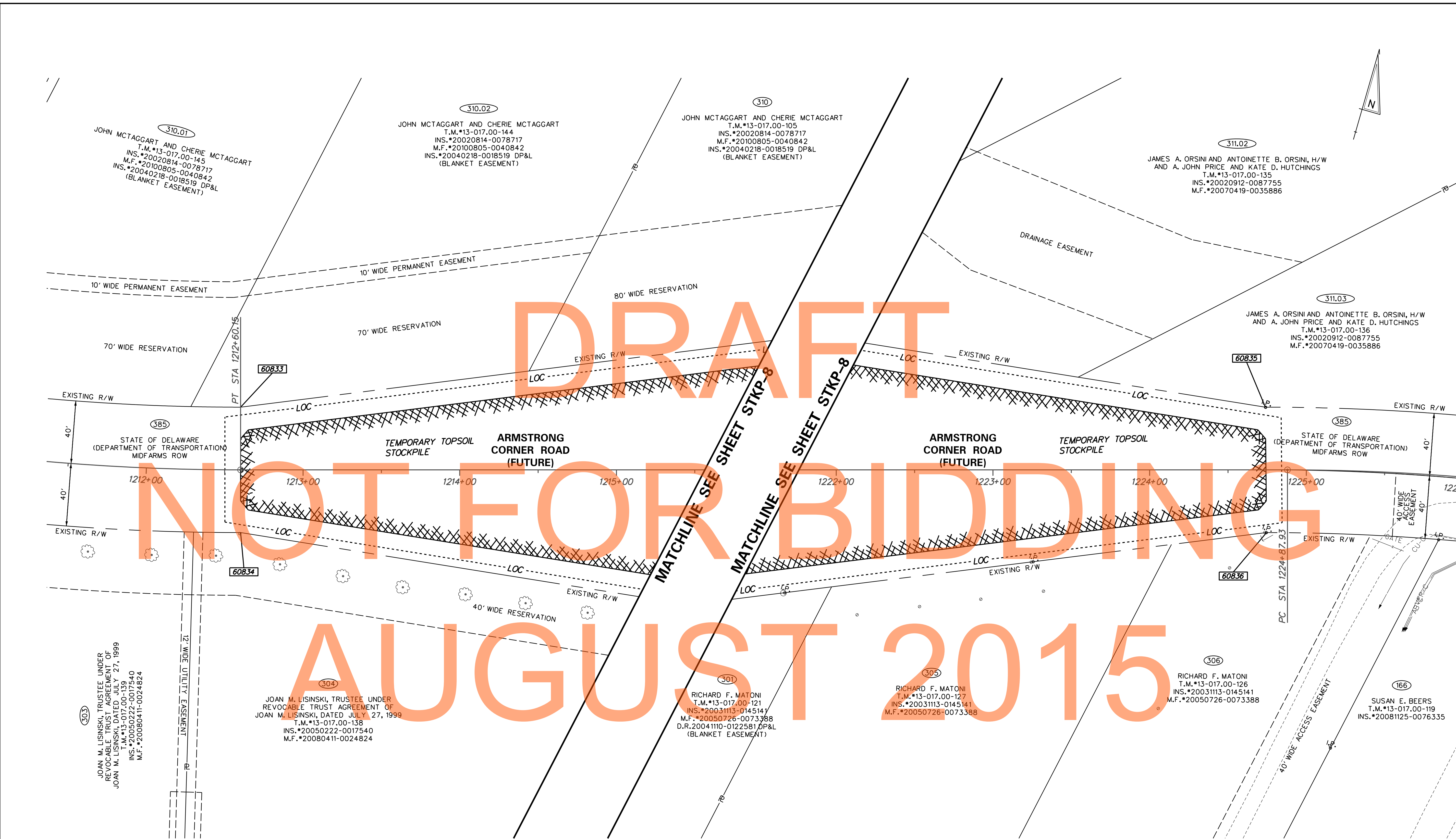
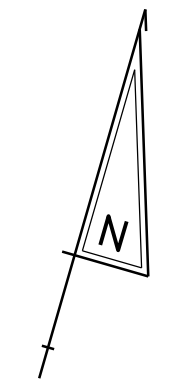

COORDINATE LIST				
POINT NO.	STATION	OFFSET	NORTHING	EASTING
60833	119+65.57	-556.37	539135.2079	566726.1866
60834	118+94.57	-519.50	539058.3424	566748.3607
60835	125+24.86	520.78	539471.6162	567892.3317
60836	124+54.20	558.30	539394.9548	567915.2139



ADDENDUMS / REVISIONS	

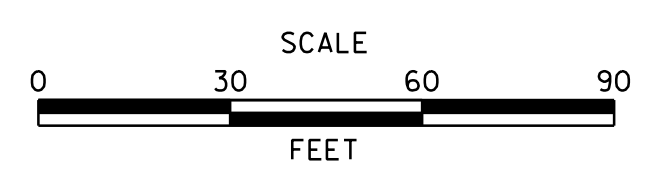

**US 301**  
**LEVELS ROAD**  
**TO SUMMIT BRIDGE ROAD**

CONTRACT T200911303	BRIDGE NO.
COUNTY NEW CASTLE	DESIGNED BY: WRC
	CHECKED BY: GTS

**SPUR ROAD STOCKPILE PLANS**  
**CONSTRUCTION, GRADING AND**  
**E&S PLAN**

<b>STKP-10</b>
SHEET NO. 1251
TOTAL SHTS. 1256



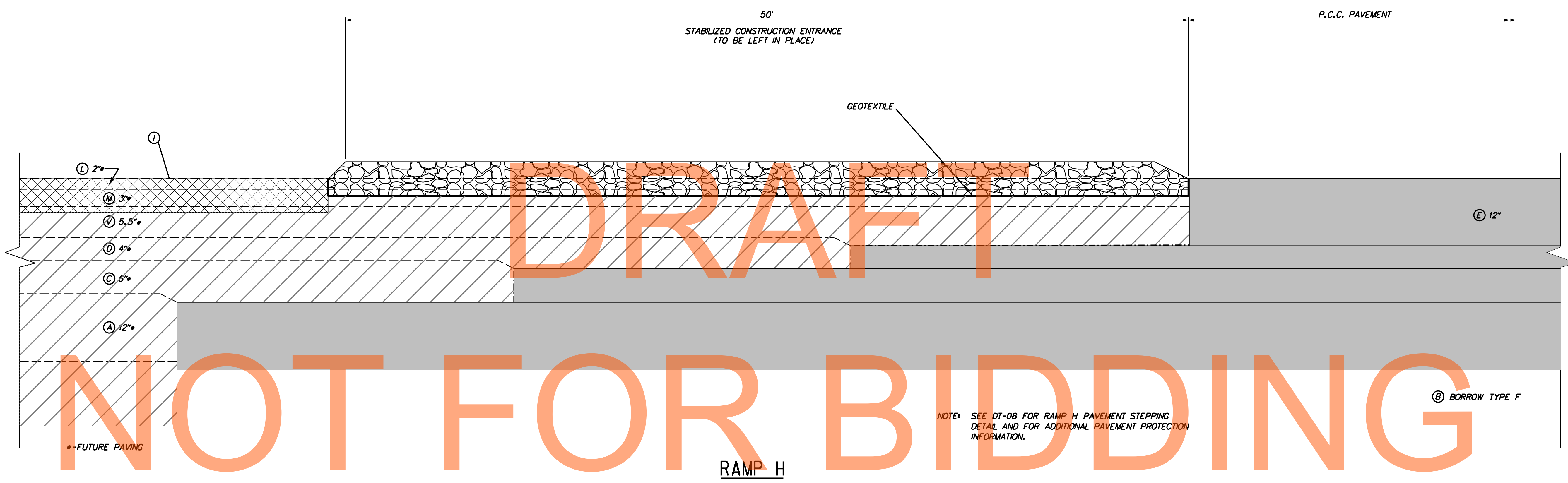

DRAFT

NOT FOR BIDDING

AUGUST 2015

LEGEND	
•(A)	ITEM *209001, BORROW TYPE A
•(B)	ITEM *209006, BORROW TYPE F
•(C)	ITEM *304502, SOIL CEMENT BASE COURSE
•(D)	ITEM *304501, PERMEABLE TREATED BASE
•(E)	ITEM *501006, PORTLAND CEMENT CONCRETE PAVEMENT
①	ITEM *733002, TOPSOILING, 6" DEPTH ITEM *734013, PERMANENT GRASS SEEDING, DRY GROUND
•(L)	ITEM *401801, WMA, SUPERPAVE, TYPE C, 160 GYRATIONS, PG 64-22 (CARBONATE STONE)
•(M)	ITEM *401810, WMA, SUPERPAVE, TYPE B, 160 GYRATIONS, PG 64-22
•(V)	ITEM *401663, SUPERPAVE BITUMINOUS CONCRETE BASE COURSE, 160 GYRATIONS, PG 64-22

