

CHANGEABLE MESSAGE BOARDS

CMS-1

PRIOR TO DETOUR
(10 DAYS PRIOR TO BEGINNING OF DETOUR)

STRAWBERRY LANE

TO CLOSE STARTING
XXXXXX

SPECIAL SIGNS

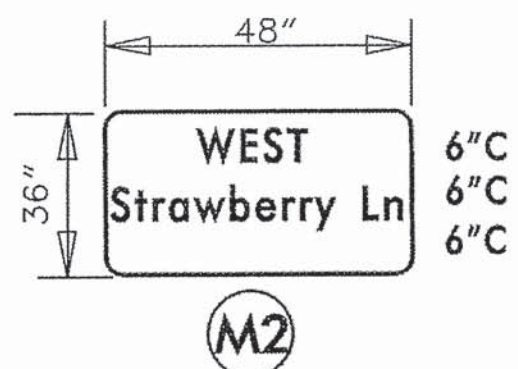
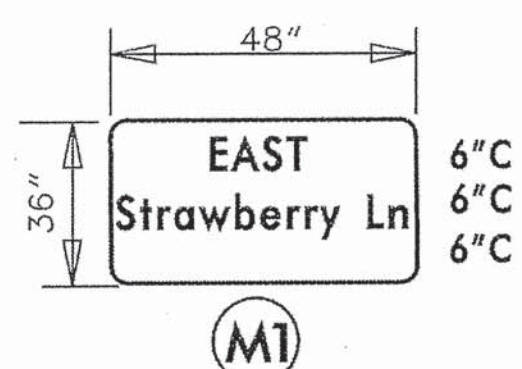
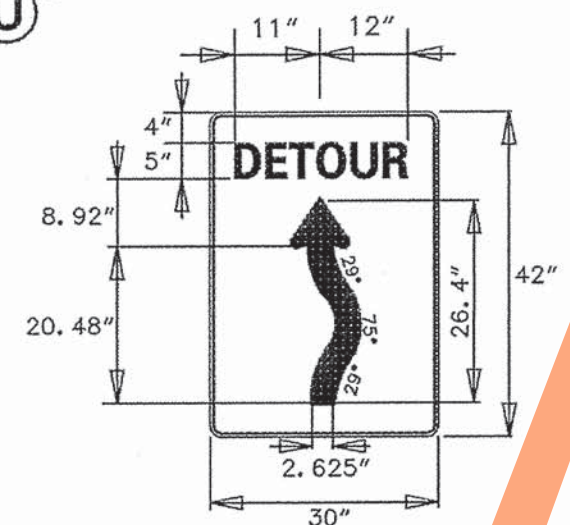
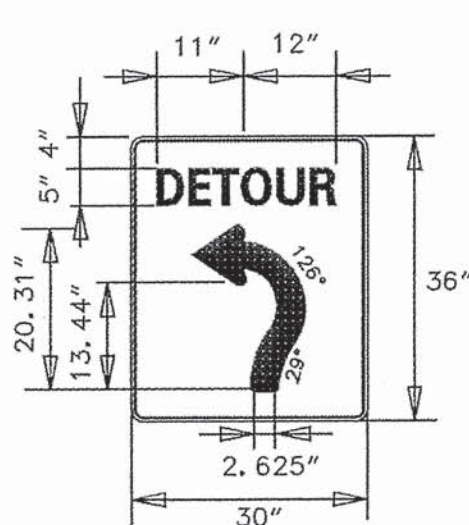
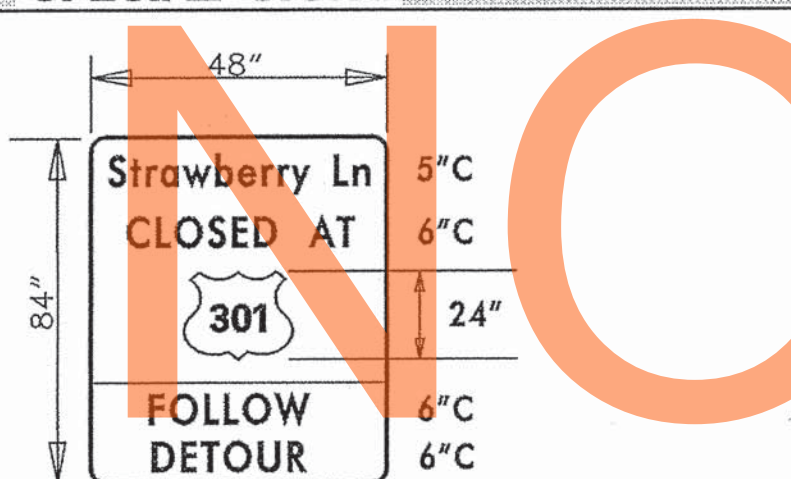

* U Sign shall be mounted on two 4"x6" wood posts that shall be ground mounted and breakaway in accordance with NCHRP 350. (Cost associated with wood posts is incidental to item #743024.)

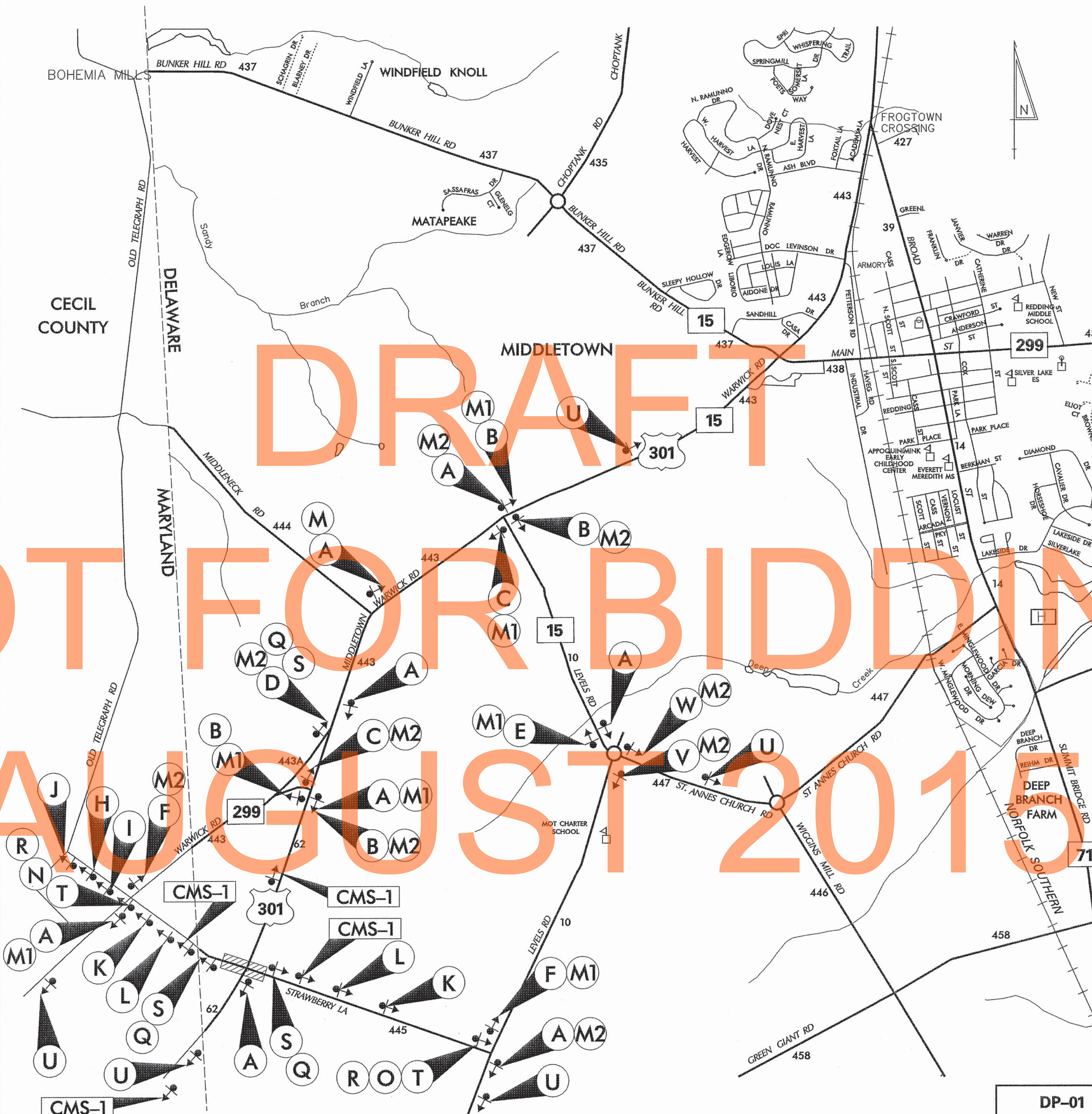

LEGEND

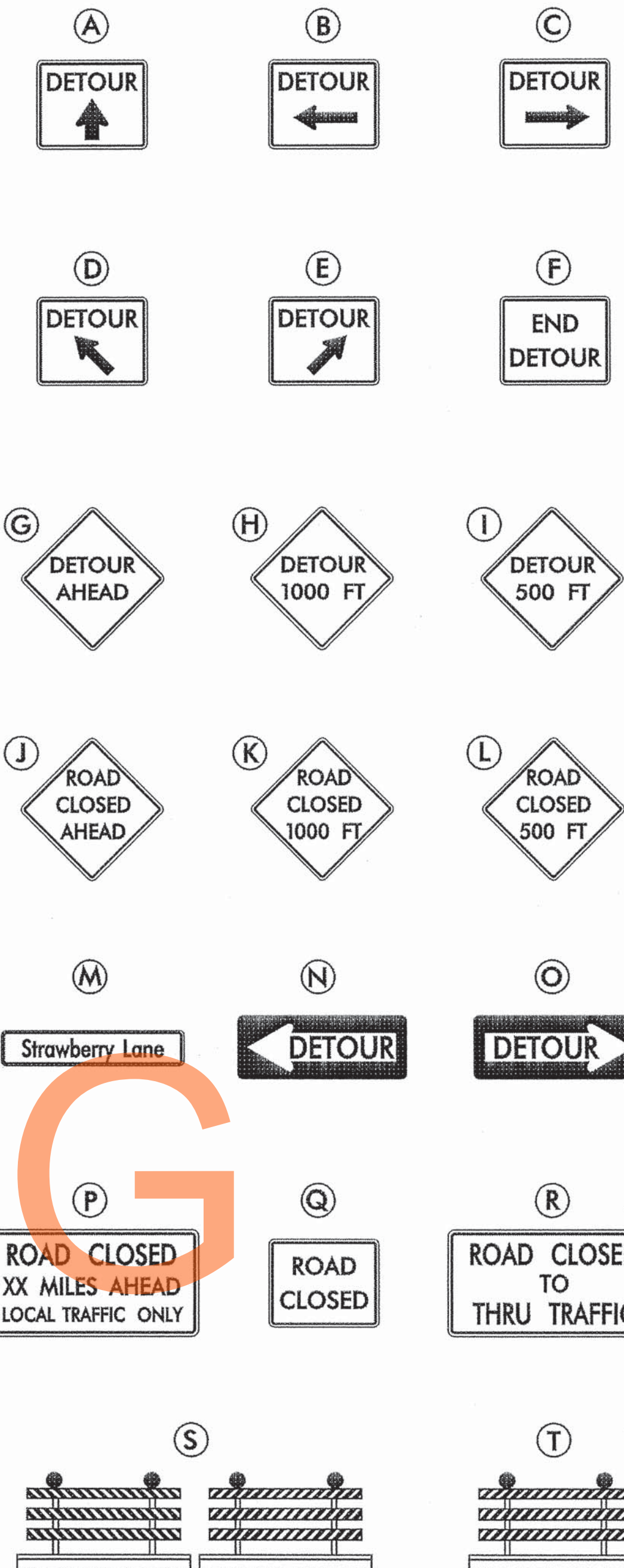

GENERAL NOTES

- ALL DETOUR SIGNING INCLUDING TRAILBLAZERS, ARE TO BE SUPPLIED AND MAINTAINED BY THE GENERAL CONTRACTOR IN COMPLIANCE TO THE MANUAL OF UNIFORM TRAFFIC CONTROL DEVICES.
- THE CONTRACTOR SHALL COMPLY WITH GUIDELINES IN "THE DELAWARE MANUAL ON UNIFORM TRAFFIC CONTROL DEVICES (DE- MUTCD PART 6) FOR LIGHTS, BARRICADES AND SIGNS.(AS PER LATEST REVISION)
- FIELD CONDITIONS MAY DICTATE CHANGES AT SOME TIME DURING THE LIFE OF THE CONTRACT. IN THE EVENT OF OMISSIONS OR CORRECTIONS, THE SIGNING PROVISIONS OF THE DELAWARE MANUAL ON UNIFORM TRAFFIC CONTROL DEVICES WILL PREVAIL.
- SIGNS J THROUGH L AND P THROUGH R, THE WORD (ROAD) SHOULD BE CHANGED TO RAMP, R/R OR BRIDGE WHERE APPLICABLE.
- WARNING SIGNS SHOULD BE MOUNTED ON BREAKAWAY POSTS AND HAVE RETROREFLECTIVE FLUORESCENT SHEETING.
- "S" BARRICADES SHALL COMPLETELY RUN THE FULL WIDTH OF ROADWAY.
- BARRICADES SHALL BE A MINIMUM OF 6 FEET WIDE UNLESS DIRECTED BY THE ENGINEER.
- DETOUR TO BE IN PLACE DURING PHASE 2 OF CONSTRUCTION FOR A PERIOD OF APPROXIMATELY 10 MONTHS.

RECOMMENDED _____ DATE: _____ APPROVED CHIEF SAFETY OFFICER _____ DATE: 9-17-12 APPROVED TRAFFIC ENGINEER _____ DATE: 9/17/12

CHANGEABLE MESSAGE BOARDS

CMS-1
 PRIOR TO DETOUR
 (10 DAYS PRIOR TO BEGINNING OF DETOUR)

MIDDLE NECK ROAD

TO CLOSE STARTING XXXXXX

SPECIAL SIGNS

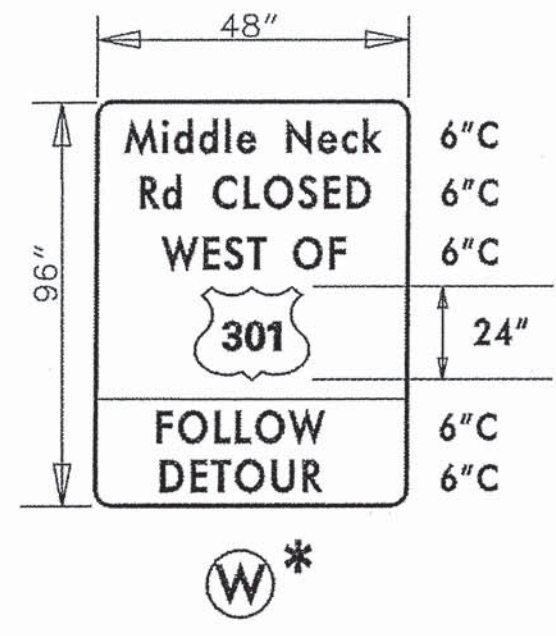
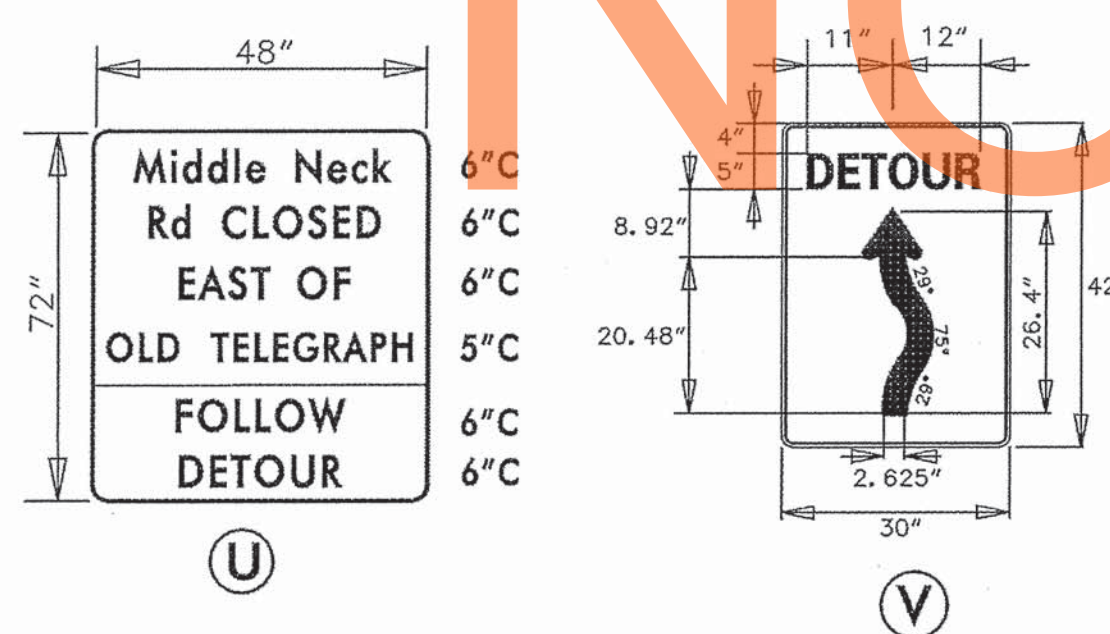

* (W) Sign shall be mounted on two 4"x6" wood posts that shall be ground mounted and breakaway in accordance with NCHRP 350. (Cost associated with wood posts is incidental to item #743024.)



LEGEND

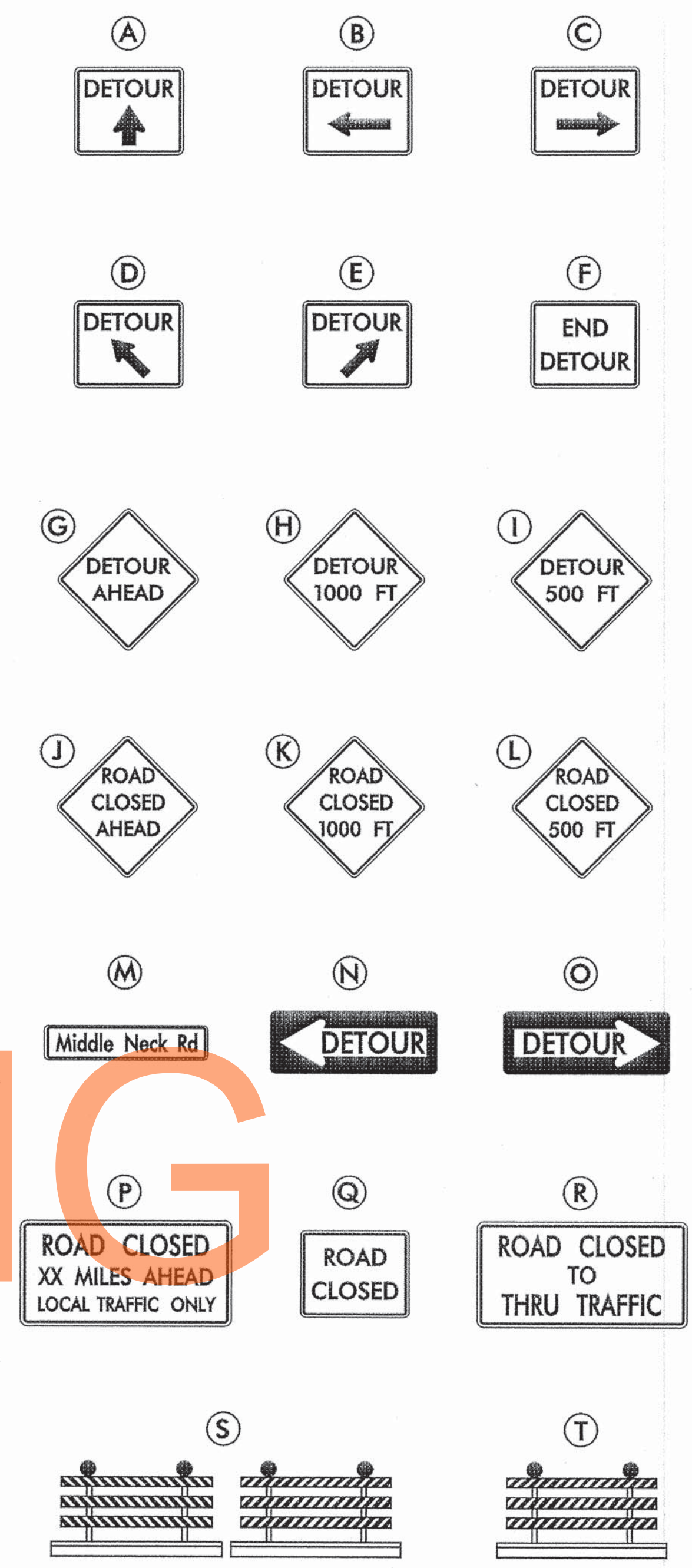

GENERAL NOTES

- ALL DETOUR SIGNING INCLUDING TRAILBLAZERS, ARE TO BE SUPPLIED AND MAINTAINED BY THE GENERAL CONTRACTOR IN COMPLIANCE TO THE MANUAL OF UNIFORM TRAFFIC CONTROL DEVICES.
- THE CONTRACTOR SHALL COMPLY WITH GUIDELINES IN "THE DELAWARE MANUAL ON UNIFORM TRAFFIC CONTROL DEVICES (DE- MUTCD PART 6) FOR LIGHTS, BARRICADES AND SIGNS.(AS PER LATEST REVISION)
- FIELD CONDITIONS MAY DICTATE CHANGES AT SOME TIME DURING THE LIFE OF THE CONTRACT. IN THE EVENT OF OMISSIONS OR CORRECTIONS, THE SIGNING PROVISIONS OF THE DELAWARE MANUAL ON UNIFORM TRAFFIC CONTROL DEVICES WILL PREVAIL.
- SIGNS J THROUGH L AND P THROUGH R, THE WORD (ROAD) SHOULD BE CHANGED TO RAMP, R/R OR BRIDGE WHERE APPLICABLE.
- WARNING SIGNS SHOULD BE MOUNTED ON BREAKAWAY POSTS AND HAVE RETROREFLECTIVE FLUORESCENT SHEETING.
- "S" BARRICADES SHALL COMPLETELY RUN THE FULL WIDTH OF ROADWAY.
- BARRICADES SHALL BE A MINIMUM OF 6 FEET WIDE UNLESS DIRECTED BY THE ENGINEER.
- DETOUR TO BE IN PLACE DURING PHASE 2 OF CONSTRUCTION FOR A PERIOD OF APPROXIMATELY 10 MONTHS.

DP-02

RECOMMENDED DATE: _____ APPROVED CHIEF SAFETY OFFICER: _____ DATE: 9-17-22 APPROVED TRAFFIC ENGINEER: _____ DATE: 9/17/22

DELAWARE DEPARTMENT OF TRANSPORTATION

ADDENDUM / REVISIONS

NOT TO SCALE

US 301 MARYLAND STATE LINE TO LEVELS ROAD

CONTRACT T200811301
 ROAD NO. N 444
 COUNTY NEW CASTLE
 DESIGNED BY: TLM
 CHECKED BY: PAH

PHASE 2 DETOUR PLAN MIDDLE NECK ROAD

SHEET NO. 646
 TOTAL SHTS. 850

CHANGEABLE MESSAGE BOARDS

CMS-1
PRIOR TO DETOUR
(10 DAYS PRIOR TO BEGINNING OF DETOUR)

WARWICK ROAD

TO CLOSE STARTING XXXXXX

DURING DETOUR

WARWICK ROAD

CLOSED FOLLOW DETOUR

LEGEND

A DETOUR ↑	B DETOUR ←	C DETOUR →
D DETOUR ↙	E DETOUR ↗	F END DETOUR
G DETOUR AHEAD	H DETOUR 1000 FT	I DETOUR 500 FT
J ROAD CLOSED AHEAD	K ROAD CLOSED 1000 FT	L ROAD CLOSED 500 FT
M ROAD NAME	N DETOUR ←	O DETOUR →
P ROAD CLOSED XX MILES AHEAD LOCAL TRAFFIC ONLY	Q ROAD CLOSED	R ROAD CLOSED TO THRU TRAFFIC
S 	T 	

SPECIAL SIGNS

U

Warwick Rd	6"C
CLOSED NORTH	5"C
OF Wilson	6"C
FOLLOW	6"C
DETOUR	6"C

V*

Warwick Rd	6"C
CLOSED WEST	5"C
OF 301	24"
FOLLOW	6"C
DETOUR	6"C

* **V** Sign shall be mounted on two 4"x6" wood posts that shall be ground mounted and breakaway in accordance with NCHRP 350. (Costs associated with wood posts is incidental to item #743024.)



- GENERAL NOTES**
- ALL DETOUR SIGNING INCLUDING TRAILBLAZERS, ARE TO BE SUPPLIED AND MAINTAINED BY THE GENERAL CONTRACTOR IN COMPLIANCE TO THE MANUAL OF UNIFORM TRAFFIC CONTROL DEVICES.
 - THE CONTRACTOR SHALL COMPLY WITH GUIDELINES IN "THE DELAWARE MANUAL ON UNIFORM TRAFFIC CONTROL DEVICES (DE- MUTCD PART 6) FOR LIGHTS, BARRICADES AND SIGNS.(AS PER LATEST REVISION)
 - FIELD CONDITIONS MAY DICTATE CHANGES AT SOME TIME DURING THE LIFE OF THE CONTRACT. IN THE EVENT OF OMISSIONS OR CORRECTIONS, THE SIGNING PROVISIONS OF THE DELAWARE MANUAL ON UNIFORM TRAFFIC CONTROL DEVICES WILL PREVAIL.
 - SIGNS J THROUGH L AND P THROUGH R, THE WORD (ROAD) SHOULD BE CHANGED TO RAMP, R/R OR BRIDGE WHERE APPLICABLE.
 - WARNING SIGNS SHOULD BE MOUNTED ON BREAKAWAY POSTS AND HAVE RETROREFLECTIVE FLUORESCENT SHEETING.
 - "S" BARRICADES SHALL COMPLETELY RUN THE FULL WIDTH OF ROADWAY.
 - BARRICADES SHALL BE A MINIMUM OF 6 FEET WIDE UNLESS DIRECTED BY THE ENGINEER.
 - DETOUR TO BE IN PLACE DURING PHASE 3 OF CONSTRUCTION FOR A PERIOD OF APPROXIMATELY 2 WEEKS.

RECOMMENDED _____ DATE: _____

APPROVED CHIEF SAFETY OFFICER: _____ DATE: 9-17-12

APPROVED TRAFFIC ENGINEER: _____ DATE: 9/17/12