

PLOTTED: 10/31/2018
Z:\2017\1702\027\1-420\CADD\MICROSTATION\ROADWAY\CP05_1-420.DGN

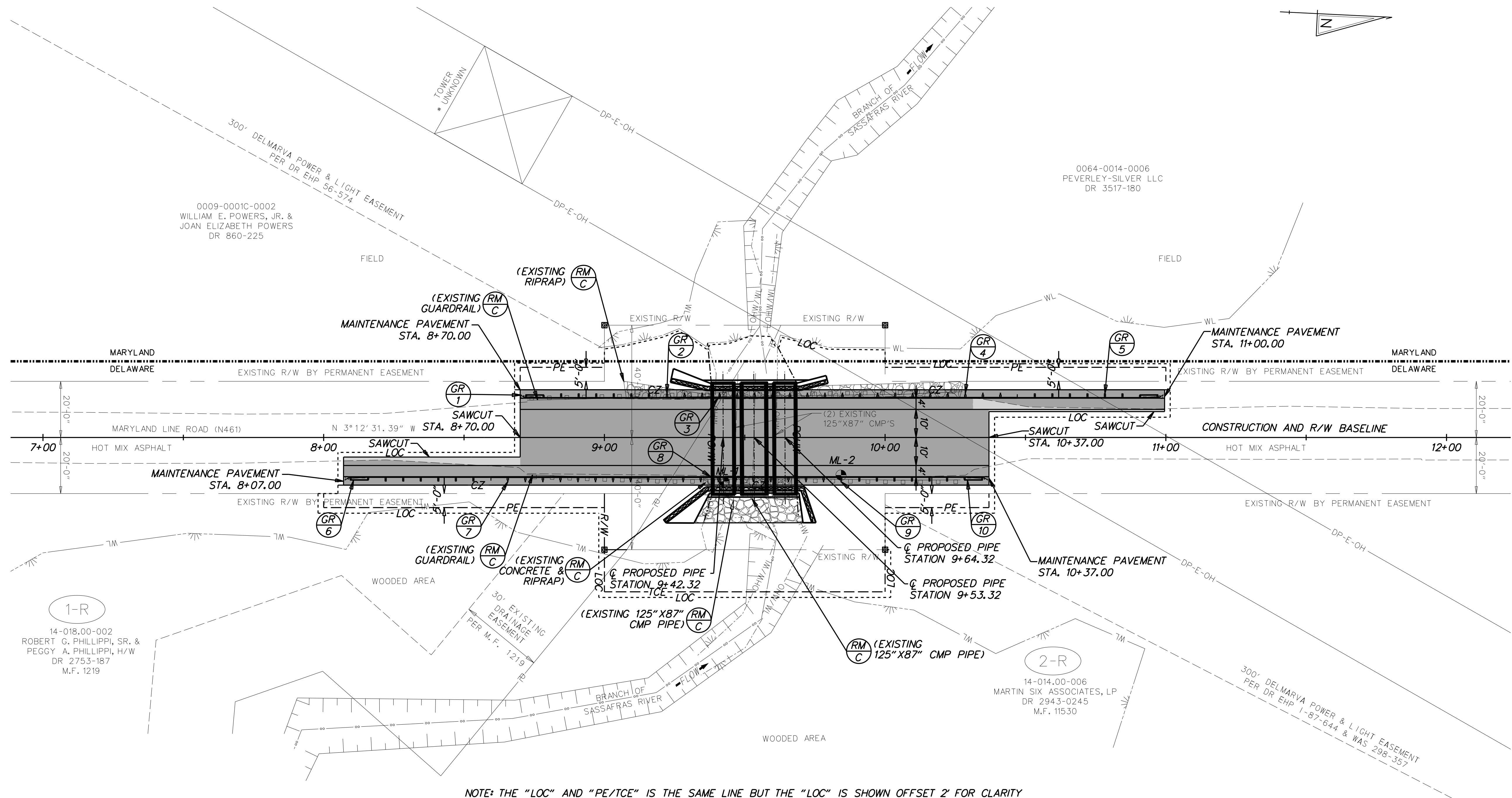

NOTE: THE "LOC" AND "PE/TCE" IS THE SAME LINE BUT THE "LOC" IS SHOWN OFFSET 2' FOR CLARITY

NOTES:

- RIPRAP PLACEMENT DOWNSTREAM - RIPRAP SHALL BE PLACED IN THE CHANNEL BOTTOM (AS INDICATED ON SHEET 7) ALONG THE STREAM CENTERLINE AND SHALL BE PLACED TO CREATE A SMOOTH BEND THAT MATCHES THE EXISTING STREAM BANKS.
- SEE ENVIRONMENTAL COMPLIANCE SHEET FOR ADDITIONAL NOTES ON STREAM RESTORATION AND RIPRAP TREATMENT.
- EXISTING IMPERVIOUS PAVEMENT AREA: 4,416 S.F.
PERMANENT IMPERVIOUS PAVEMENT AREA: 6,800 S.F.
NET CHANGE IN IMPERVIOUS PAVEMENT AREA: 2,384 S.F.
- SEE SHEET 3 NOTE 6 FOR NPDES GENERAL PERMITTING.

GUARDRAIL SCHEDULE				
NO.	ITEM DESCRIPTION / TYPE	BEGIN STA.	OFFSET	LENGTH
1	END TREATMENT ATTENUATOR, TYPE 1	8+72.00	-14.00'	50.00'
2	STEEL BEAM GUARDRAIL, TYPE 1-31	9+22.00	-14.00'	12.50'
3	STEEL BEAM GUARDRAIL, TYPE 2-31	9+34.50	-14.00'	37.50'
4	STEEL BEAM GUARDRAIL, TYPE 1-31	9+72.00	14.00'	75.00'
5	END TREATMENT ATTENUATOR, TYPE 1	10+47.00	-14.00'	50.00'
6	END TREATMENT ATTENUATOR, TYPE 1	8+09.50	14.00'	50.00'
7	STEEL BEAM GUARDRAIL, TYPE 1-31	8+59.50	14.00'	75.00'
8	STEEL BEAM GUARDRAIL, TYPE 2-31	9+34.50	14.00'	37.50'
9	STEEL BEAM GUARDRAIL, TYPE 1-31	9+72.00	14.00'	12.50'
10	END TREATMENT ATTENUATOR, TYPE 1	9+84.50	14.00'	50.00'

RIPRAP SCHEDULE		
LOCATION	TYPE	AREA/SF
UPSTREAM	R-7	328.00

SOIL BORING SCHEDULE			
NO.	STATION	OFFSET	DESCRIPTION
ML-1	9+42.60	15.64	SEE SOIL BORING LOG
ML-2	9+84.29	13.42	SEE SOIL BORING LOG

	ADDENDUMS / REVISIONS		DESIGN-BUILD STATEWIDE PIPE REPLACEMENT PROJECT (BR 1-420 ON MARYLAND LINE ROAD)	CONTRACT T201707002	BRIDGE NO. 1-420	CONSTRUCTION PLAN	SHEET NO. 5
				COUNTY NEW CASTLE	DESIGNED BY: HLW CHECKED BY: KSJ		TOTAL SHTS. 13